

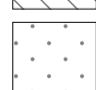





-  Cropland
-  Wilderness
-  Arable
-  Grass
-  Mud
-  Sand
-  Gravel
-  Dirt Road



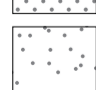

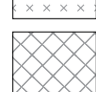
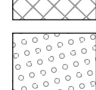
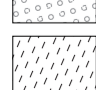
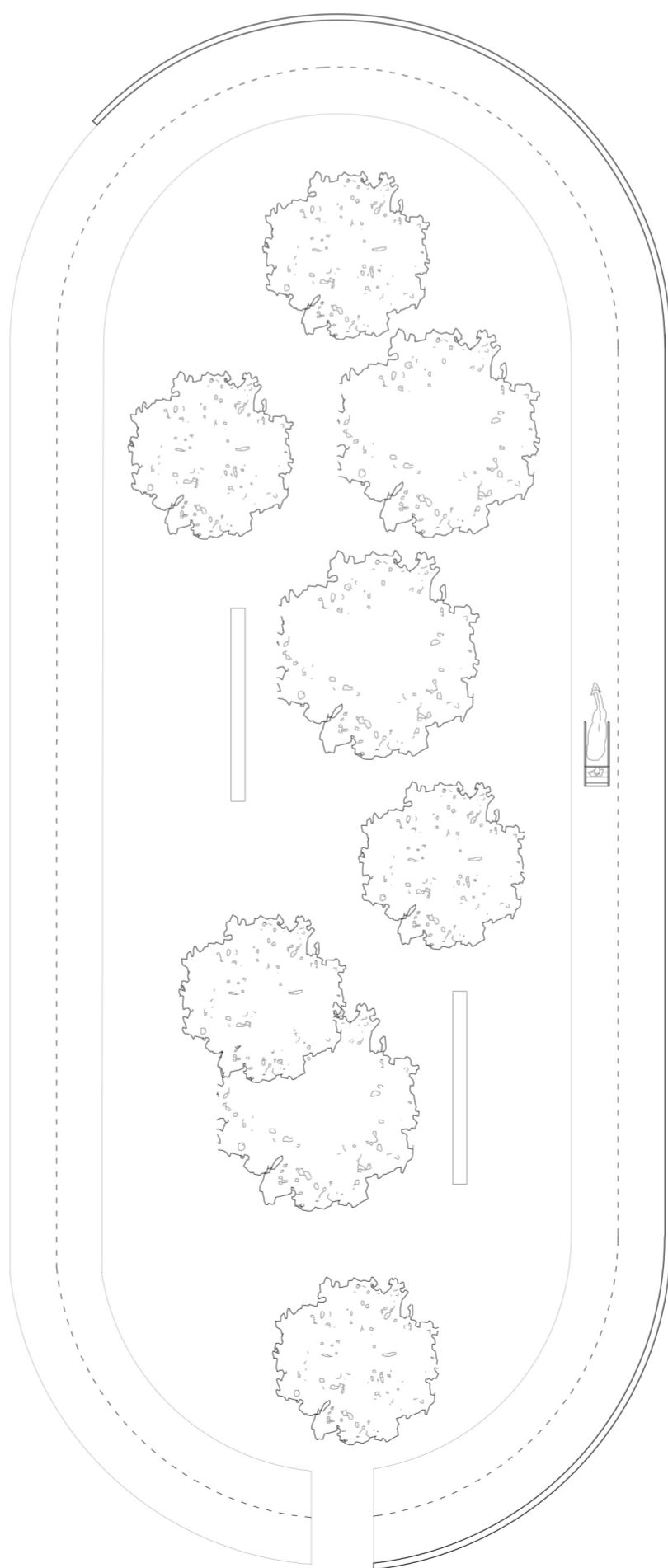
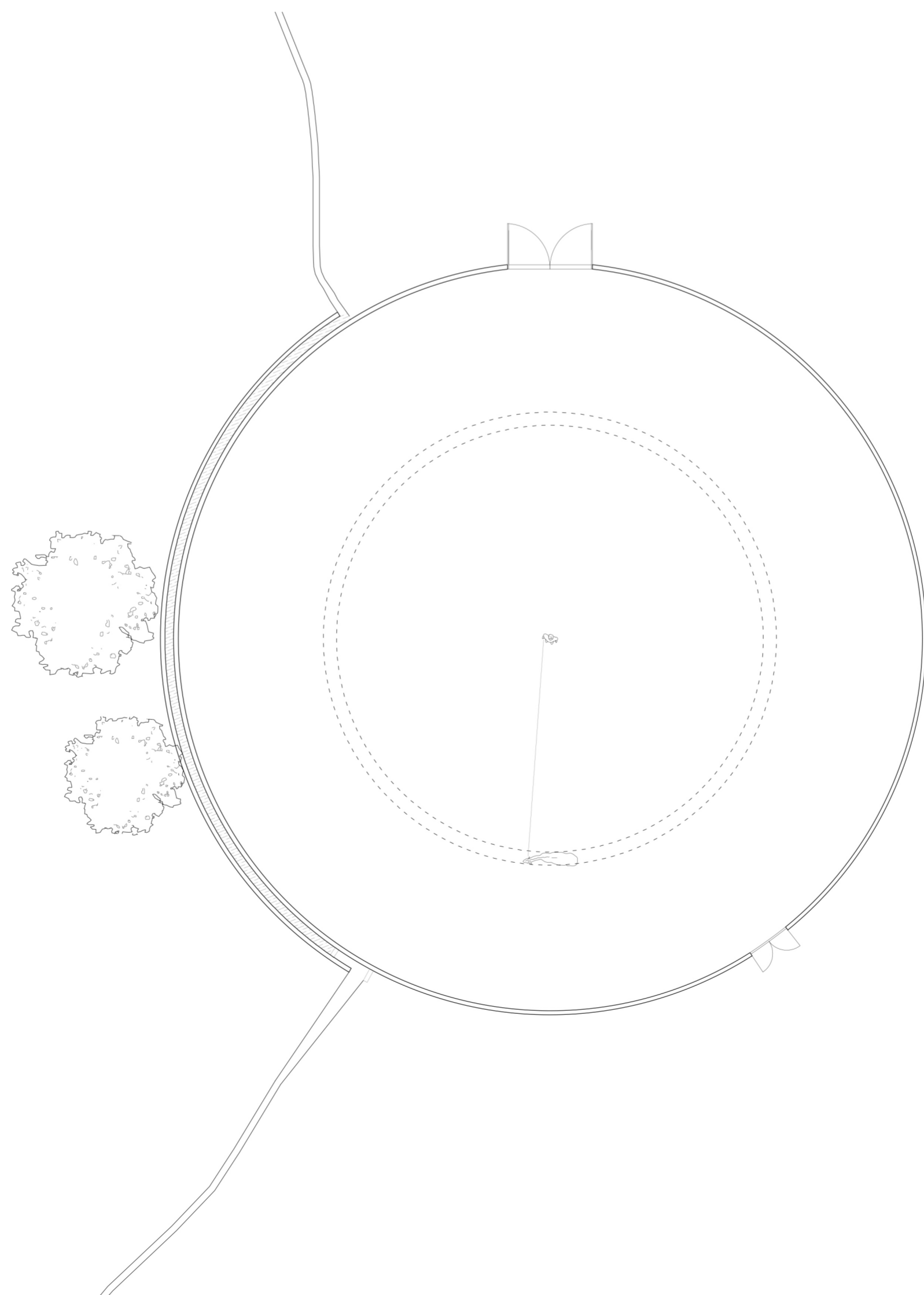
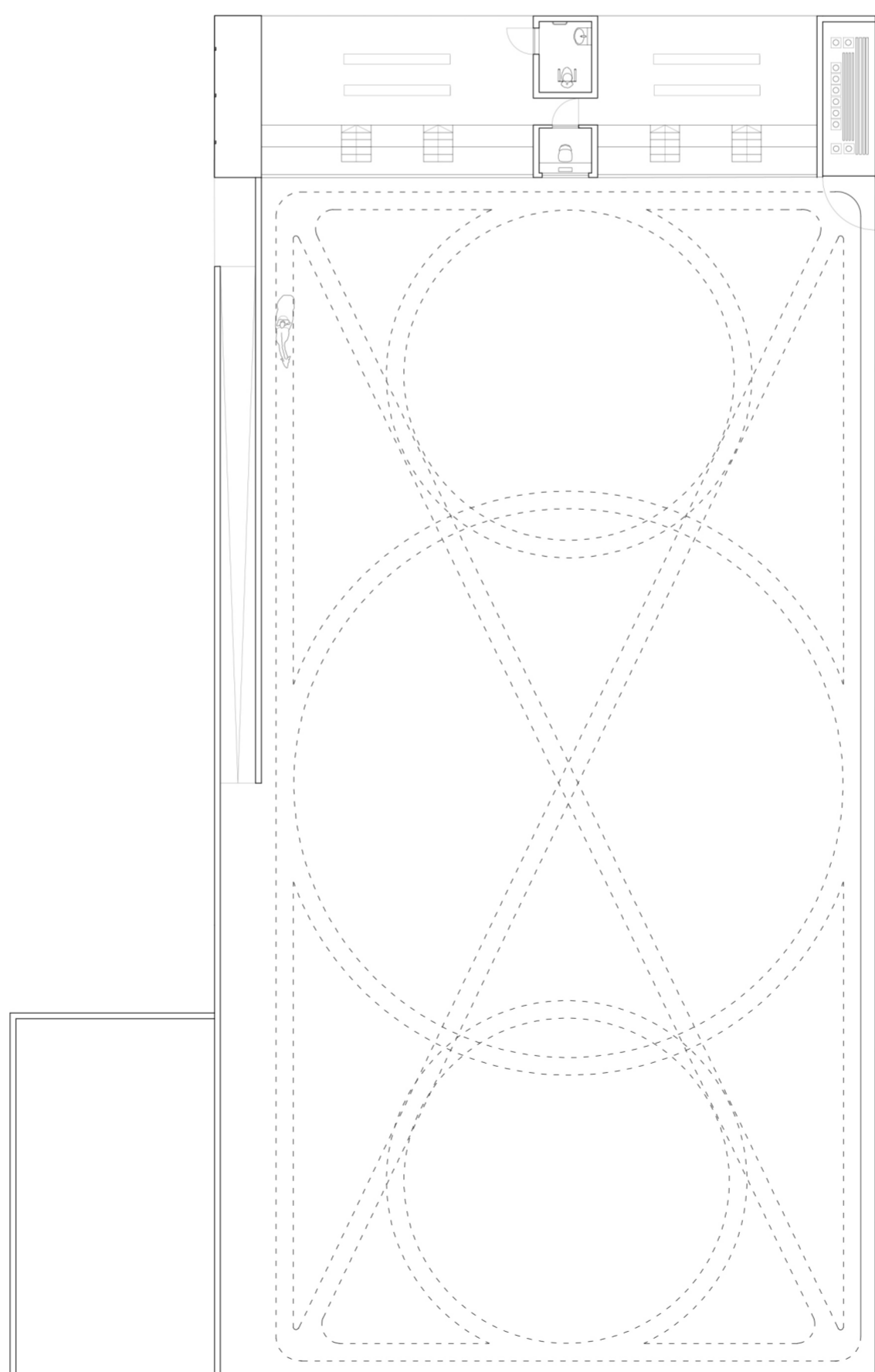



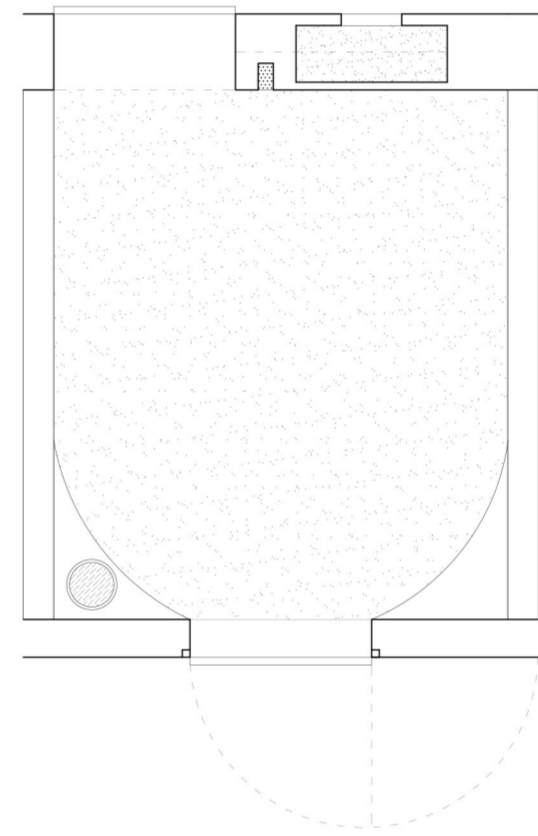

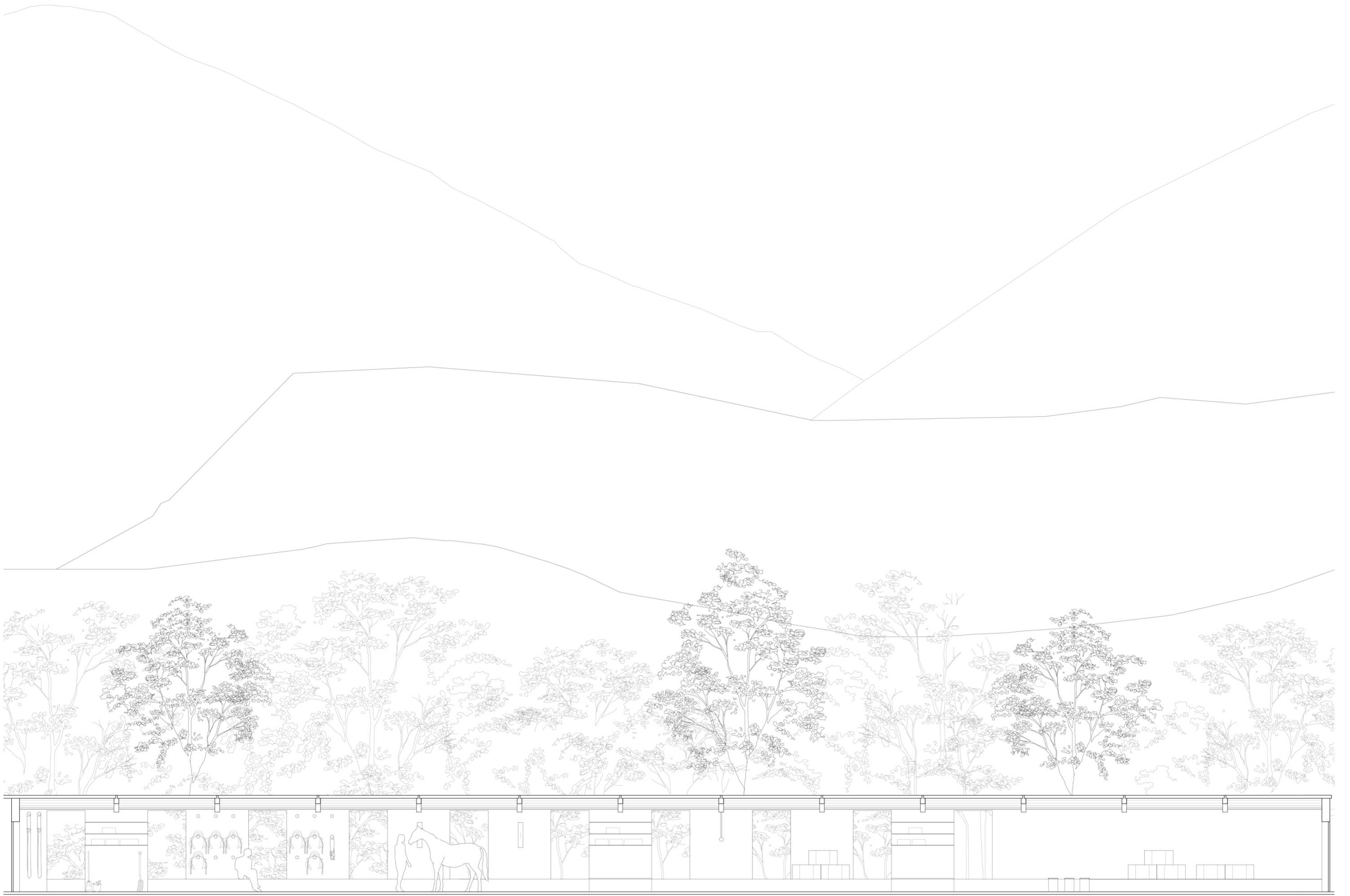

Section C 1:100



① Summer Pasture

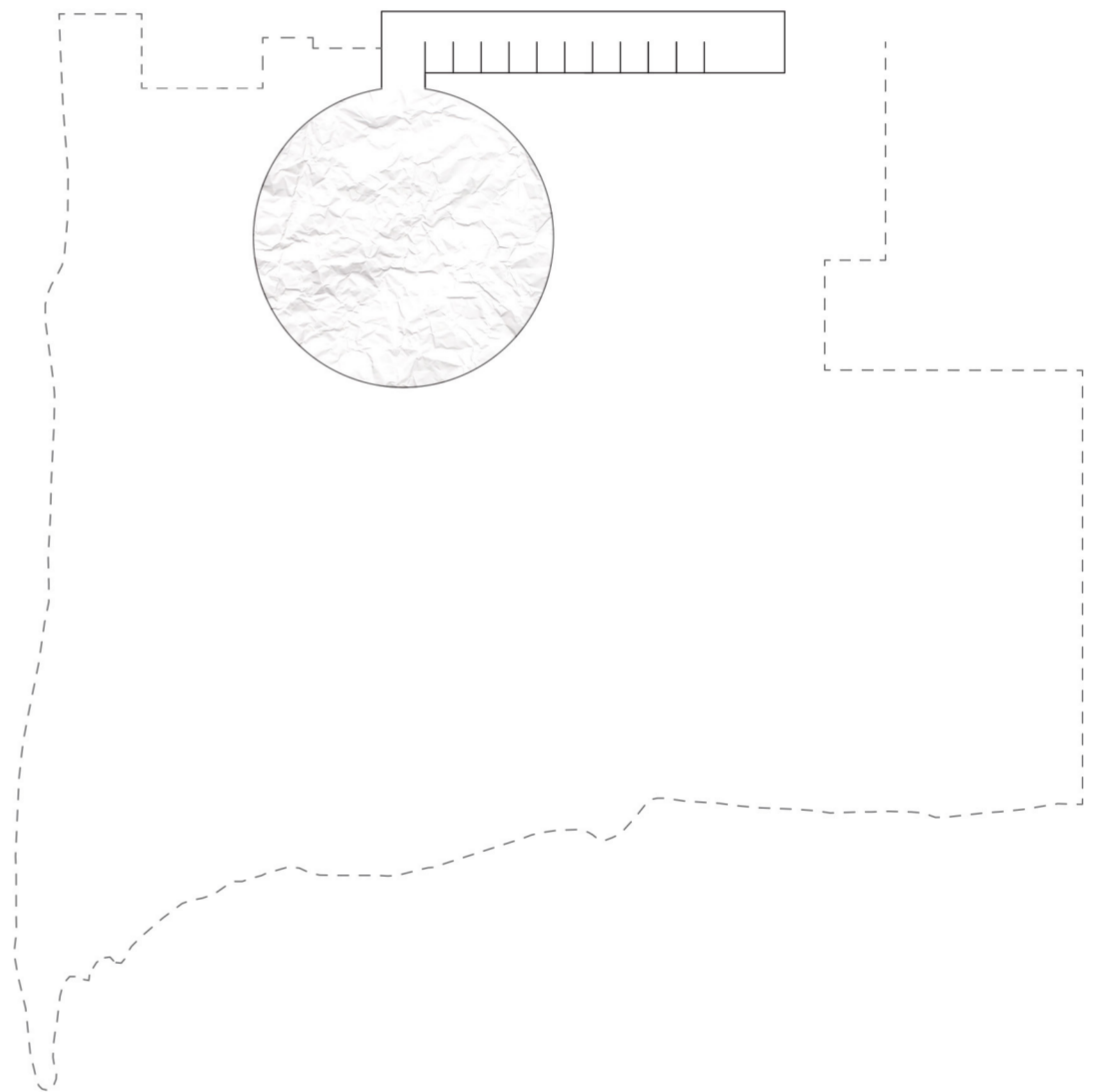

② Winter Pasture

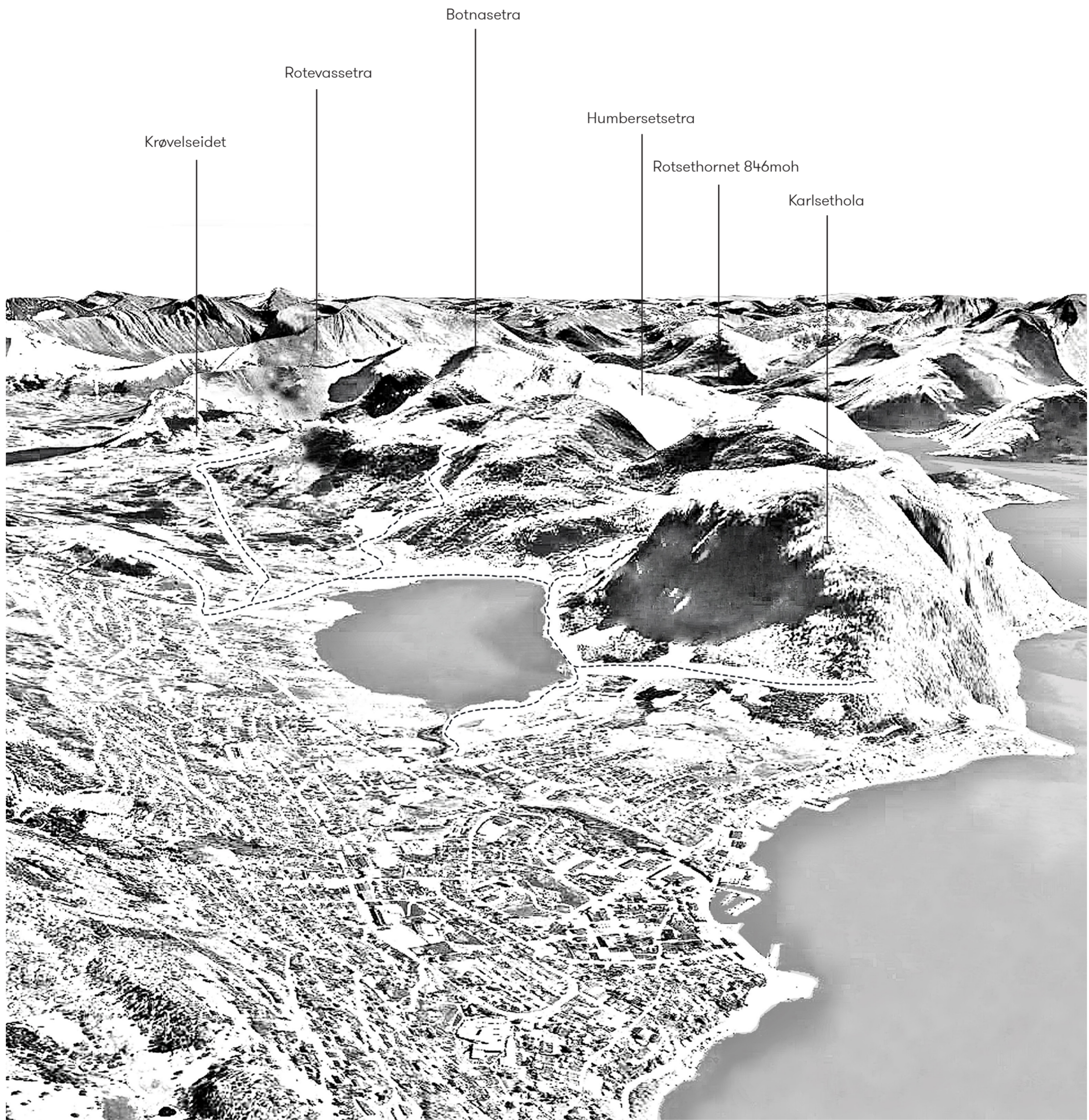

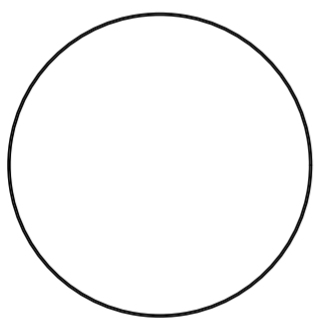
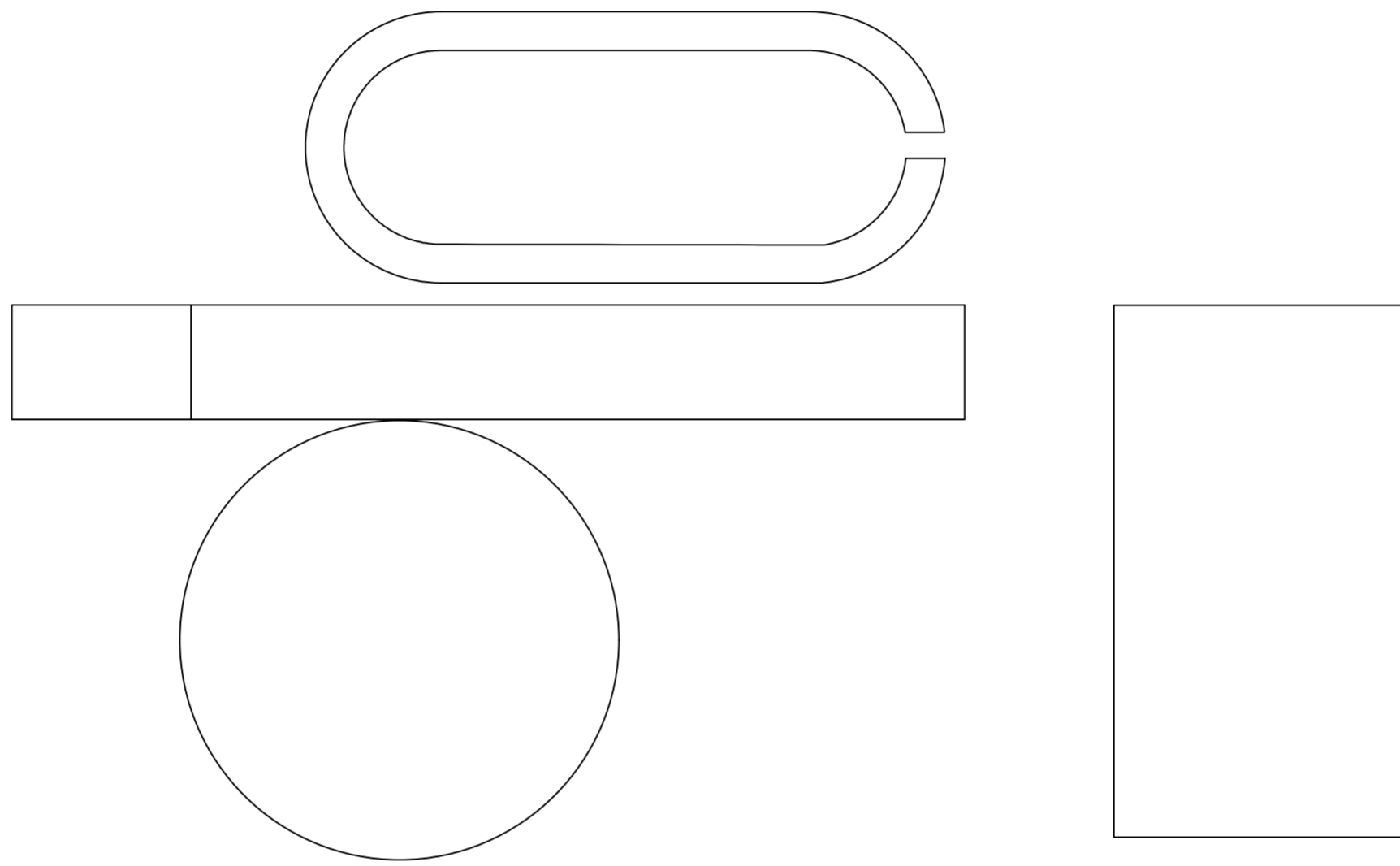

Paddock
Lunging ring
Horsemanship

Ø = 17m



Manege
Dressage
Jumping

20 x 40 m

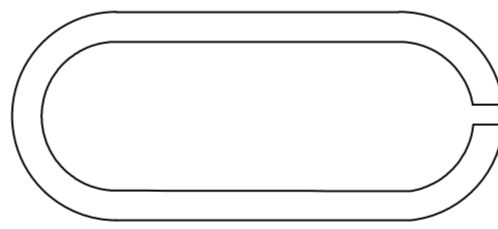

Trott Track

L = 55 m



Rider Housing

126 sqm

Horse Housing

10 x 10.5 sqm

Norwegian Horse Breeds



Fjord horse

Use: Heavy work, such as plowing fields or pulling timber, yet light and agile enough to be a good riding and driving horse. They are also sure-footed in the mountains. They are considered very good driving horses, and are commonly used in everything from competitions to tourist transport. They are also used as a sport horse, particularly in combined driving.

Withers: 1.3-1.4m



Dole horse

Use: Work, draft and harness horse. Known for its pulling power and agility. Also used as a riding horse. The Dole Gudbrandsdal has also been crossed with Swedish Warmbloods to produce riding-type horses



Withers: 1.4-1.6m

International Horse Breeds



Shagya - Arabian

Hungary, Fullblood. Use: This breed is recognized as a riding horse, and is also driven in harness. It was a hardy covering horse and is now popular in sport horse disciplines such as dressage, eventing and endurance riding. Perfect for therapeutic riding due to its soft movements.

Withers: 1.5m



English Fullblood

England, Fullblood. Use: Thoroughbreds are used mainly for racing, but are also bred for other riding disciplines such as show jumping, combined training, dressage, polo, and fox hunting. They are also used in dressage and jumping.



Withers: 1.6-1.7m



Northland horse

Use: Highly versatile in use, great strength, and its suitability for both riding and driving. Thanks to its strength and endurance, the breed is suitable for trail riding and serving as packhorse. Its smooth gait make it well-suited for therapy riding. It is also used for junior harness racing, dressage, and jumping

Withers: 0.9-1.4 m



Norwegian coldblood trotter

Use: The Norwegian trotter is a strong and hardy horse, mostly used as a racehorse [trotter] due to its speed and agility. Also used as a riding horse with its good temperament



Withers: 1.5 - 1.7 m

Morgan Horse

North America, Halfblood. Use: All round horse. The Morgan breed is known for its versatility. Popular used in western activities. Dressage, jump, field, draft and as general riding horse.

Withers: 1.4-1.6m



Hanoverian

Germany, Warmblood. Use: Originally a carriage horse, infusions of Thoroughbred blood lightened it to make it more agile and useful for competitions in dressage and jumping.



Withers: 1.6-1.7m

