

# BARENTS SUPPORT NETWORK

Offshore Search and Rescue Initiative

Diploma candidate

Uku Miller

## CONTEXT

A matter of perspective



Buckminster Fuller's  
Dymaxion Projection  
of the World Ocean



Buckminster Fuller's  
Dymaxion Globe

AREA  
1,405,000 km<sup>2</sup>

AVERAGE DEPTH  
230 m

MAXIMUM DEPTH  
600 m

GAS RESERVES  
30% of the world

OIL RESERVES  
25% of the world

POPULATION  
5.5 million

## SITE

The Barents Region

CLIMATE  
subarctic

AVERAGE WINTER AIR TEMPERATURE  
-25°C N / -5°C SW

AVERAGE SUMMER AIR TEMPERATURE  
0°C N / 10°C SW

AVERAGE SUMMER AIR TEMPERATURE  
0°C N / 10°C SW

ANNUAL PRECIPITATION  
500 mm S / 250 mm N

POLAR NIGHTTIME  
70-110 days / year

POLAR DAYTIME  
70-130 days / year

## INTRODUCTION

Project overview

As newfound prospects accompanied by hospitable changes to climatic conditions make way for growing economic ambitions on the Barents Sea, so arises the urgency to provide proportionate measures of safety and support for the increased human presence and activity in this hostile environment.

This project focuses on the architectural development of an offshore Search and Rescue station on the Barents Sea, as well as the proposal for an accompanying communication and surveillance network, with the intention of providing a viable solution for areas of activity which currently suffer from a lack of sufficient rescue service coverage.

The station would be capable of aeronautical and maritime rescue and recovery response, while providing supplies to extend the range and active presence of patrol ships.

RUSSIAN BORDER OIL TRANSPORT CARGO SHIPPING FISHING AREAS GAS AND OIL RESERVES MONITORING BUOY SEARCH AND RESCUE STATION

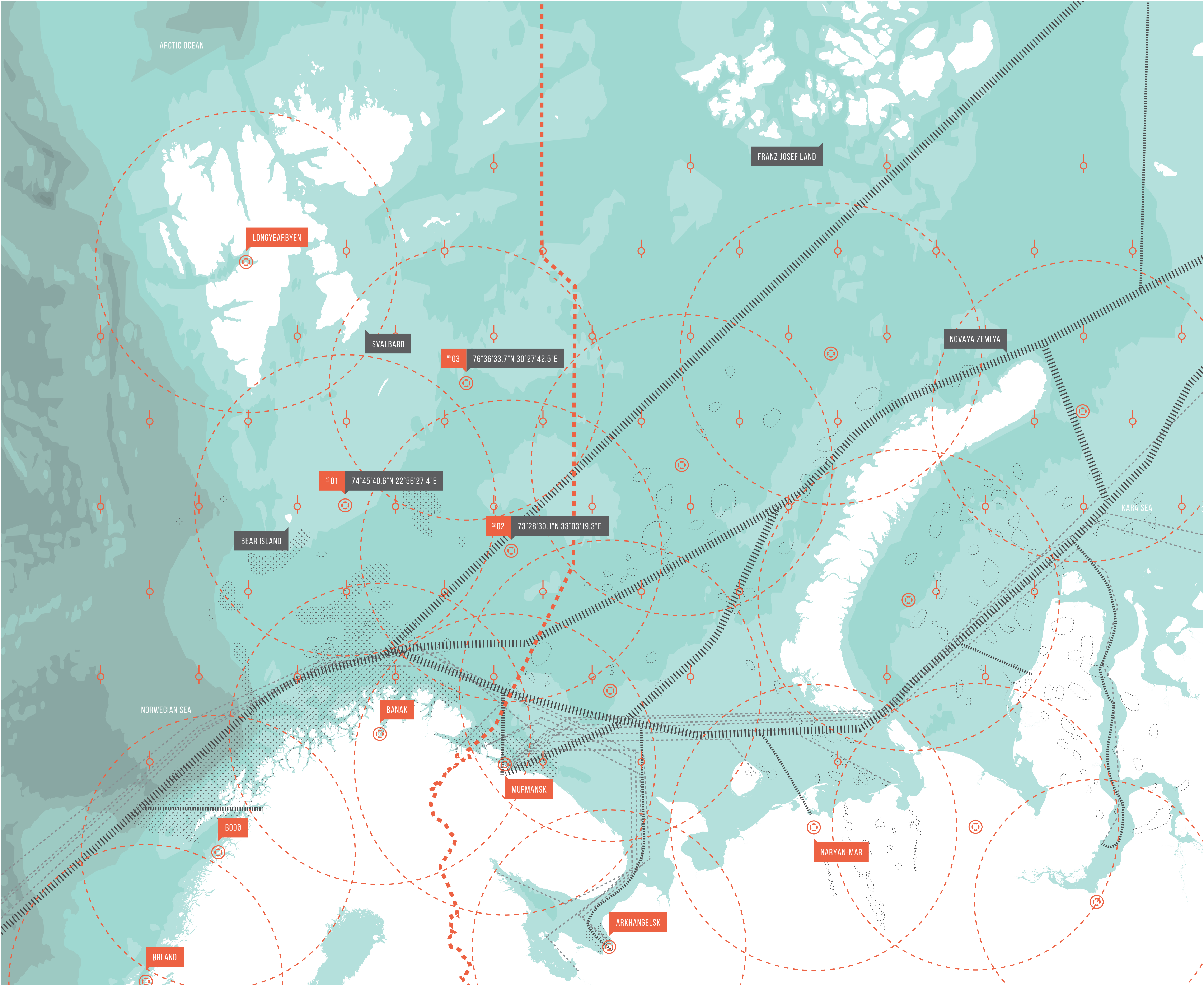

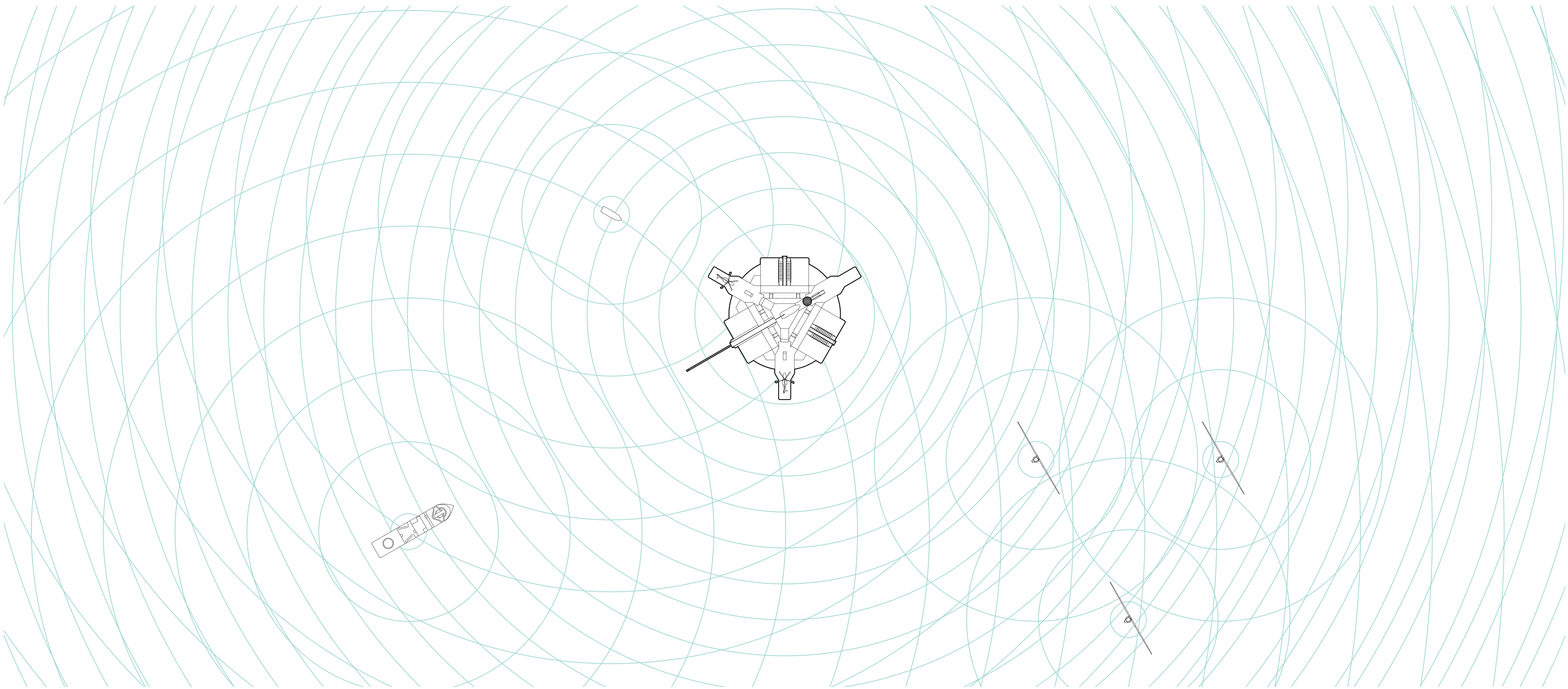

# SITE PLAN

Station with support ship and turbines  
1:2000

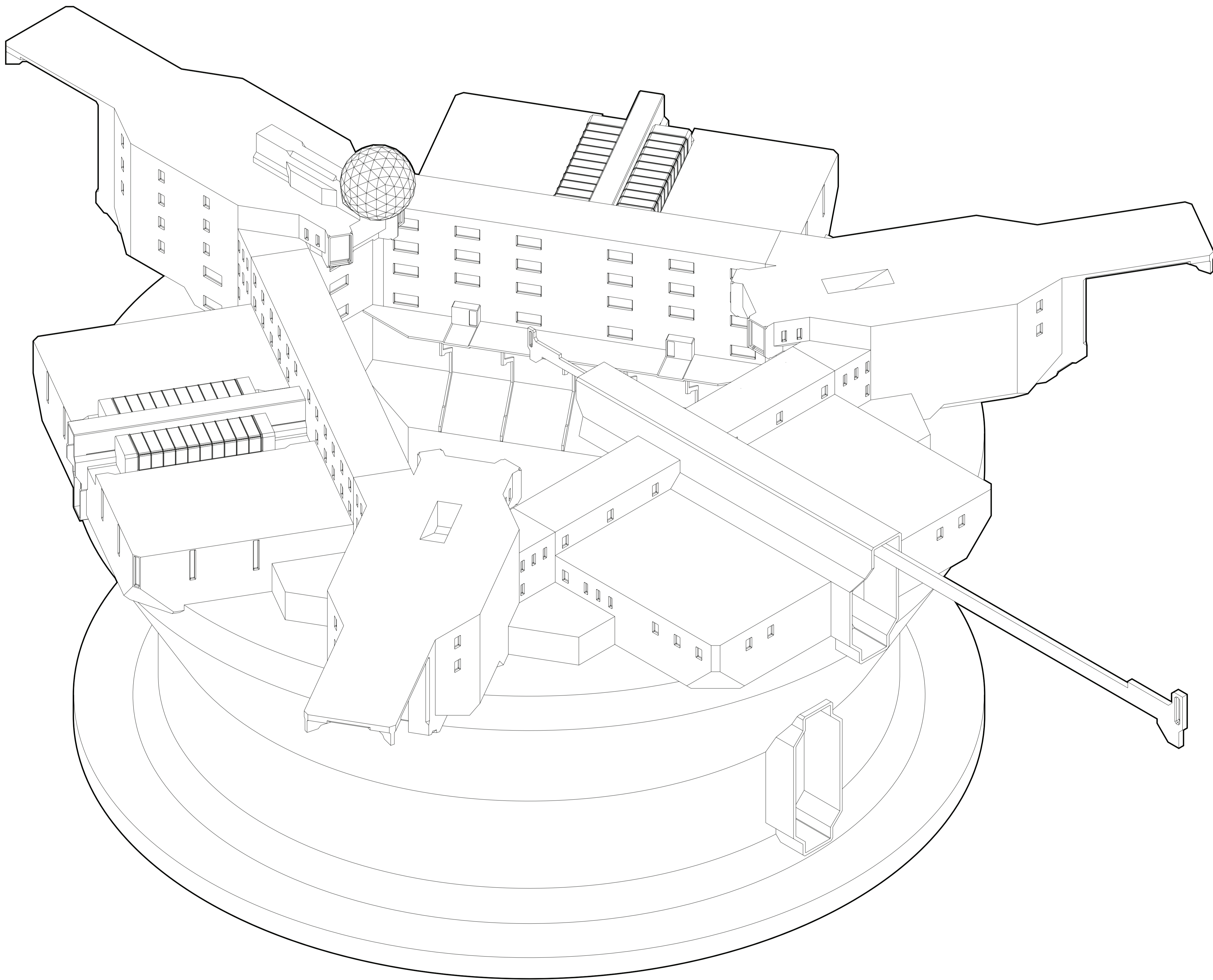

Isometric overview

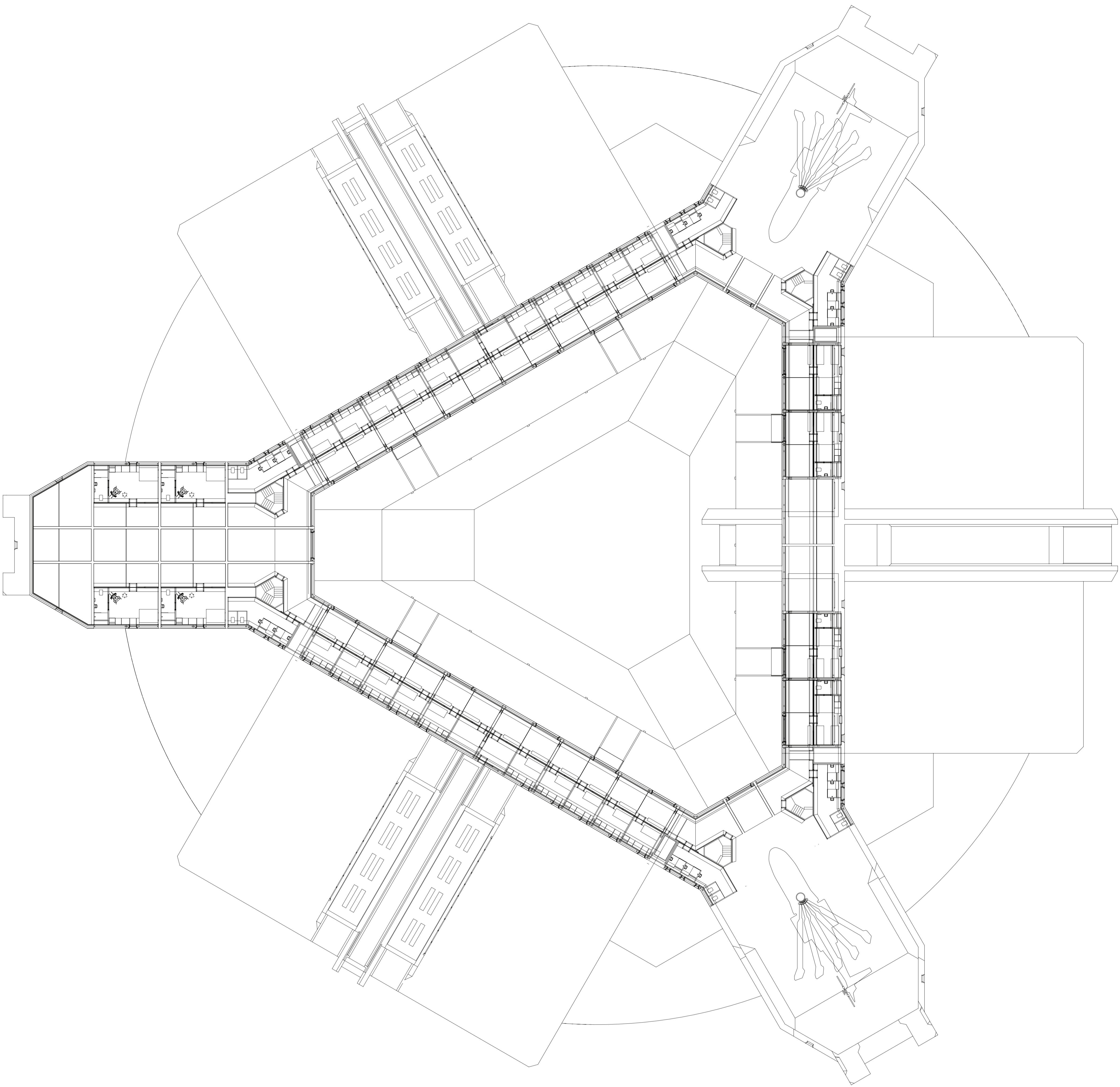

FLOOR PLAN  
1:200

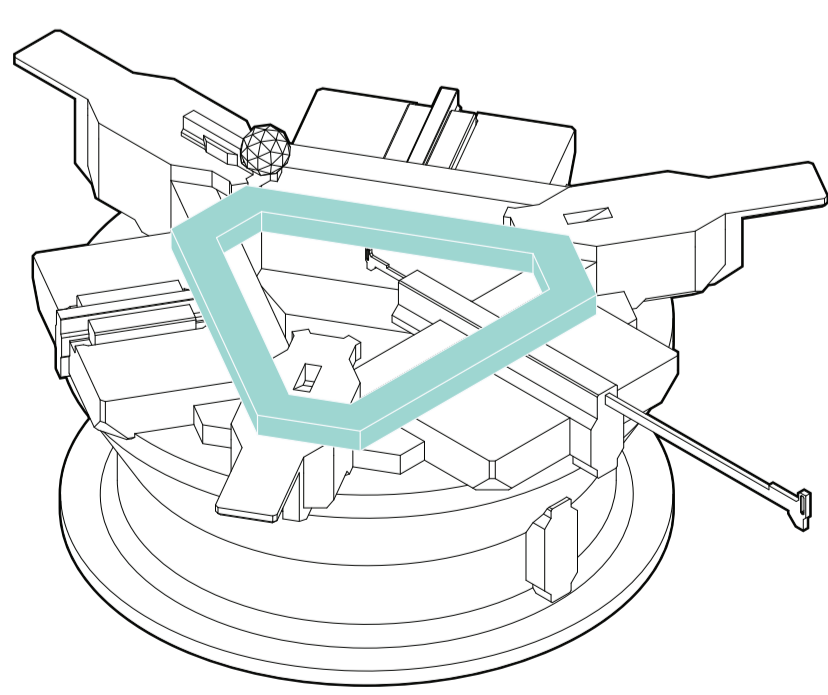

MAIN HALLWAY  
Complete circulation on the main floor

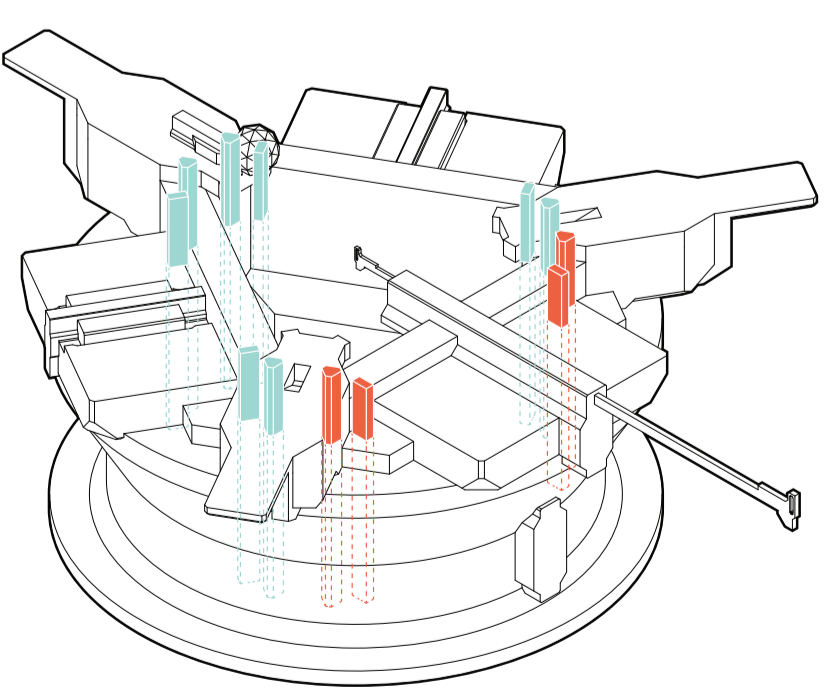

VERTICAL CONNECTIONS  
Common use and operational lifts and stairs

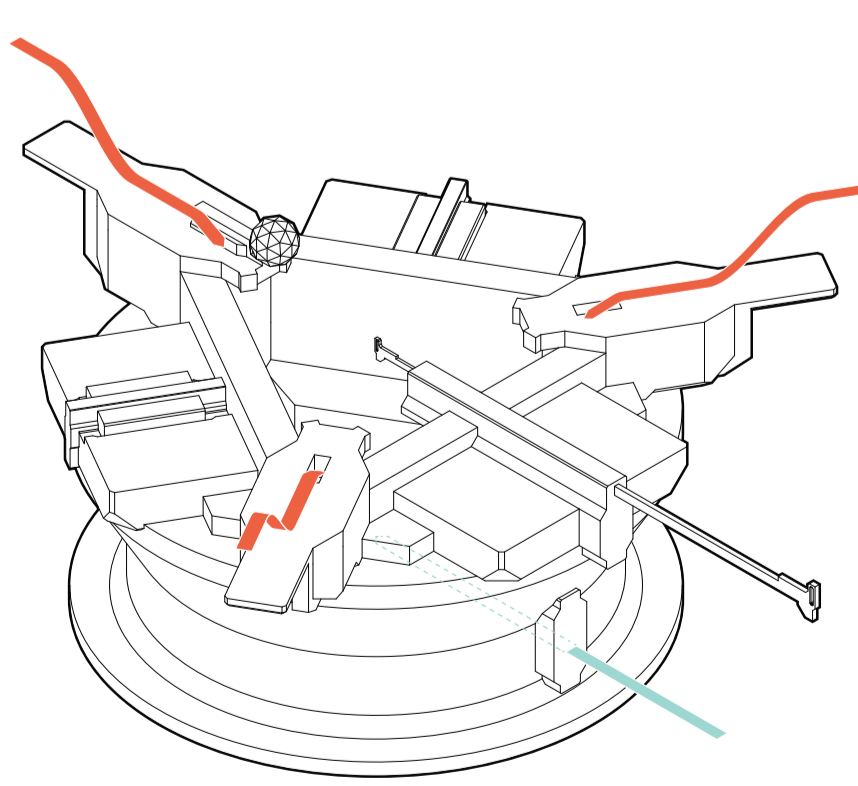

ACCESS  
Air and sea

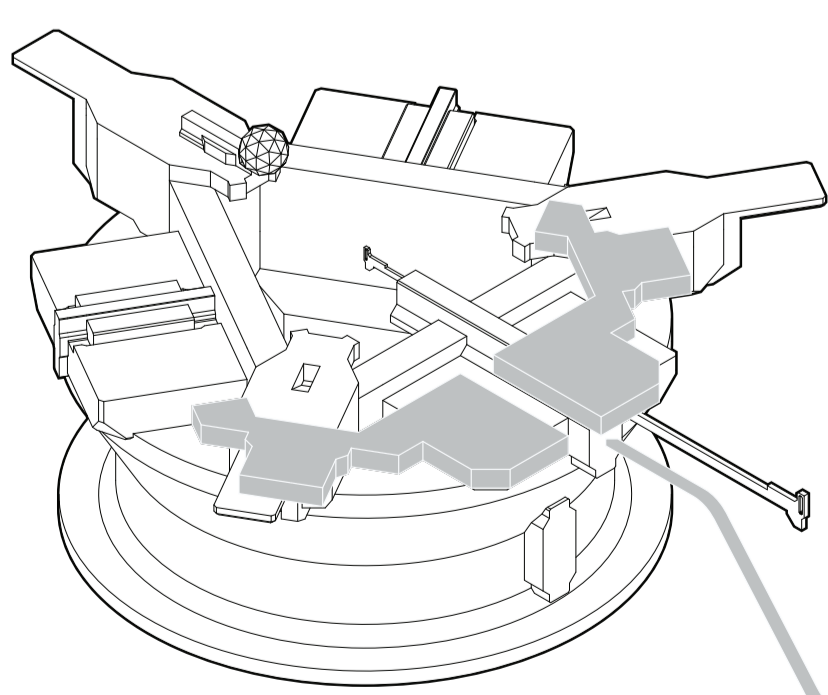

STORAGE  
Provisions holds and circulation

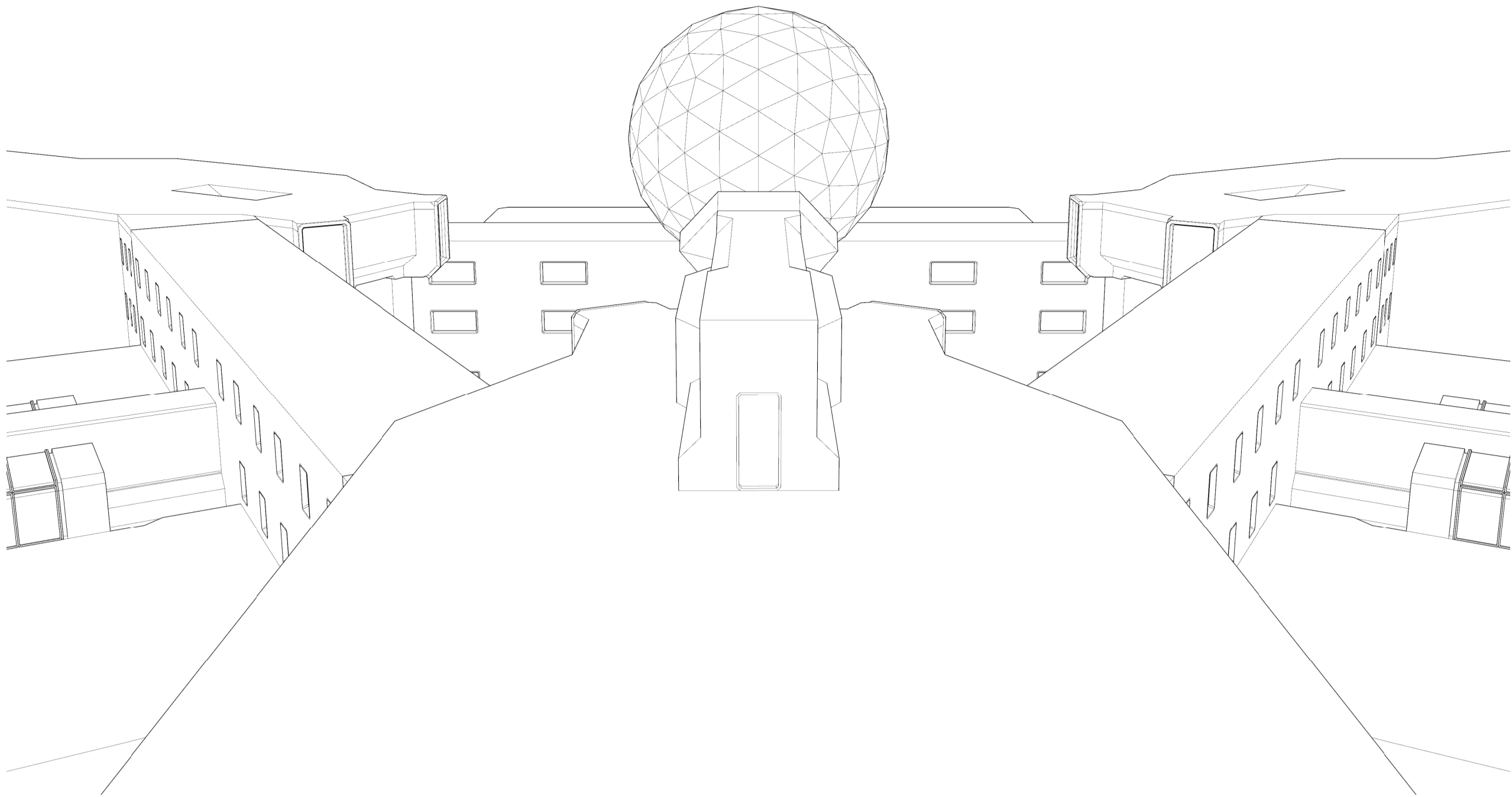

Exterior view  
visiting deck

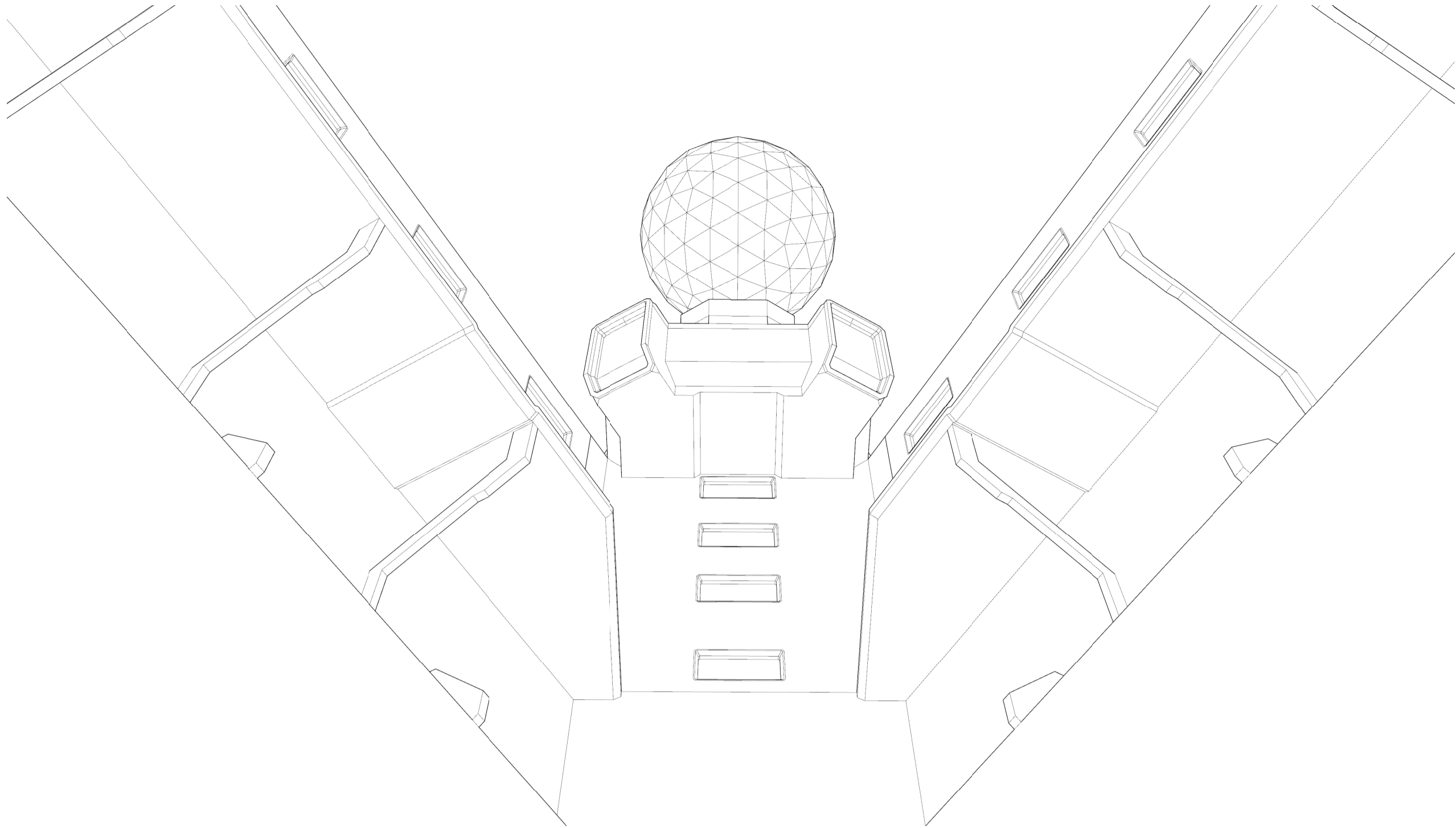

Exterior view  
moonwell

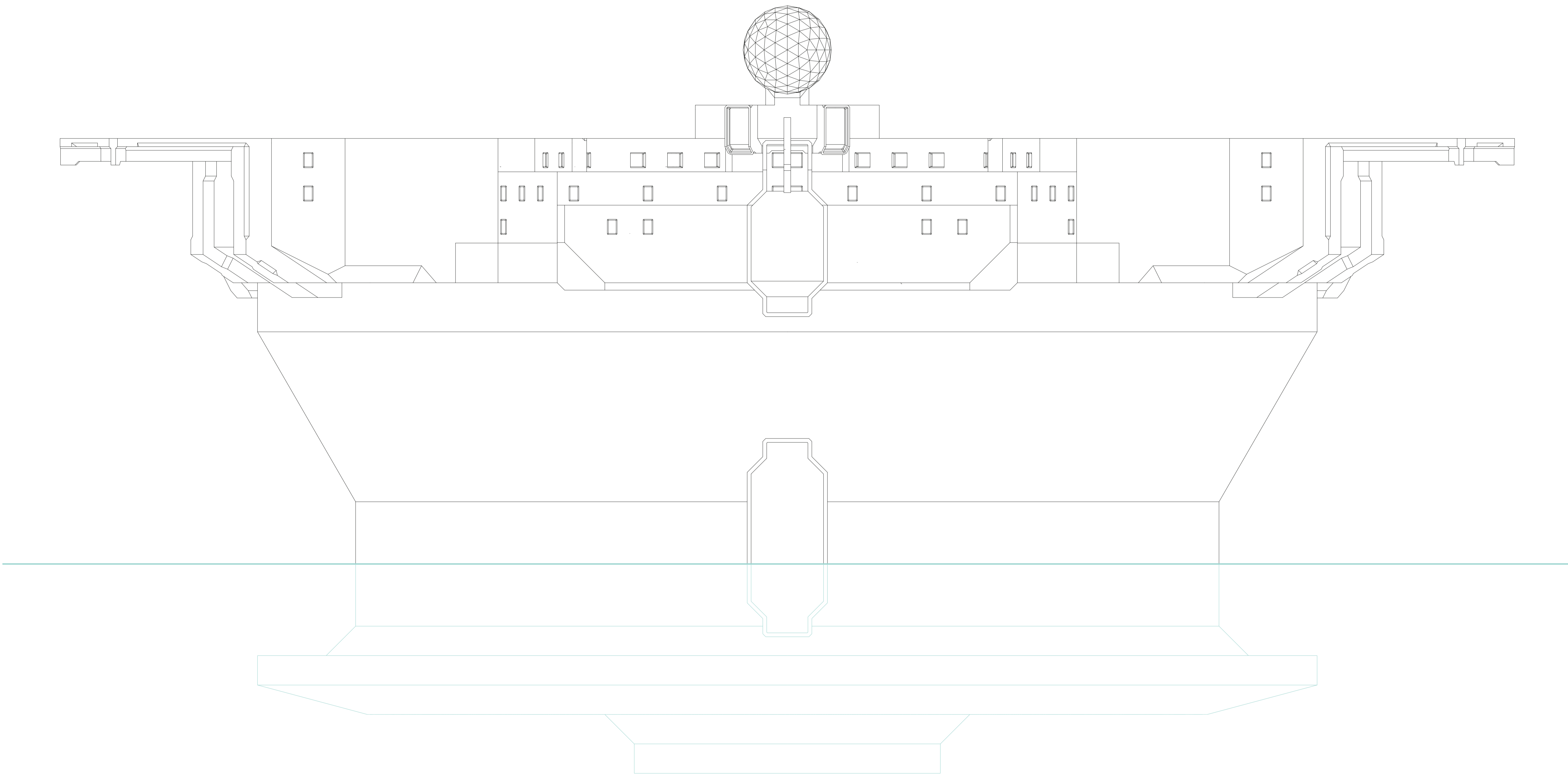

ELEVATION  
1:200

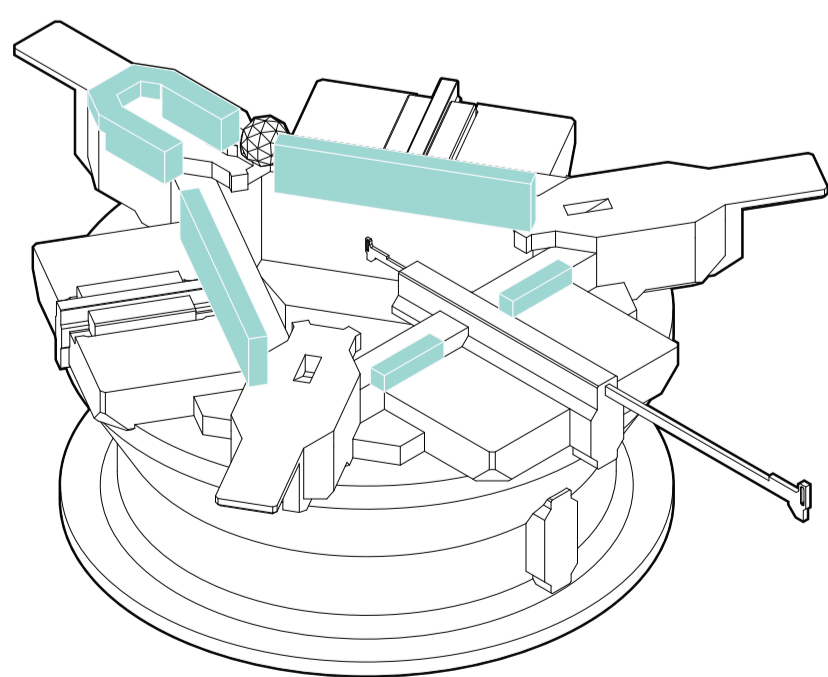

LIVING QUARTERS  
Housing for crew and rescues

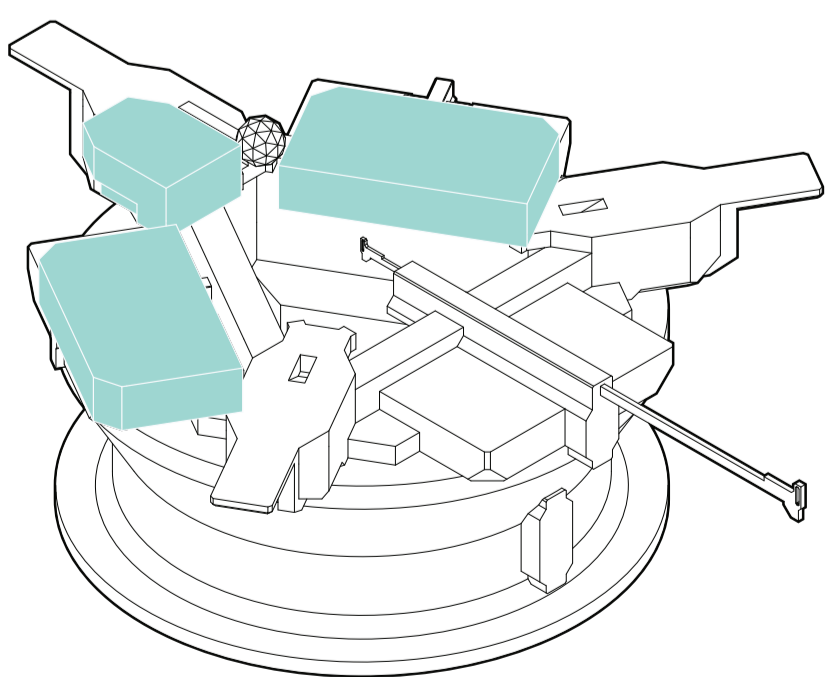

COMMON SPACES  
Leisure, dining and training

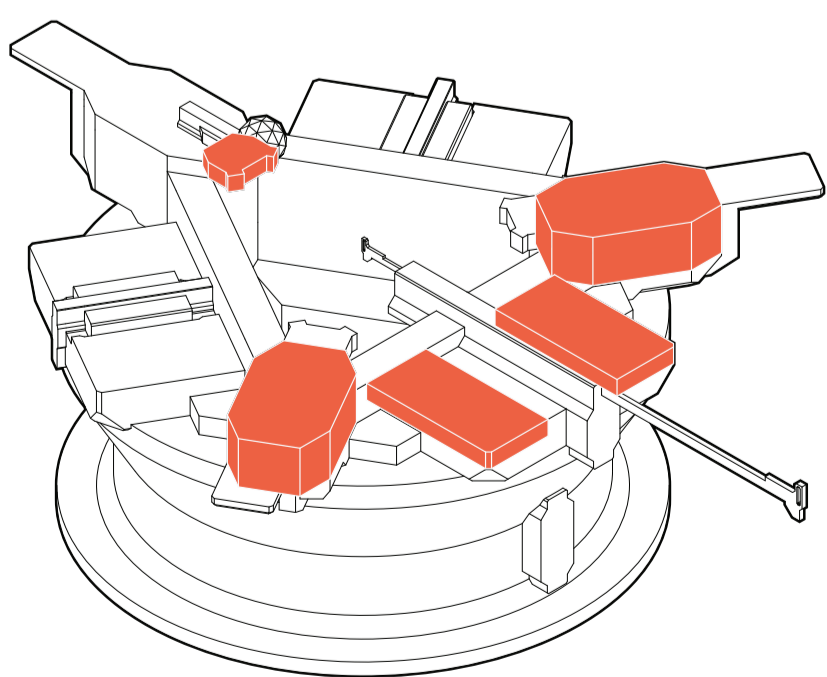

OPERATIONS  
Emergency response and reception

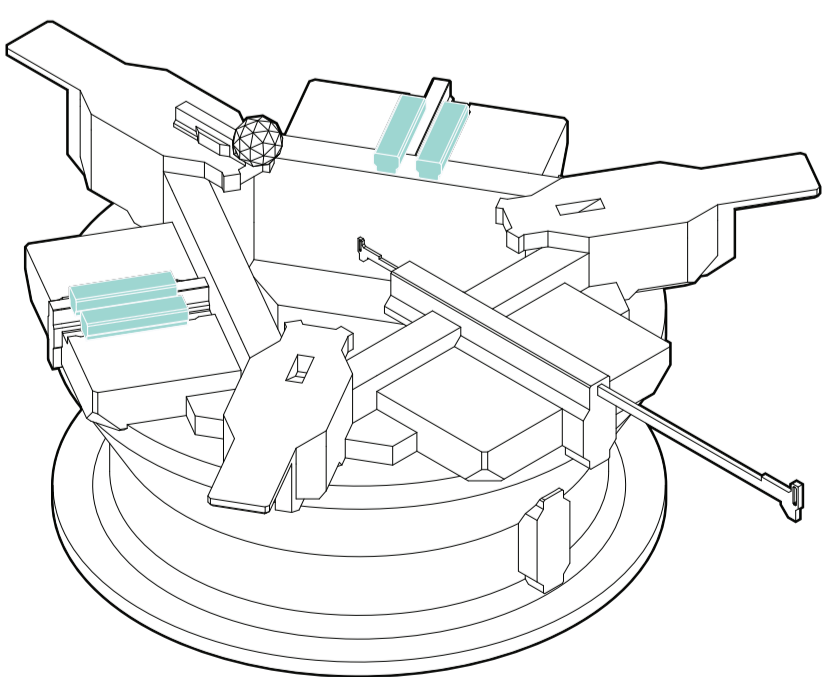

HYDROPONICS  
Fresh food production

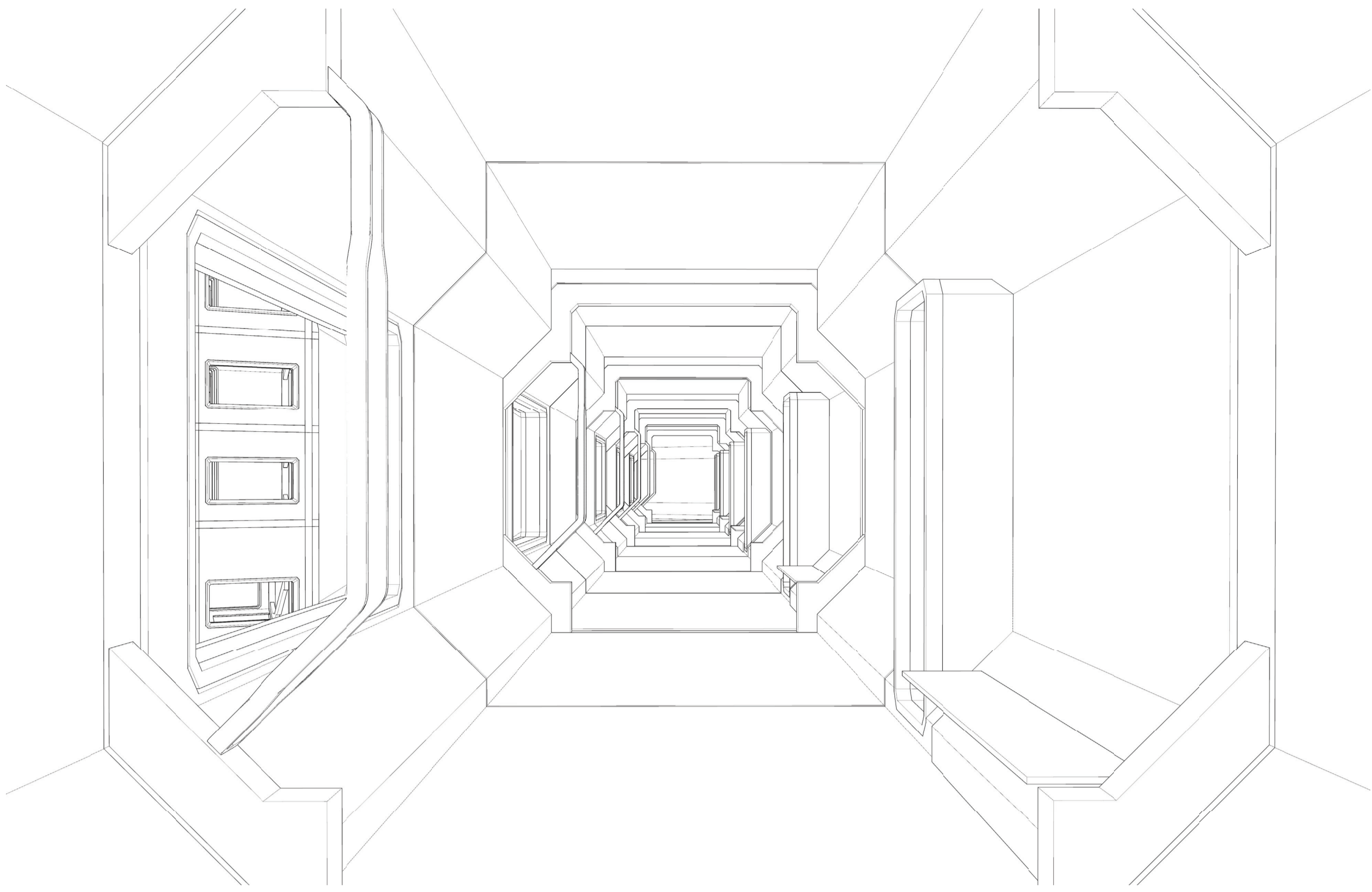

Interior view  
*living quarters hallway*

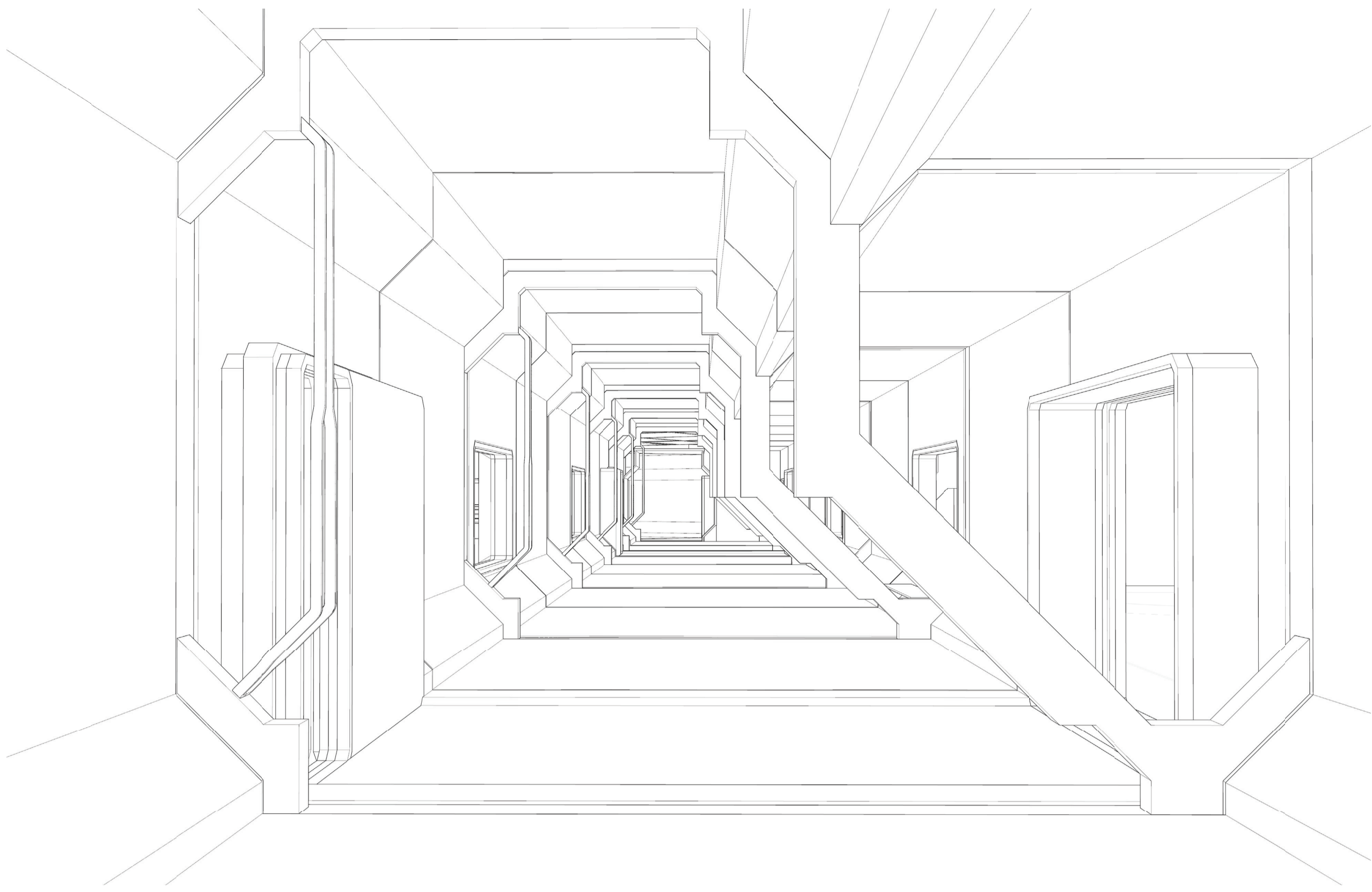

Interior view  
*main hallway*

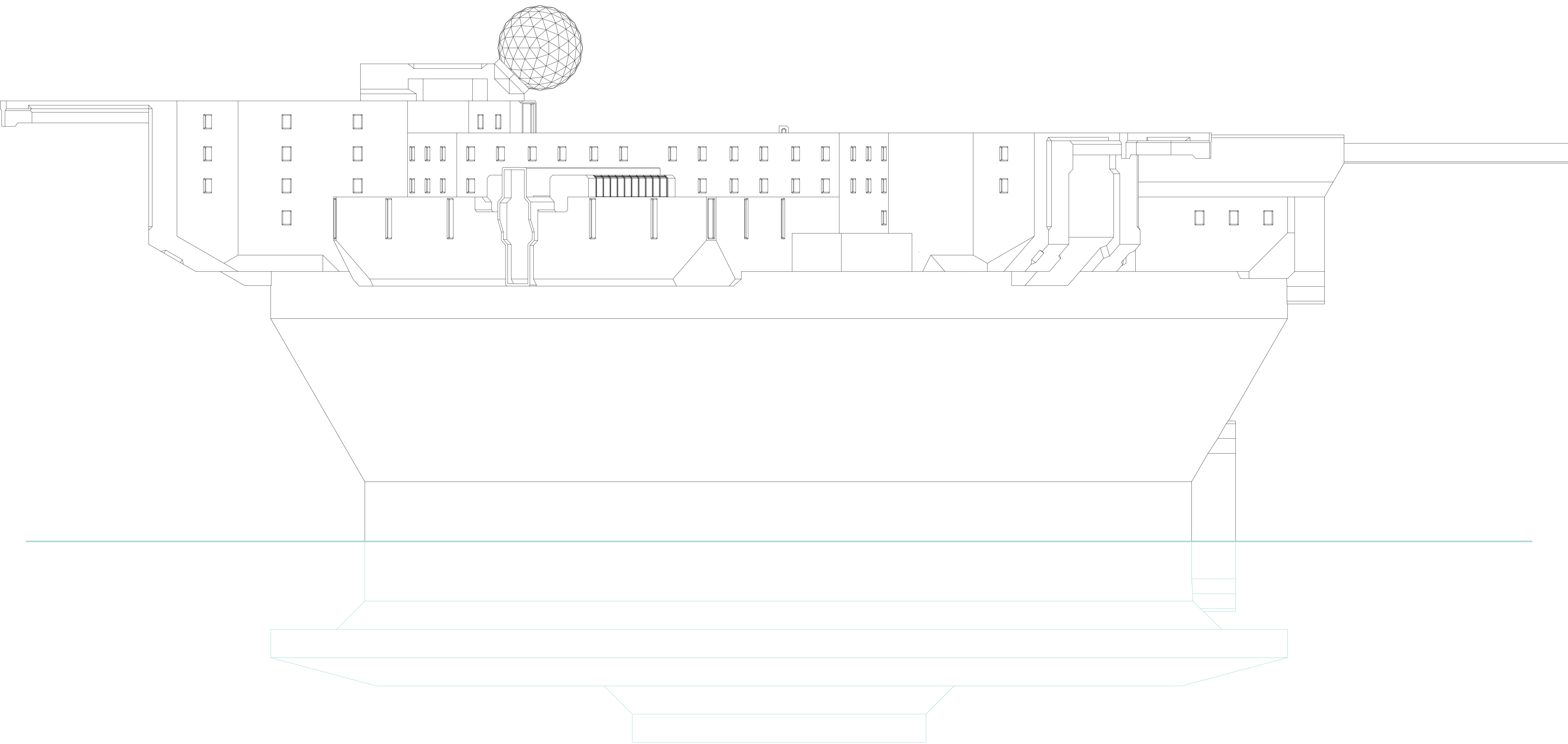

ELEVATION  
1:500

INTERIOR ELEMENTS

The Barents chair and coffee table

