

BARENTS SUPPORT NETWORK

Offshore Search and Rescue Initiative

Diploma candidate

Uku Miller

CONTEXT

A matter of perspective



Buckminster Fuller's
Dymaxion Projection
of the World Ocean



Buckminster Fuller's
Dymaxion Globe

AREA
1,405,000 km²
AVERAGE DEPTH
230 m
MAXIMUM DEPTH
600 m
GAS RESERVES
30% of the world
OIL RESERVES
25% of the world
POPULATION
5.5 million

SITE

The Barents Region

CLIMATE
subarctic
AVERAGE WINTER AIR TEMPERATURE
-25°C N / -5°C SW
AVERAGE SUMMER AIR TEMPERATURE
0°C N / 10°C SW
AVERAGE SUMMER AIR TEMPERATURE
0°C N / 10°C SW
ANNUAL PRECIPITATION
500 mm S / 250 mm N
POLAR NIGHTTIME
70-110 days / year
POLAR DAYTIME
70-130 days / year

INTRODUCTION

Project overview

As newfound prospects accompanied by hospitable changes to climatic conditions make way for growing economic ambitions on the Barents Sea, so arises the urgency to provide proportionate measures of safety and support for the increased human presence and activity in this hostile environment.

This project focuses on the architectural development of an offshore Search and Rescue station on the Barents Sea, as well as the proposal for an accompanying communication and surveillance network, with the intention of providing a viable solution for areas of activity which currently suffer from a lack of sufficient rescue service coverage.

The station would be capable of aeronautical and maritime rescue and recovery response, while providing supplies to extend the range and active presence of patrol ships.

RUSSIAN BORDER OIL TRANSPORT CARGO SHIPPING FISHING AREAS GAS AND OIL RESERVES MONITORING BUOY SEARCH AND RESCUE STATION

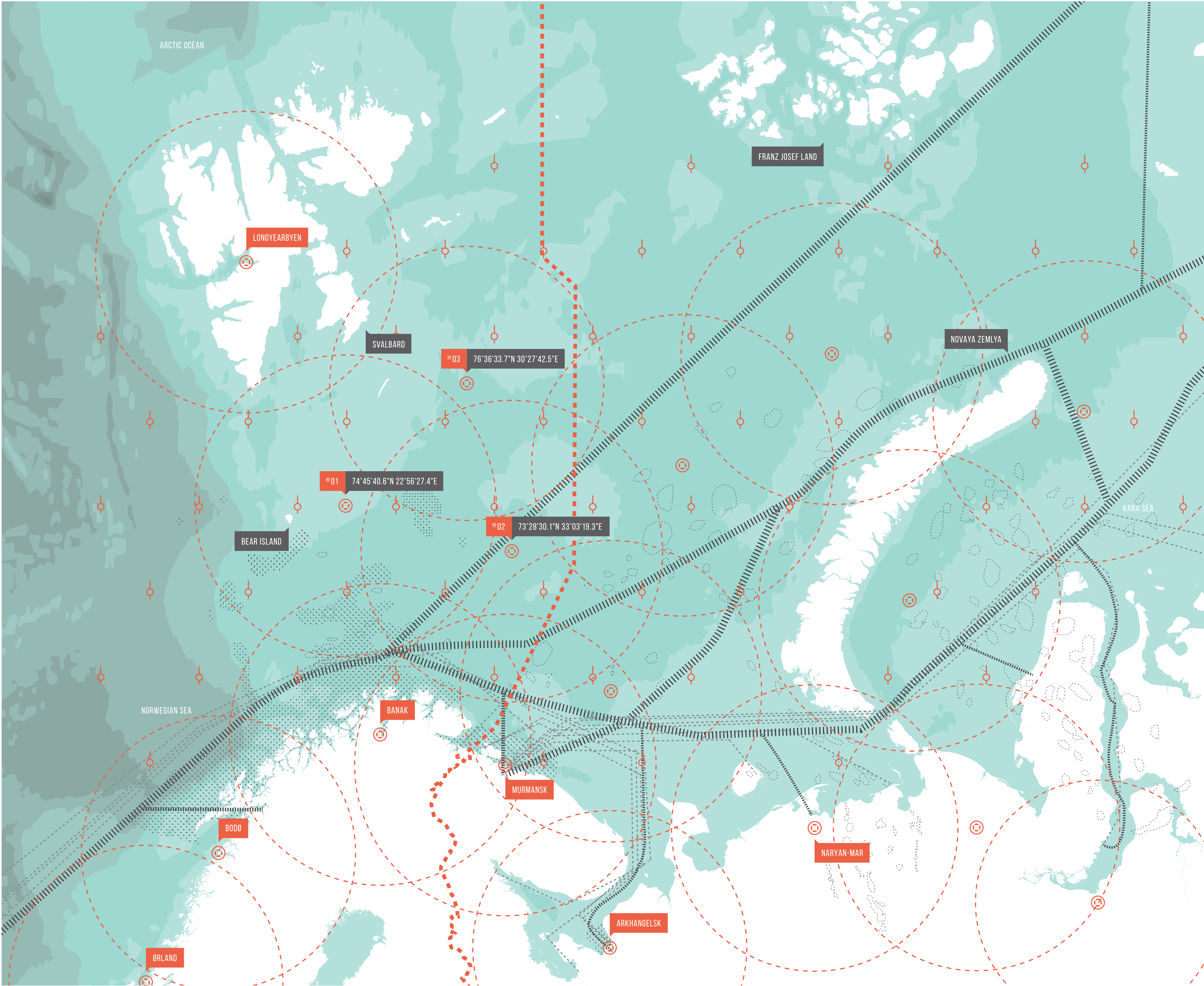

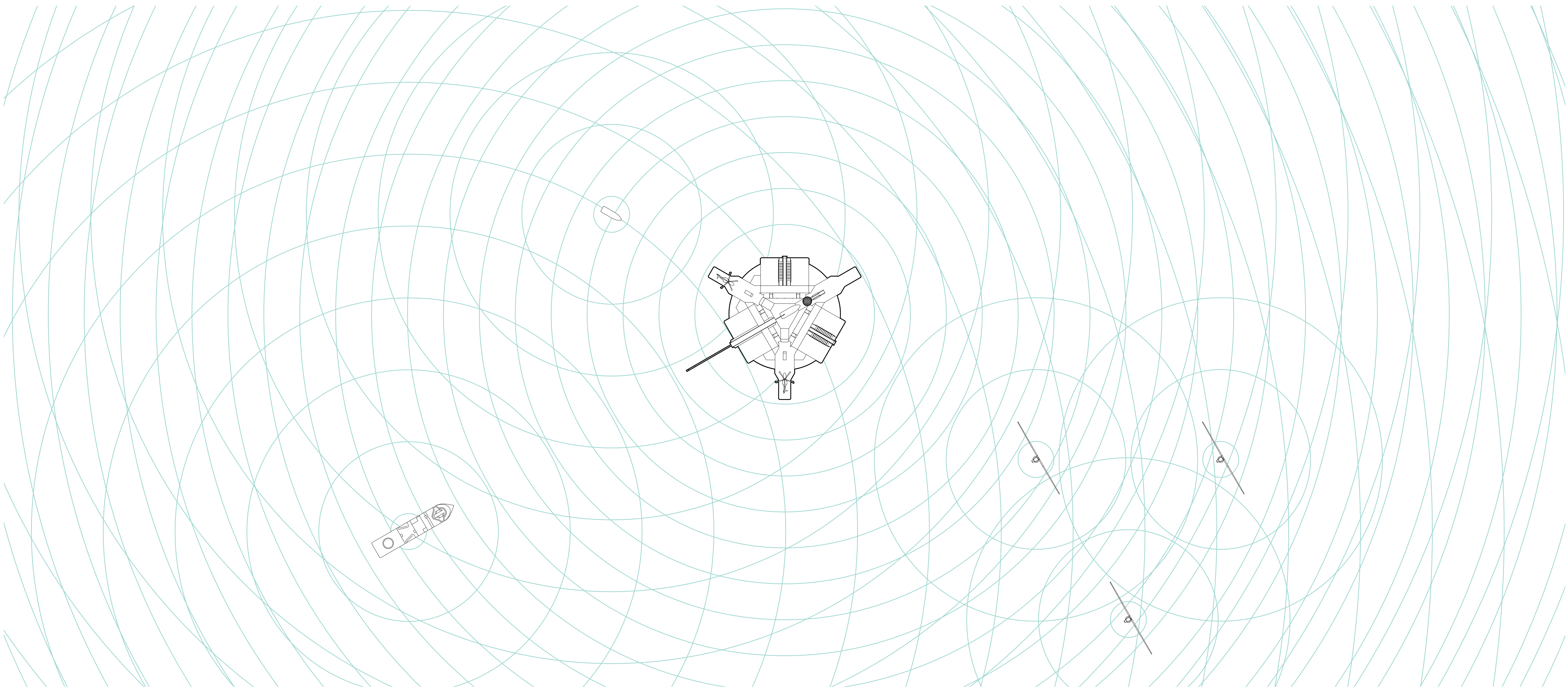

SITE PLAN

Station with support ship and turbines
1:2000

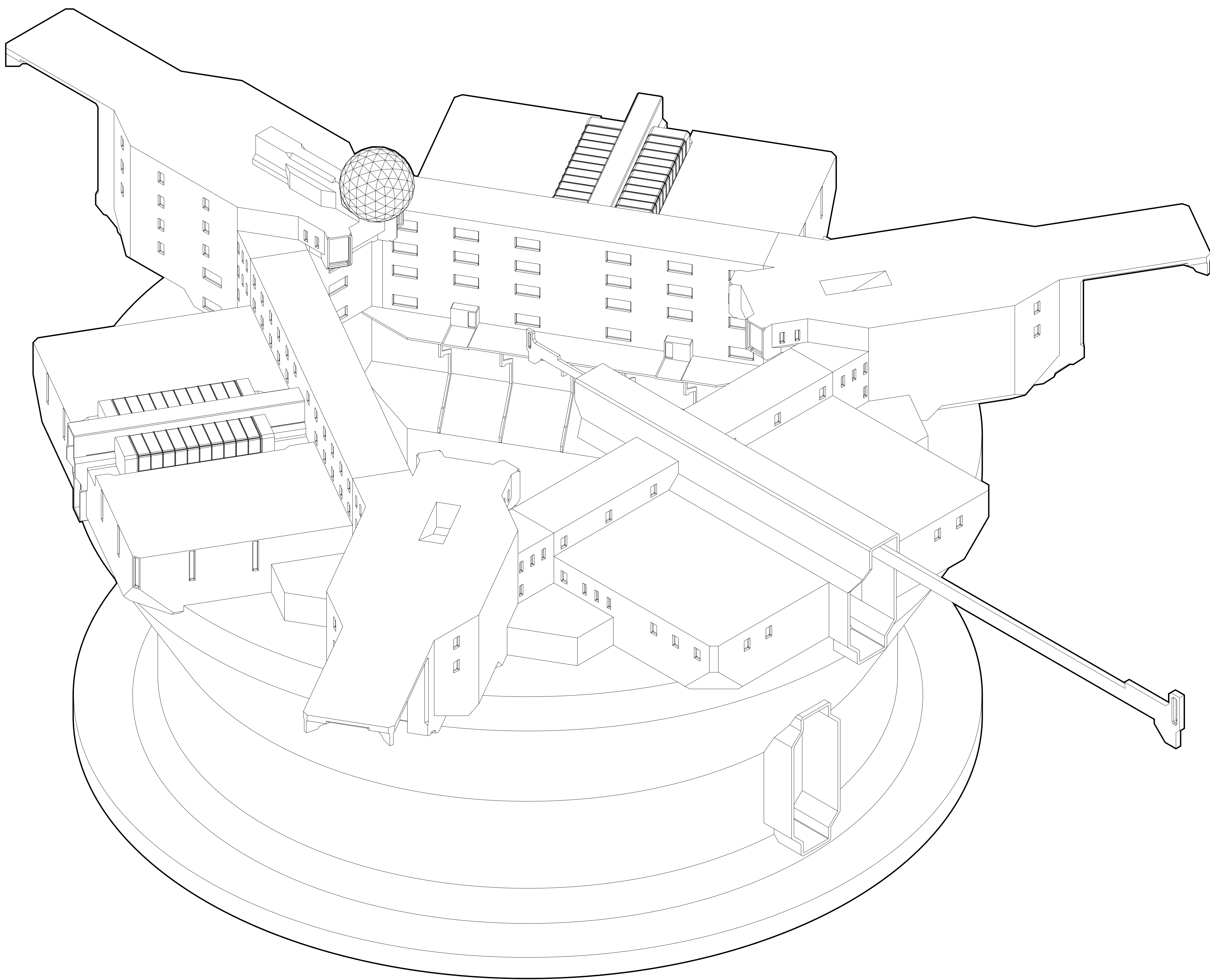

Isometric overview

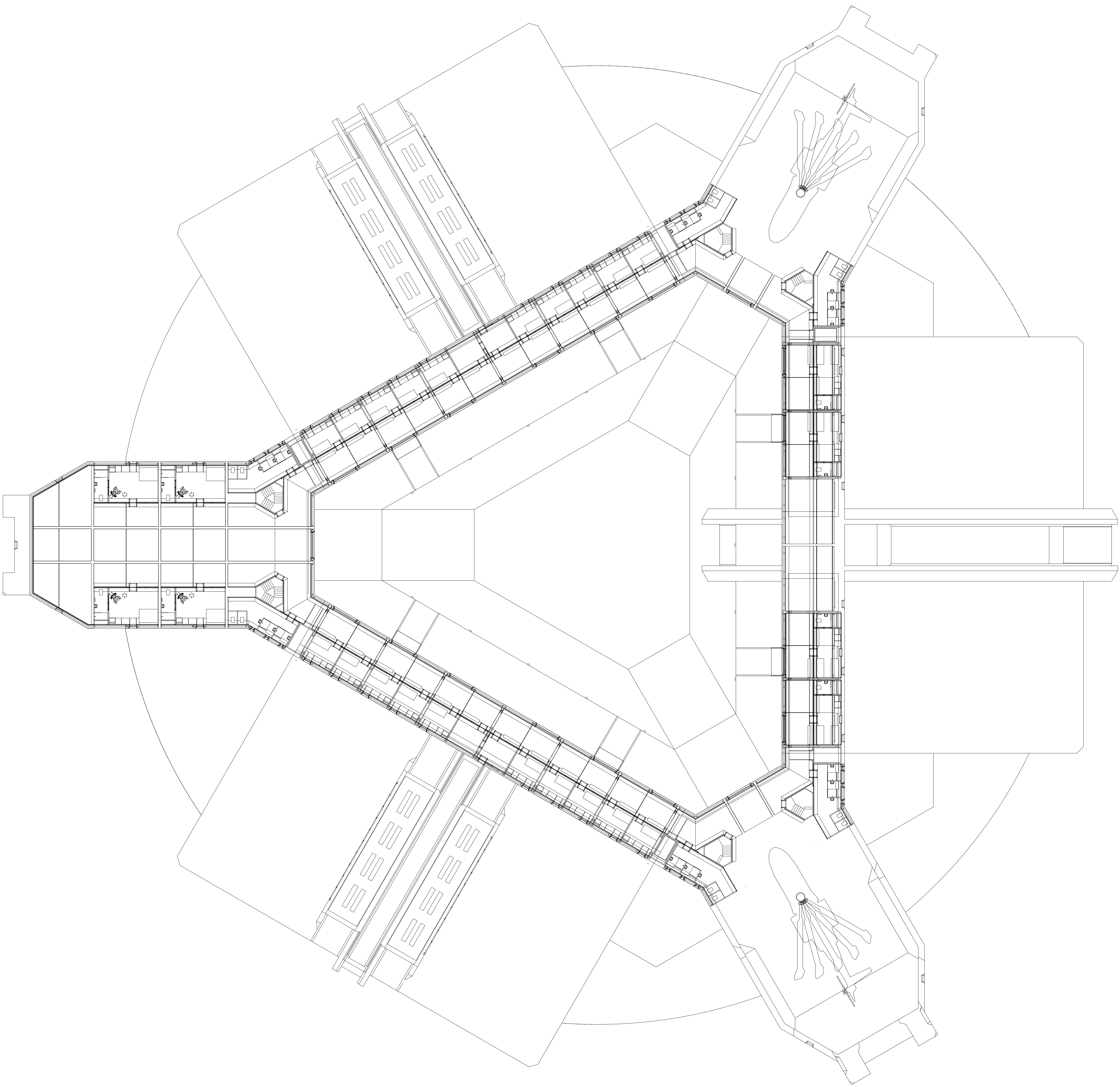

FLOOR PLAN
1:200

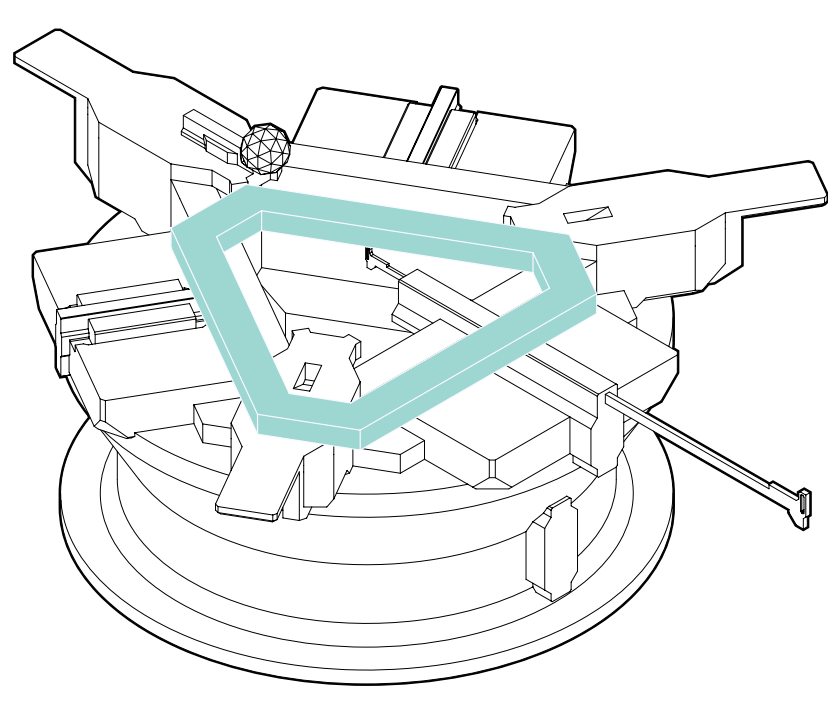

MAIN HALLWAY
Complete circulation on the main floor

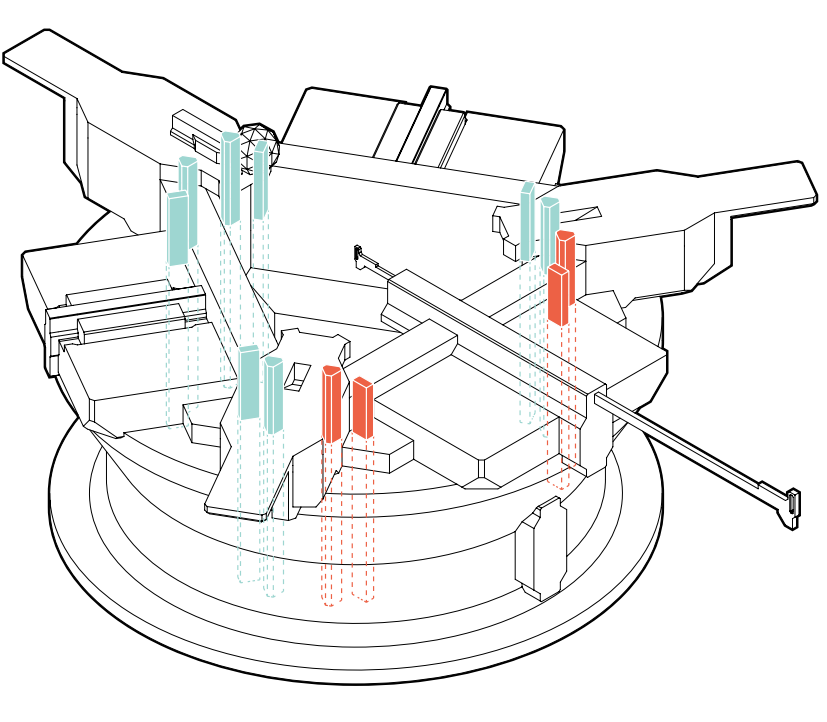

VERTICAL CONNECTIONS
Common use and operational lifts and stairs

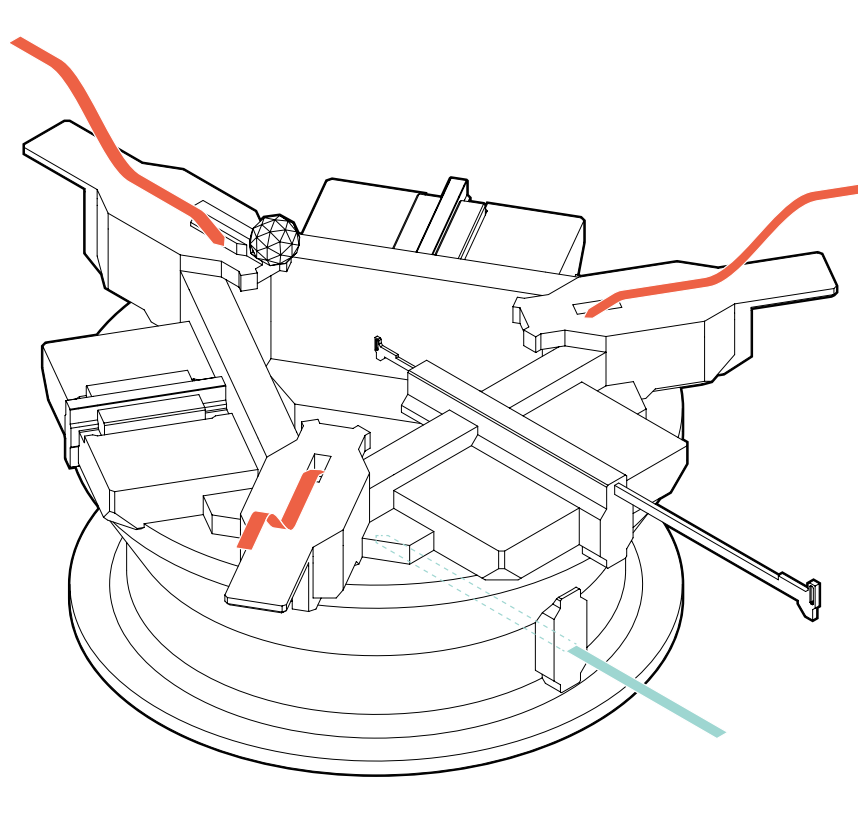

ACCESS
Air and sea

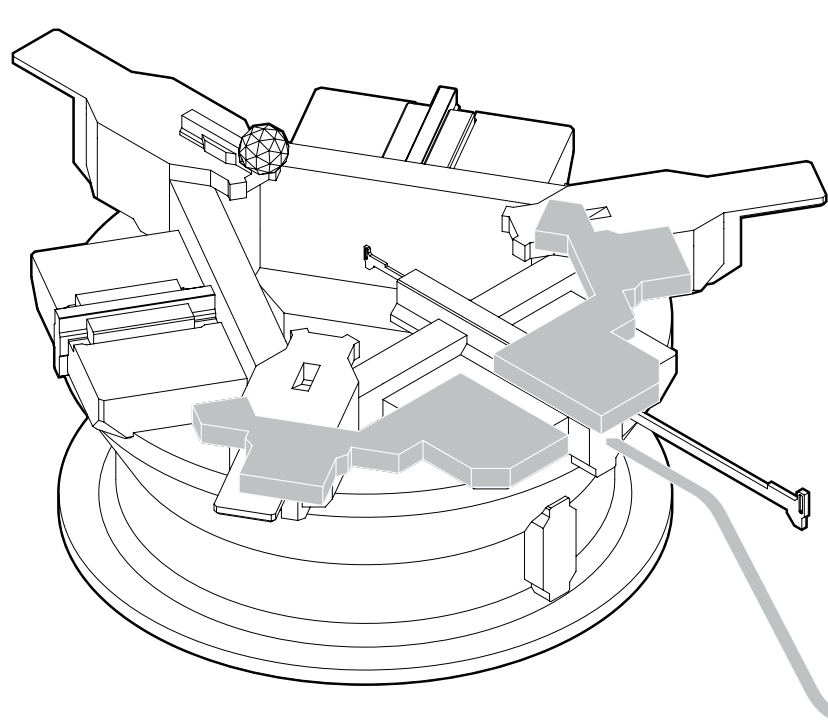

STORAGE
Provisions holds and circulation

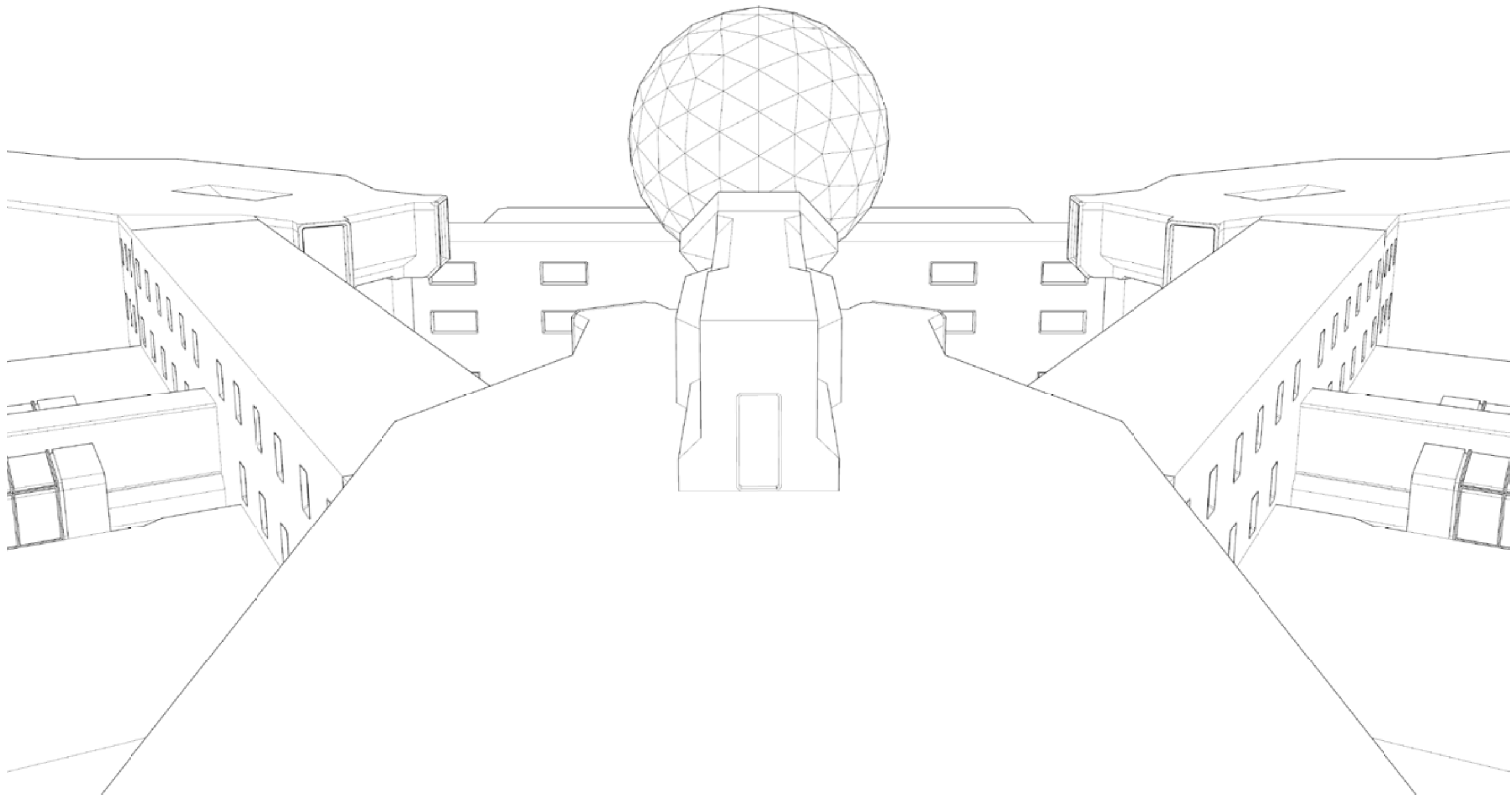

Exterior view
visiting deck

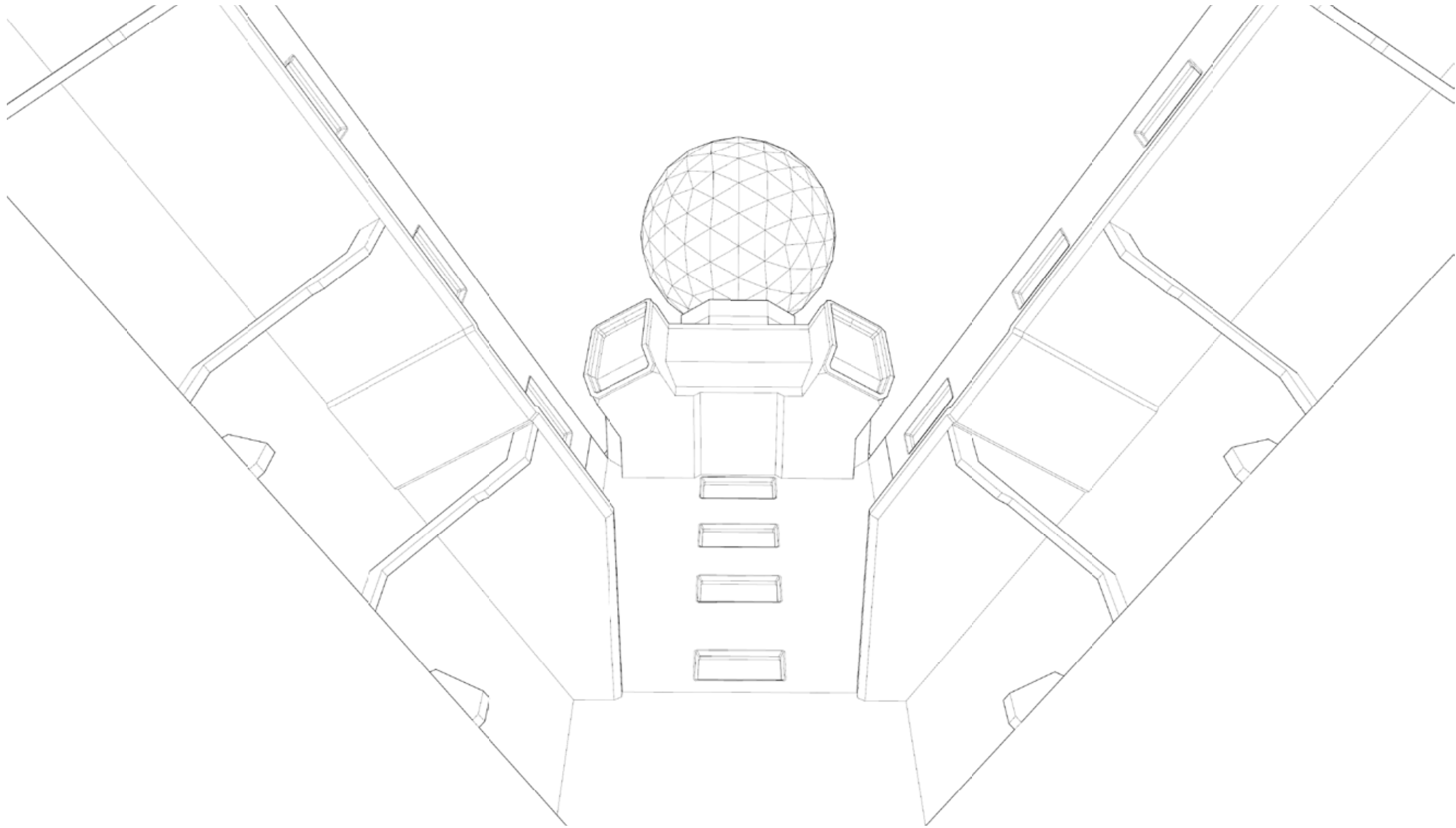

Exterior view
moonwell

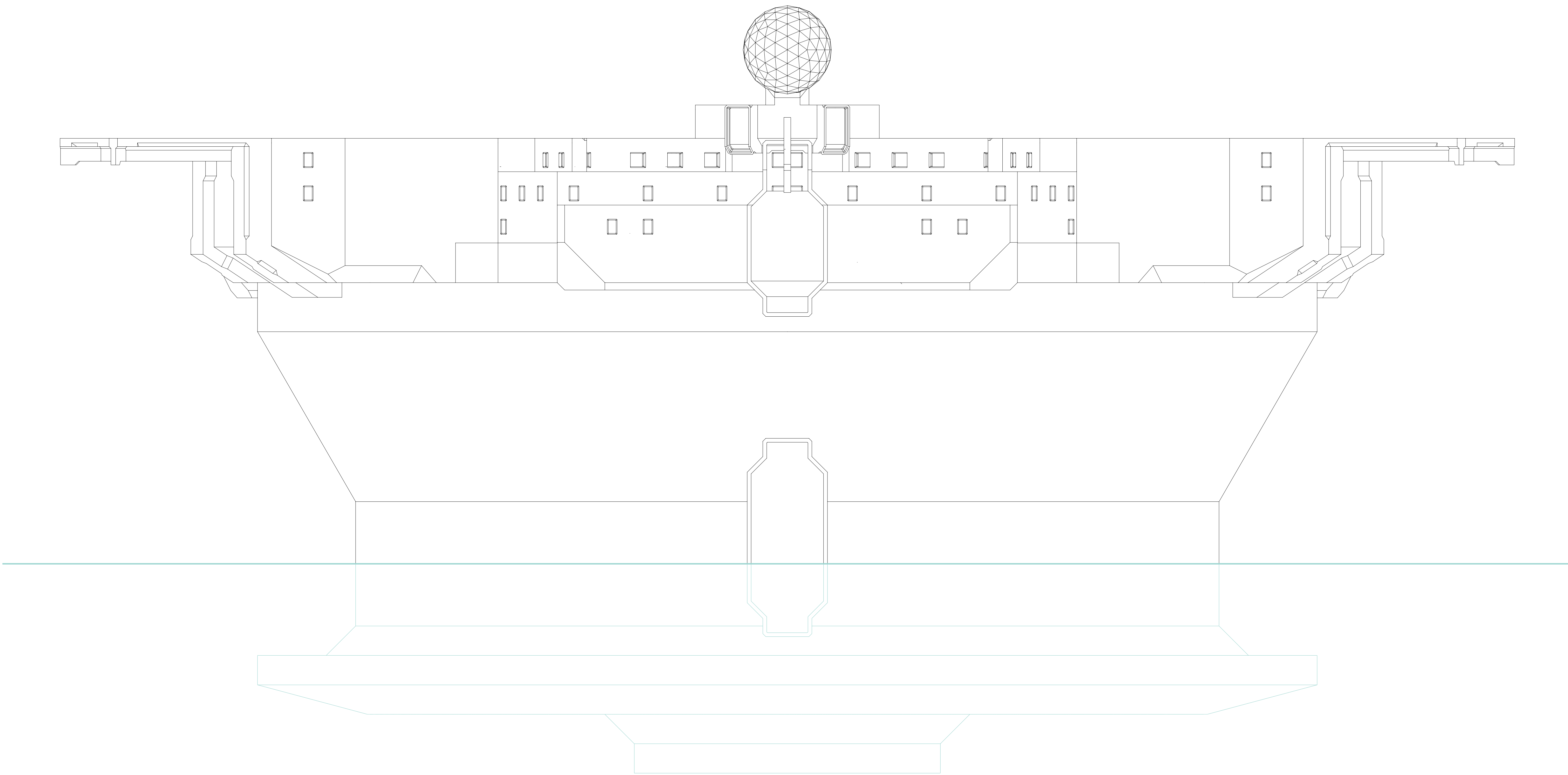

ELEVATION
1:200

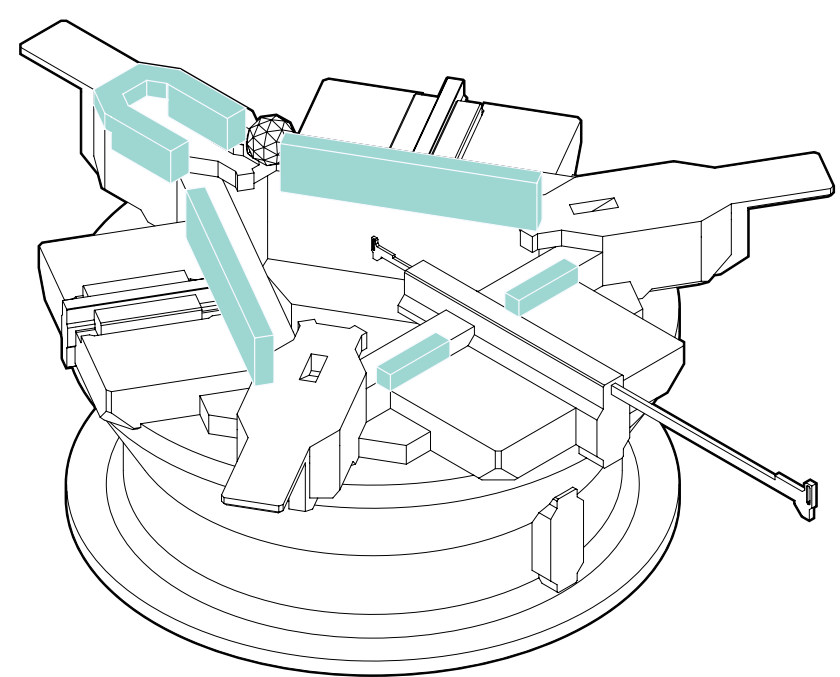

LIVING QUARTERS
Housing for crew and rescues

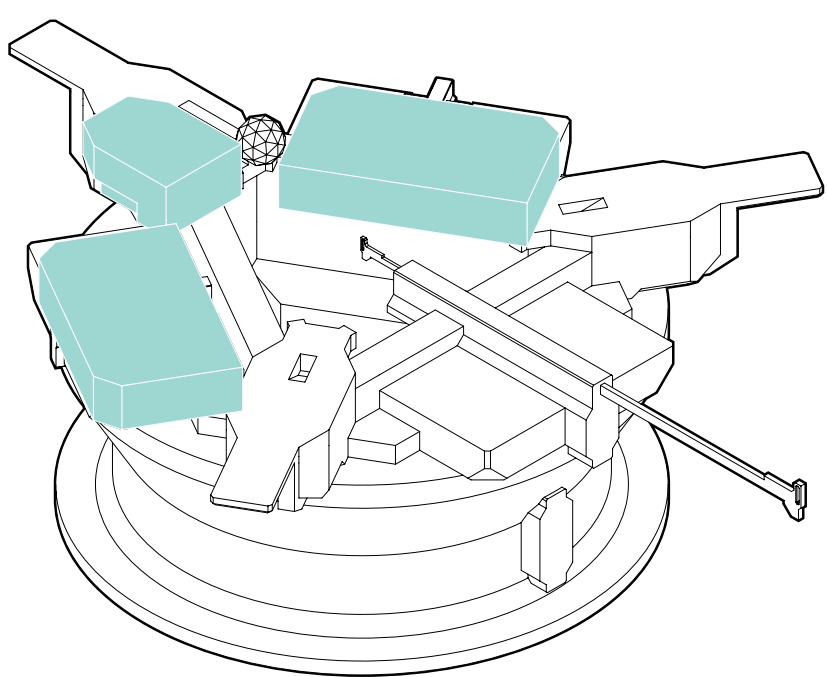

COMMON SPACES
Leisure, dining and training

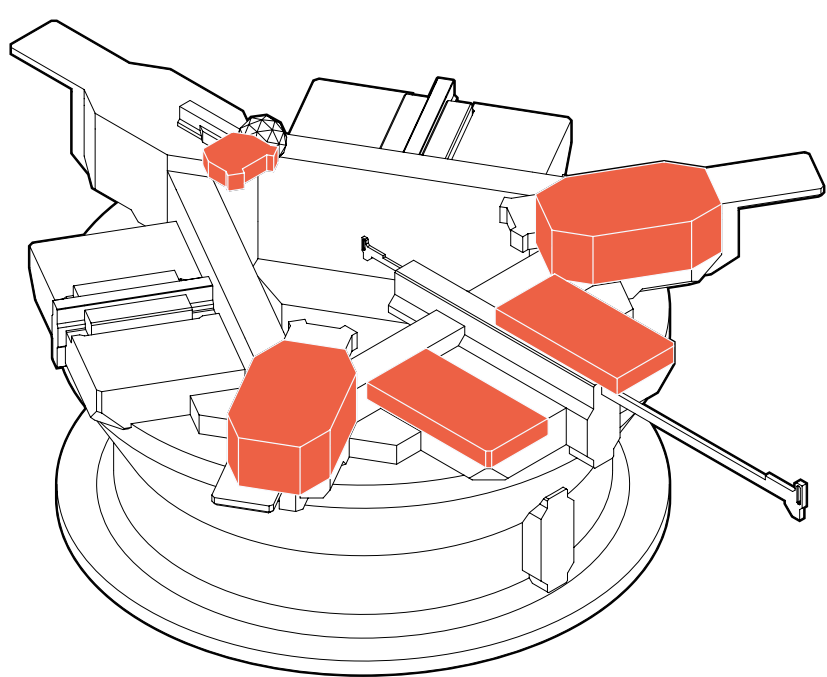

OPERATIONS
Emergency response and reception

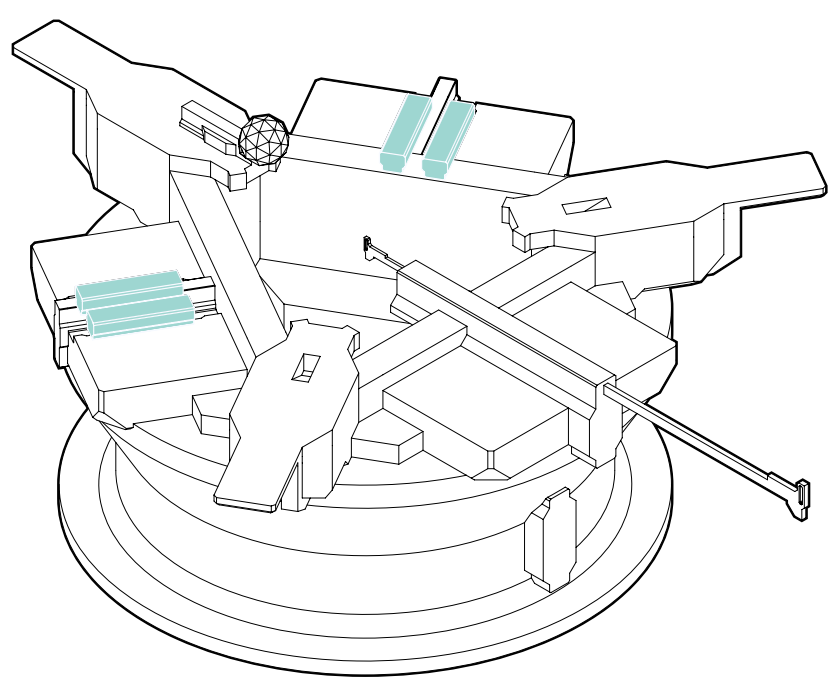

HYDROPONICS
Fresh food production

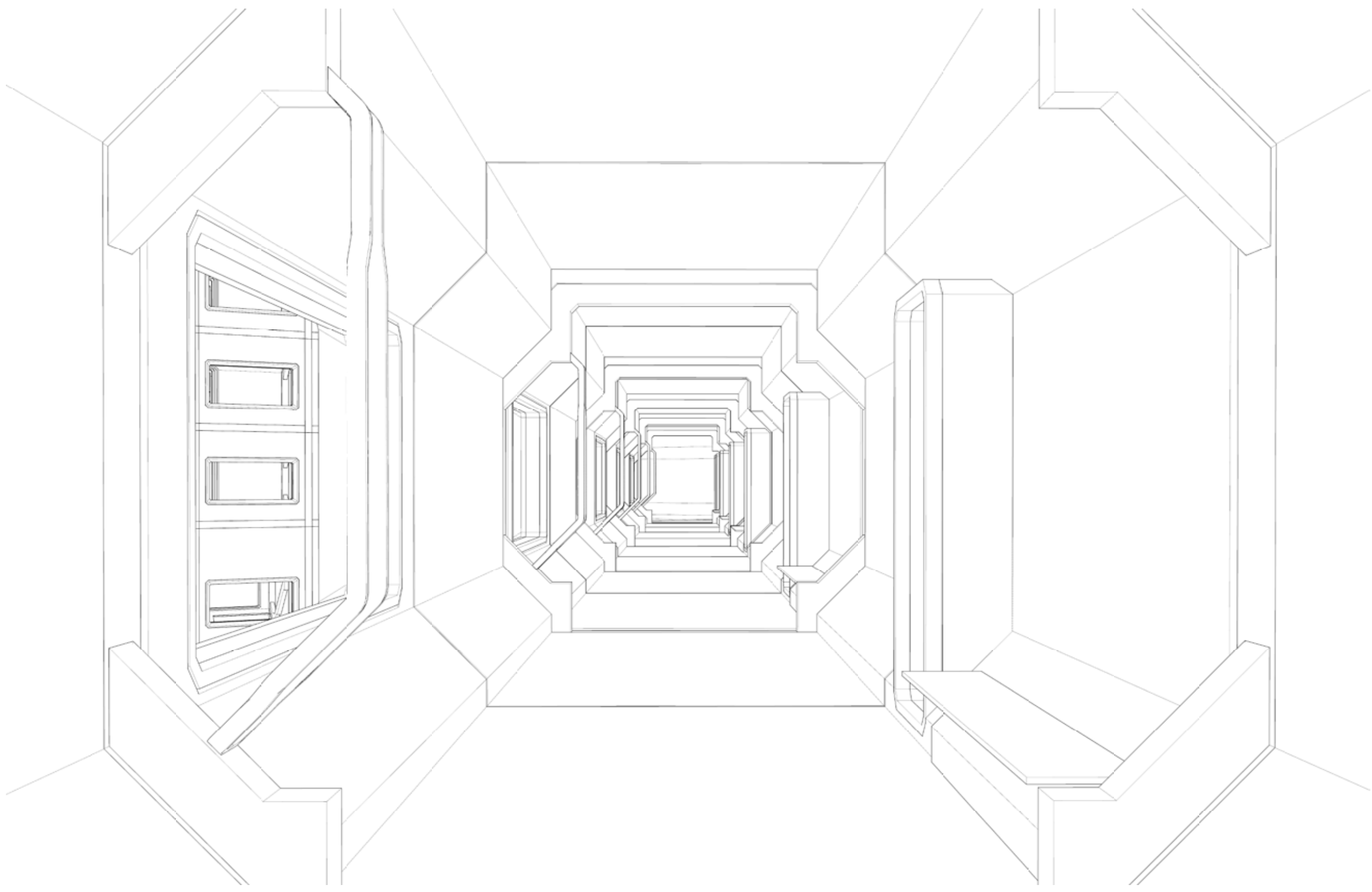

Interior view
living quarters hallway

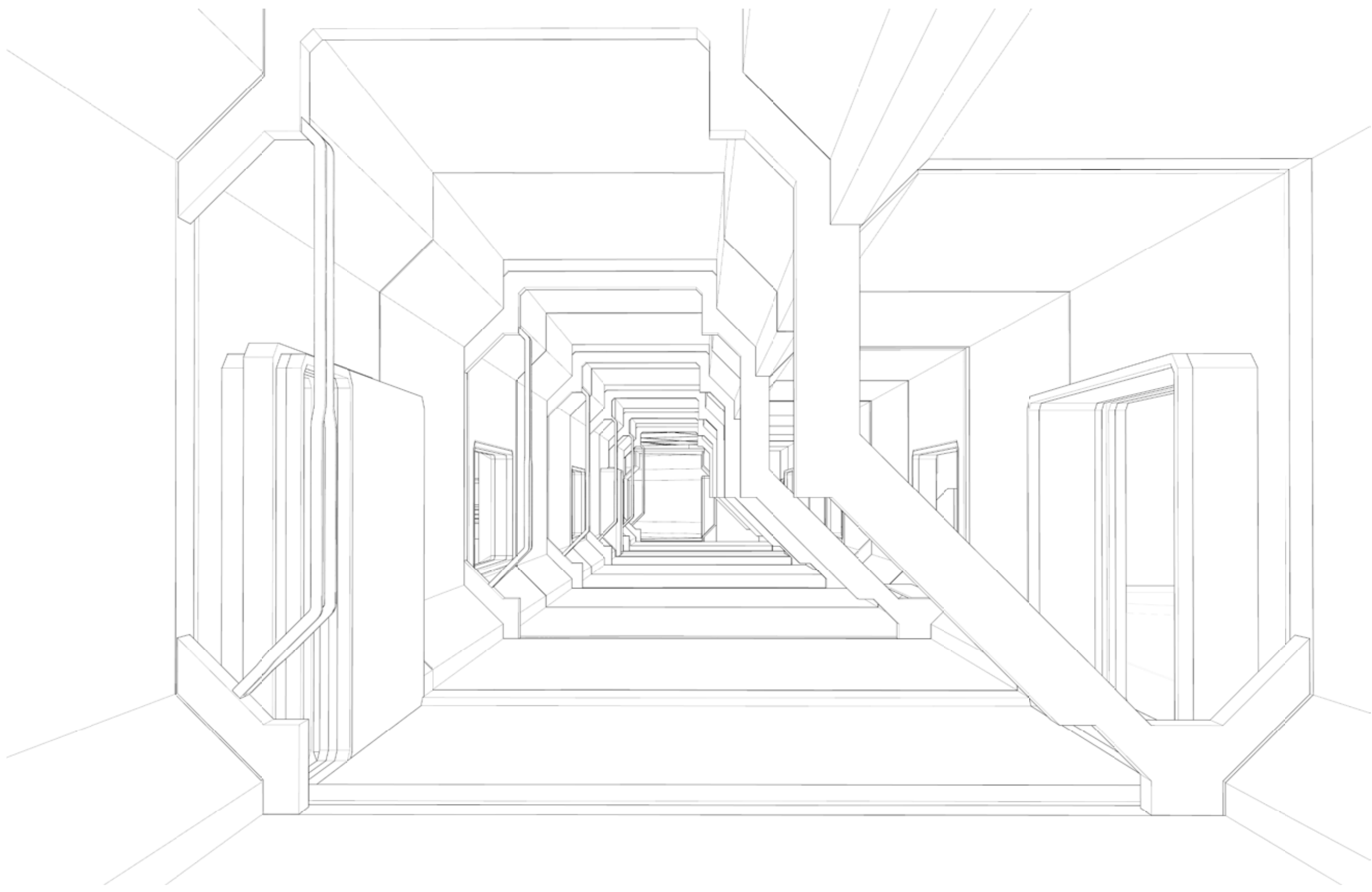

Interior view
main hallway

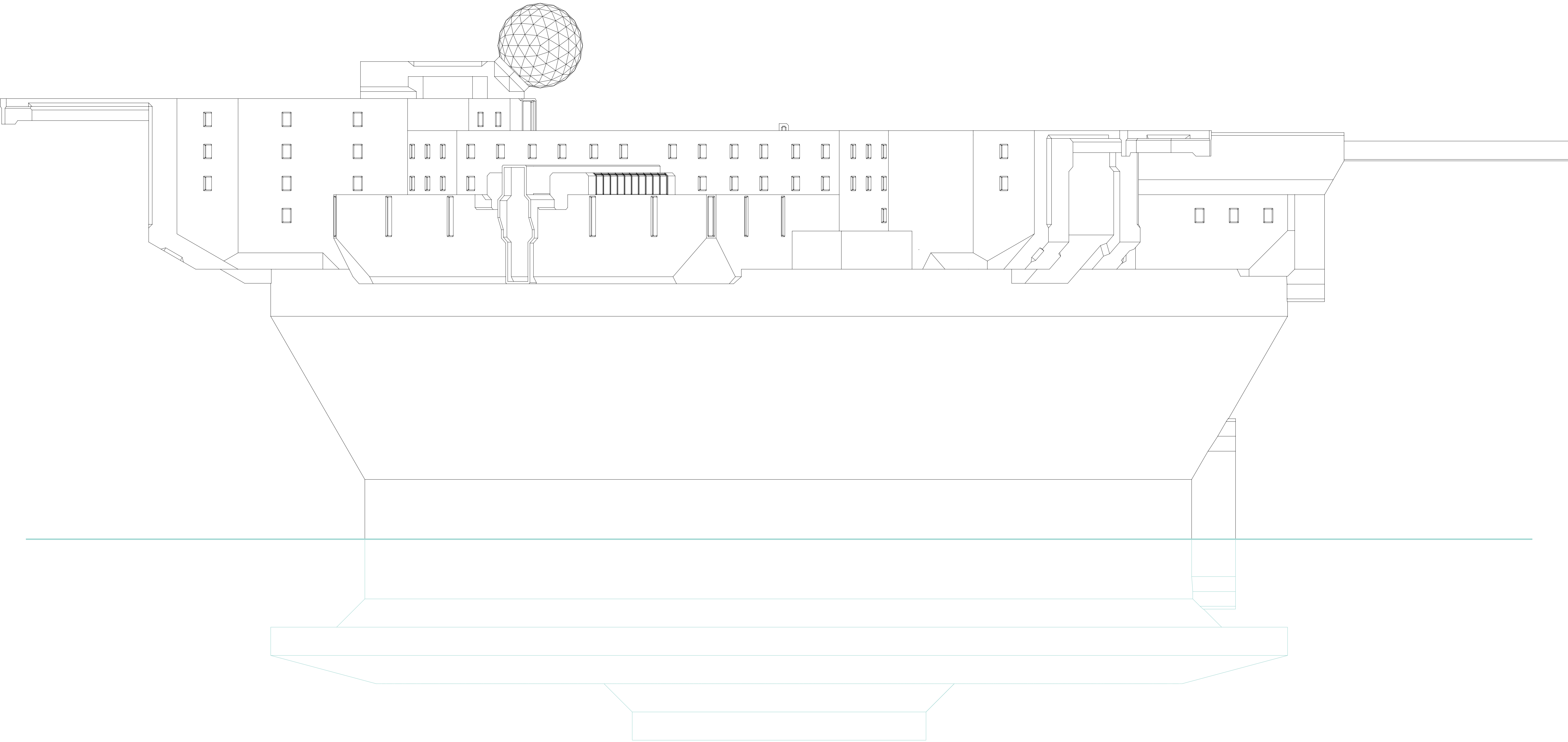

ELEVATION
1:500

INTERIOR ELEMENTS

The Barents chair and coffee table

