



Crematorium





Erik Werenskiöld *En Bondebegravelse* 1885



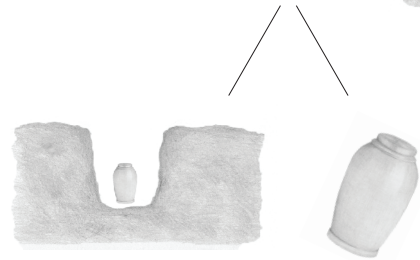
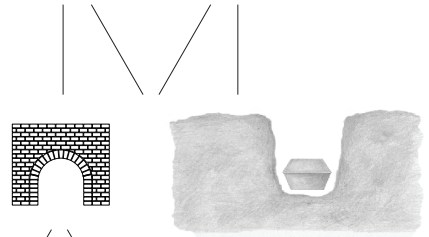
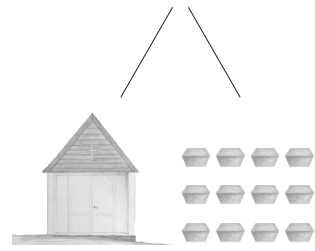











Churches and graveyards in the municipality of Luster.

From top left:

- 1: Graveyard in Fortun. 2: Graveyard in Luster. 3: Graveyard in Jostedalen
- 4: Dale Church, Luster. 5: Urnes Stavechurch. 6: Nes Church.
- 7: Hafslø Church. 8: Joranger Church. 9: Gaupne Old Church.





Sognefjorden

Oslo



Indre Sogn  
Area: 7419 km<sup>2</sup>  
Population: 24 525



Oslo  
Area: 454 km<sup>2</sup>

Grünerløkka  
Population: 56 137



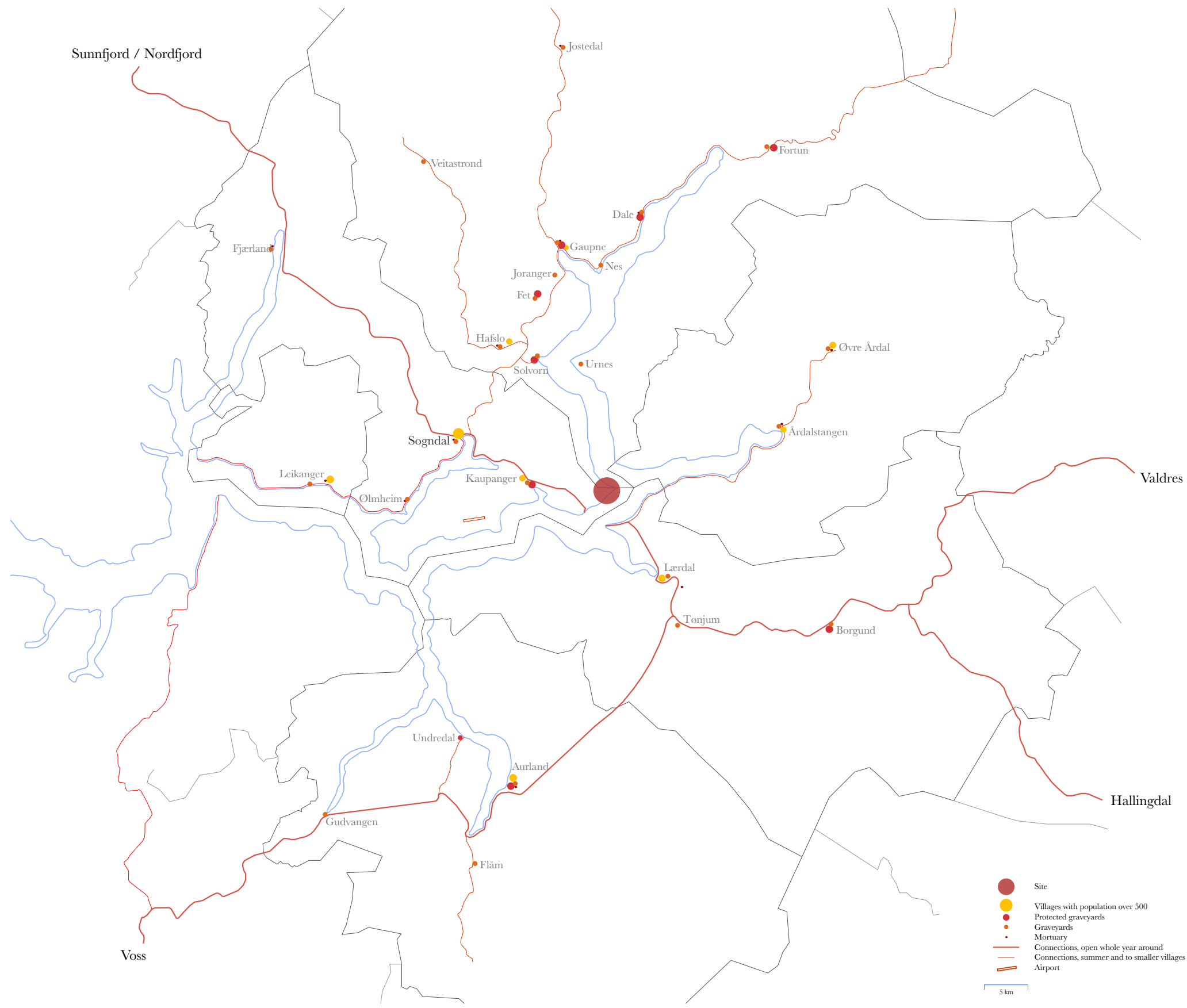

Sunnfjord / Nordfjord

Jostedal

Veitastromd

Fortun

Fjarland

Dale

Joranger

Gaupne

Nes

Fet

Hafslø

Urnes

Øvre Årdal

Solvorn

Årdalstangen

Sogndal

Leikanger

Ølmheim

Kaupanger

Valdres

Lærdal

Tonjum

Borgund

Hallingdal

Undredal

Aurland

Gudvangen

Flåm

Voss

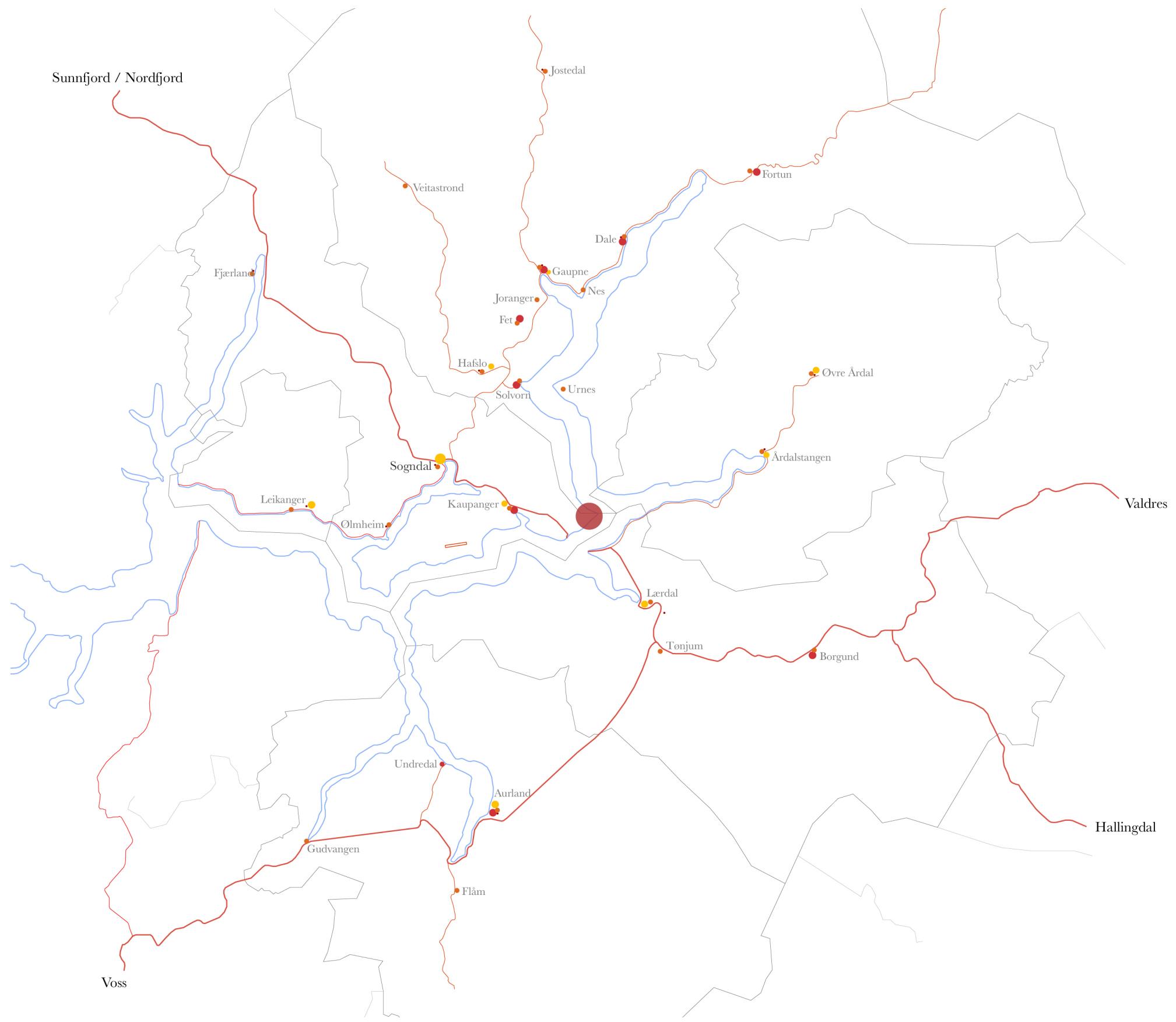

test jpg



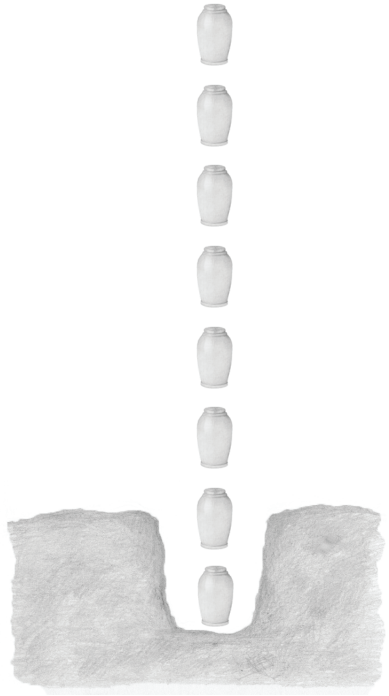
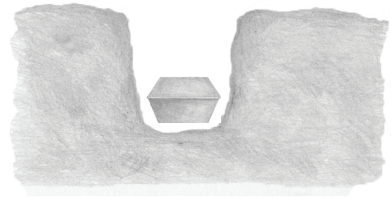



Site seen from *Store Haugmelen*, 1172 metres above sea level

















From top left:  
 1: Nya Krematoriet, Skogskyrkogården, by Johan Celsing. 2: Haslum Krematorium, by John Engh. 3: Asker Bårehus, by Carl-Viggo Hølmebakk  
 4: Asker Krematorium, by Blakstad and Munthe-Kaas. 5: Skogskapellet, Skogskyrkogården, by Gunnar Asplund. 6: Vestfold Krematorium, by Pushak Arkitekter  
 7: Asker Bårehus, by Carl-Viggo Hølmebakk. 8: Haslum Krematorium, by John Engh. 9: Uppståndelsekapellet, Skogskyrkogården, by Sigurd Lewerentz

- Circulation
- Ceremony
- Entrance, Waiting
- Oven
- Cooling

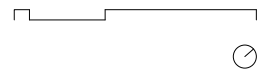
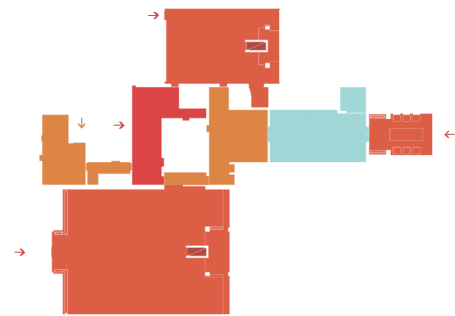

Haslum Krematorium  
John Engh, 1962, Bærum

Size:  
Cremations pr. year: 977 (2015)  
Ovens: 1 (in basement)  
Employees: 2,5

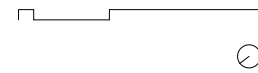

Nya Krematoriet  
Johan Celsing, 2014, Skogskyrkogården, Stockholm

Size: 1512 m2  
Cremations pr. year: 3934 (2016)  
Ovens: 4  
Employees: 6



Vestfold Krematorium  
Pushak, 2010, Sandefjord

Size: 1100 m2  
Cremations pr. year: 1034 (2015)  
Ovens: 2 (only one in use)  
Employees: 2,5



## Project Content

	Use / Purpose	Scale	Characteristics	Object (s)
Viewing Room	Bereaved get the chance to view the deceased. A ceremony that can take place the same day of death, or in the days after. A space for pause, connected to the viewing room. Possibility to be there for 5 minutes and 3 hours, whatever needed.	Small in scale, intimate enough for one and 8 and perhaps even more. 10-30 square meters.	One window, and this is the only natural light source. One door, which is the entrance. A room in the forest. Wooden floor. A home and a shelter for the deceased.	Chairs. Candleholders. A white granite boulder to place the coffin on. An object to put flowers, CD-player or anything of wishes on top of, or inside of. A space for those who do not want to participate in the viewing, and/or need a pause.
Room for coffins	A room for the deceased in the days after death and before the ceremony. Only for a few hours, or for a week or two. Connected to the oven and to the viewing.	Small room for at least 6 coffins, where the coffin lies with the lid on.	A cold room in temperature, but with some natural daylight and flowers. This room is a part of the forest, detached from the rest.	Flowers and other personal items if wanted. No other objects.
Ceremonial Room	The Ceremony, the funeral, which usually takes place between 7 and maximum 14 days after death. More formal than the viewing ceremony.	A room for up to 40. Smaller than the churches in the district, intimate. Enough space for a choir to sing, someone to play or other performances.	Sacral, high under the ceiling. Natural light source, which is the main feature in the space.	Benches (never full and never empty). Pulpit. Candleholders. A white granite boulder to place the coffin on. A space around the coffin to put flowers. A table, for instance to set a picture on.
Waiting Room	The bereaved will wait here after the ceremony until the urn is ready, approximately 3 hours. Place to sit, to eat, to drink coffee or other wishes. Toilets in short walking distance.	A room for potentially 40 people. The room is not set by 4 walls, the nature is a part of this waiting room, endless.	A narrow, horizontal space (climatized), closely connected to the outside and the view to the forest, with possibility and aim to walk outside. Use the nature and the close forest as a retreat. A path, ending with a bench and a view towards the fjord.	A door and a ramp leading to the forest. Chairs, tables and sofas, a temporary home for 3 hours. A bench and a path. Candleholders. Equipment for screen.
Room for urn	After approximately 3 hours the bereaved will be handed the urn and this will be delivered by the workers. This is the end of the ceremony at the crematorium.	A part of the waiting room. Only space for a few people to collect the urn. Small in scale, but with a door to step out into the forest.	The shelf where the urn will be set should be modest, but obvious. A light room, a part of the forest.	A set shelf or table for the urn.
Observation Room	Some have the wish to see the coffin to be set in the oven. In Hinduism this is a requirement. This part takes only some minutes.	Small. Place for the closest family.	A view towards the side of the oven, so the bereaved don't see into the oven.	Close to the oven, but a boundary between the opening and the bereaved.
The Oven room	The cremation room. The whole production area, from burning to preparing the ash.	Generous working area, airy. The largest room.	Open and light working space, with large windows and with a view towards the village, detached from the bereaved.	One oven, a cooling area to cool the ash, an ashcrusher, storage for urn, sink. Pipe.
Pause	The space for the employees, where they can pull back and take a break from all the impressions	Room for 3 employees	A different view than the other rooms, windows to the outside, detached from the rest.	Table, chairs, kitchen, sofa, tv and other digital devices.





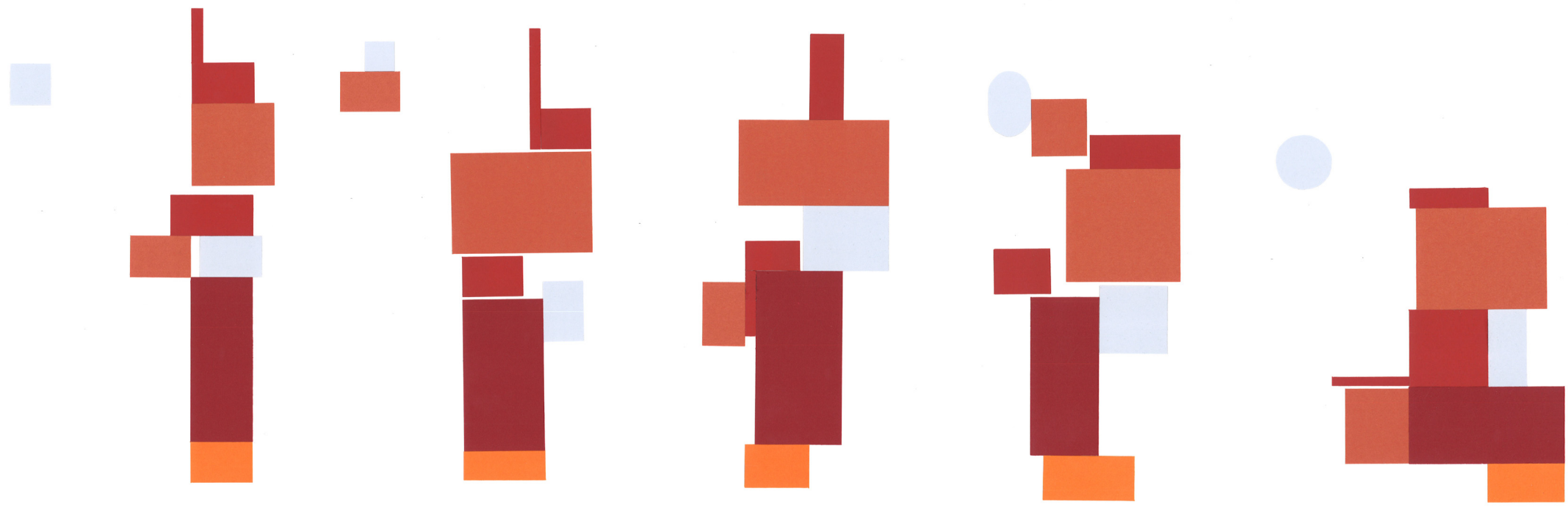

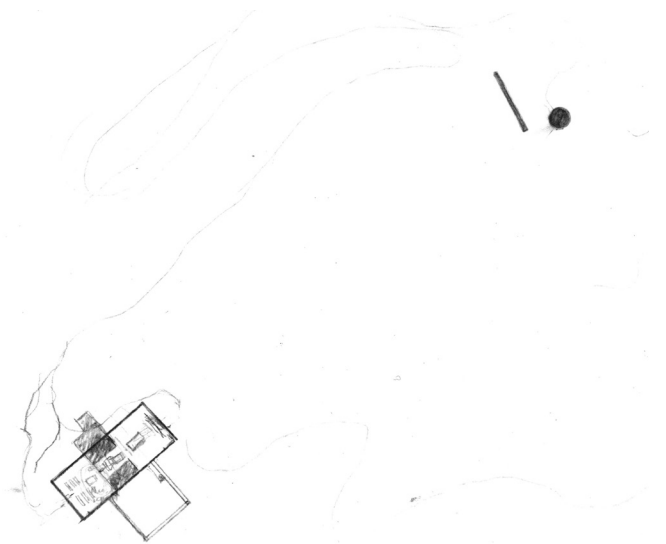
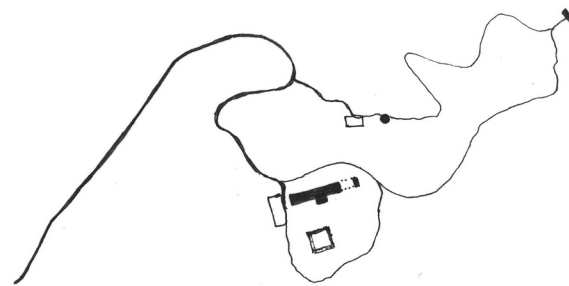
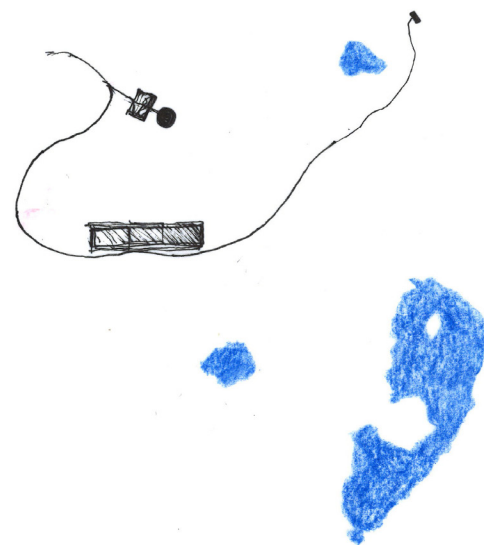

all sketches will be  
presented in a different  
way

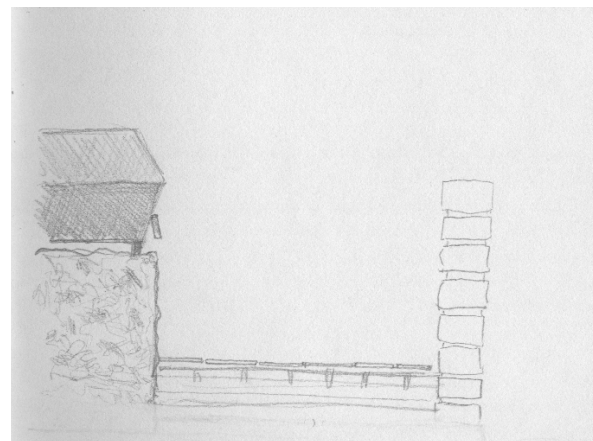
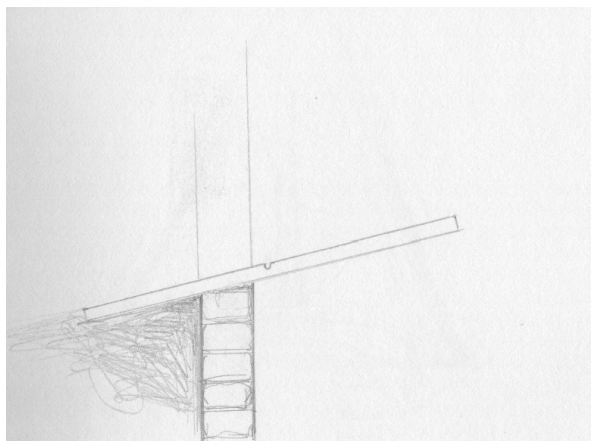
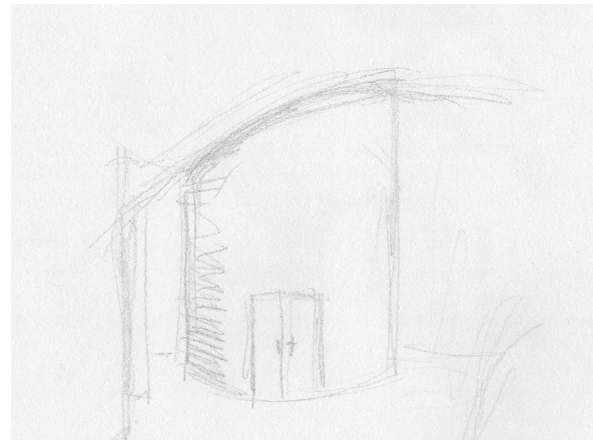
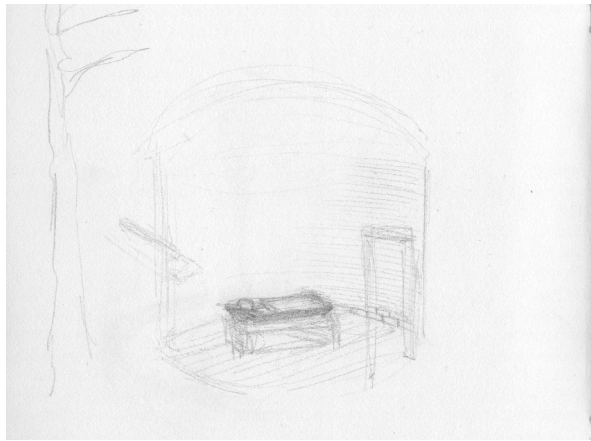

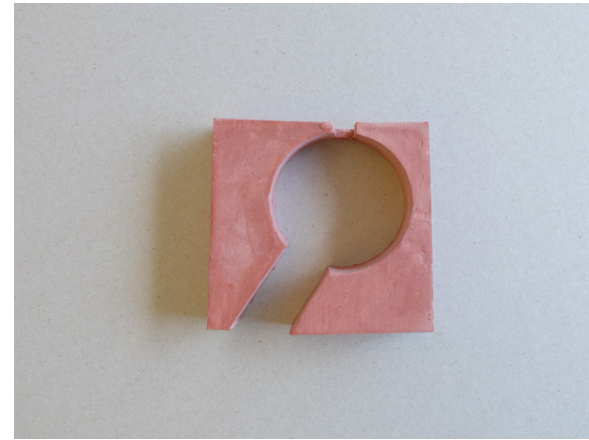
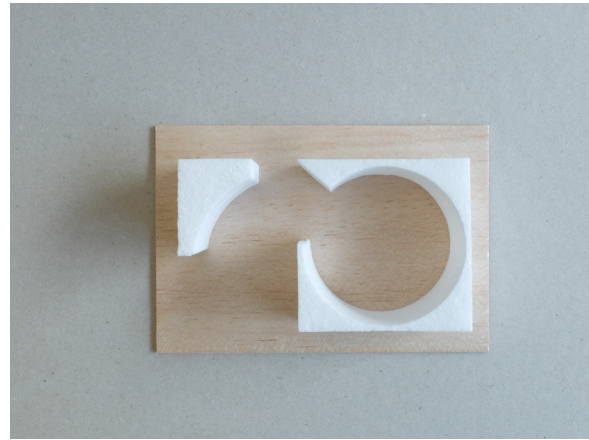
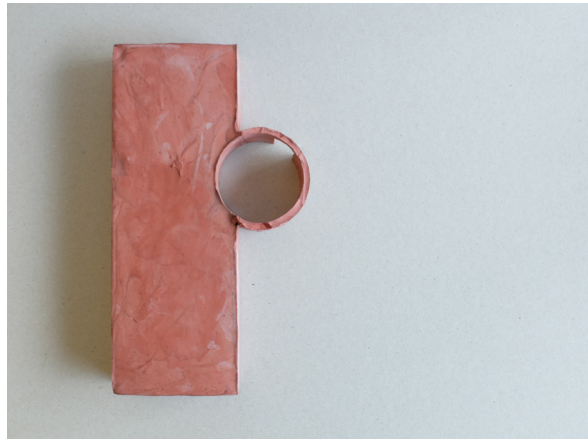



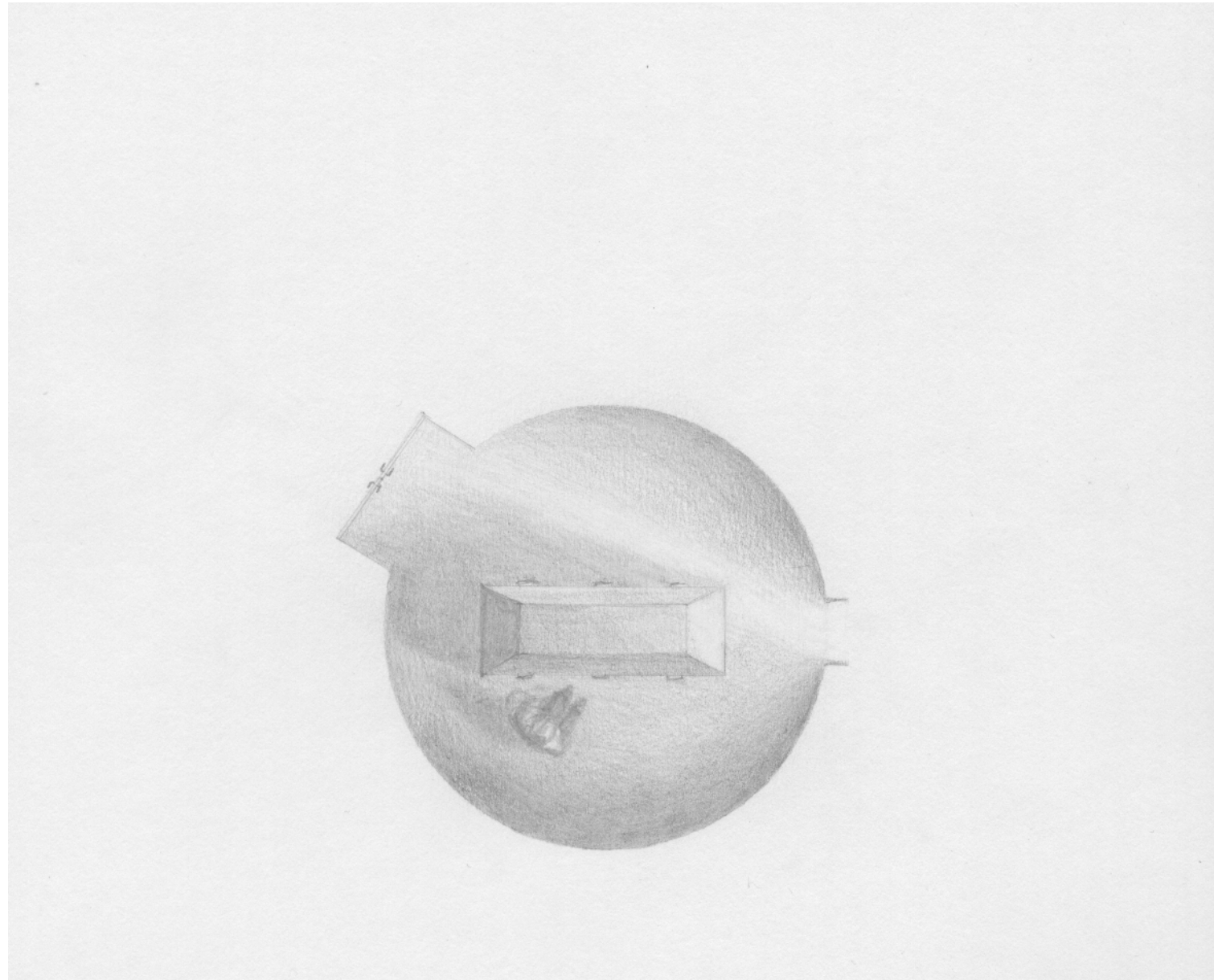

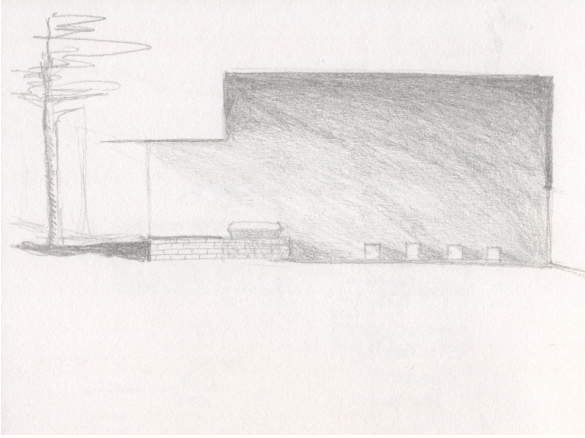
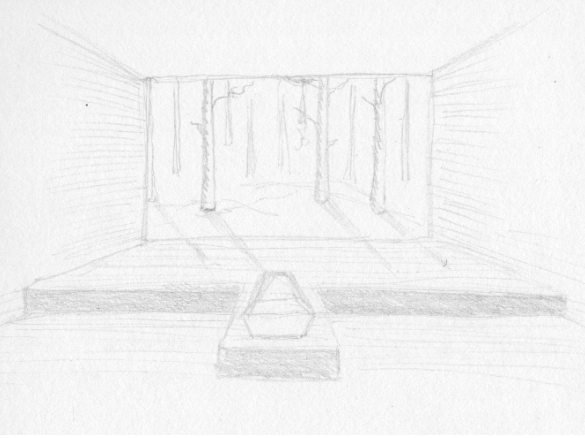
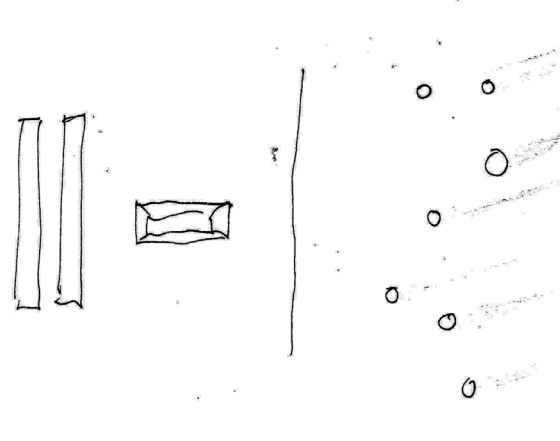
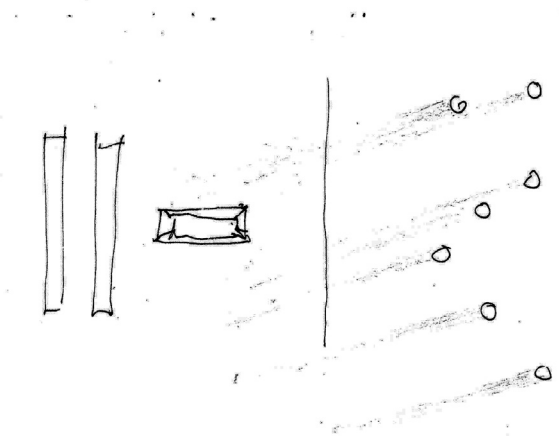





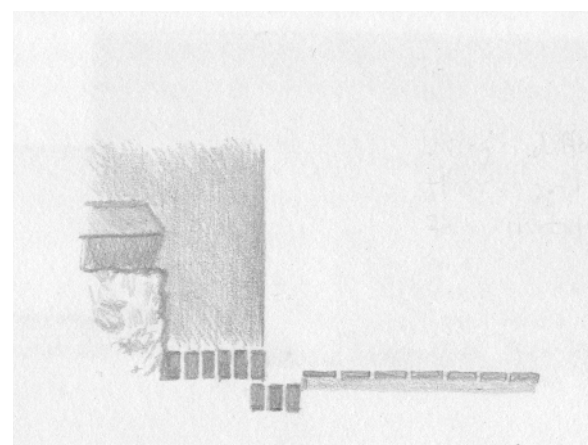
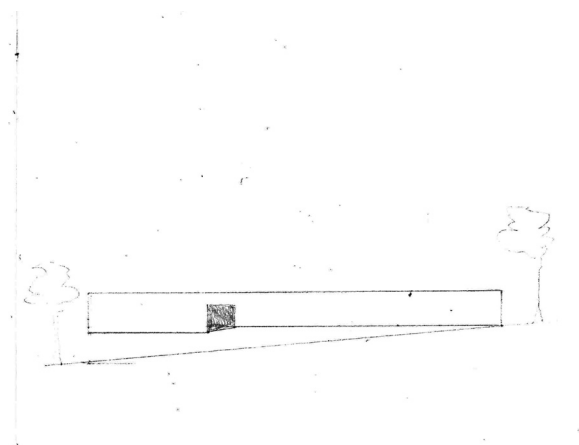
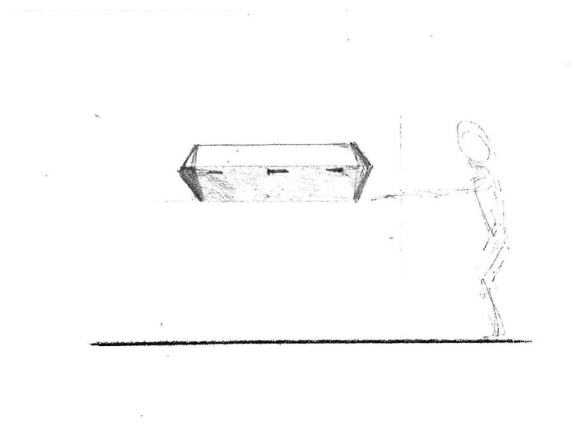
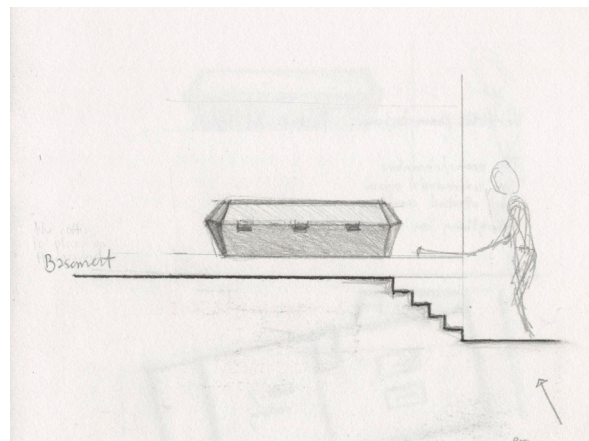

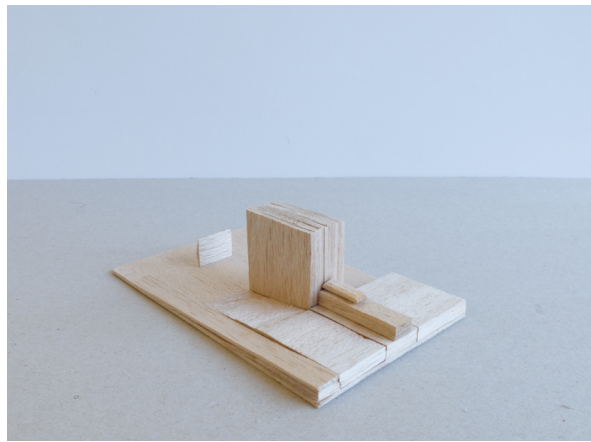
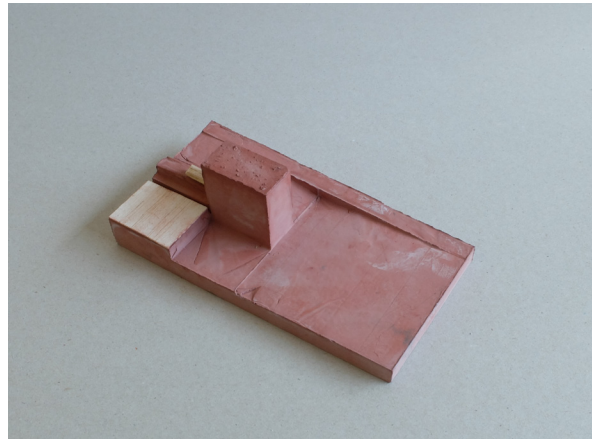
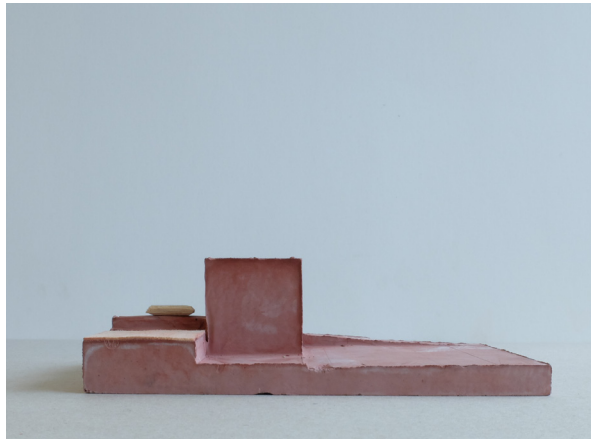
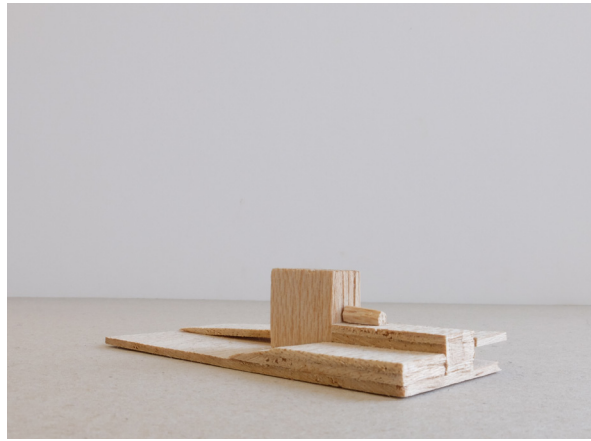

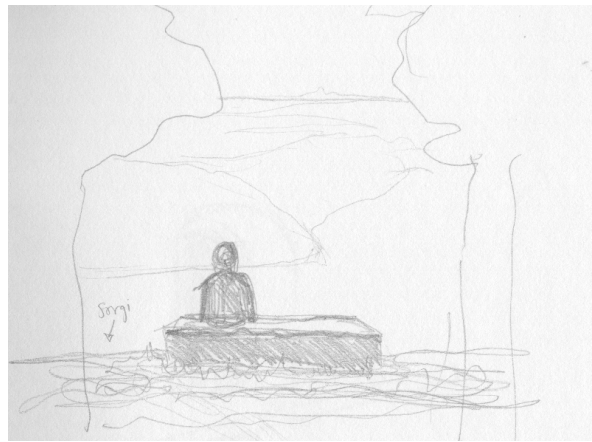
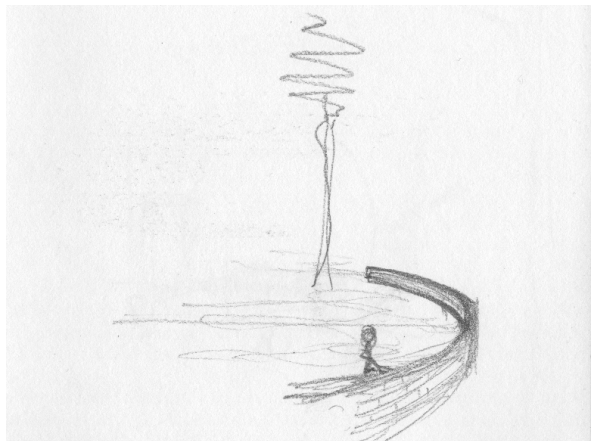
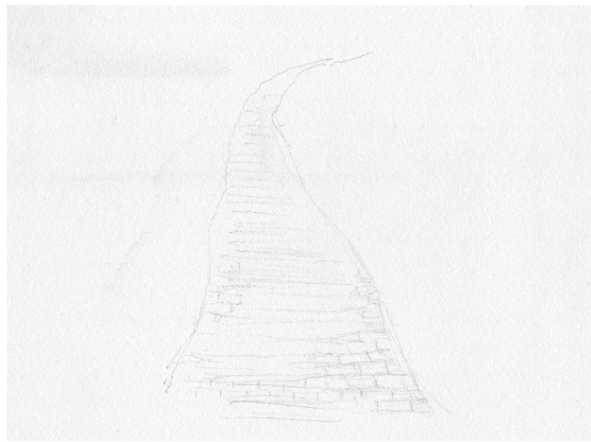



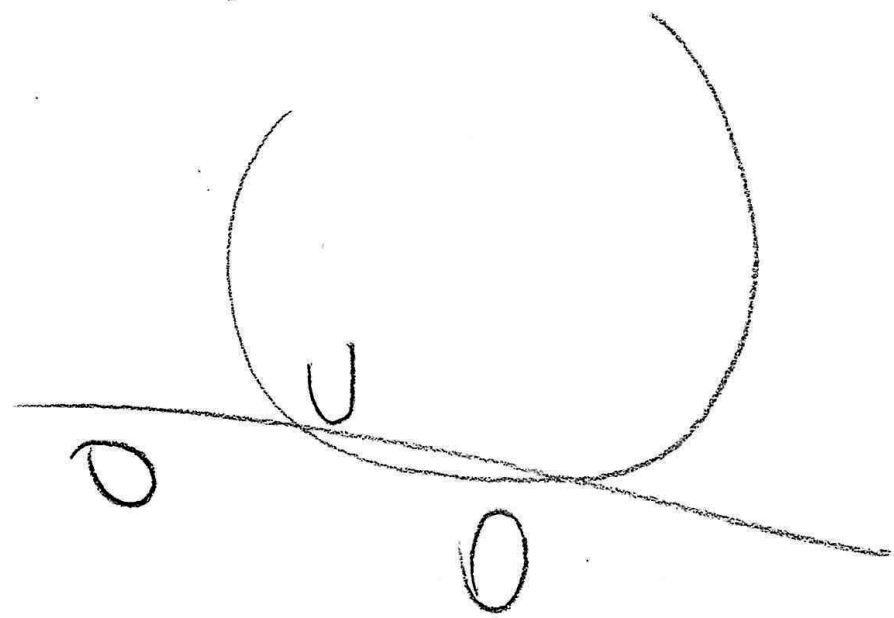

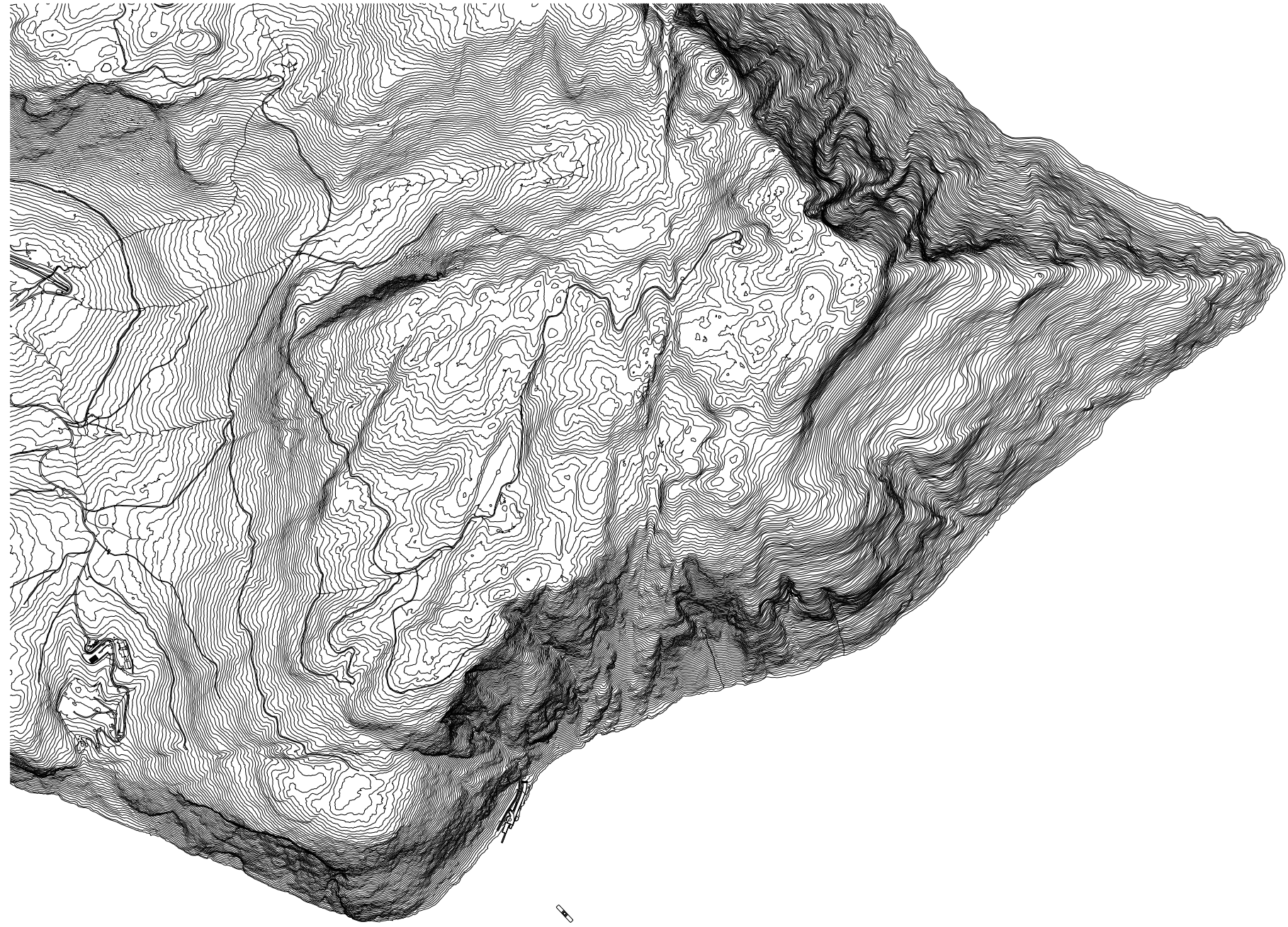

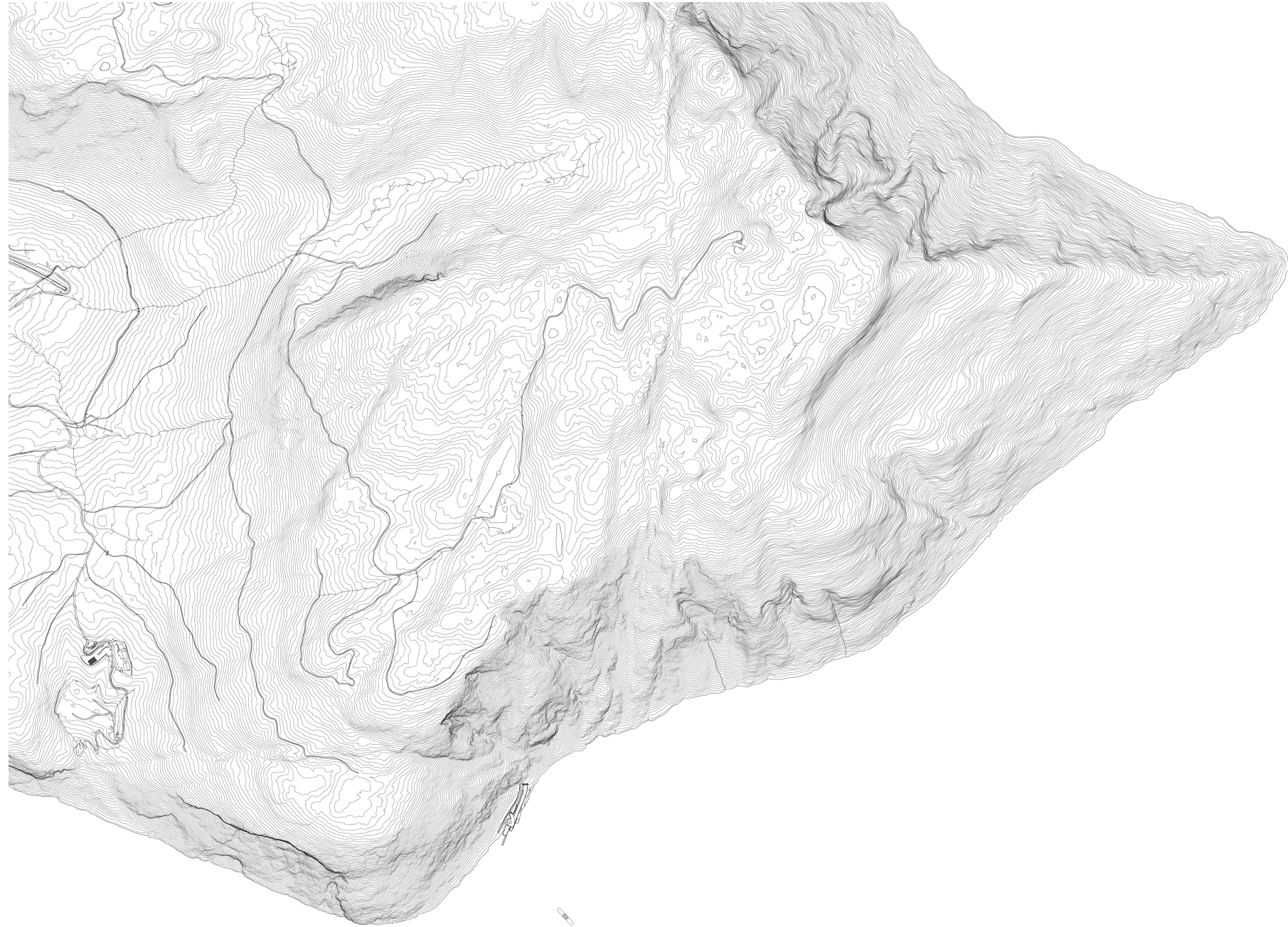

test.jpg



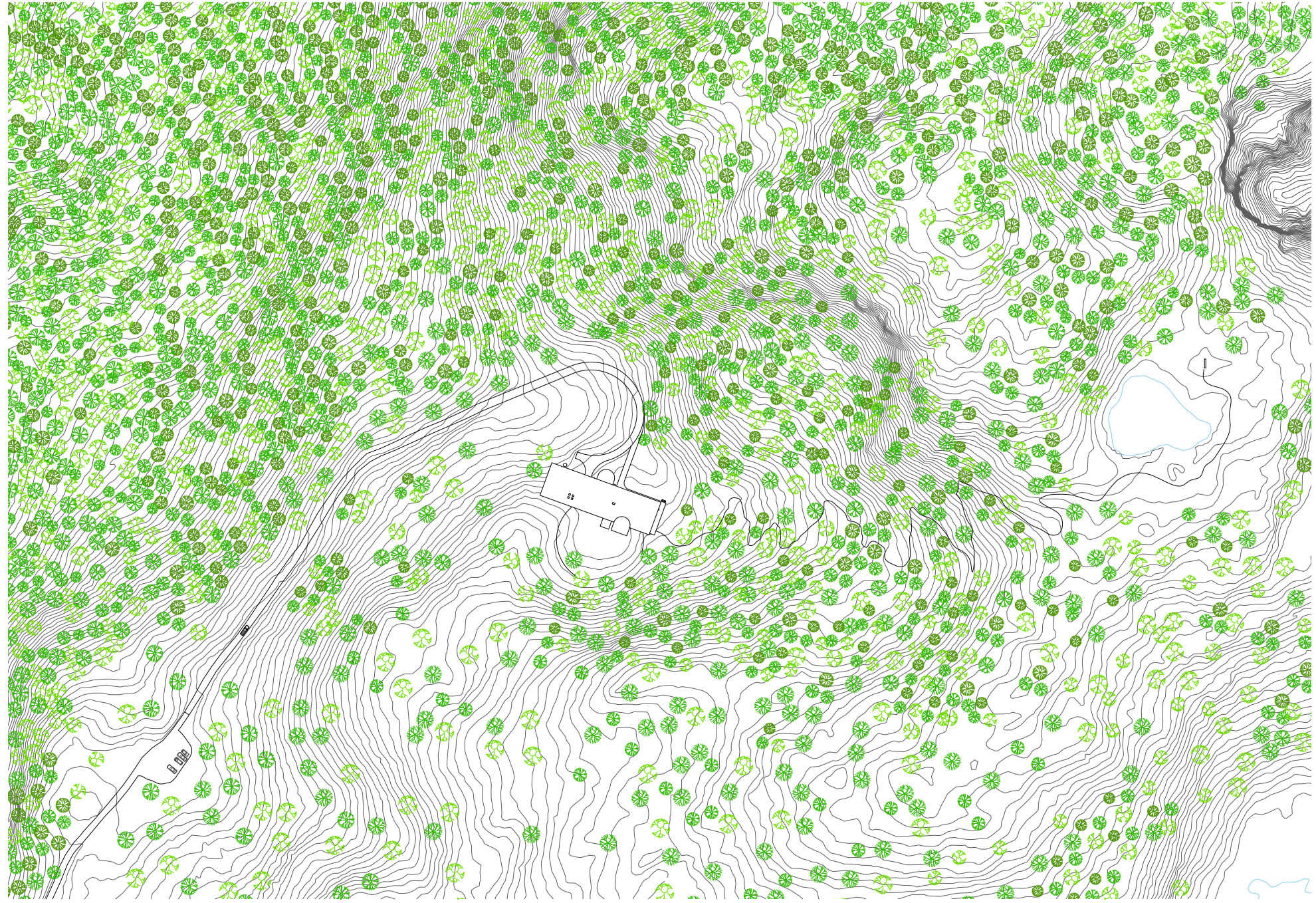



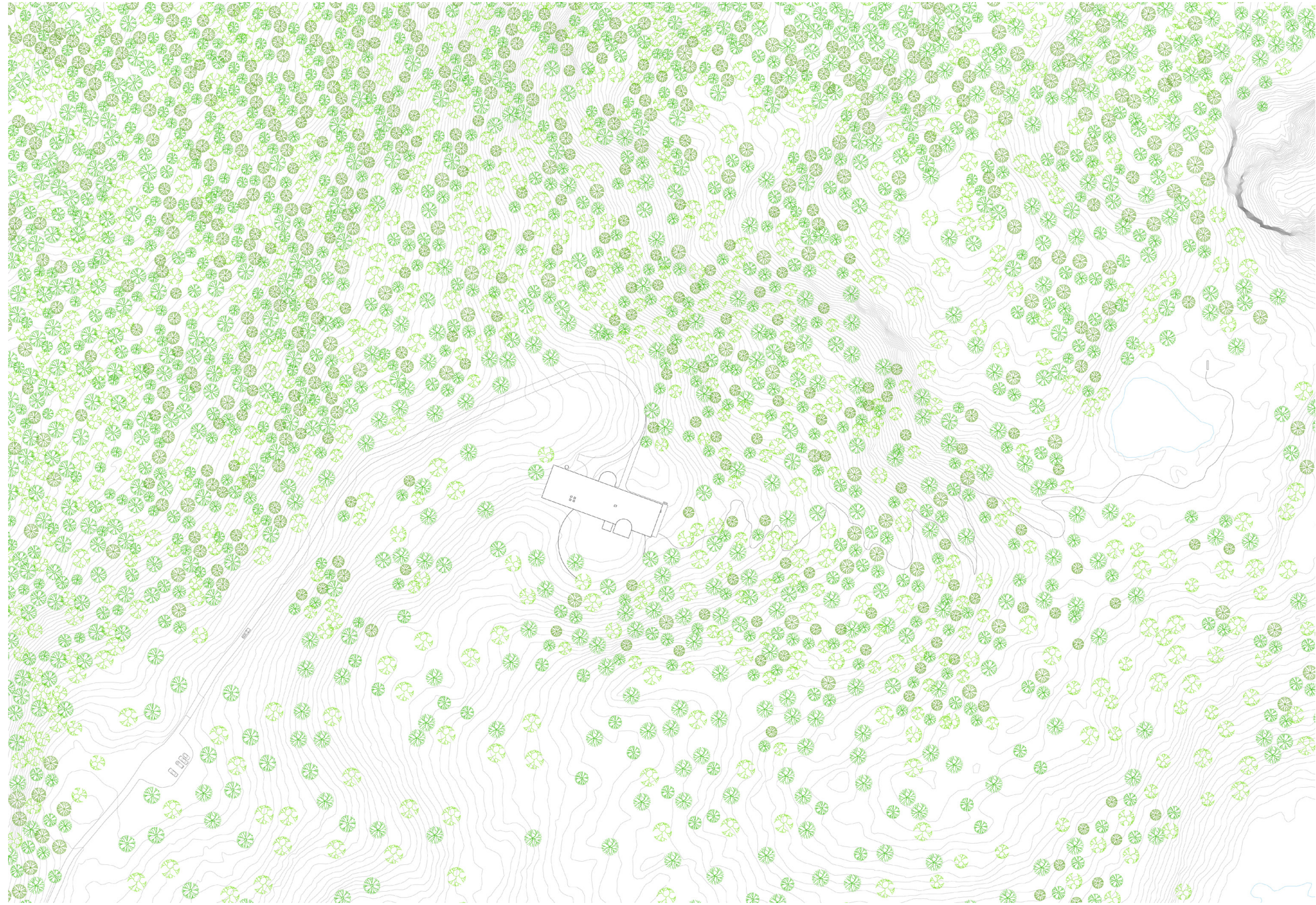

test.jpg



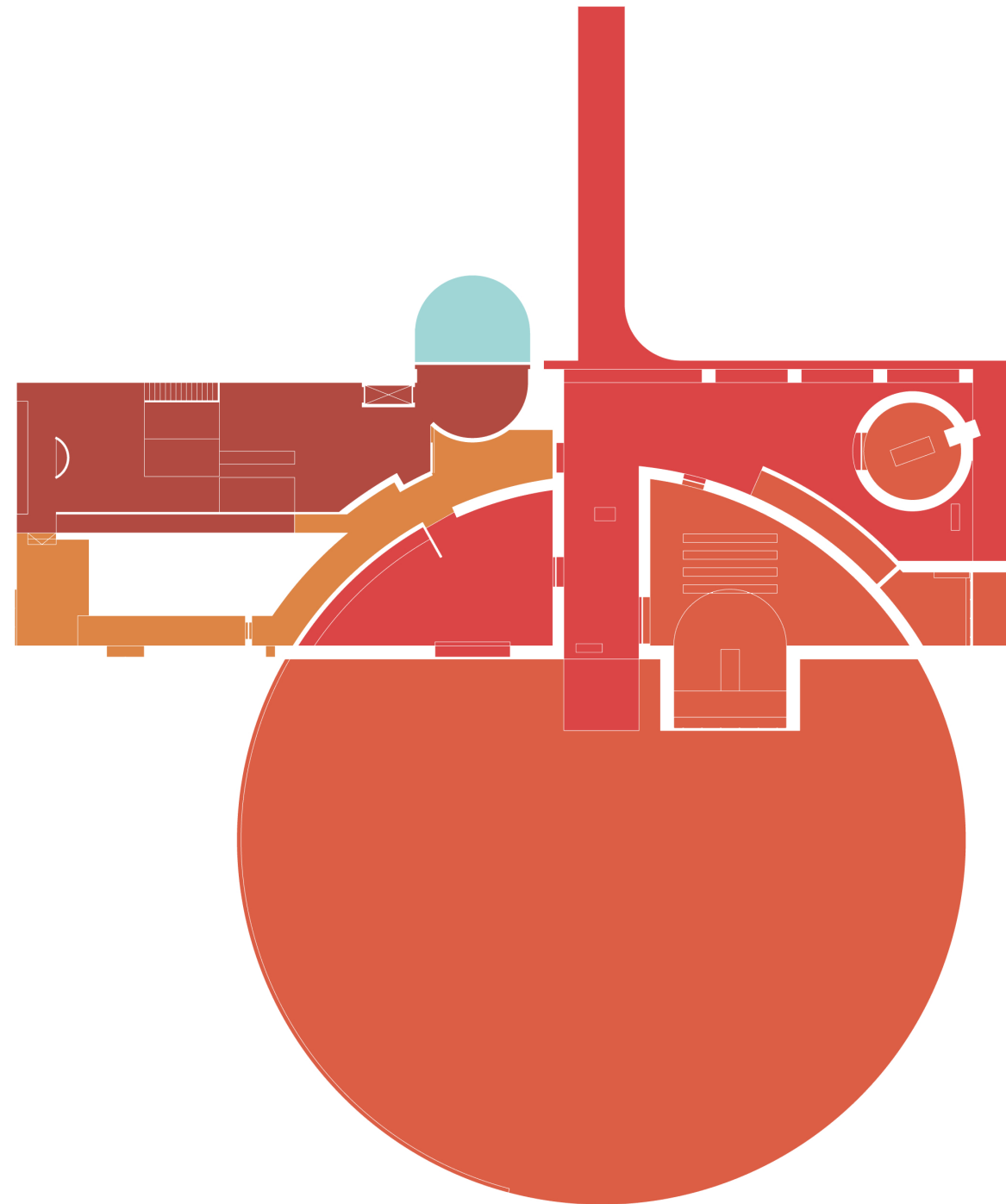

- Circulation
- Ceremony
- Entrance, Waiting
- Oven
- Cooling

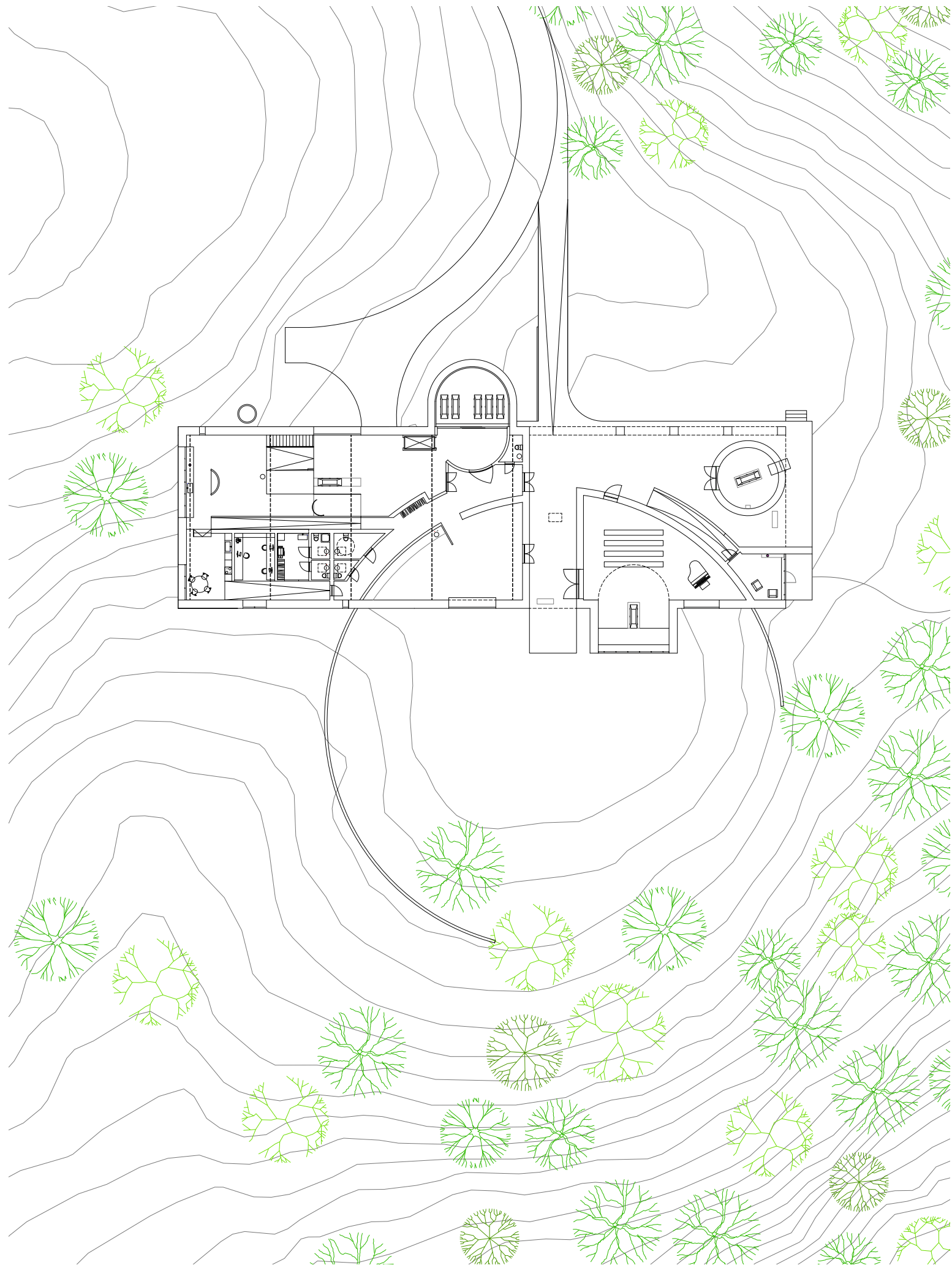



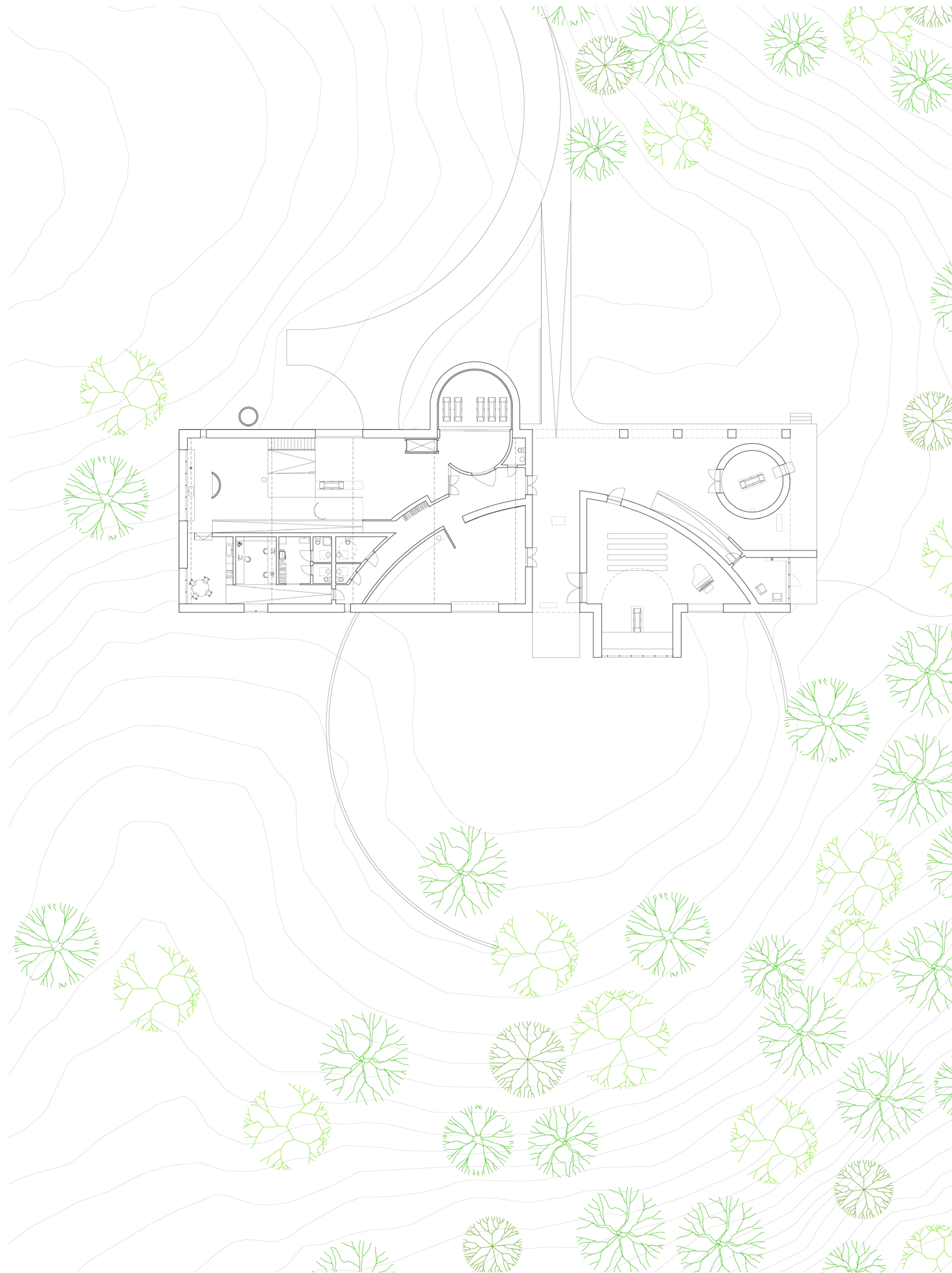

test jpg

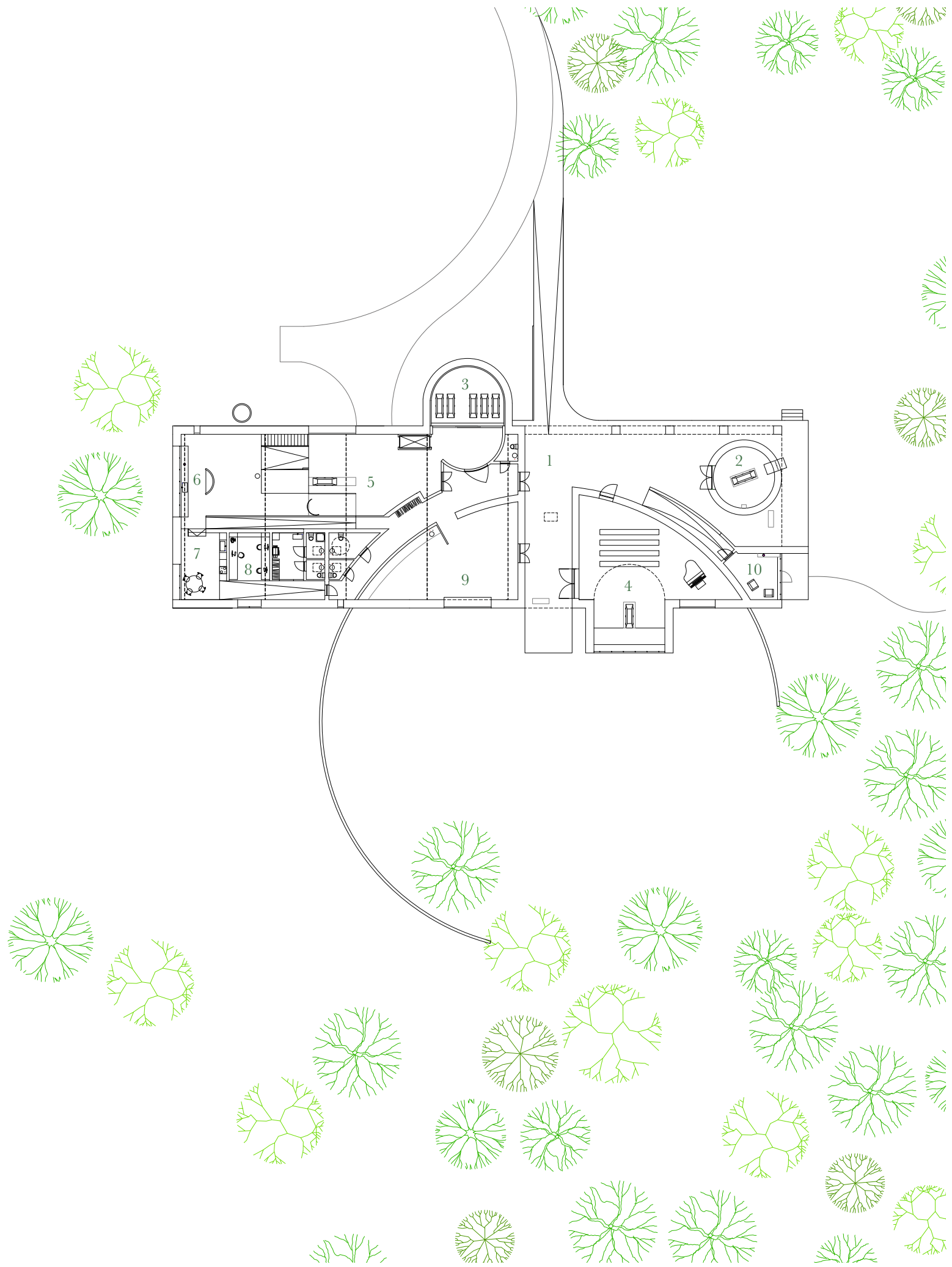

- 1 Entrance
- 2 Viewing
- 3 Coffin Room
- 4 Ceremony
- 5 Oven Room
- 6 Preparation of the ash
- 7 Pause
- 8 Office
- 9 Meeting
- 10 Urn delivery

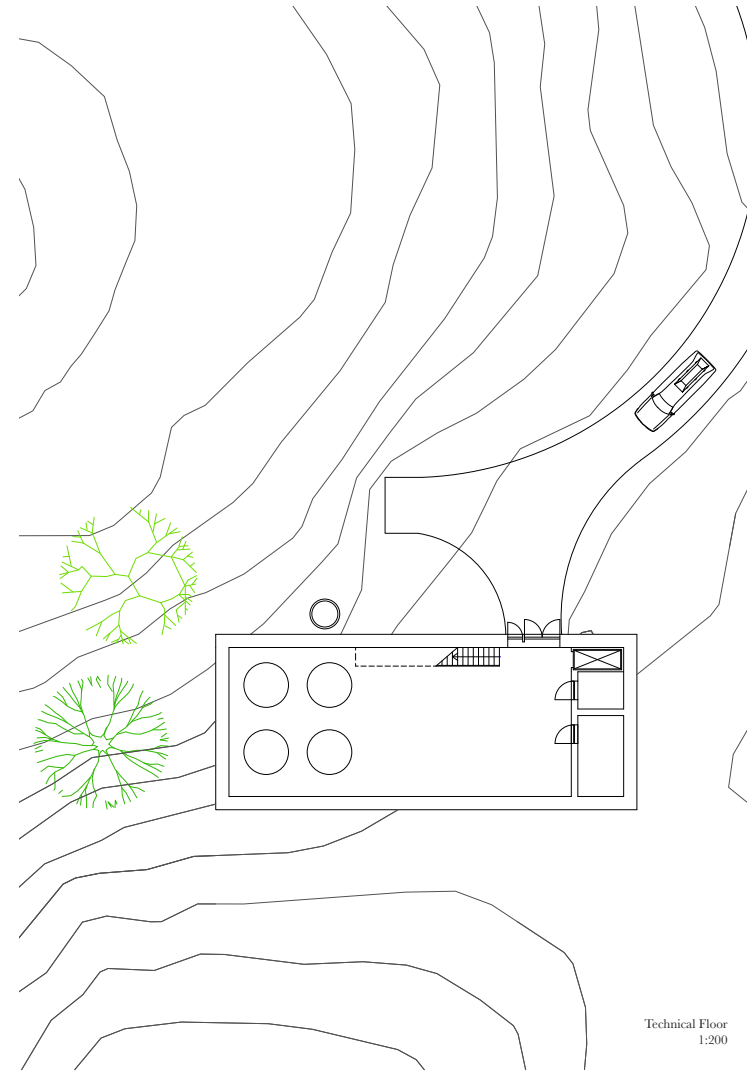

Technical Floor  
1:200



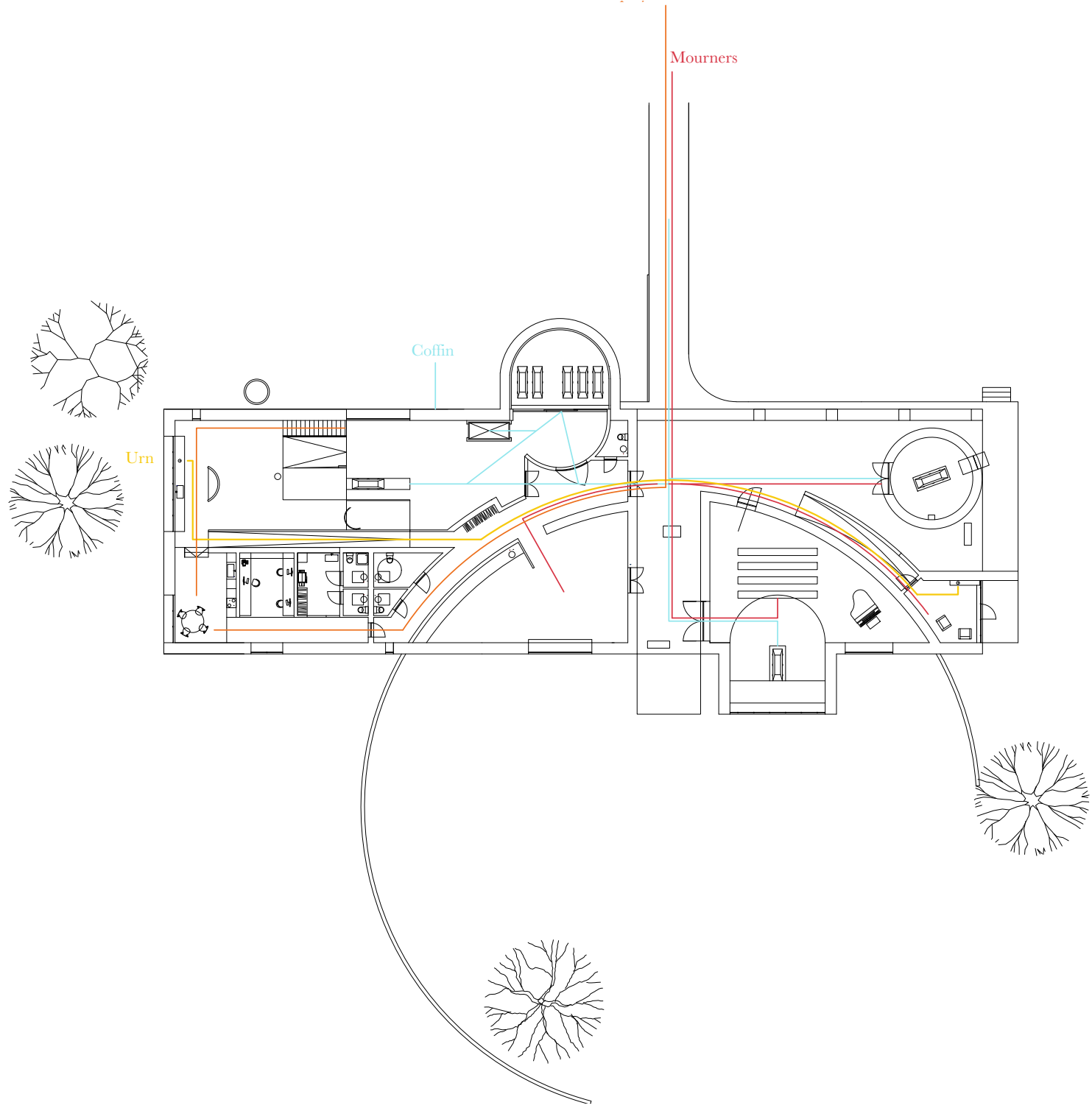

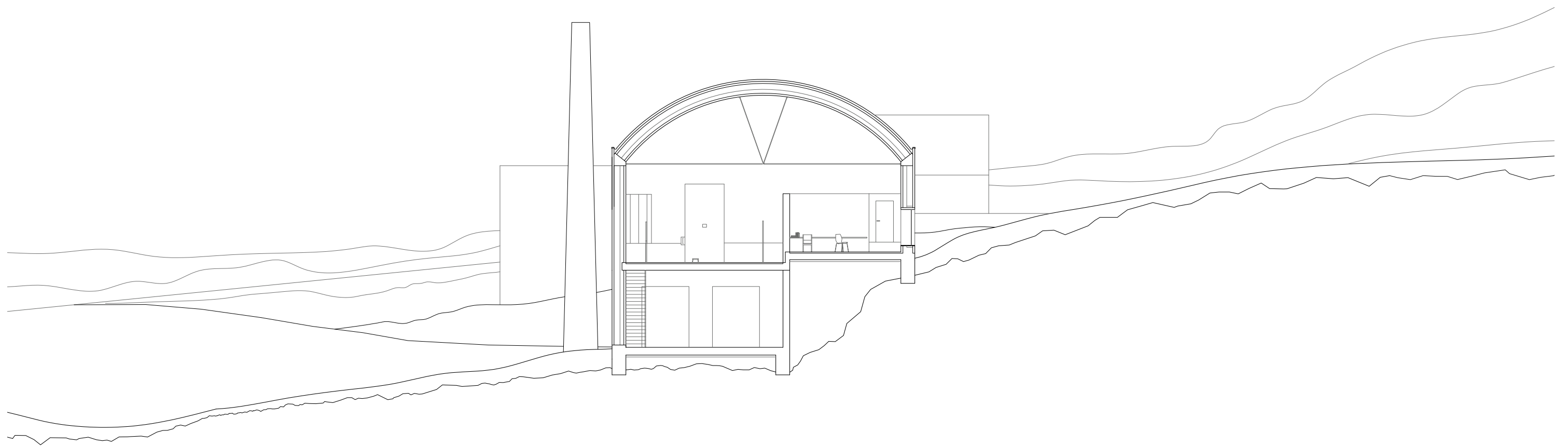

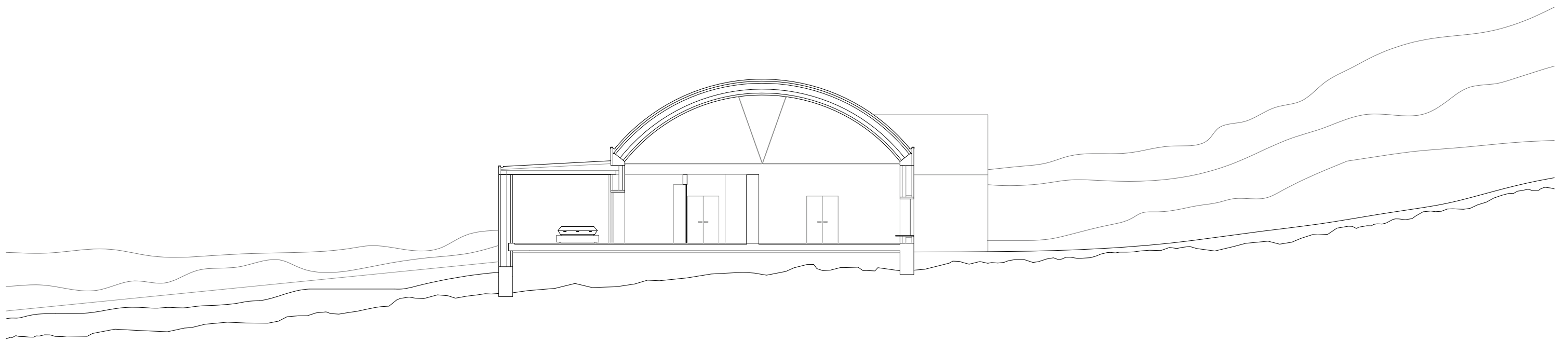



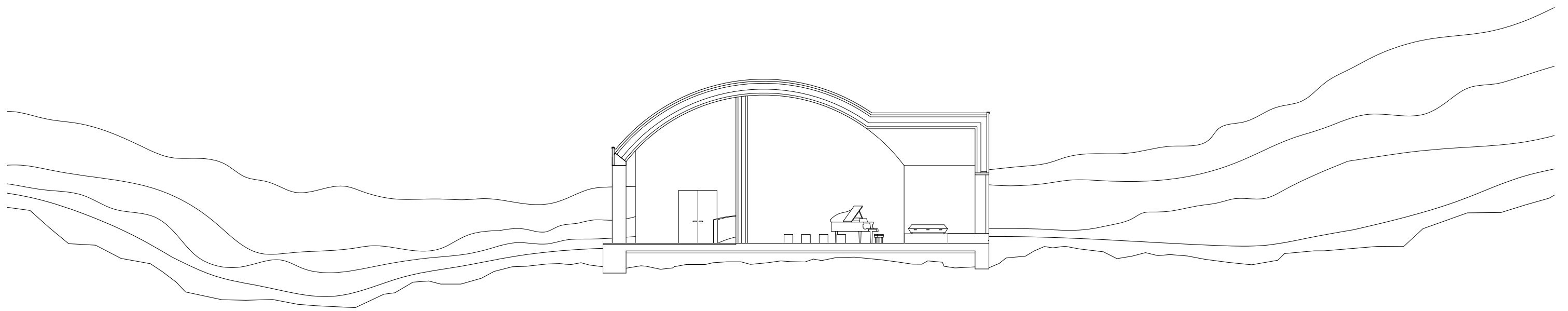

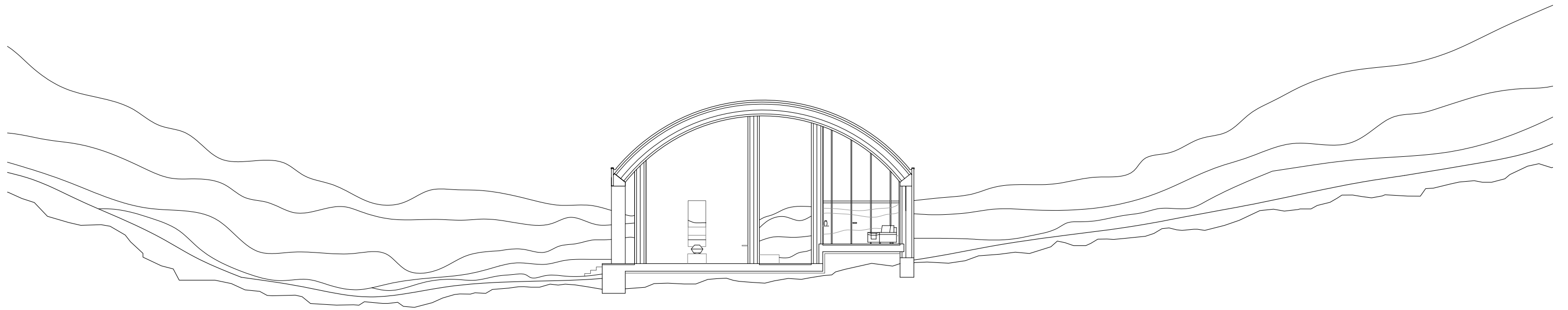







test colors and  
contrast





