

Reinforced concrete column into rocky ground

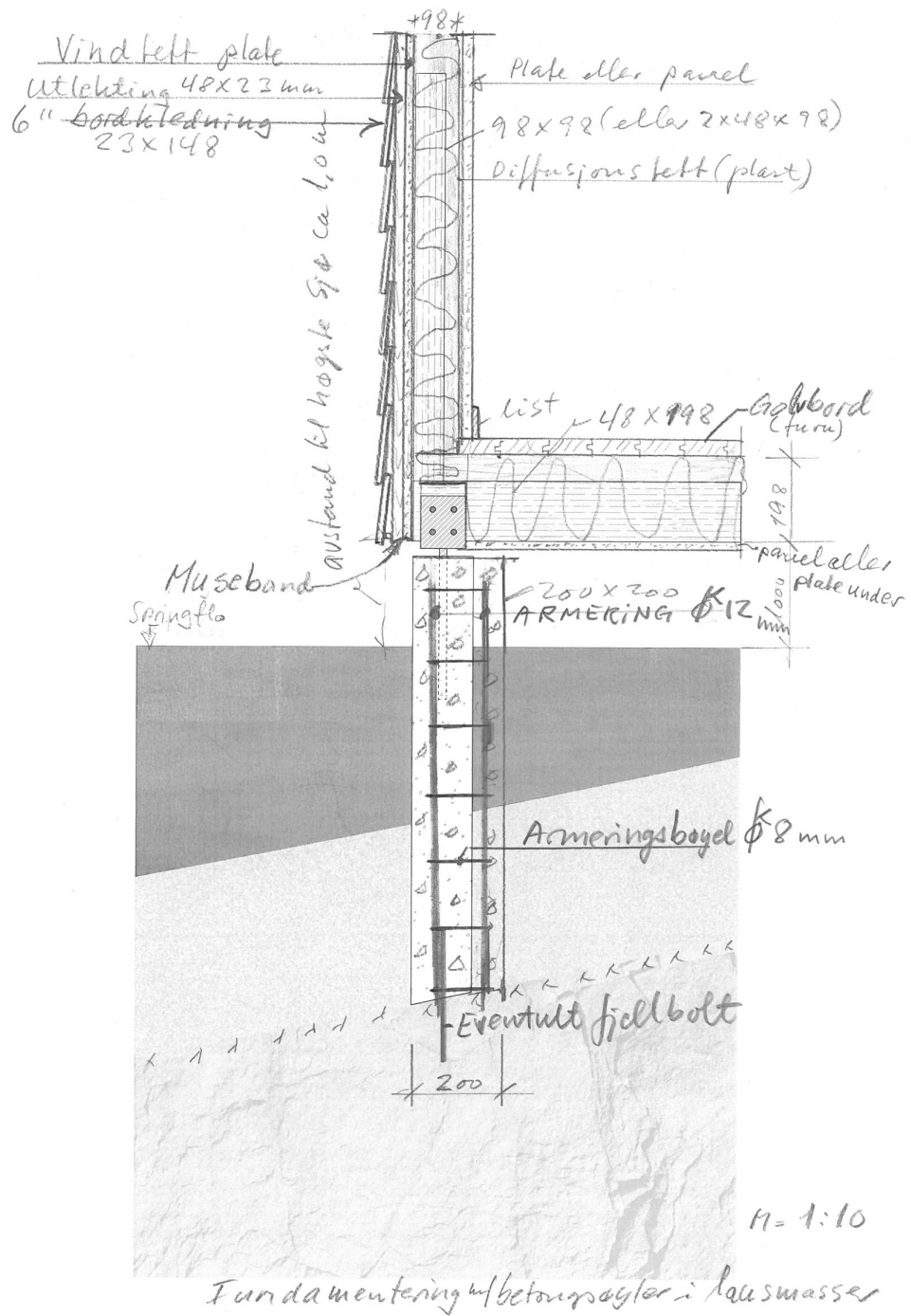

Reinforced concrete column into rocky ground with timber cladding on external walls.

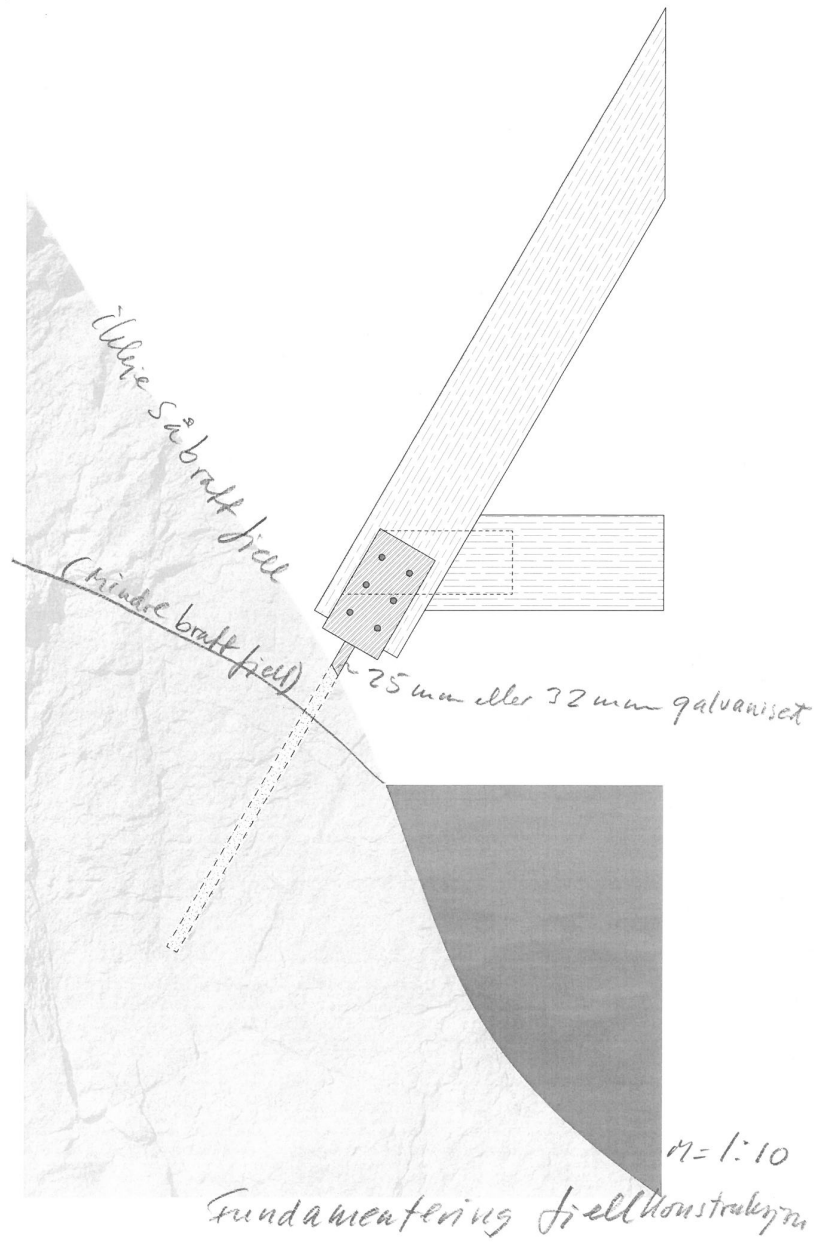

Sketch of steel footing anchored directly into rocky ground

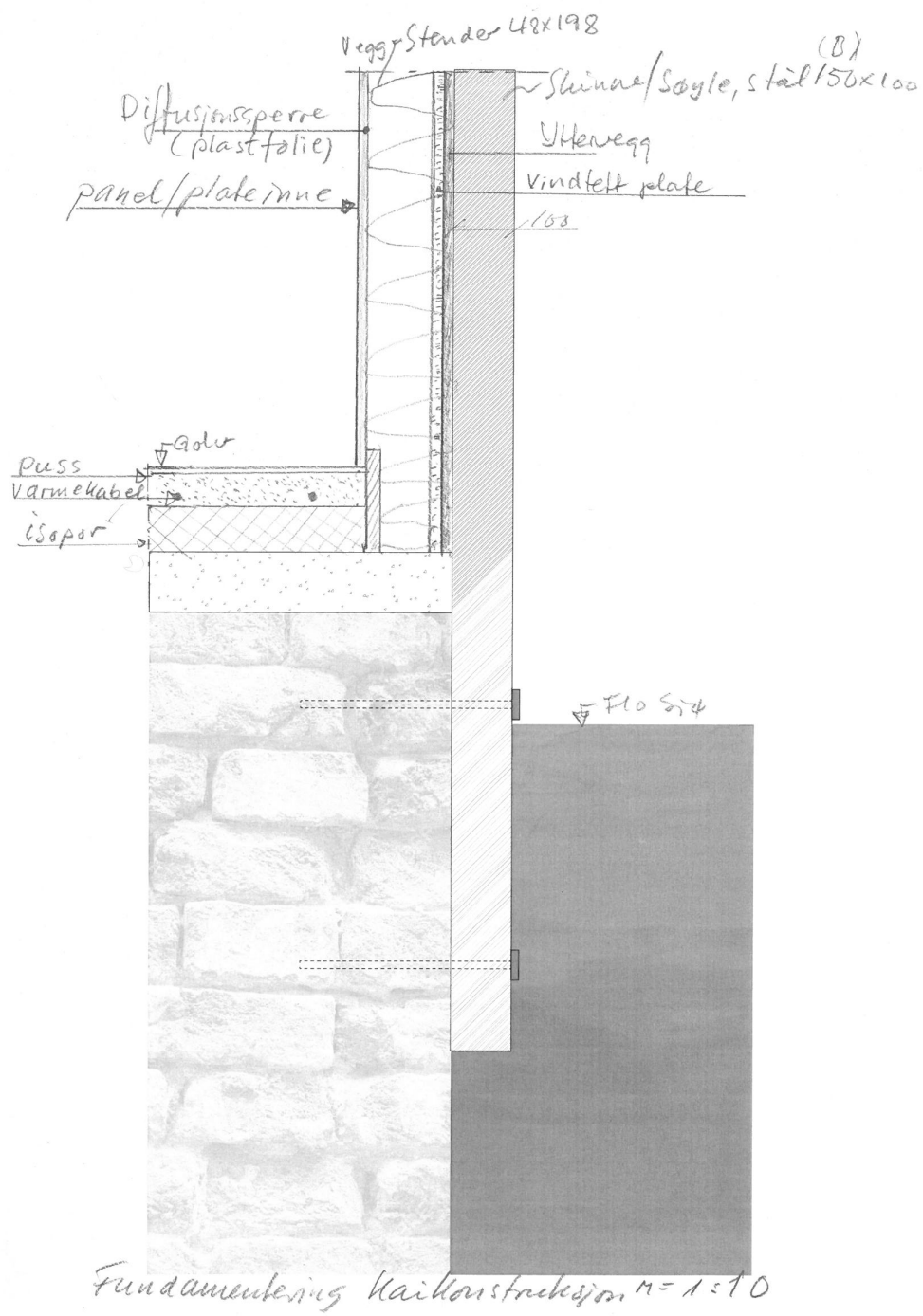

Foundation detail of cabin by the quay, steel column bolted into existing stone wall.

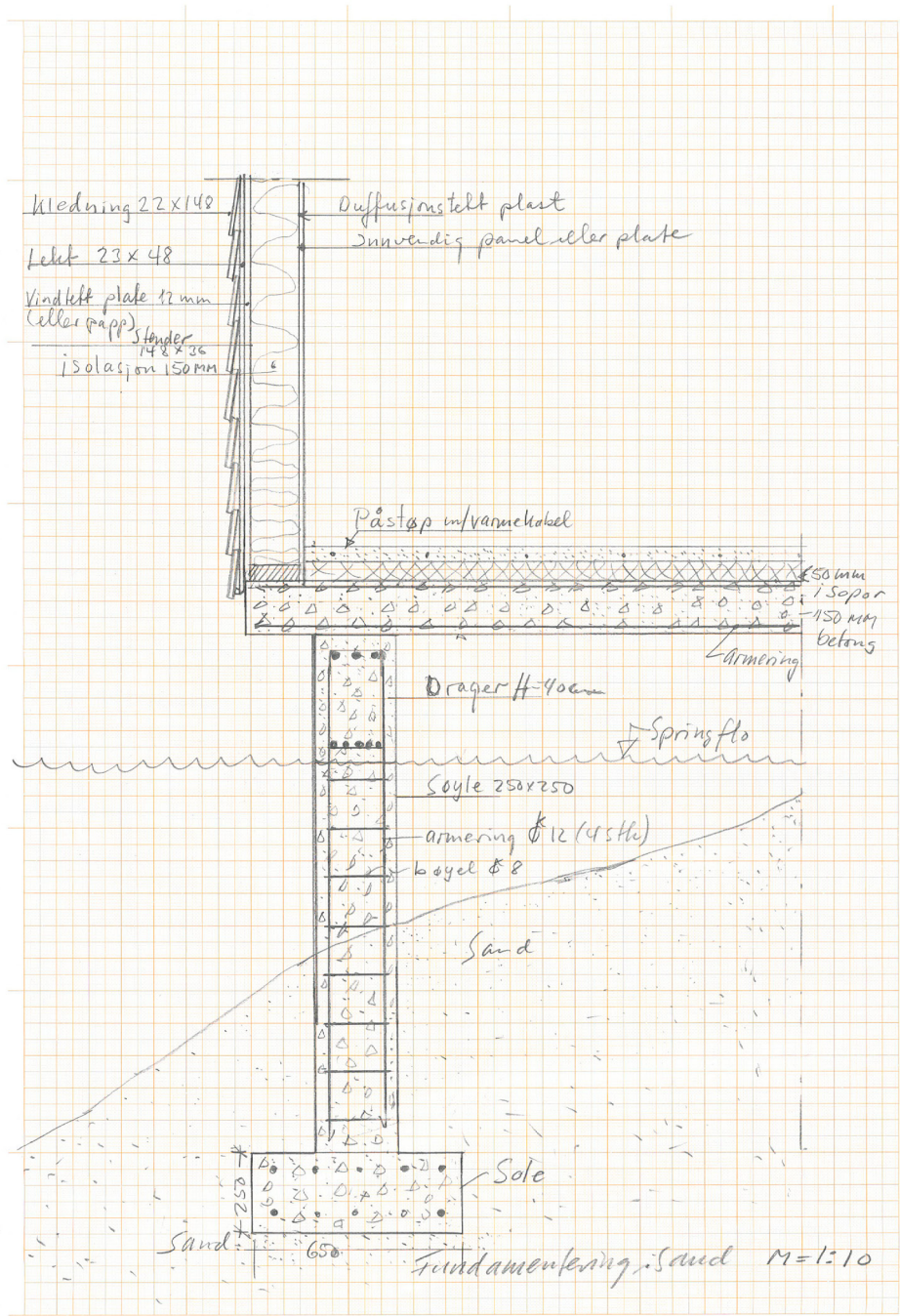

Concrete foundation into sandy ground

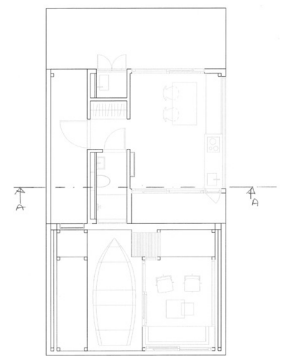
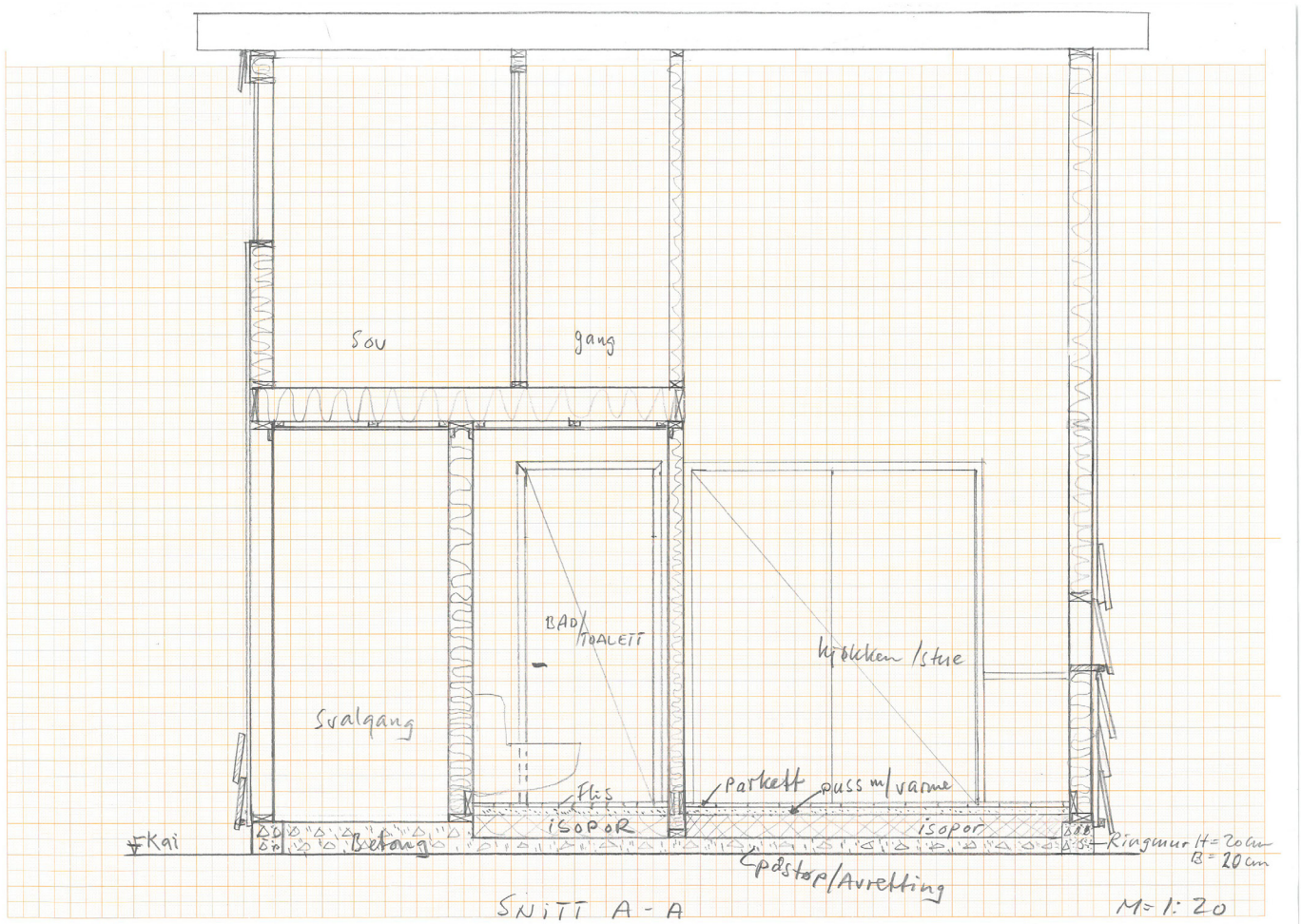

Process sketch of section through cabin by the quay, investigating insulation in wall and floor slab

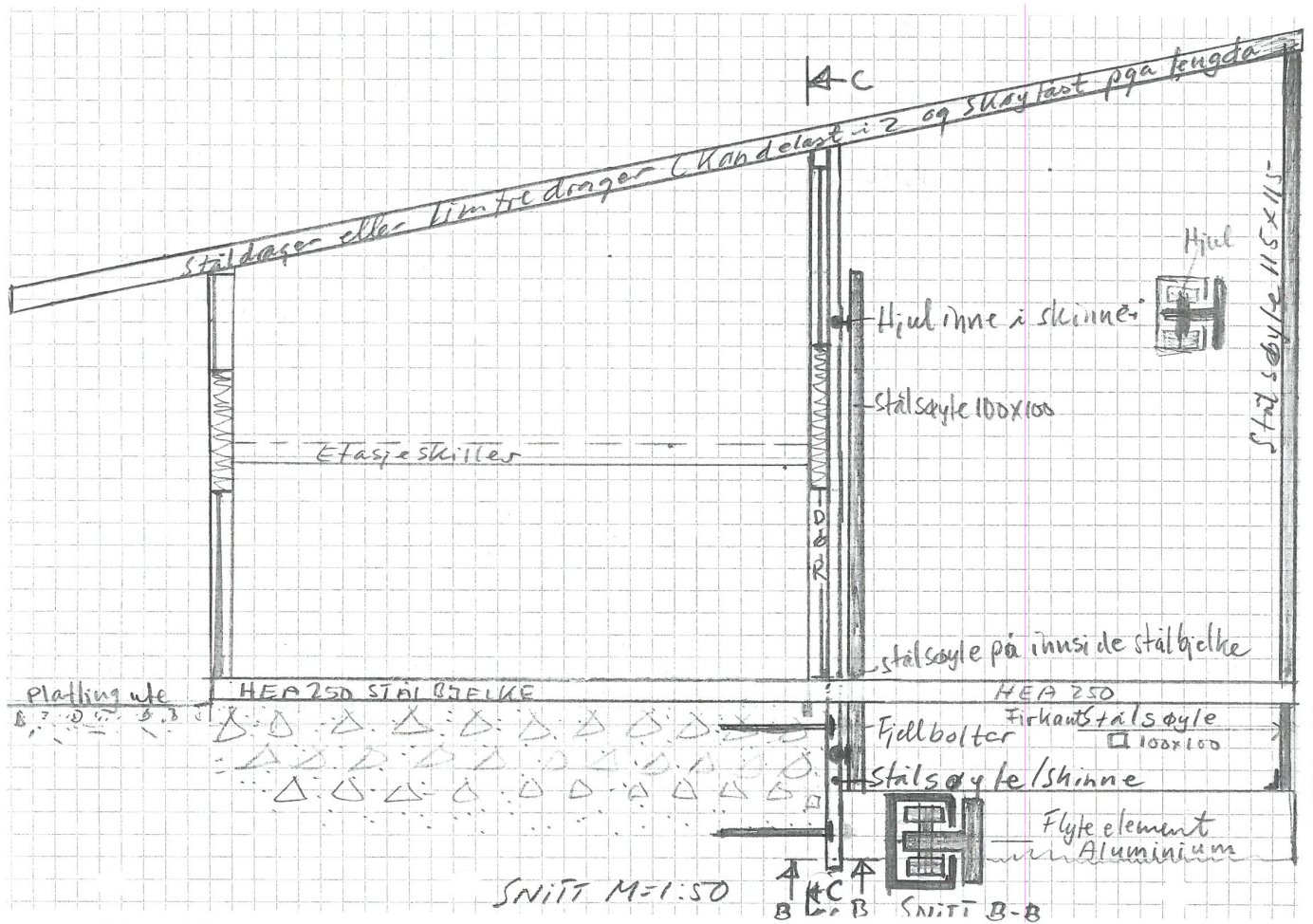

Process sketch of section through cabin by the quay, investigating using a steel beam to support cantelivering section,

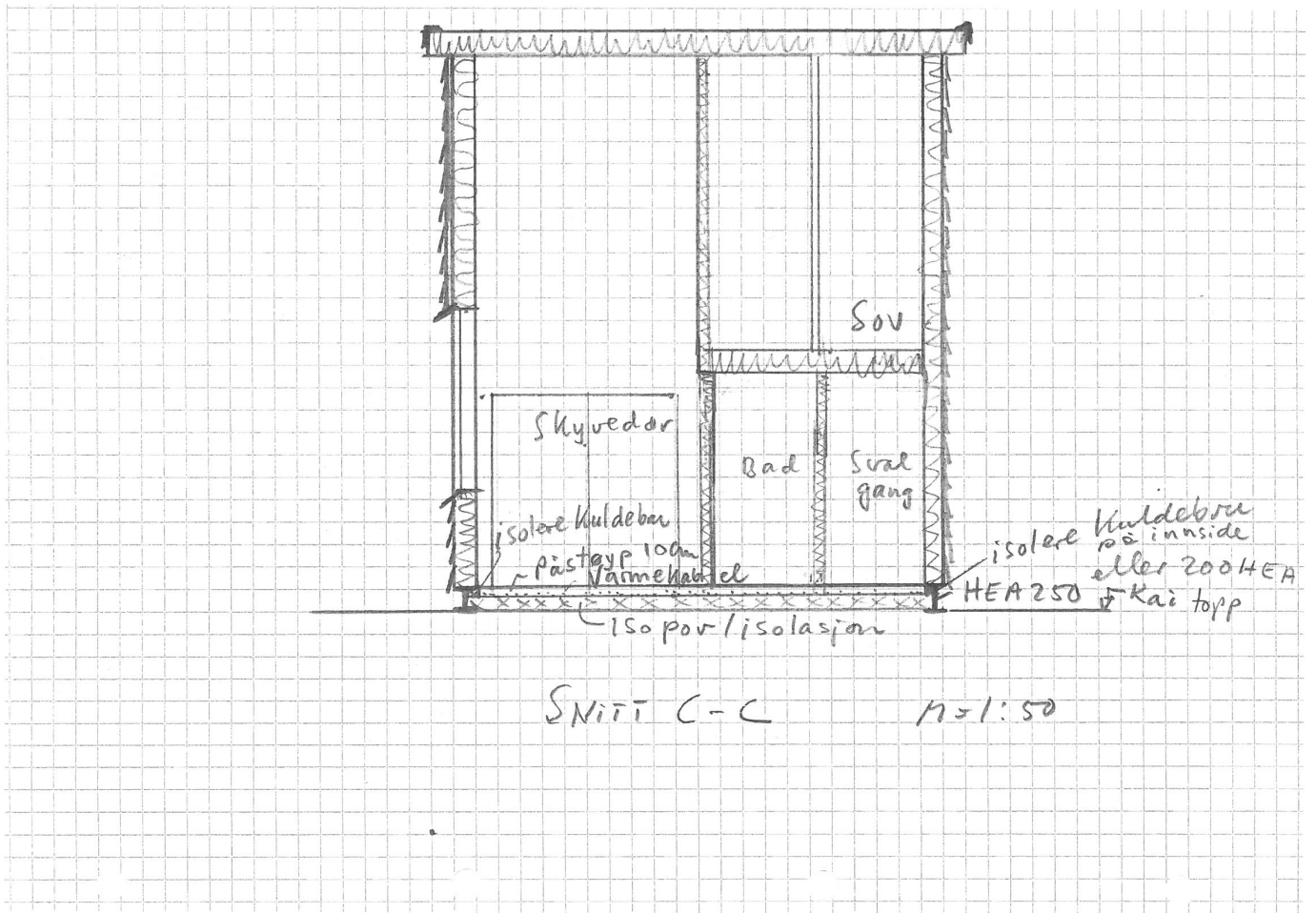

Process sketch of section through cabin by the quay, investigating deviation of rooms and need for insulation

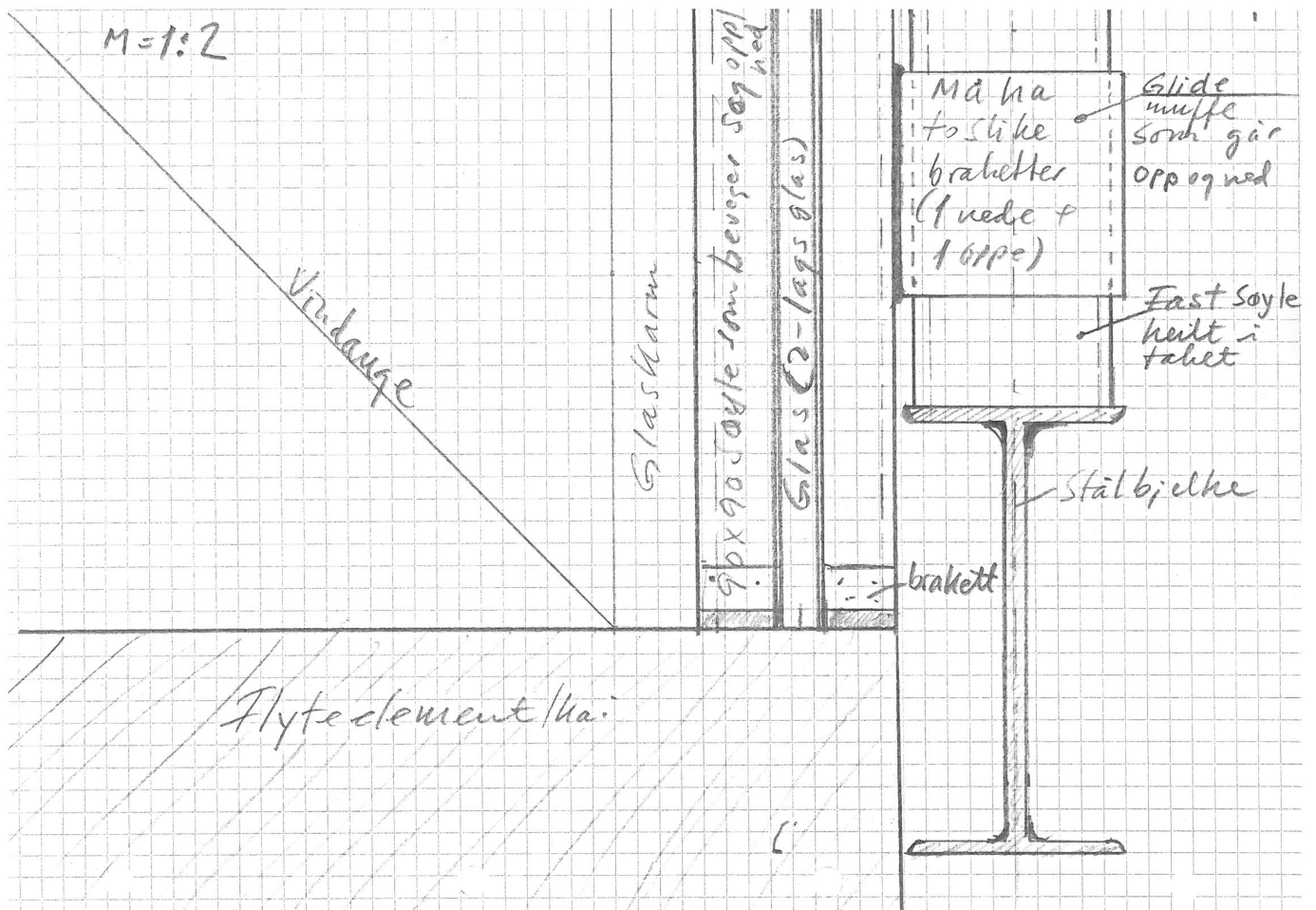

Detail of steel beam supporting movable floor slab

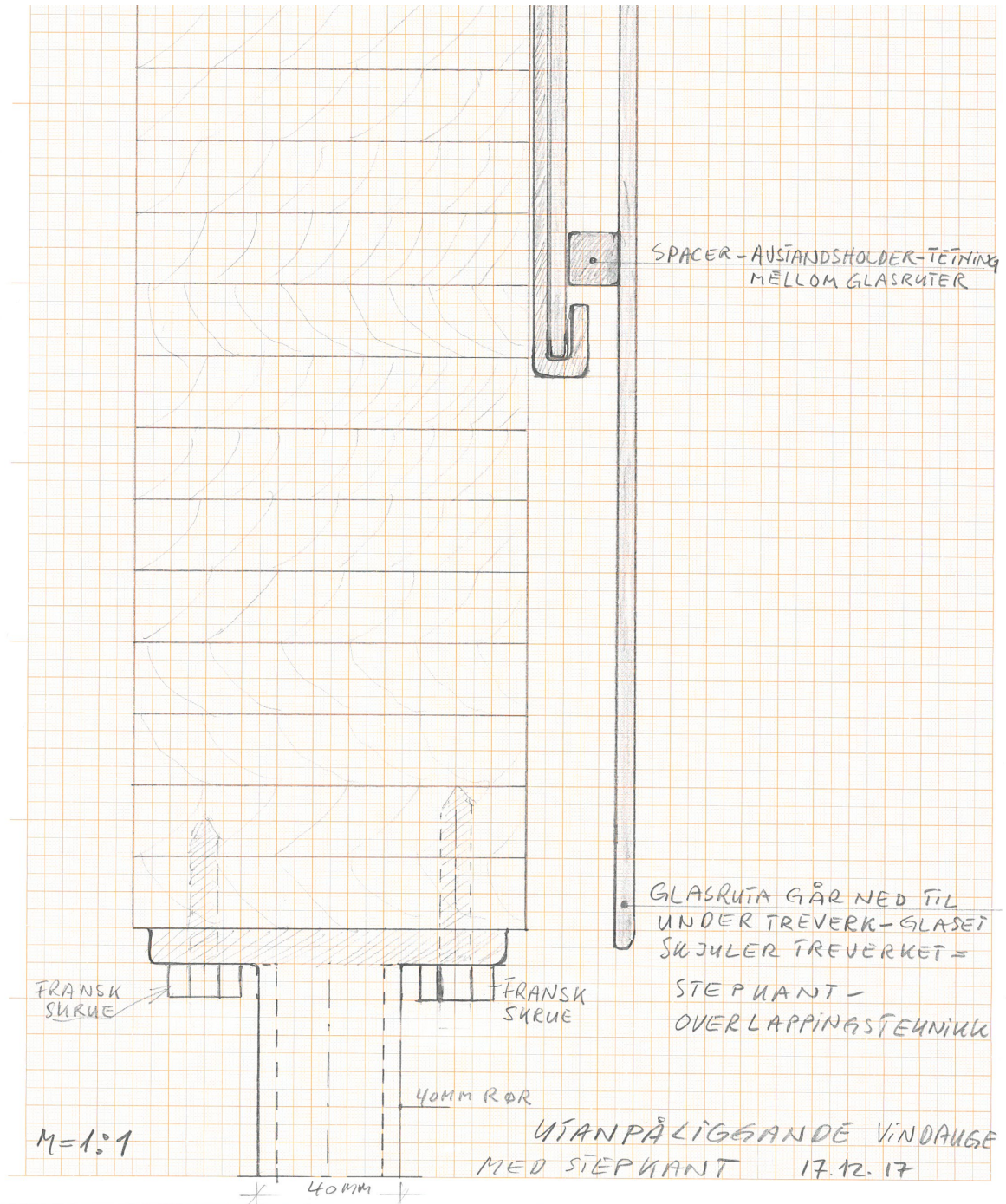

Investigating detail of window and sliding door, with the ambition of creating frameless window from the outside

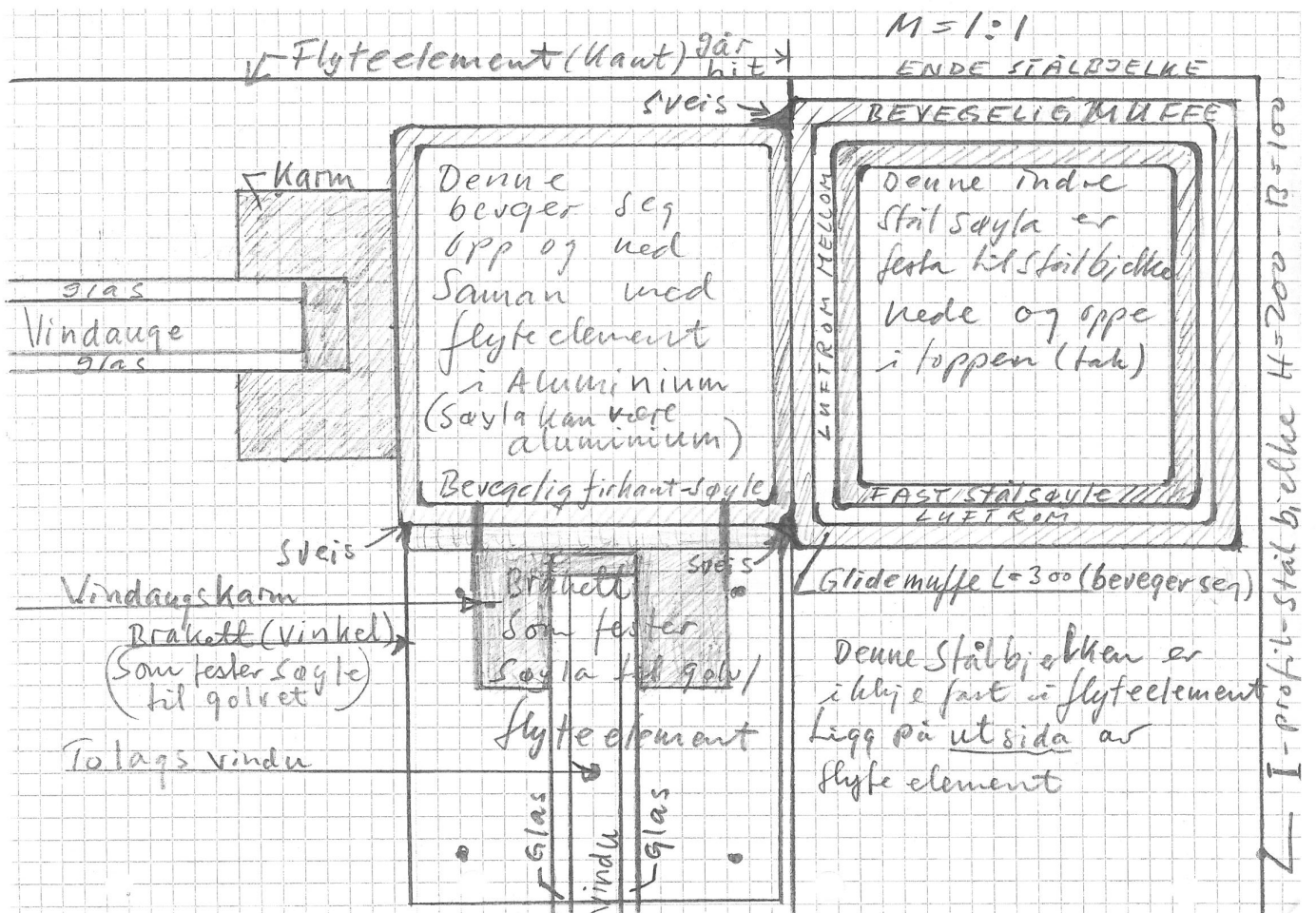

Detail of steel beam and corner window of movable element and connection to main structure

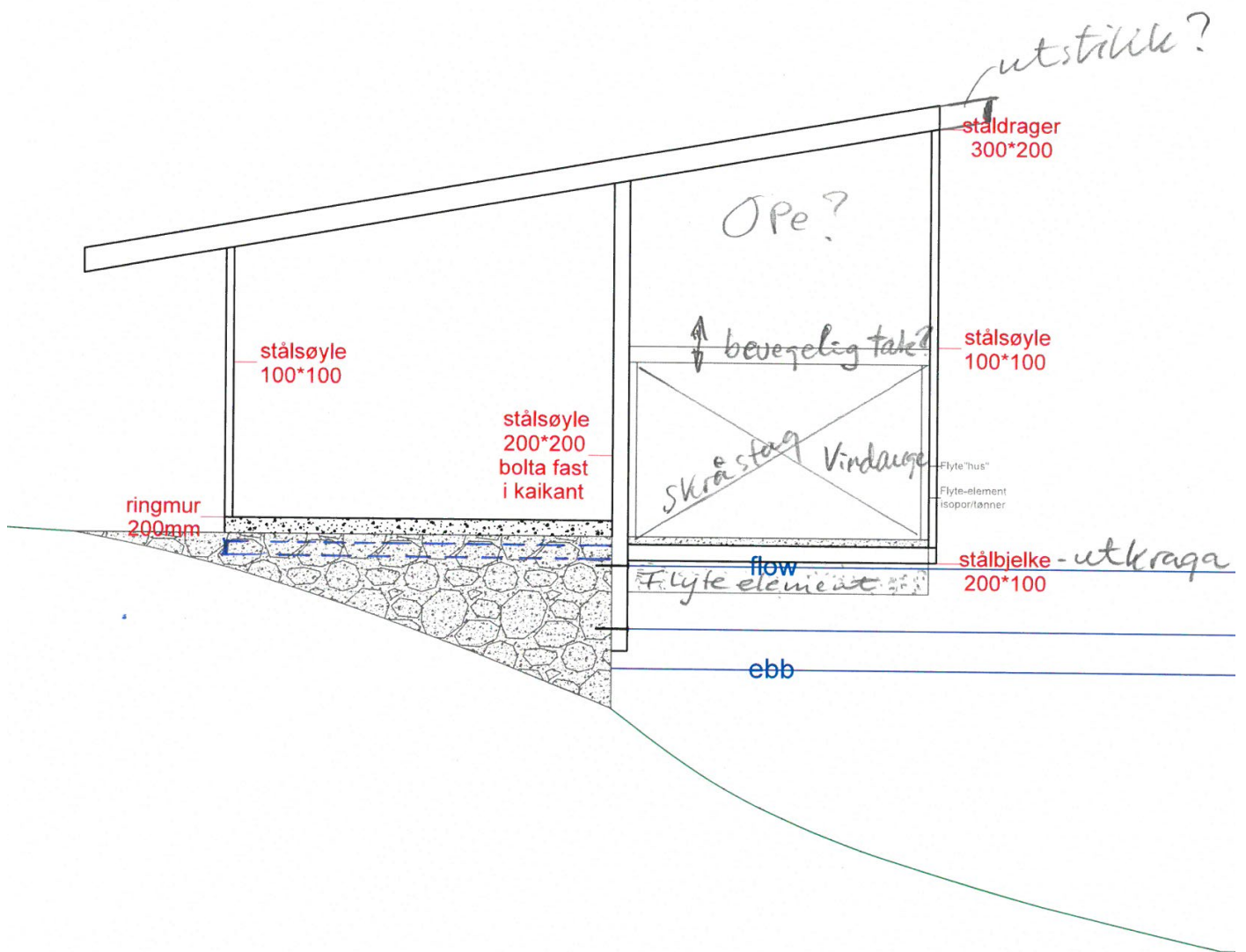

Investigating sizes of steel elements in cabin by the quay

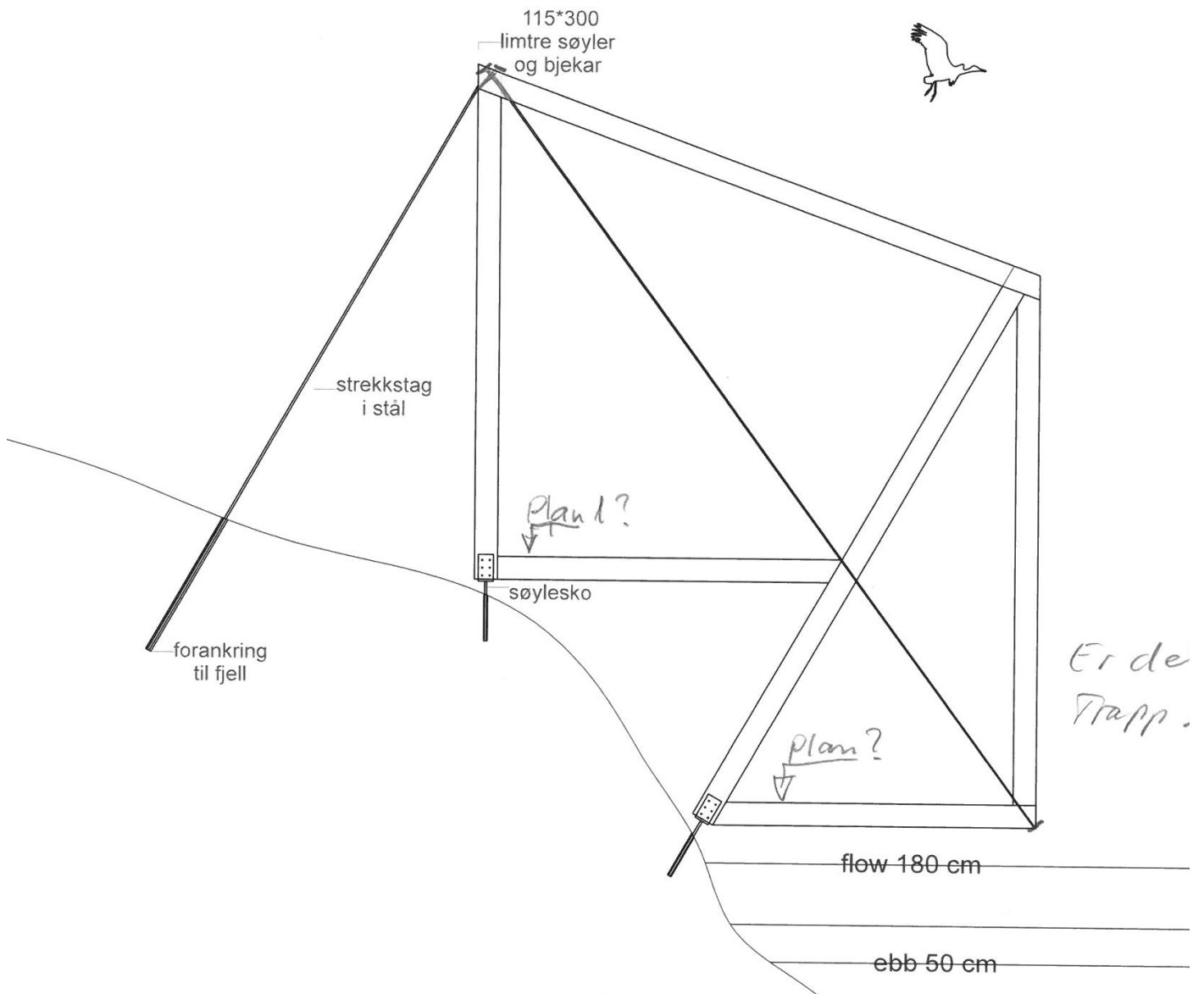

Implementing cross bracing with steel rods at cabin placed on rocky hill

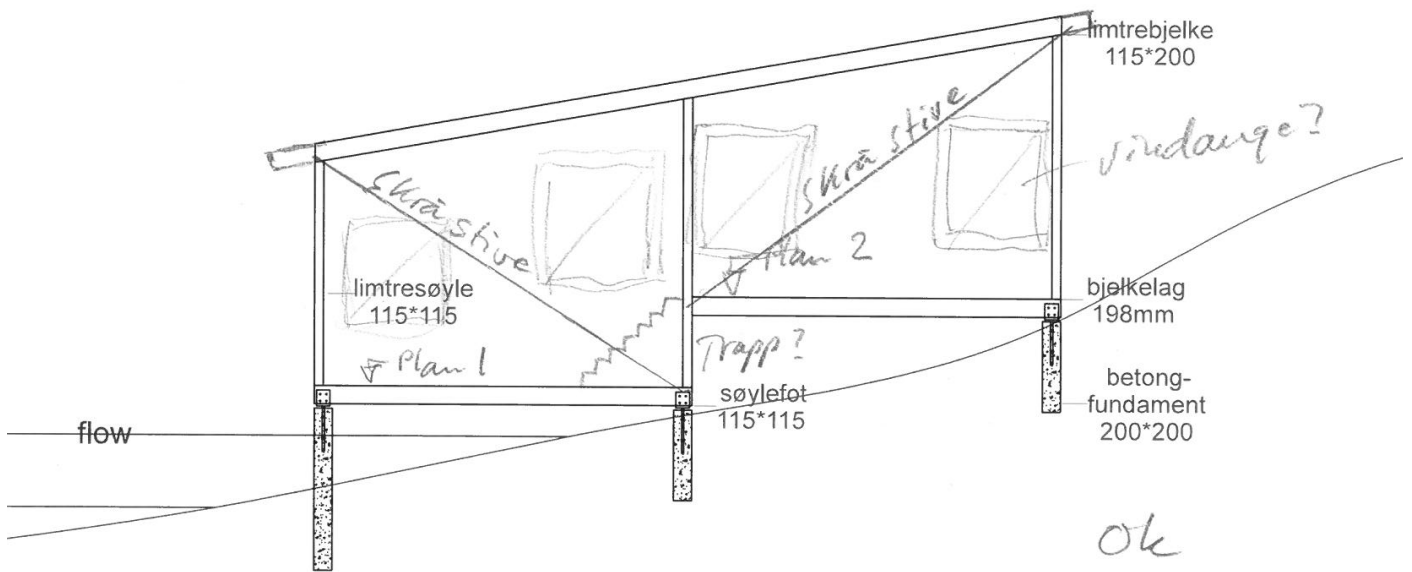

Investigating implementing cross bracing in steel at cabin placed in sandy ground

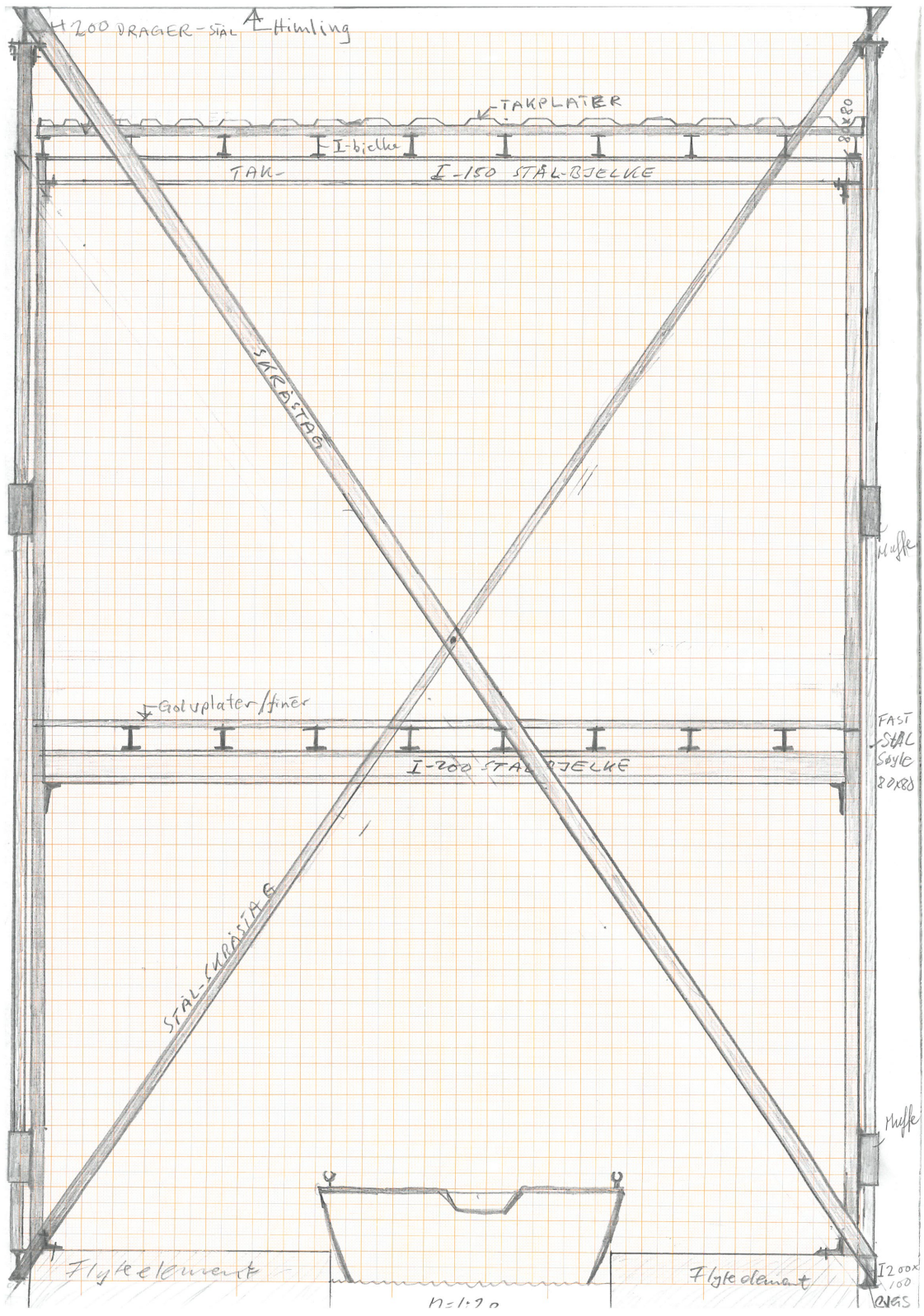

Investigating cross bracing with steel rods at cabin by the quay

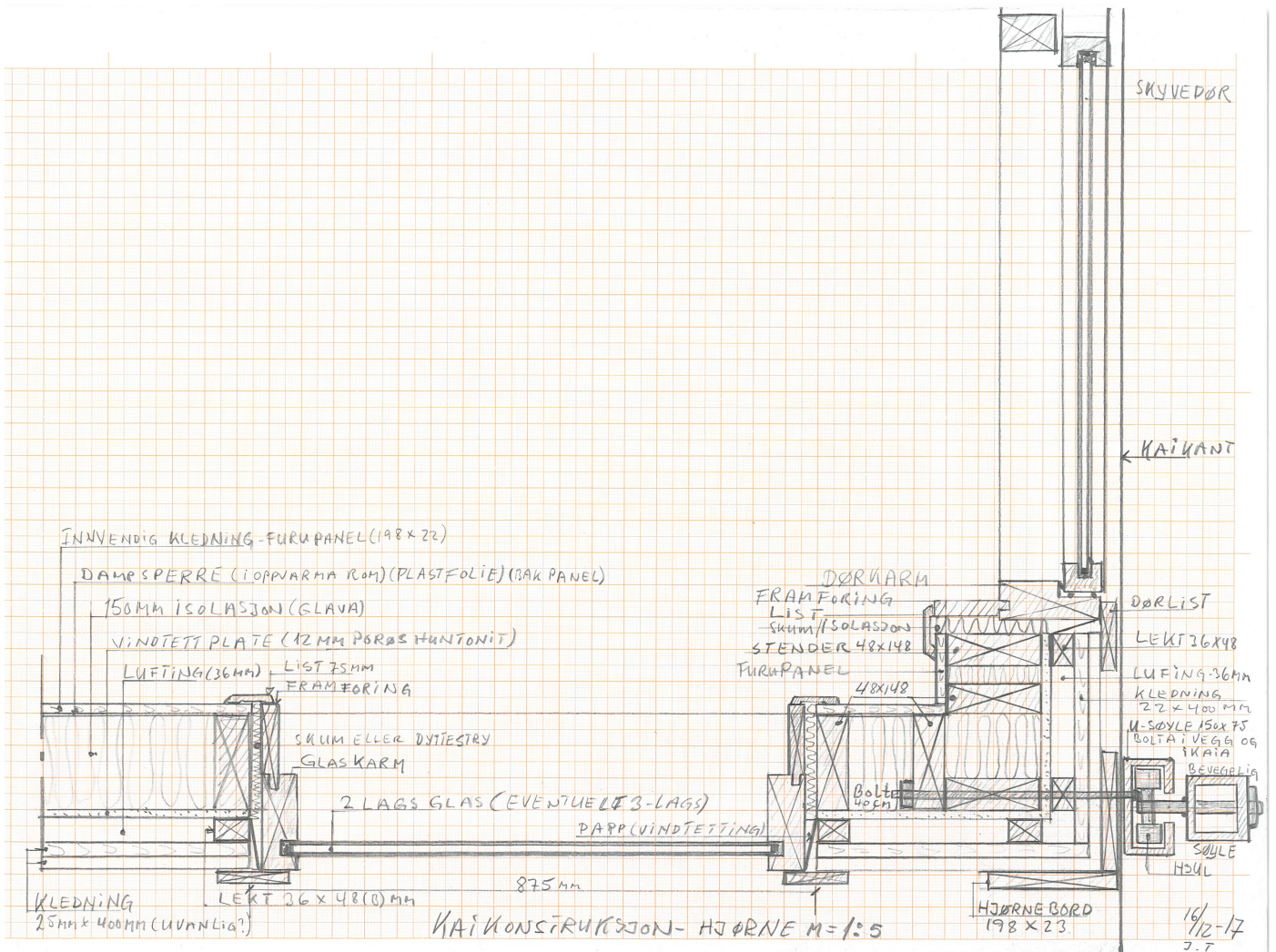

Detail of internal corner with steel column placed on the outside allowing floating element to move within U-shaped steel column

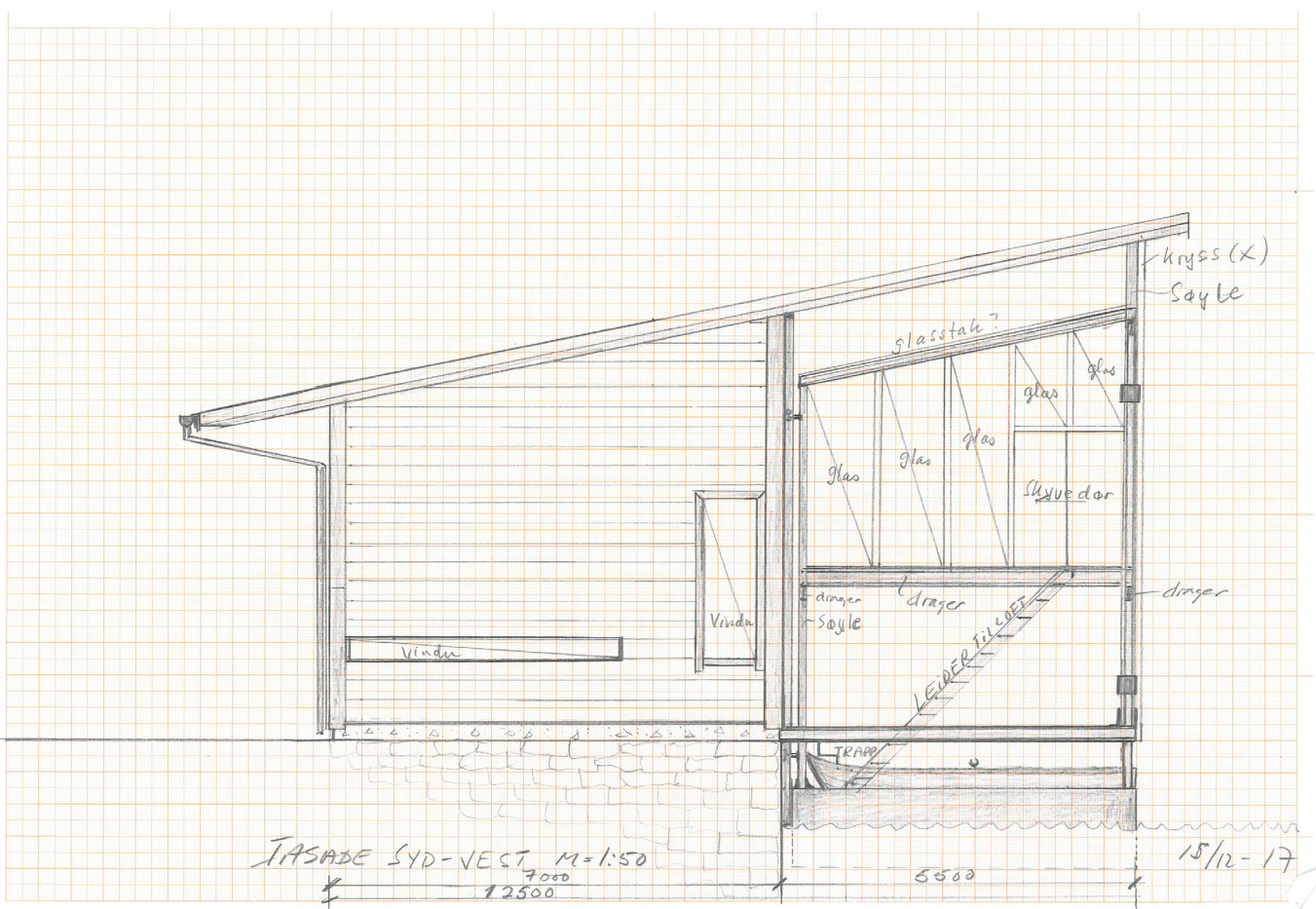

Elevation south west of cabin by the quay with semi high water

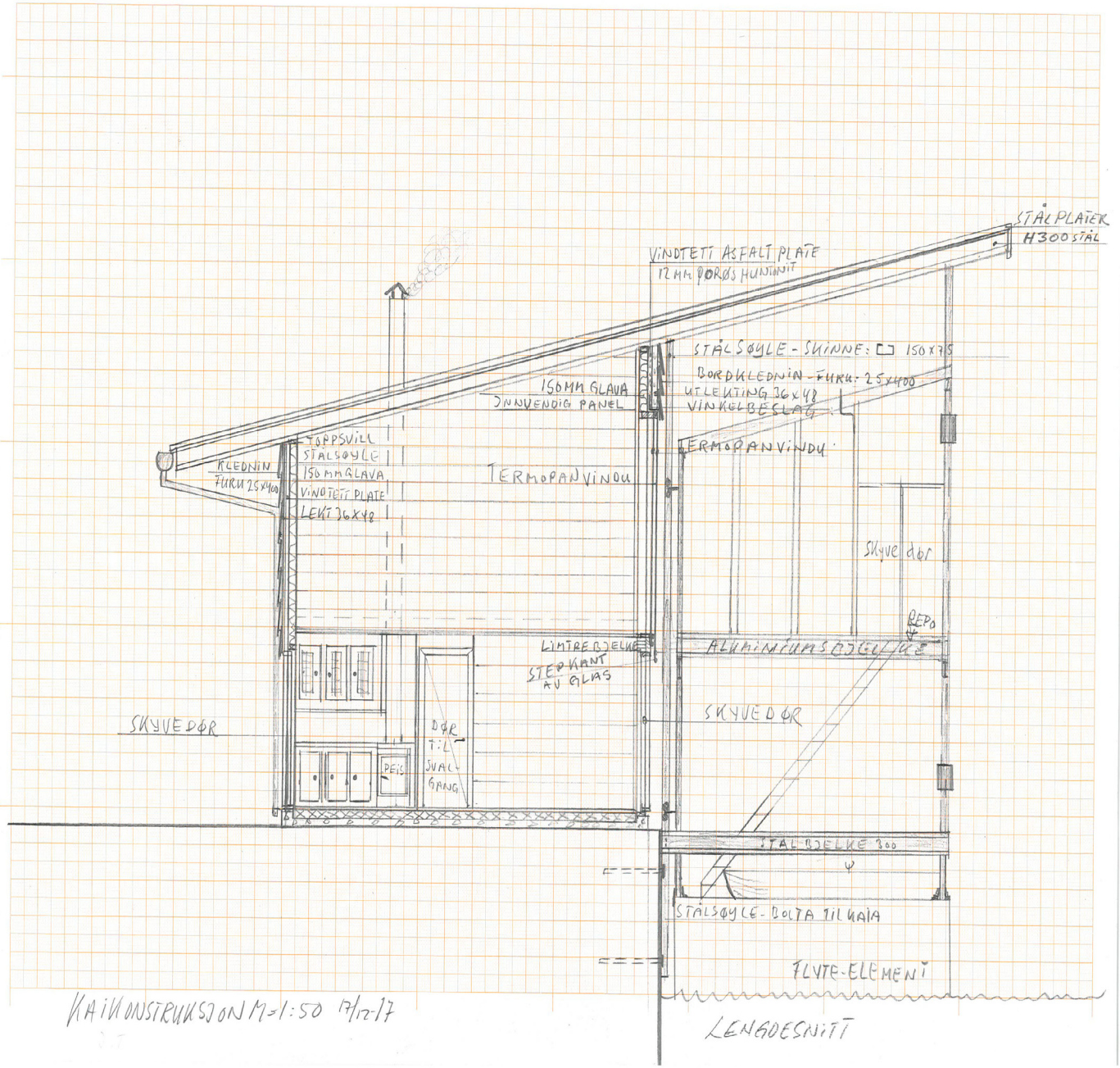

Section after making amendments with length and height of the building to allow movable floor to correspond with maximum high tide

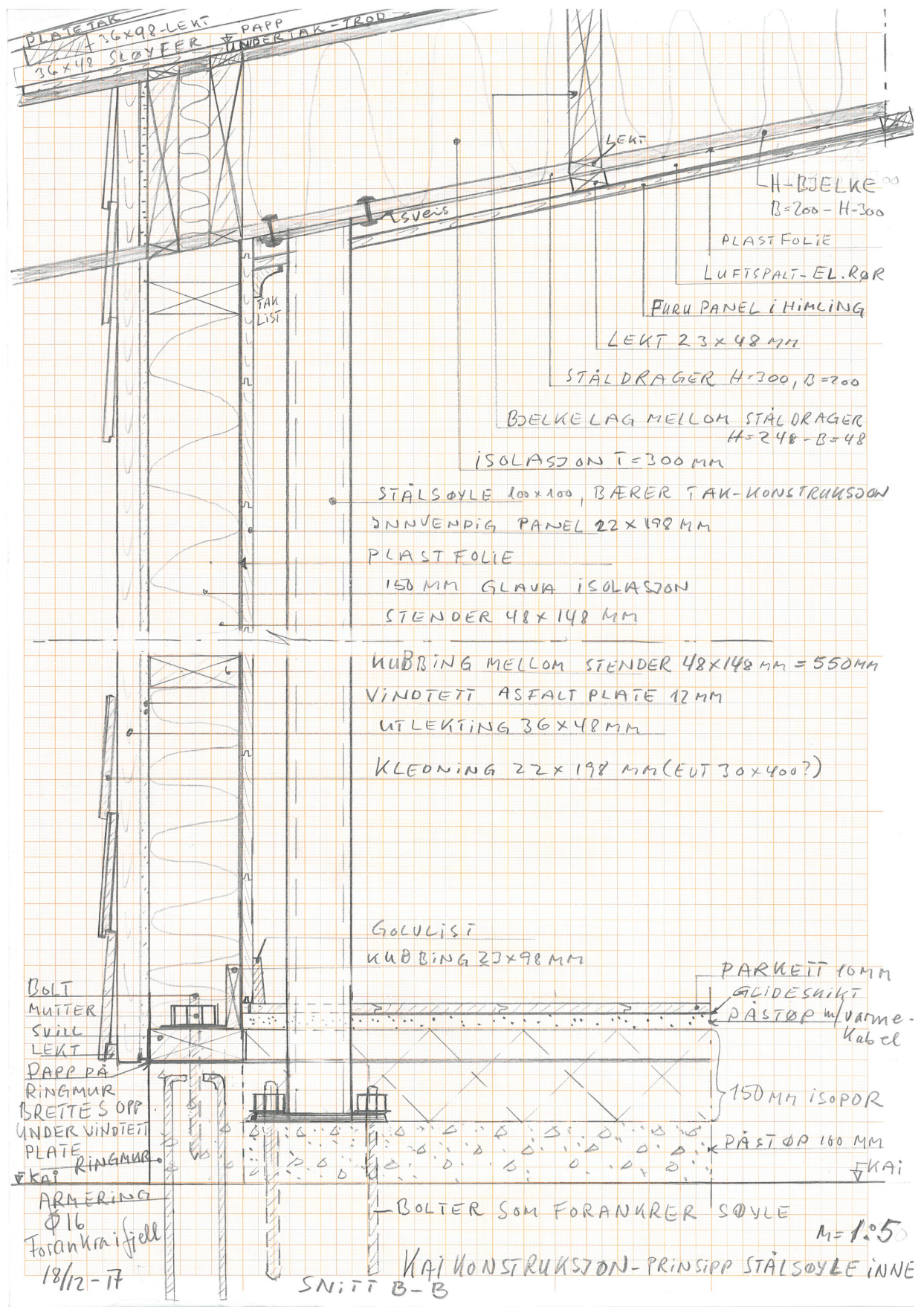

Roof detail along long section exploring gluelam beam and insulated roof and insulated external wall, exposing steel column in the inside

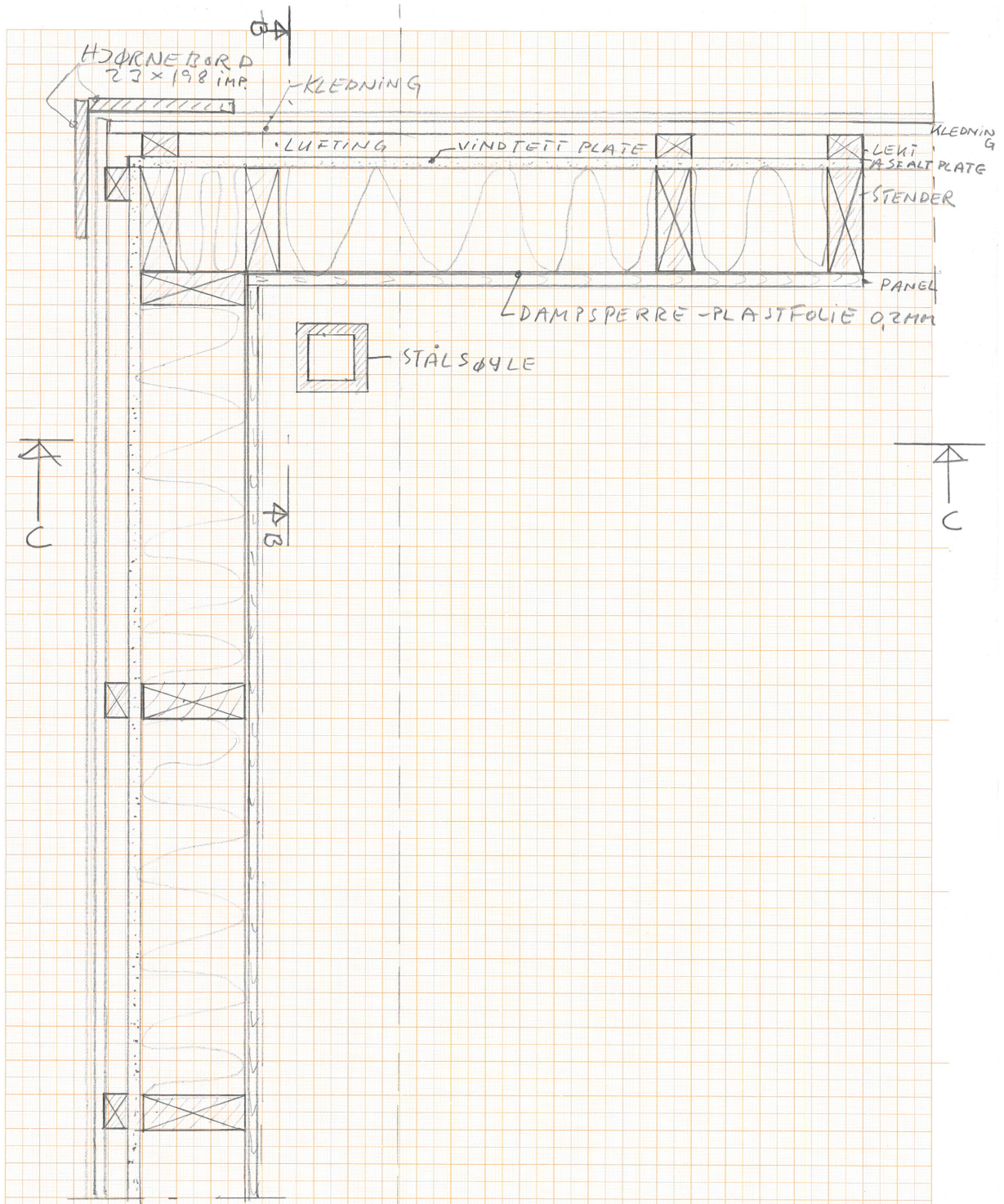

18/12-17
 KAI KONSTRUKSDON - PLAN
 JÄNVERN DIG STÅL SØYLE M5:5

Section cut in plan through exterior wall and exposed steel column in the corner of the room

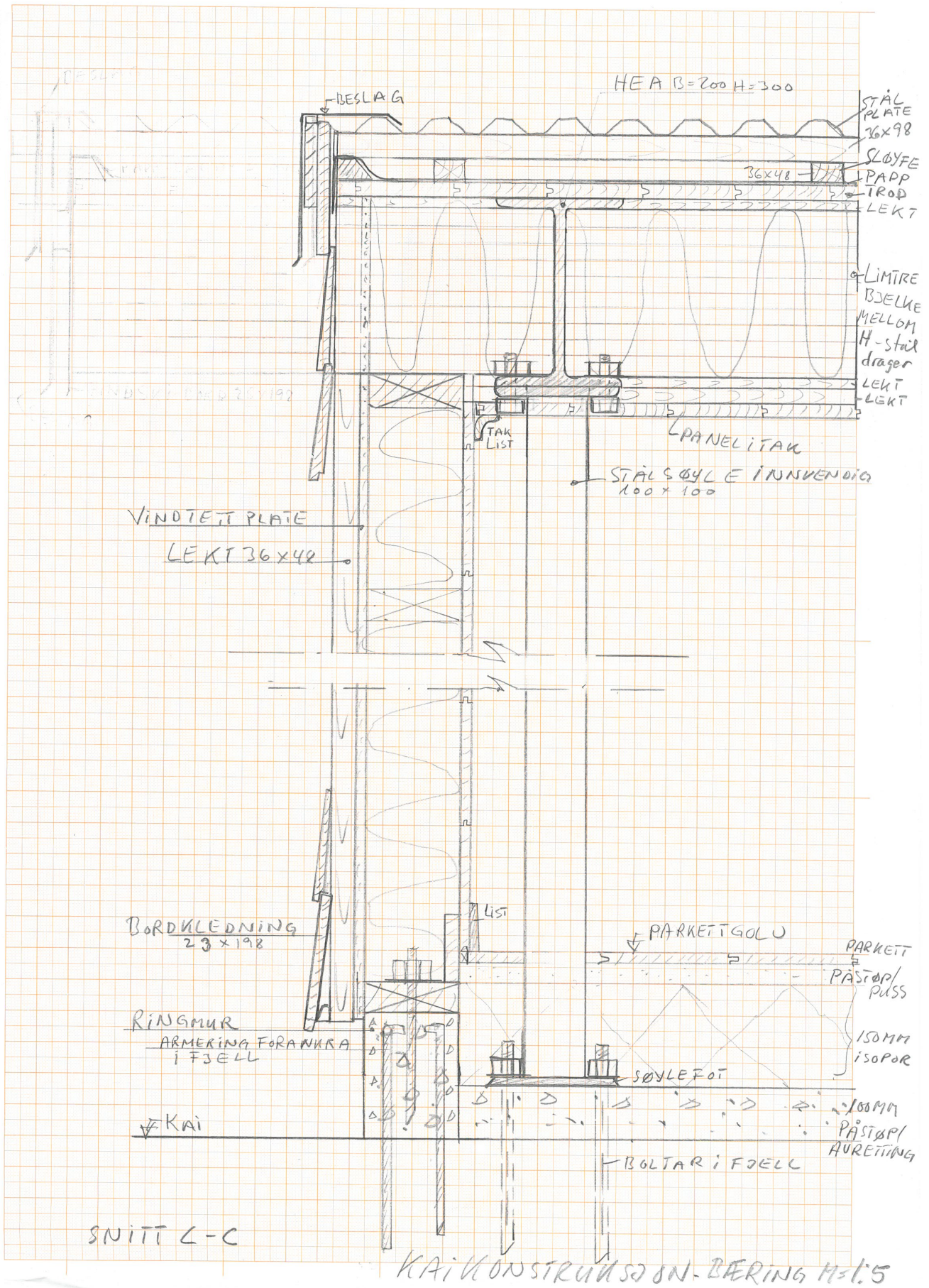

Roof detail of steel beam and glue lam beam with insulated external wall, exposing steel column in the inside

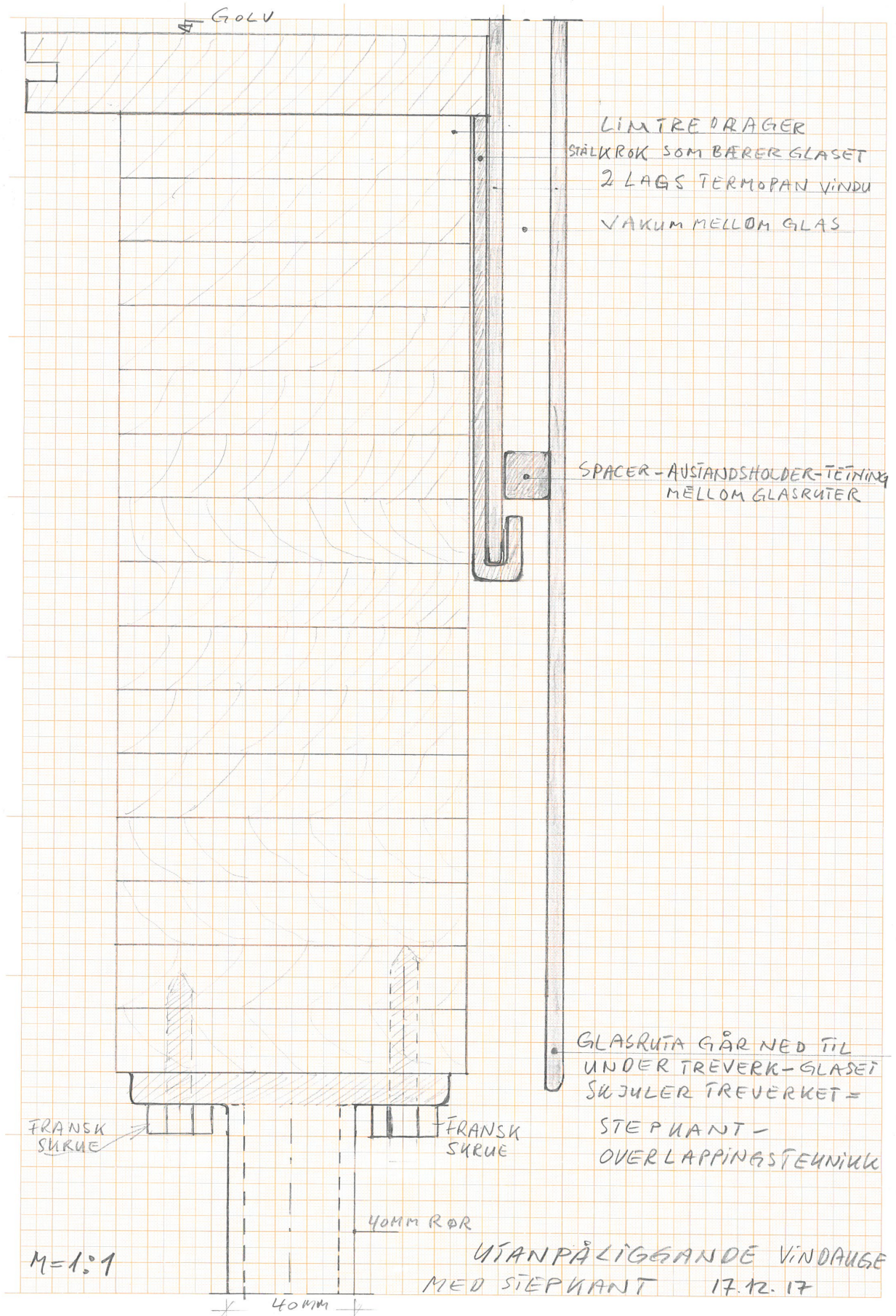

Wall detail investigating overlapping window to allow glass surface to extend beyond timber structure