

AN  
ANIMAL  
BOOK

the animals, (the visitors), the house  
are all my animals.

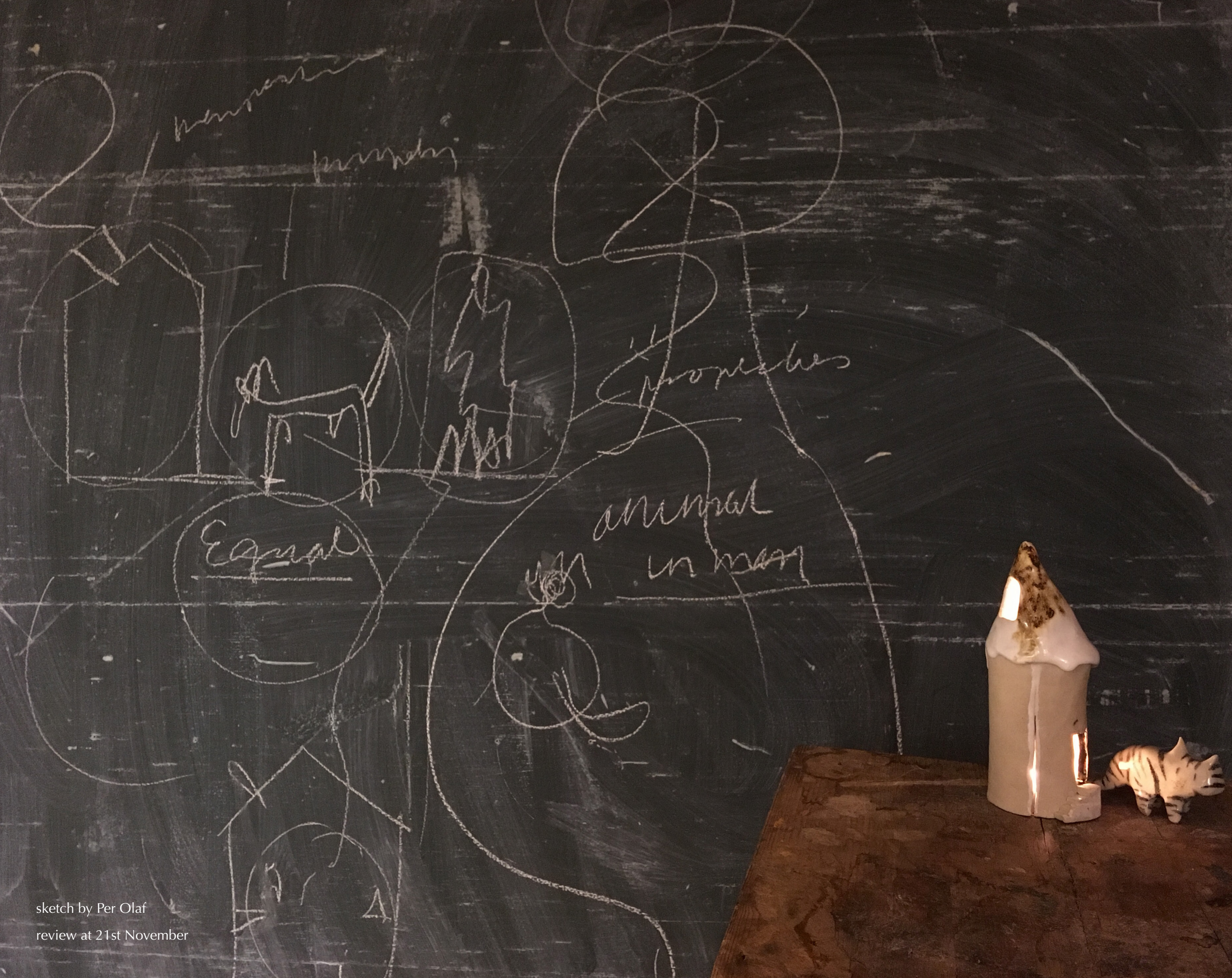



memories  
punching

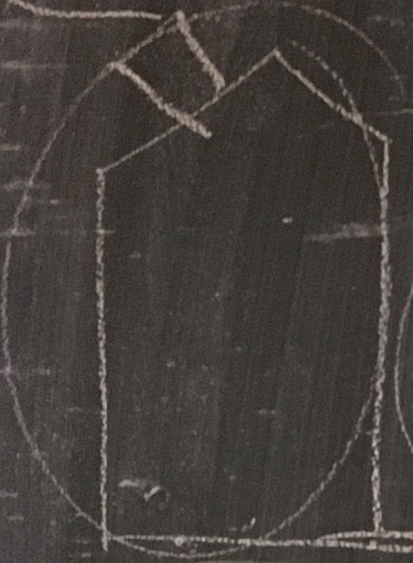

Chronicles

Equal

animal  
in man

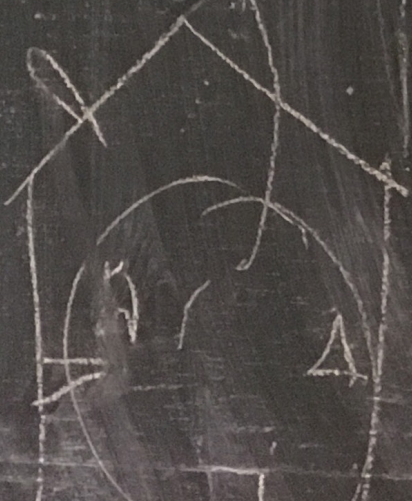

sketch by Per Olaf  
review at 21st November

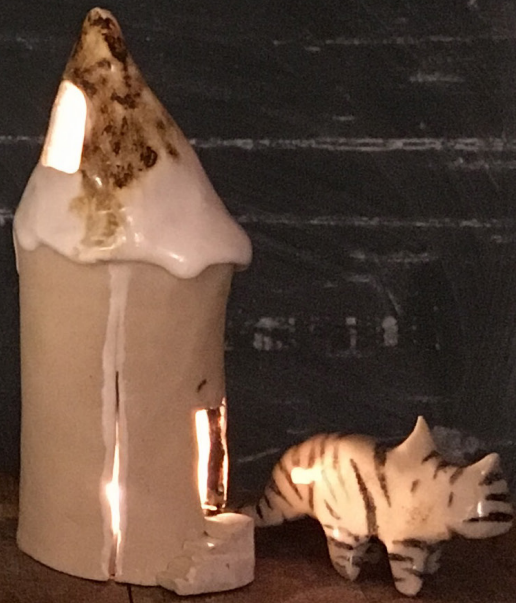



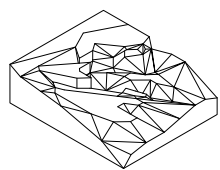

Animal 01 | the site / big animal 01  
plaster, plasticine  
14x17x5cm





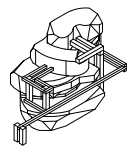

Animal 02  
plaster, beech  
17x10x7cm









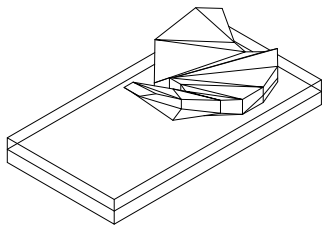

Animal 03 | the site / big animal 02

a piece of wood from woods in Oslo, black walnut, epoxy, plasticine

31x16x12cm



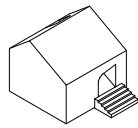

Animal 04 | the house 01

plaster

11x9x9cm

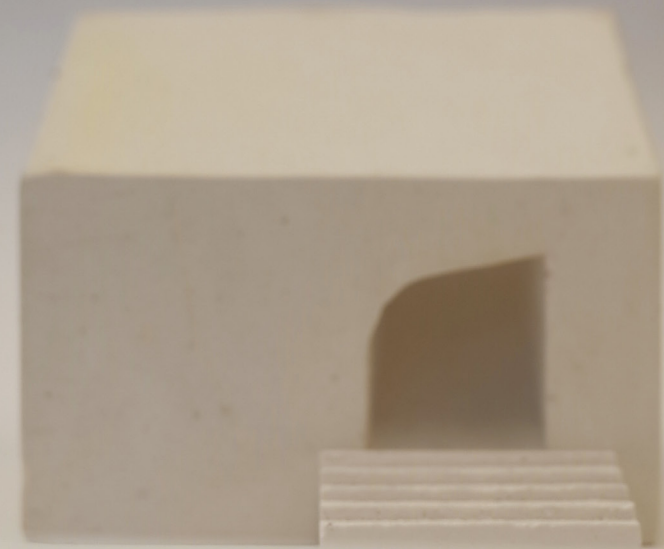



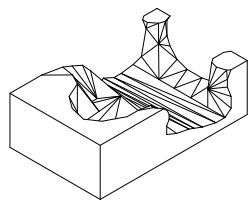

Animal 05 | part of the site  
pine wood, white paint, plasticine  
22x14x7cm







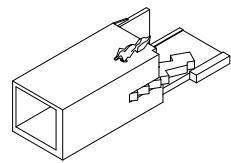

Animal 06 | the studio 01  
plaster with coffee, black walnut  
15x7x6cm



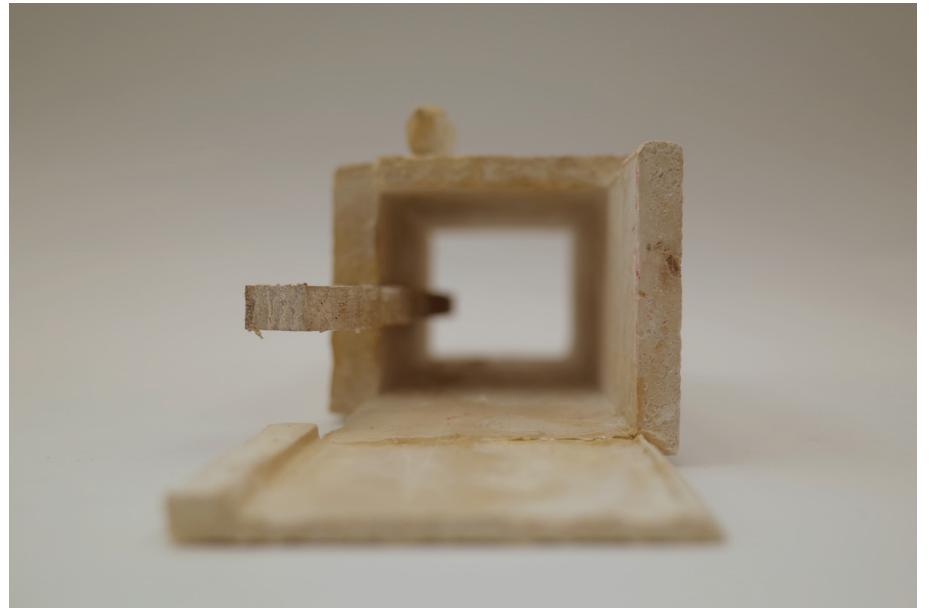



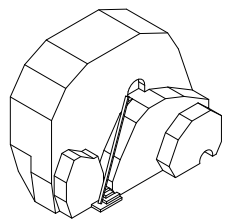

Animal 07 | the potato cave and another  
plaster, beech, plasticine  
22x6x17cm





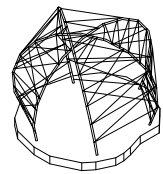

Animal 08 | the lamp  
plaster, copper wire  
15x14x14cm

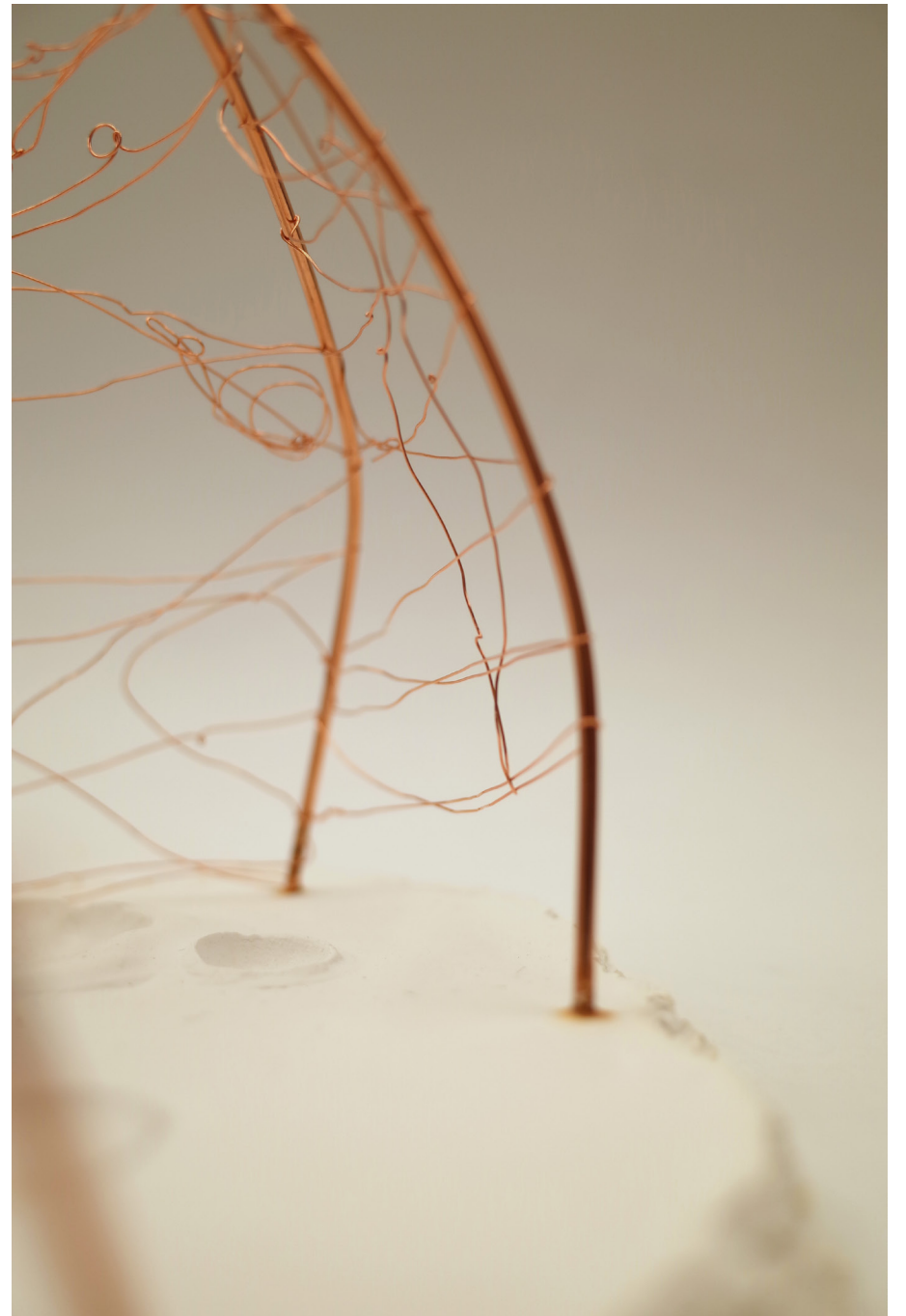



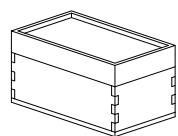

Animal 09 | 知更鸟的盒子



Animal 10 | a planet  
epoxy, *Acalypha hispida*  
5x5x4cm







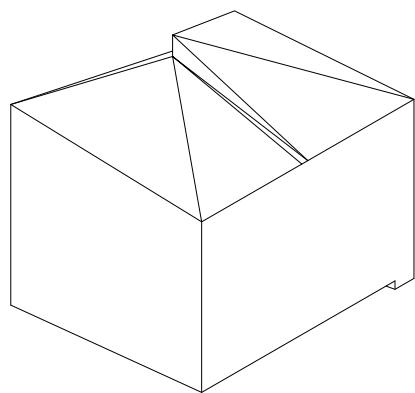

Animal 11 | a vistor

a part of an unkown tree, found on the road in 6th September,  
cut by friendly cutter to make it easier to carry

30x27x27cm



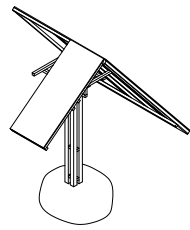

Animal 12 | the house 02 / the big roof  
plywood, beech, stone from Lista  
20x14x21cm







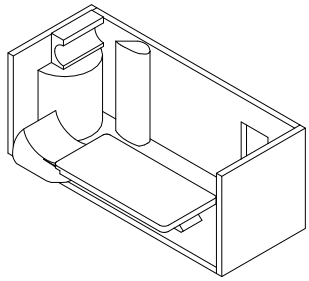

Animal 13 | the sutdio 02  
oak, beech, pine wood, cherry wood  
32x13x13cm

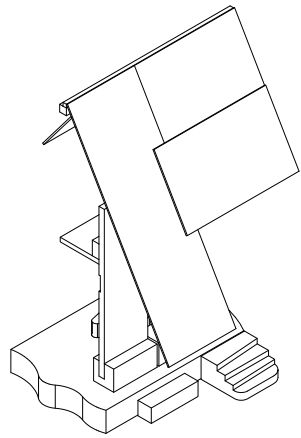

Animal 14 | the house 03 / the house for the big roof  
oak, beech, pine wood, black walnut, plywood, plaster

28x25x35cm















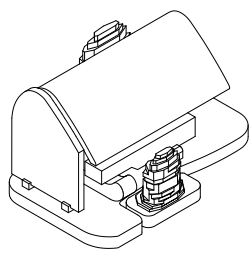

Animal 14 | the studio 03  
oak, beech, pine wood, black walnut, birch, plaster  
27x18x15cm



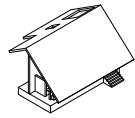

Animal 15 | the house 04  
cardboard, beech  
10x6x7cm







Animal 15 | the studio 04 and me  
cardboard, plasticine  
6x4x4cm





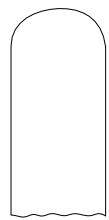

Animal 16  
plaster, watercolor in Prussian Blue  
10x10x21cm





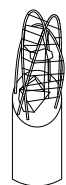

Animal 17 | echo of the lamp  
plaster, pigment in Prussian Blue, copper wire  
6x6x18cm





Animal 18 | an elephant or anteater

talcum

7X4X6cm





Animal 19 | a lion  
talcum  
5x7x7cm





Animal 20 | a fox  
talcum  
5x7x5cm





Animal 21 | a sheep

talcum

8x3x7cm





Animal 21 | a cat  
talcum  
8x3x7cm







Animal 22 and 23

clay (900°C ), white glazing with pencil, white glazing with  $\text{Fe}_2\text{O}_3$ (1240°C )

9x2x5cm+7x6x17cm

Animal 24 | a visitor  
clay  
10x3x10cm





Animal 25 | a cat  
clay  
5x2x2cm





Animal 25 | a cat  
paper clay  
2x5x3cm





Visitor 01 | a balcony  
Fall 2017  
wax, copper wire, dried plant  
4x8x19cm





Visitor 02 | a memory of Lista  
Fall 2017  
plaster with coffee, copper wire, aluminium sheet  
16x16x15cm





Visitor 03 | a pirate cat  
Fall 2017  
birch?  
10x9x16cm





my grandma's cat and the bird





my cat in the fish tank



my cat





my friend Pelle Parafin and his bed



a drawing for a visitor  
watercolor





my friend Fifa in 2016



thr deer at Lista



