







## *Index*

1. Introduction

2. The Start

3. The ritual

4. Searching and drawing

5. The placing







# 1. Introduction



I have an obsession of placing two different things together, or several things in relation to each other. Through my works at Body & Space Morphologies, this has been the reoccurring theme. In my windowsill, I have placed two wooden containers, that if placed on top of each other they fit perfectly. One is like a round bowl and one is like a round box with a lid. I let them stand next to each other. In this way there is a tension between them, a longing for them to be stacked because of the possibility of it. And sometimes I can find them standing like that. Because my partner sometimes cannot fight the urge to put them like that, but then I put them away from each other again, because for me the longing between them is more satisfying to see than their perfect fit.

I often see objects and then I see in them a longing for something else. For me this obsession or act is about not wanting to be alone. It's about finding the balance between closeness and distance. That's also why this sentence from the writer Thomas Espedal "He loves to be alone, as long as she is in the room next to him" lingers close to my material acting and sensing.

And because of this obsession for seeing or seeking longing between objects, I decided on making two houses in the landscape where I grew up. On a site on a hill near the ocean where cows one time ate grass. I wanted to experience the place again, a place that is very present in my memories of childhood, through a new kind of acting with the place. As a child I dwelled a lot in this landscape through making wooden huts or caves in the tall grass, and now I wanted to dwell there by reliving the memories through the architecture of two houses. I wanted to make two objects and place them in this landscape, like my two containers in my windowsill.

*Marie Meulman 12.12.19*





## 2. The Start



The material acting started in my pre-diploma with the making of wooden figures that in my mind was placed in the landscape of the island and the site. The figures were made by cutting big pieces of wood in smaller pieces, then I made cuts in them, and afterwards I put them together again with the help of a stick inside the cuts. The wooden figures made clear characters, and I named them. Then the urge to put them together in couples emerged. I had to see if they could give me more satisfaction, because I really liked them as individuals, but I had to see if they could and if I could be even more happier. I placed them together, and so many of them had one or two they connected with. When put together they seemed humbler then when they were standing alone.

To get into the interior mood of the houses I made spacious models where I tried to leak the wooden figures in. Because they had given me very much in relation to finding an architecture that I want to neighbor. And the key was searching for the nooks' of the houses. Like the cuts in the wooden figures that was made to contain the sticks, I wanted to make nooks in the houses to contain the human body.

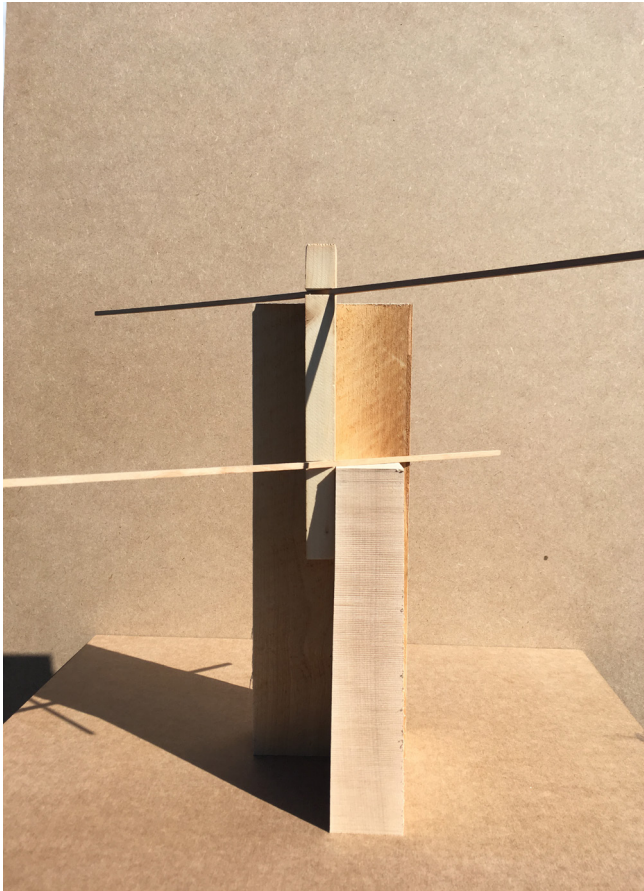

*Queen Bee*



*Tallest boy in  
class*



*Moon landing*

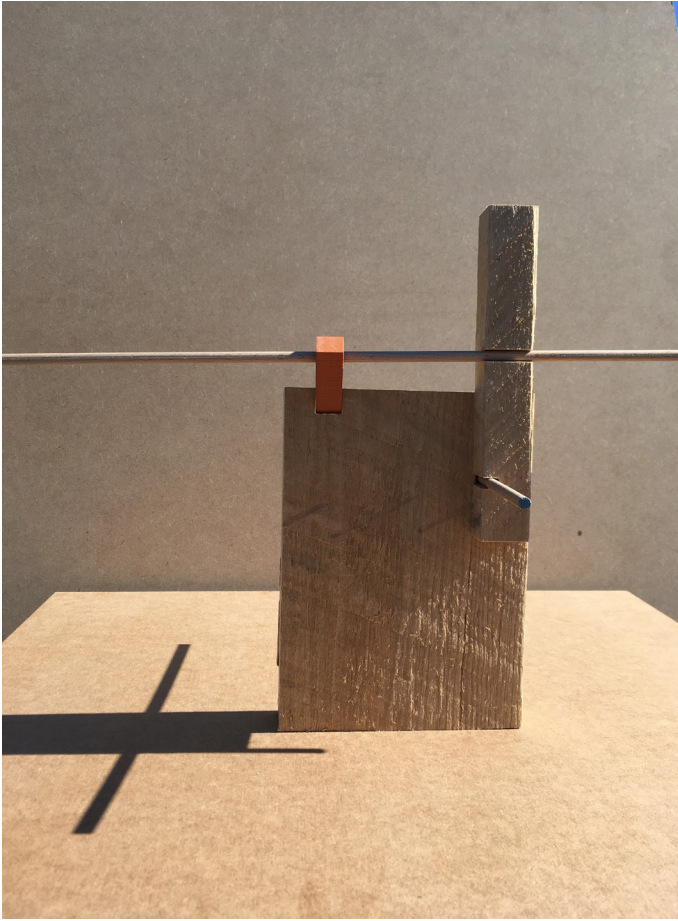

*Peacock*



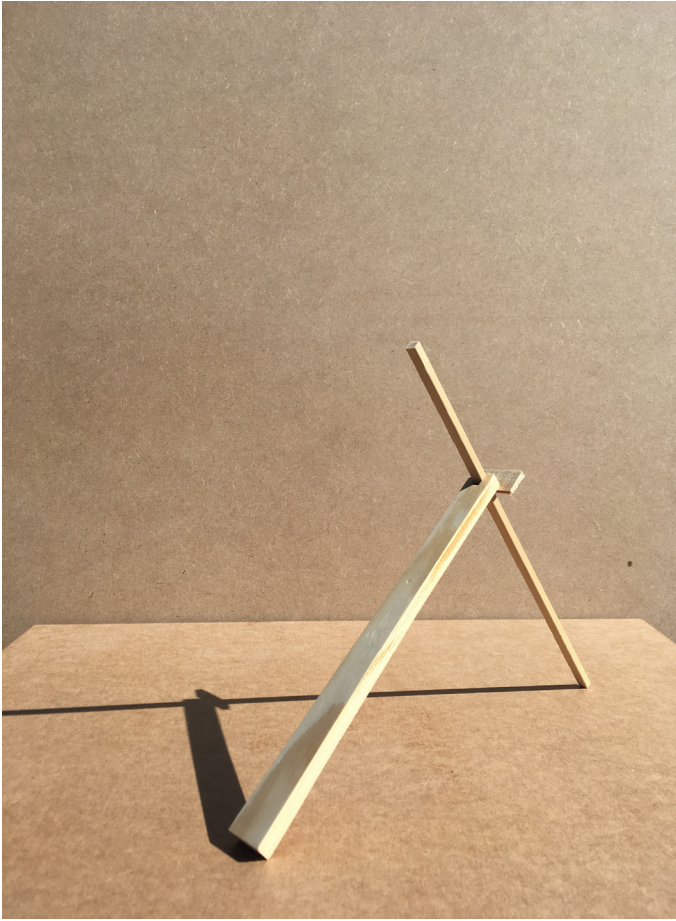

*Bone*





*Kiss*

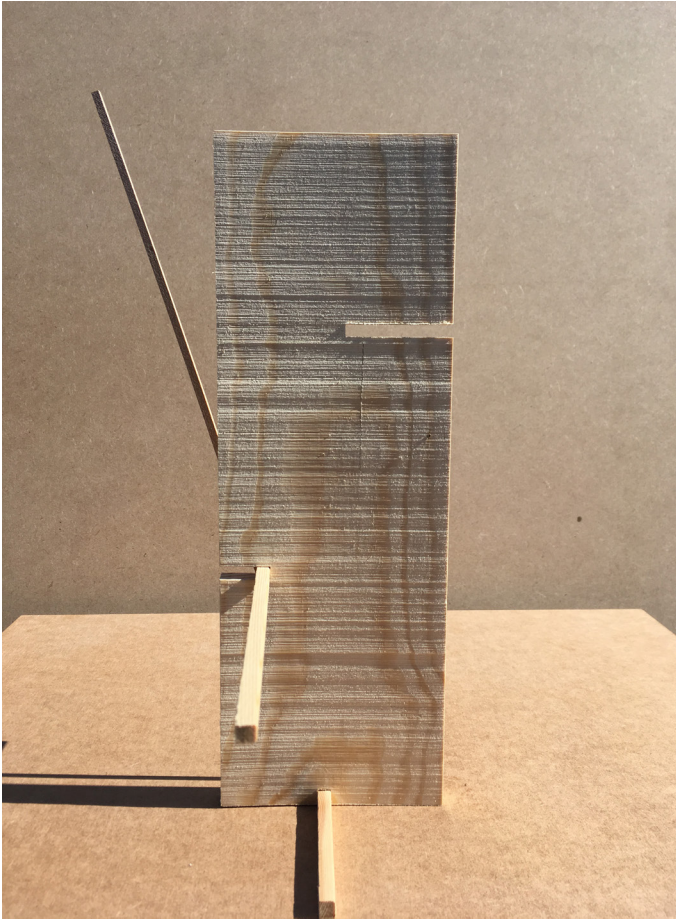

*Eyes in the back of  
the head*



*Worms hole*

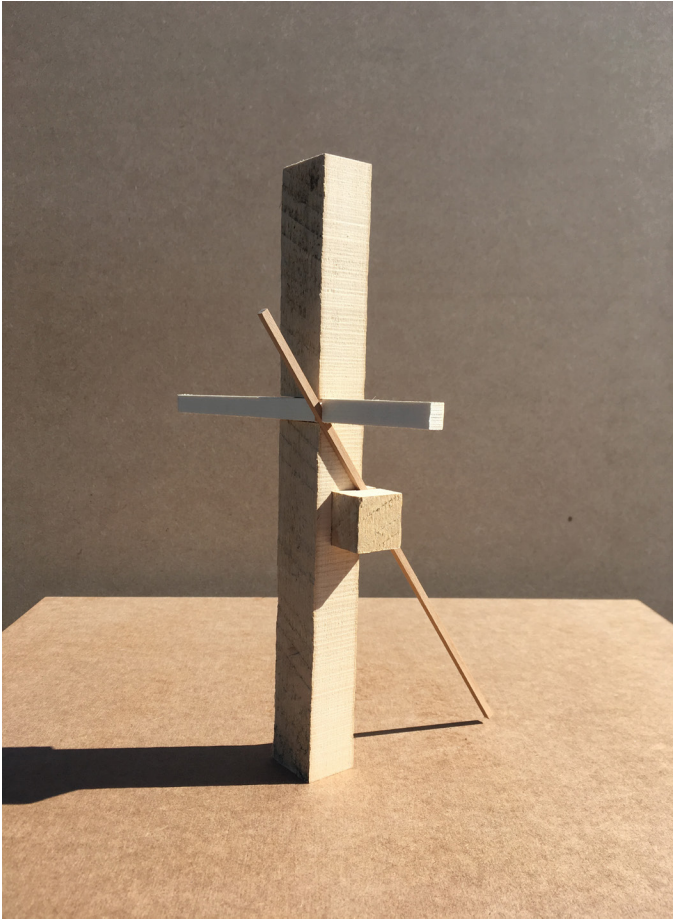

*Soldier*



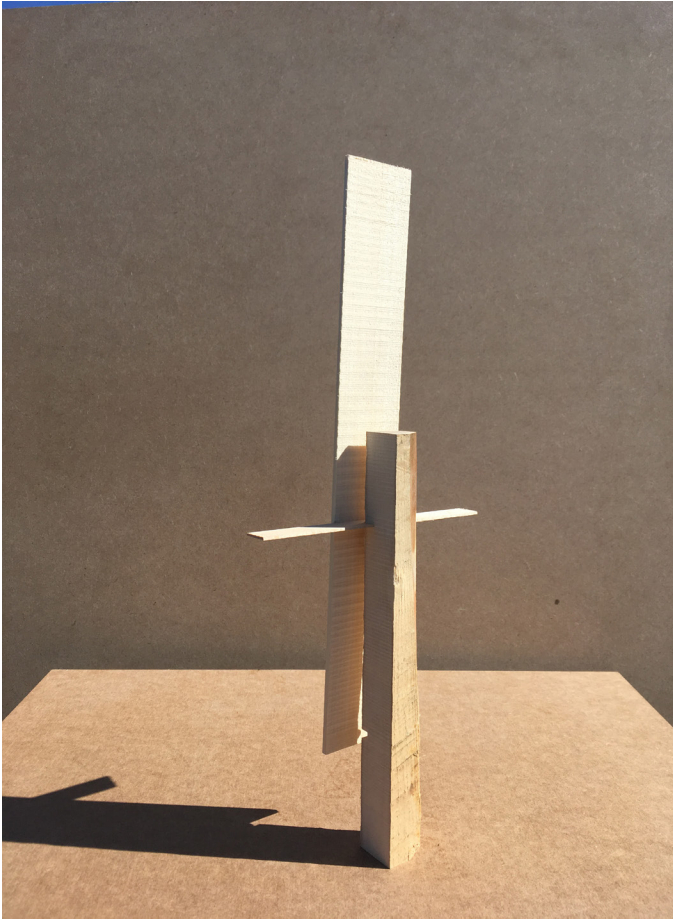

*Wind*



*Mother and Child*

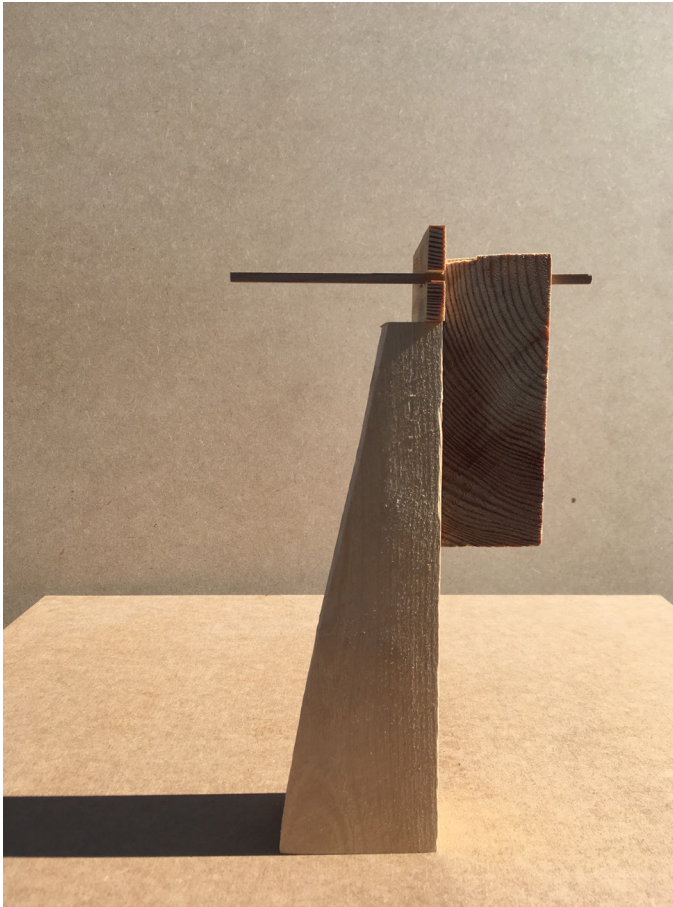

*Knees*



The following series of drawings are sketches of the wooden figures going into the plans of the spatial structures.

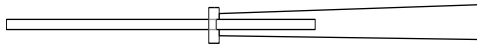

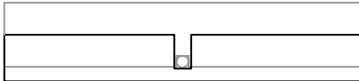

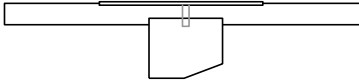

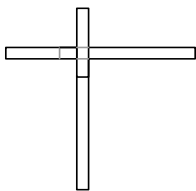

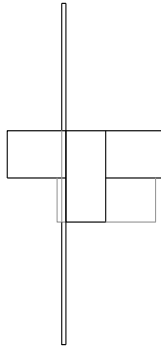

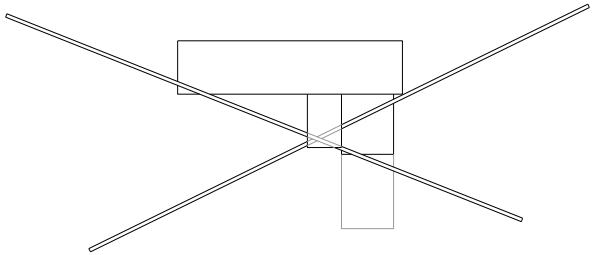



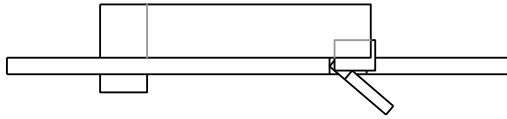

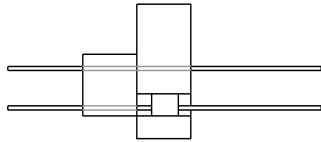

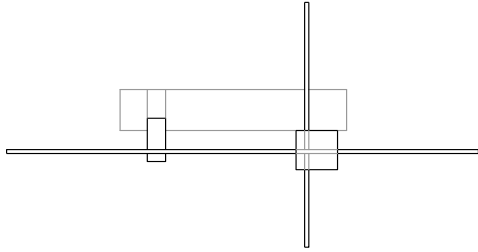

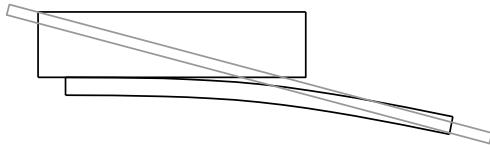

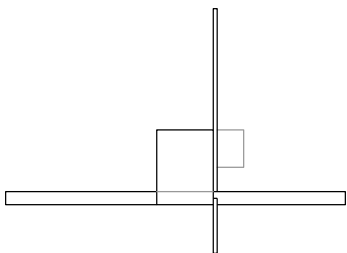

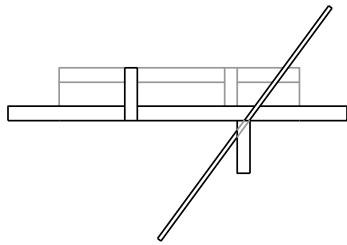

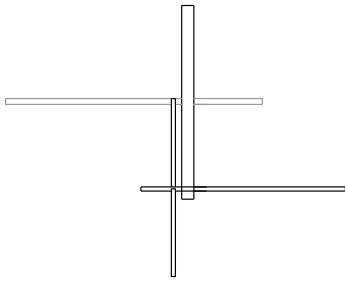



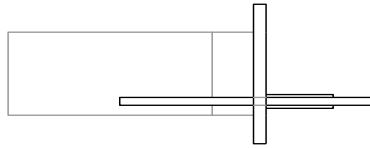

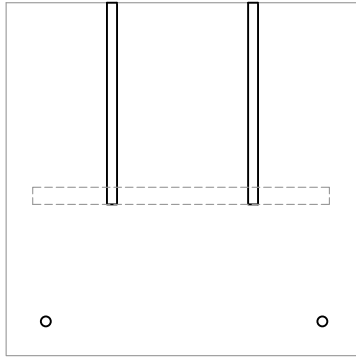

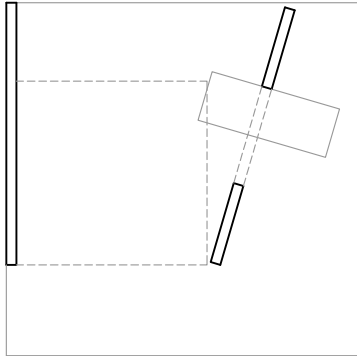

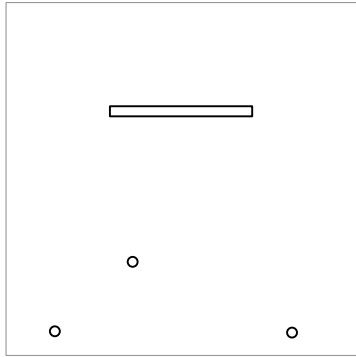

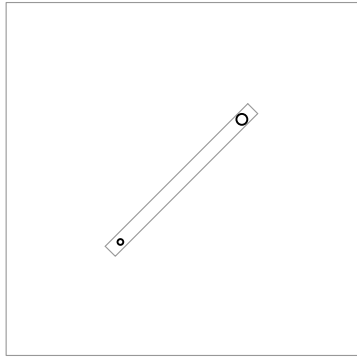

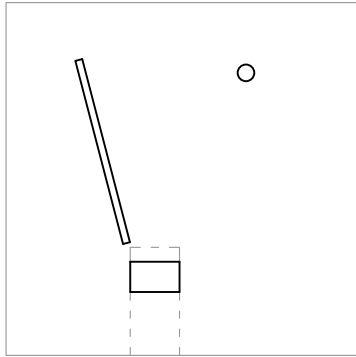

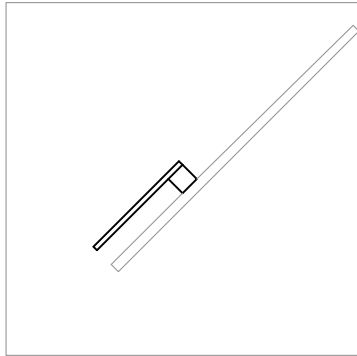

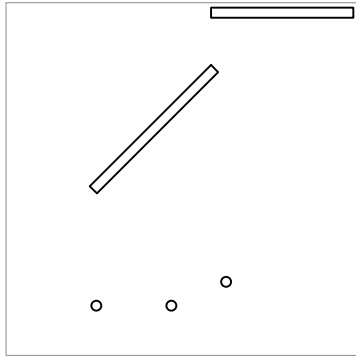



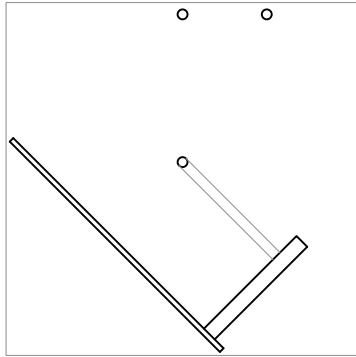

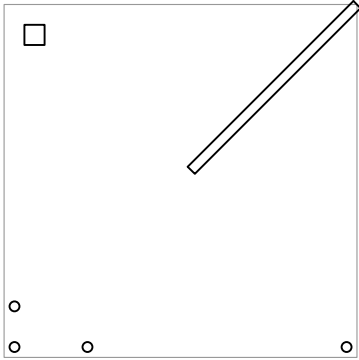

A room for two beds on each side of the diagonal wall.



A living room with a beam and a small wall. Creating a division of the space, in the same time creating several places.



A kitchen with a big window in the  
roof over the kitchencounter.





A livingroom with a chimney, a wall  
and a big collumn.



An entrance with a visual connection  
to the livingroom.



A eating nook with a big beam and a small one. One loadbearing, and one probably a shelf.



A kitchen with two walls almost intersecting, creating an indoor window to the next room.

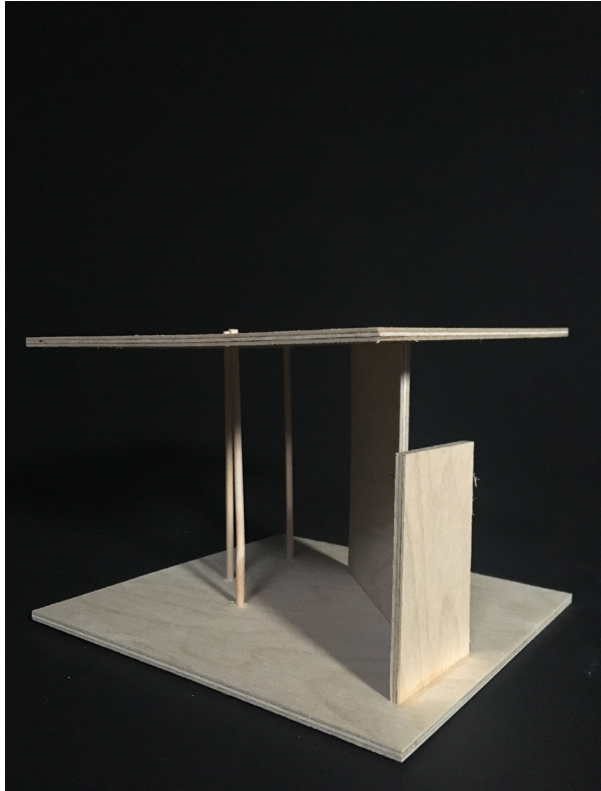



A living room with a bench  
underneath the window.



A bathroom and wc with two overlapping, but not touching, walls.



### 3. The Ritual





I went to Italy in September. I found black stones in the sand and carried them with me to the sun bed. Then I placed them together in many different couples and took pictures of them. Some of the couples seemed to belong together. And I felt that the stones, because of their smooth surface and black color and welcoming shapes, always wanted to be with each other, wanted to meet the other stones with their concave into the other stones convex. Or the pointed sides against each other.

This continued when I came back. I started a ritual every Monday, I made one or two houses in gypsum in 1:100. Searching for the couple, the tension, searching for the facades, forms and objects in the landscape.







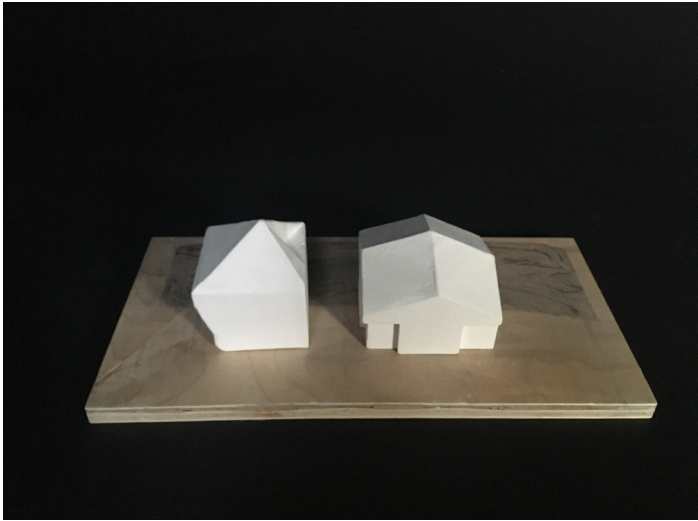

week 38

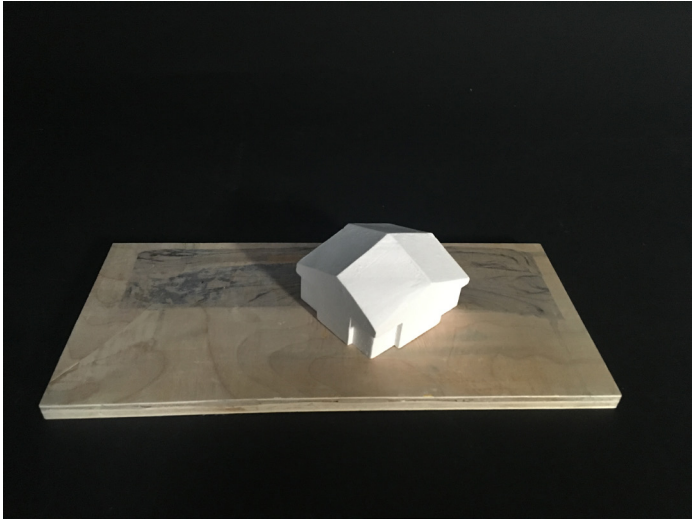

week 38

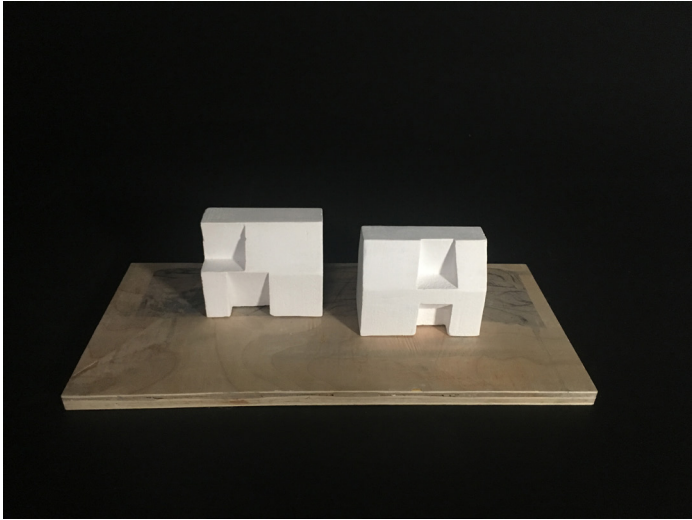

week 40

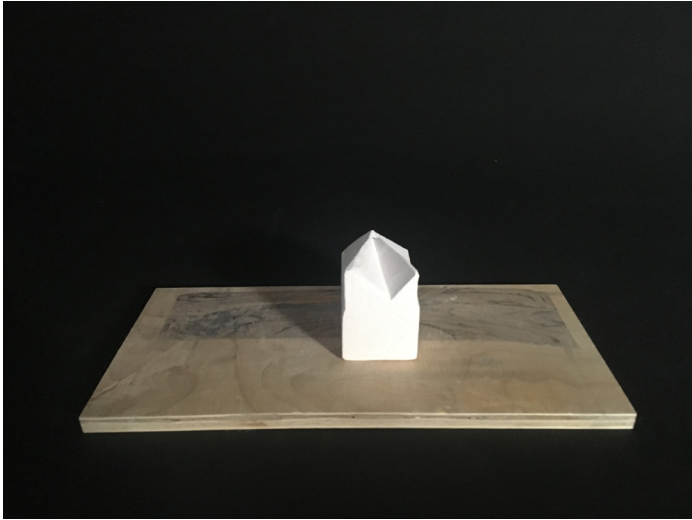

week 39







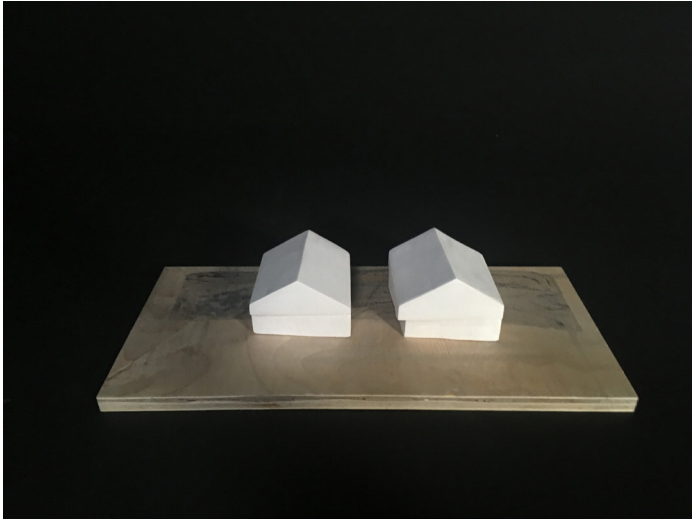

week 41

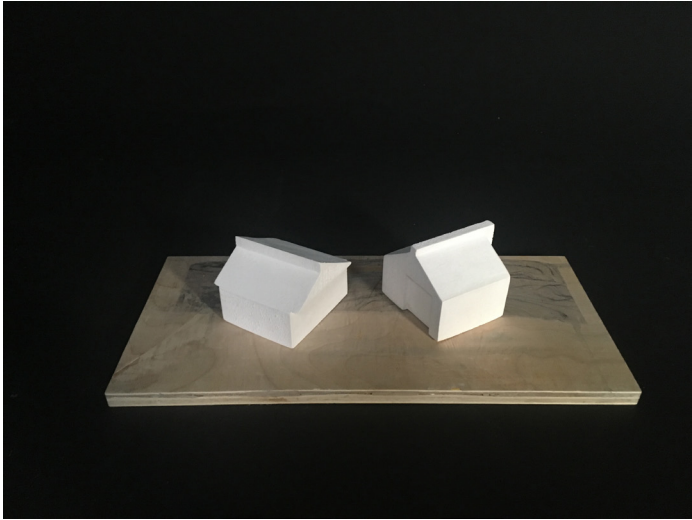

week 40

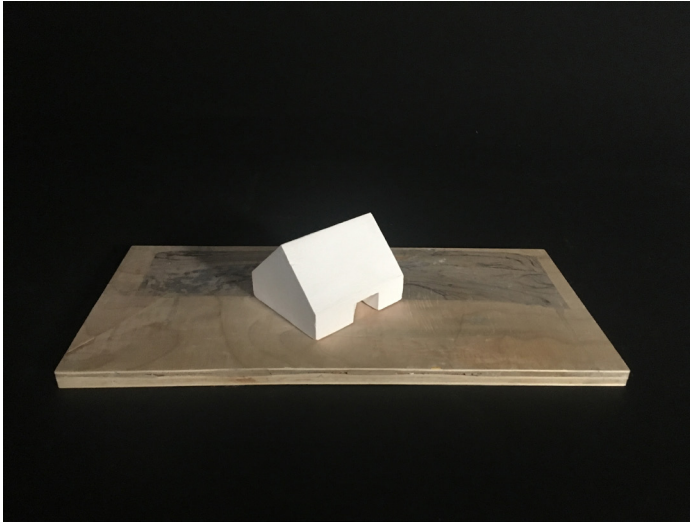

week 43



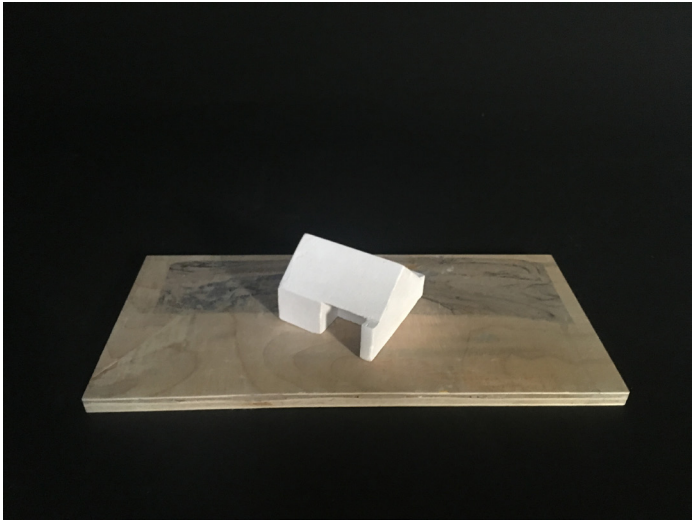

week 44



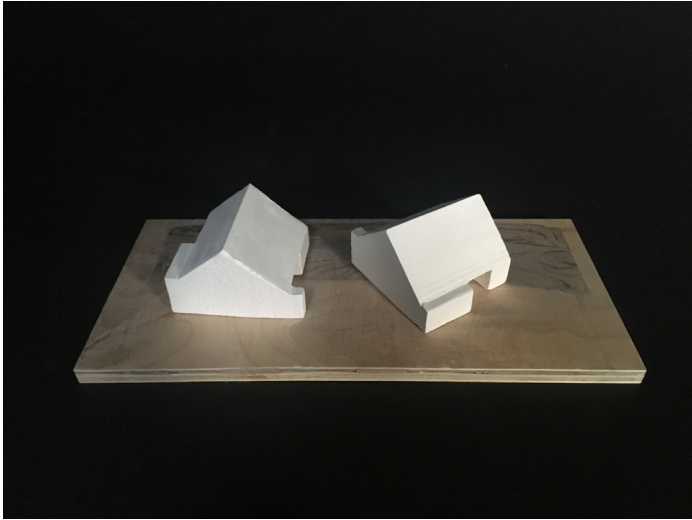

week 44



week 45







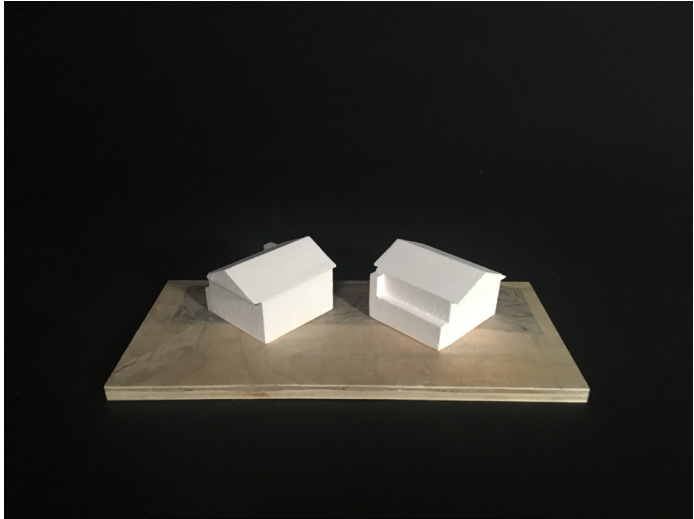

week 45



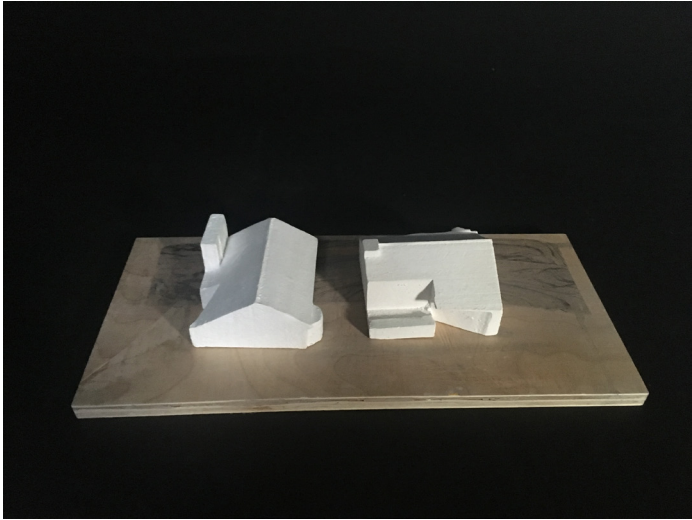

week 46

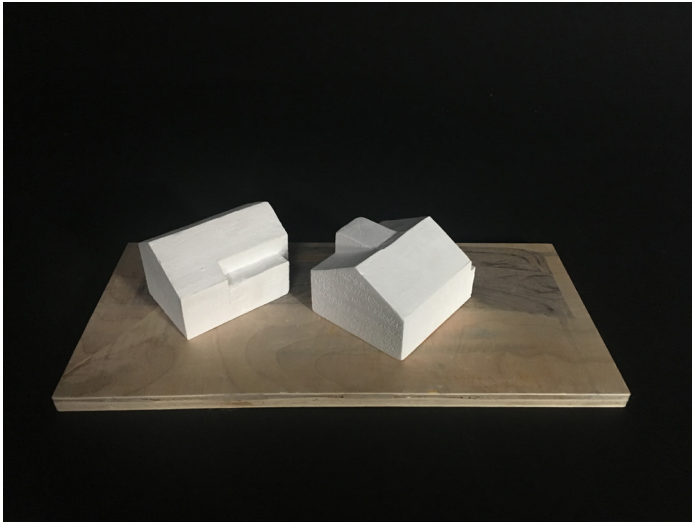

week 47









## 4. Searching and drawing

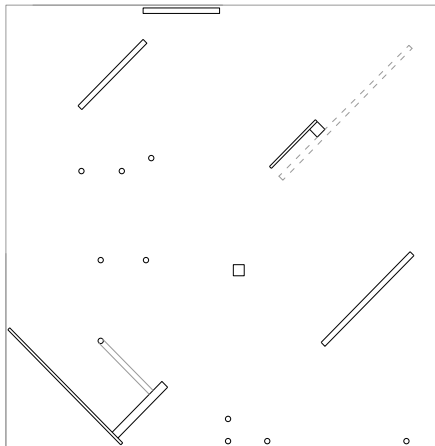

I drew the spatial structures in plan and then I put them together in different constellations, that I further worked while putting different functions inside, a second floor and a roof. And this act of drawing the plan of one of the spatial structures as one particular part of the house, then letting the walls grow out and become something else continued. Trying to make not only one drawing of a house, but two. Wanting to make two different interiors that worked the same program. Kitchen, dining area, bath room, toilet and living room in the first floor and a second floor or loft where you can dwell or sleep.

The program of the house, the sizes of the rooms and the use is always changing. For me, there are a few things in a house when it comes to function and program that I really have an affinity for, and that is:

- To use the loft as a room to inhabit, not to only stack old things and family photo albums. The feeling of dwelling and sleeping under the hard shell of the roof above ground is for me like a safe place.

- To separate the toilet and bathroom.
- I have always liked to sleep in the corner of a big room. When I was a child, I hated to sleep alone in my room. I don't like to fall asleep feeling like I am all alone or in a small room. For 100 and more years ago it was normal to sleep in a bed that was placed in the corner of the living room or if you had a kitchen help, she would sleep in the kitchen or in a little alcove next to the kitchen. This I find beautiful. To sleep in the rooms you live, not like on the couch, but in a nook on a bed that is linked to a bigger room without the door being in between. To sleep in a nook is to neighbor the rooms and people inside the house.

I implemented each of these personal thoughts of dwelling in the plans. And saw that it became a very direct force on the creating of the houses.





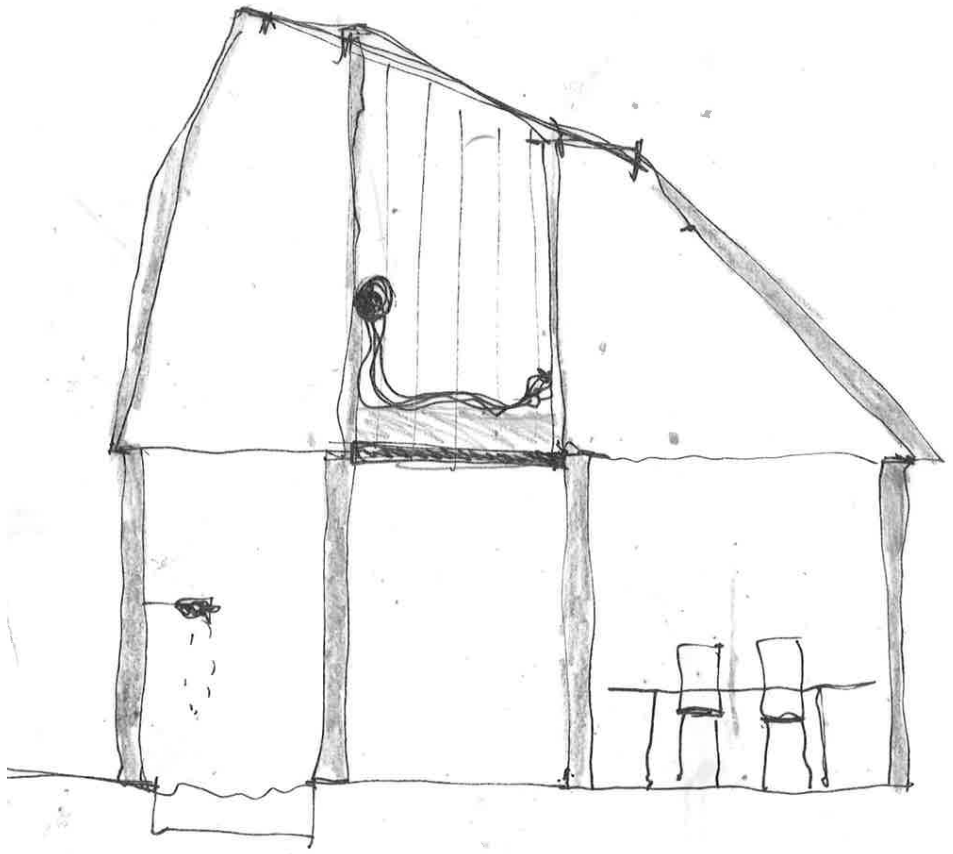







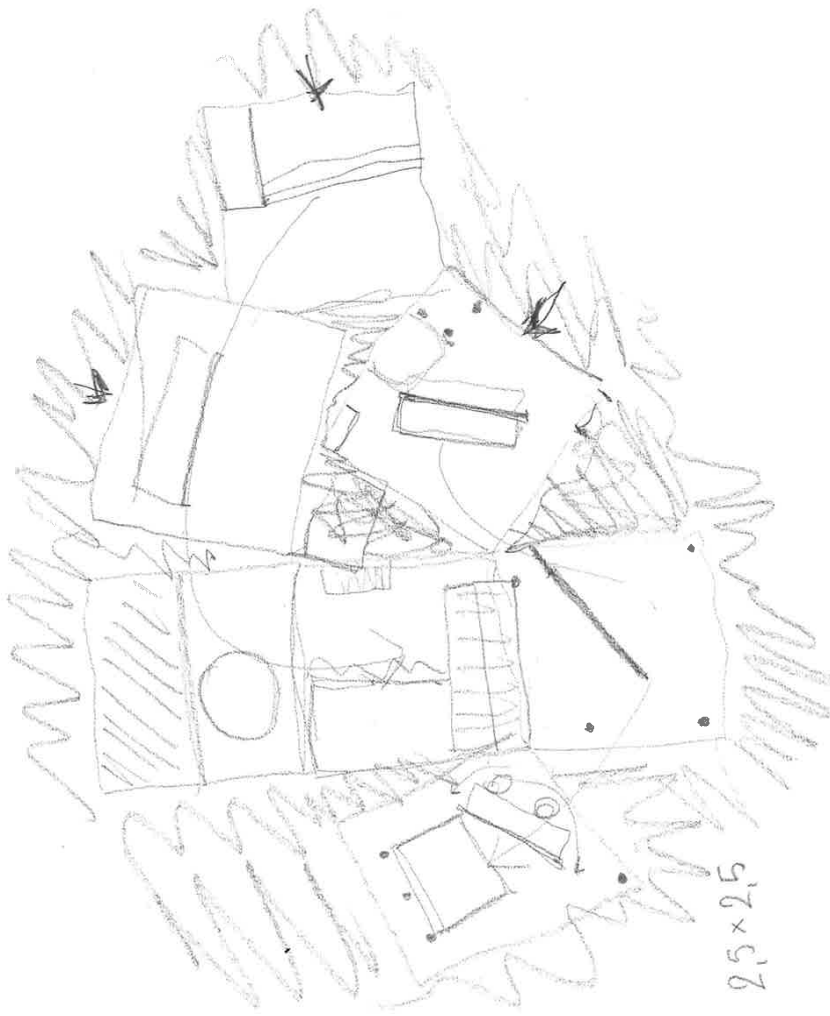

2,5 x 2,5

Klok vendor  
sem, bar, fa  
Spice 1-85

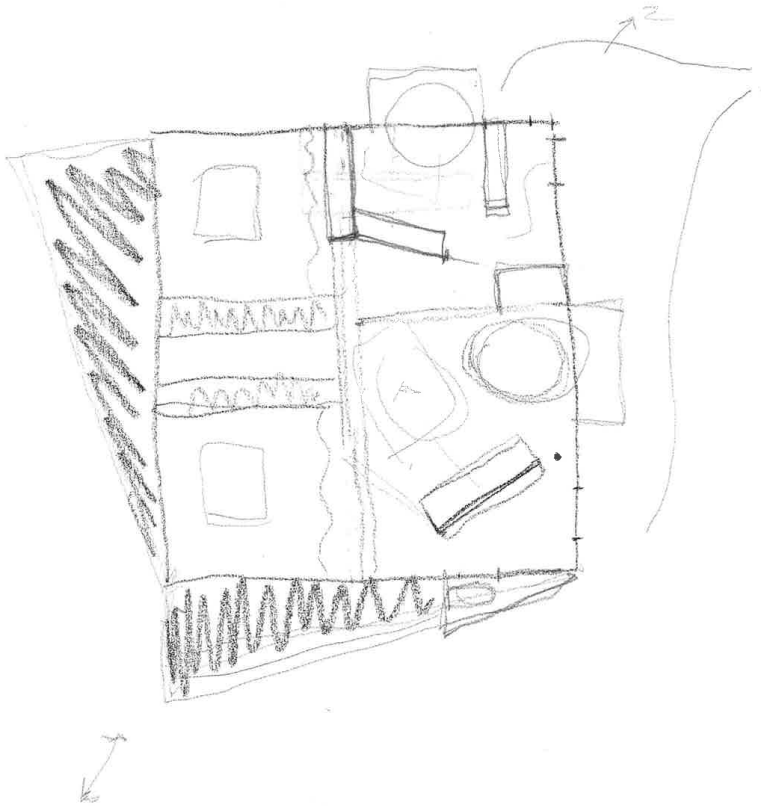





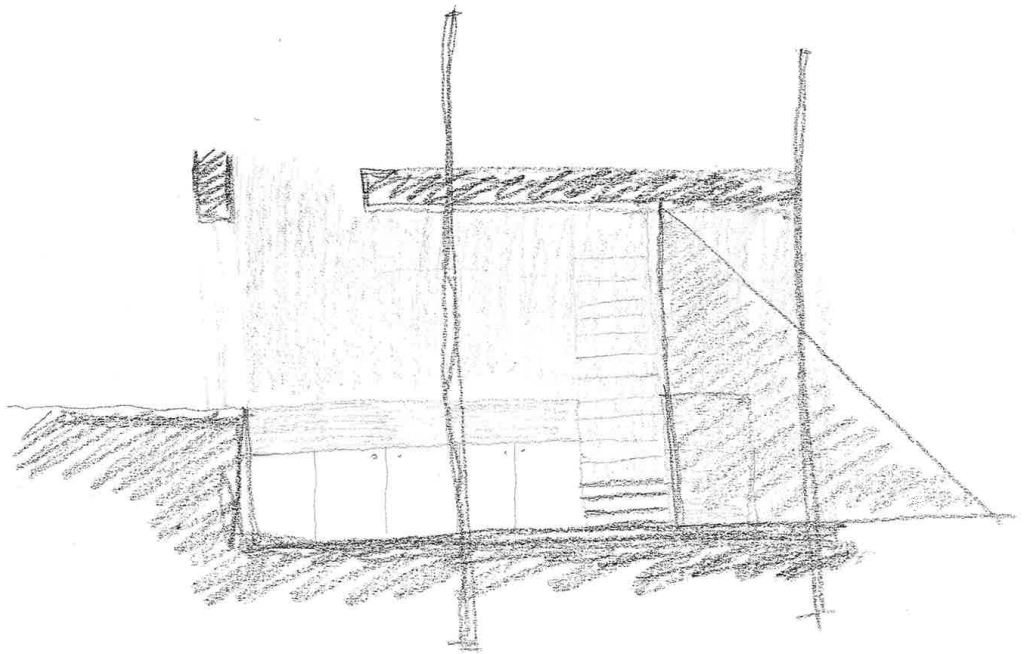

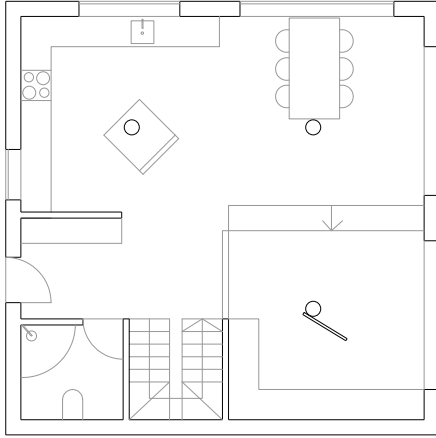

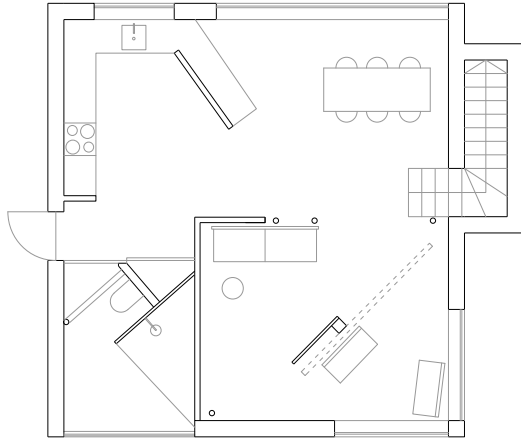



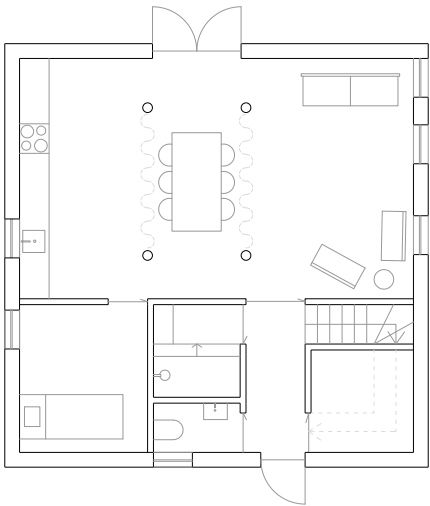

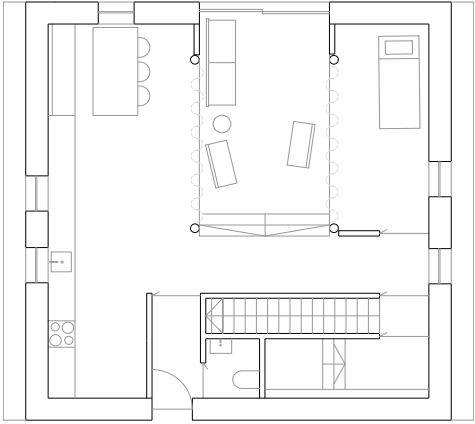

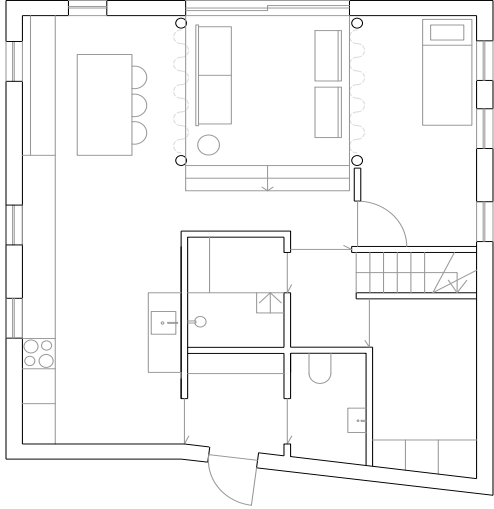

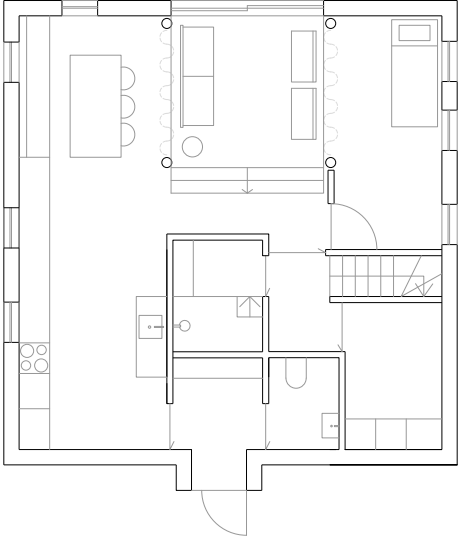

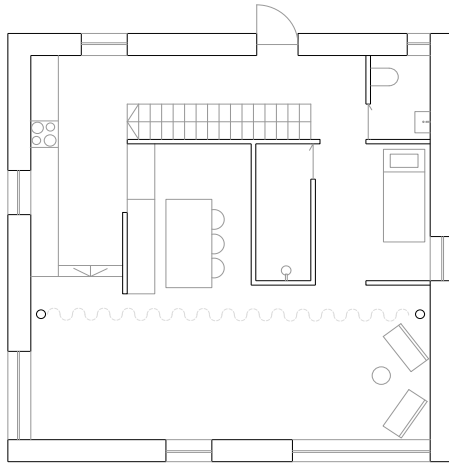

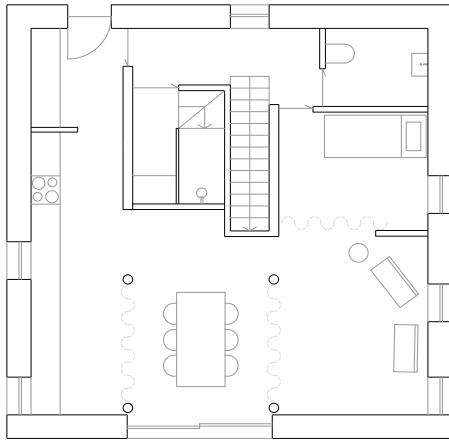

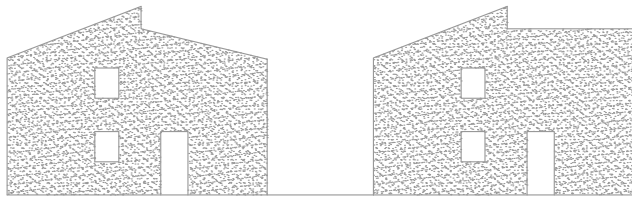

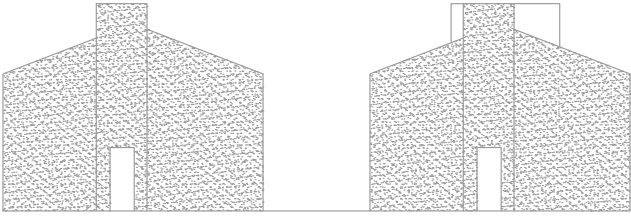



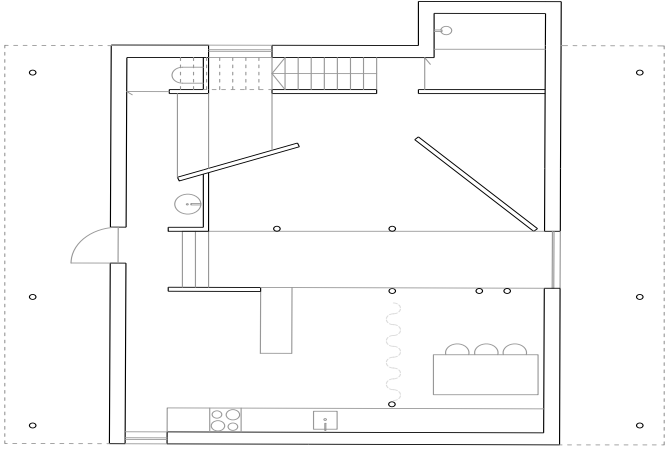

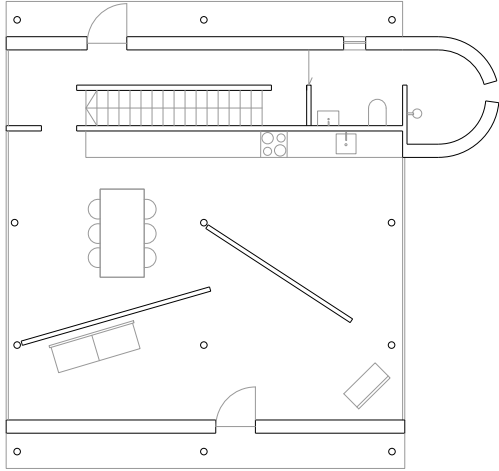

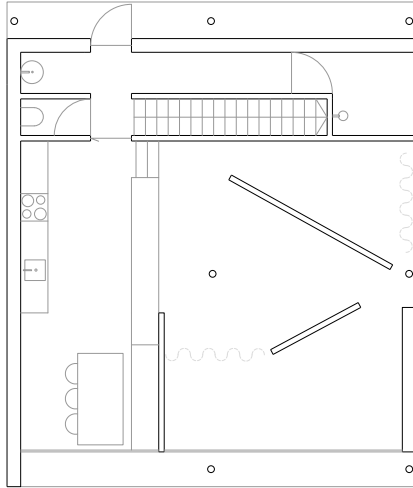

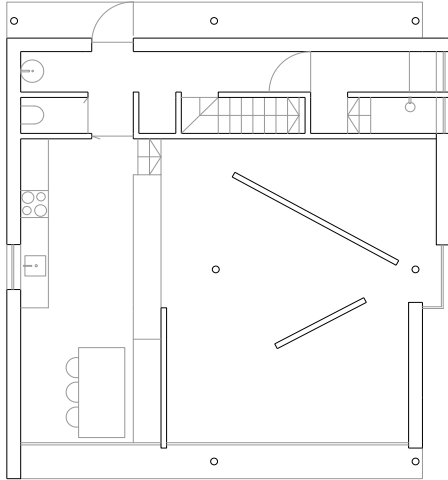

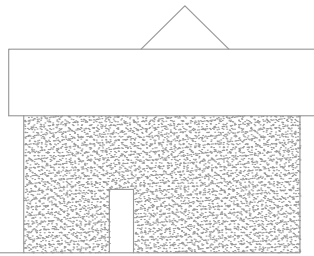
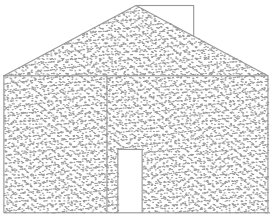

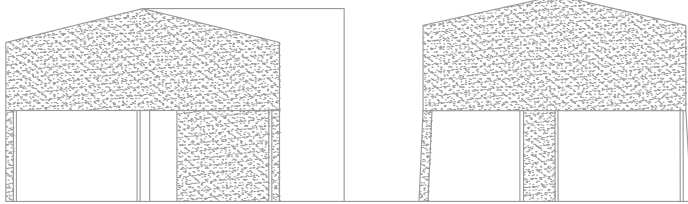

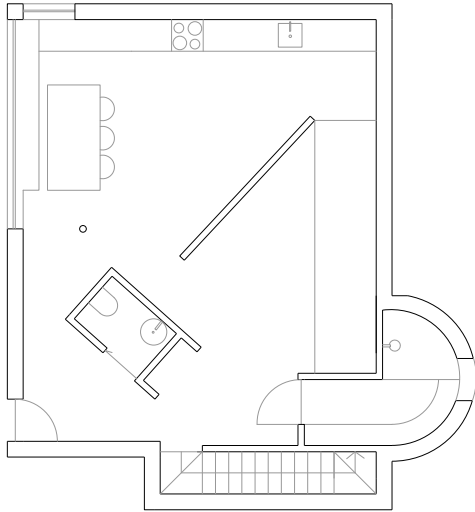

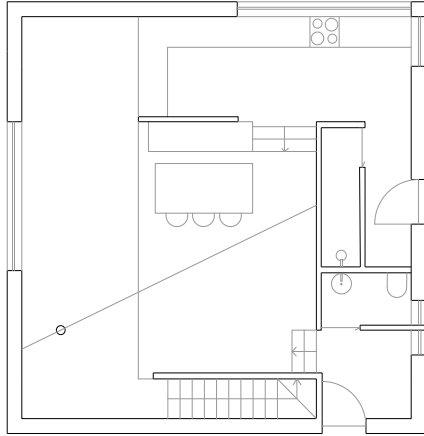



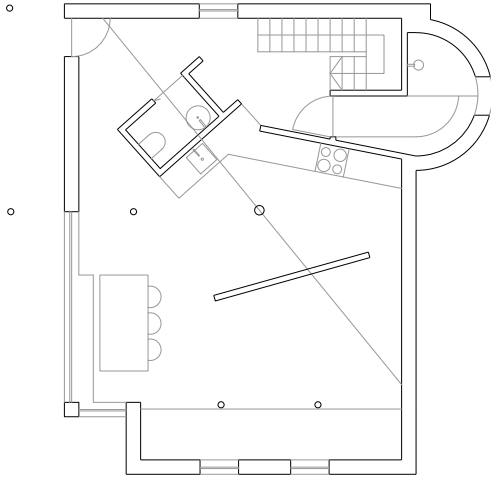

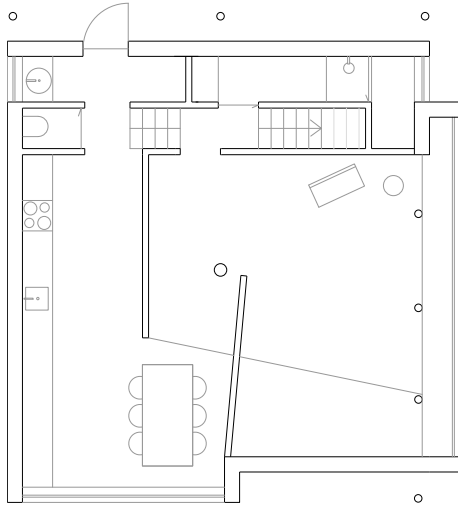



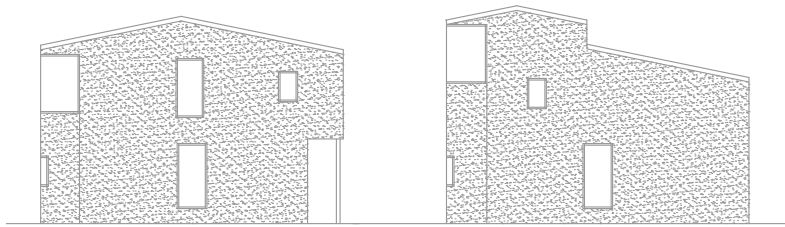

## 5. The placing

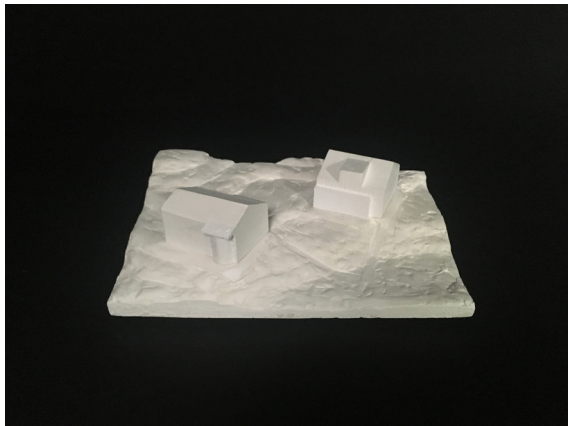

*Landscape  
Model 1:100  
With The Couple  
Gypsum*



The two houses are equal in volume. The facades have clear proportional similarities, a closeness, and also clear individual characters, a distance. They are placed next to each other in the hill facing east and the ocean. One house is placed longer up in the hill, two stairs are placed from the road and up to the houses. The people living there can walk up their stair, looking at their neighbor also going up their stair to their house. A distance and a closeness. The wooden houses are placed on concrete foundations that frames the houses, and makes terraces. The landscape around is not touched. It remains as I remember it.



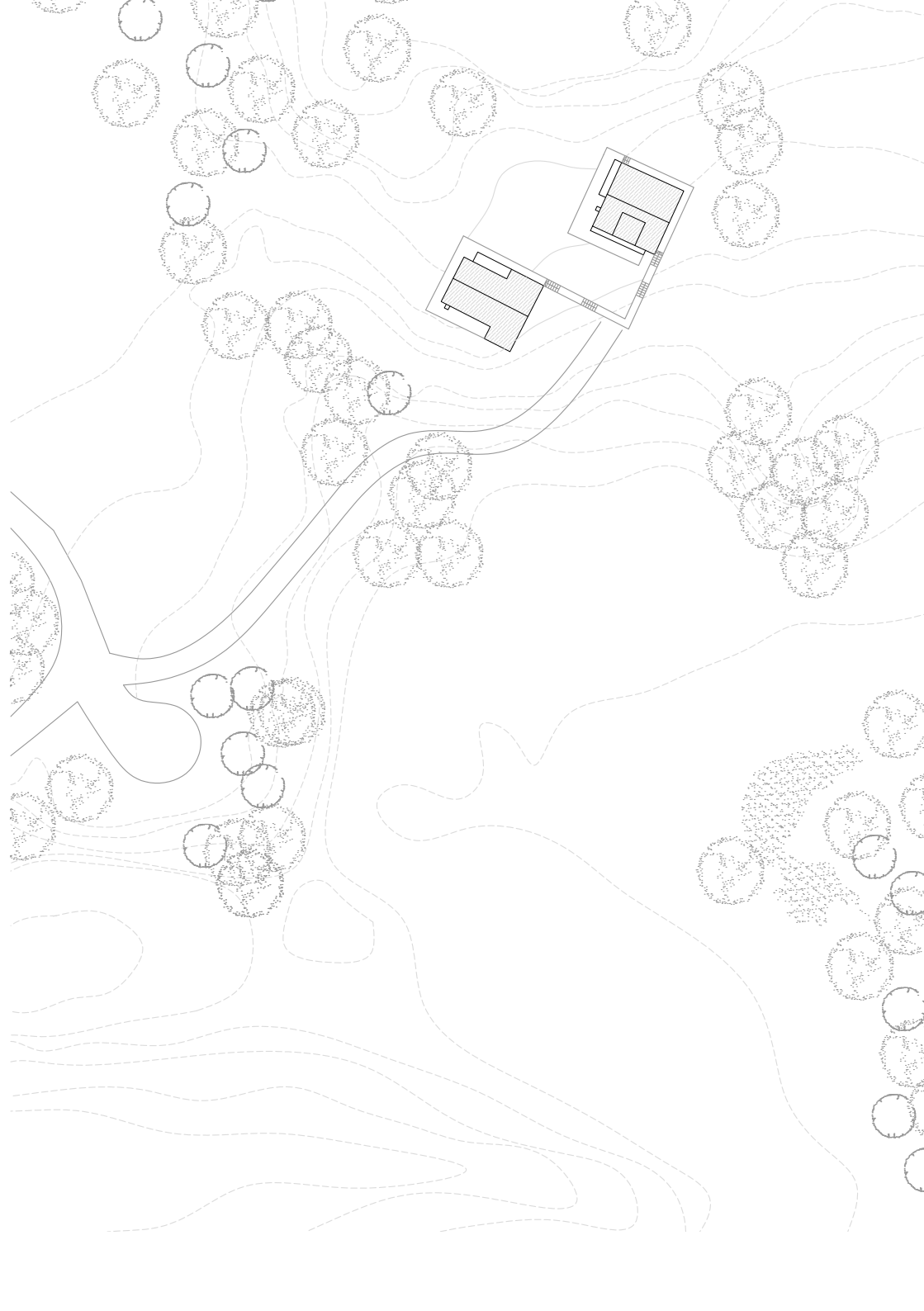



*Drawing of  
The Couple  
placed in the  
landscape  
1:500*



*House 1*  
*Model 1:25*  
*Plywood, birch*





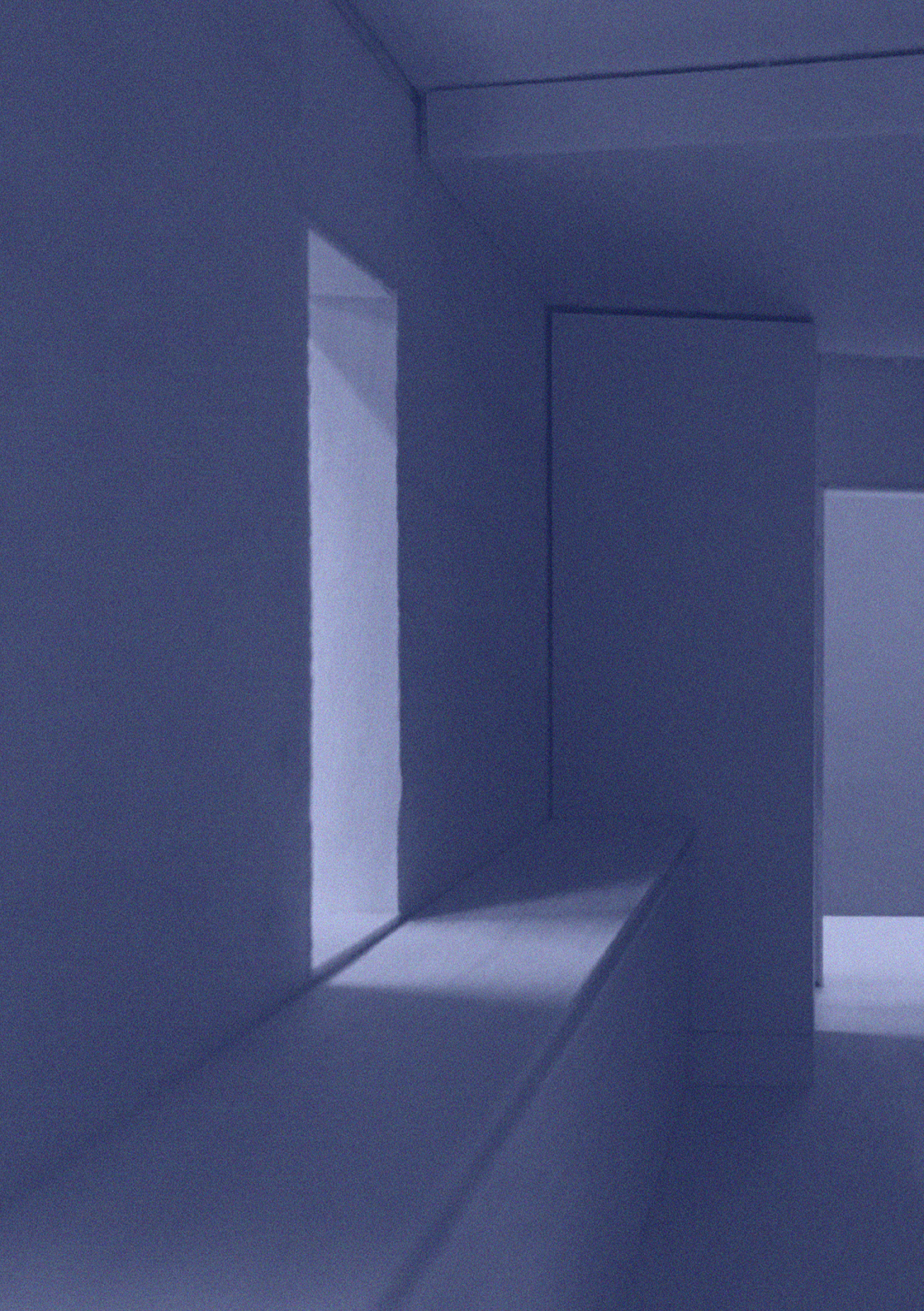







*House 1*  
*Model 1:25*  
*Plywood, birch*





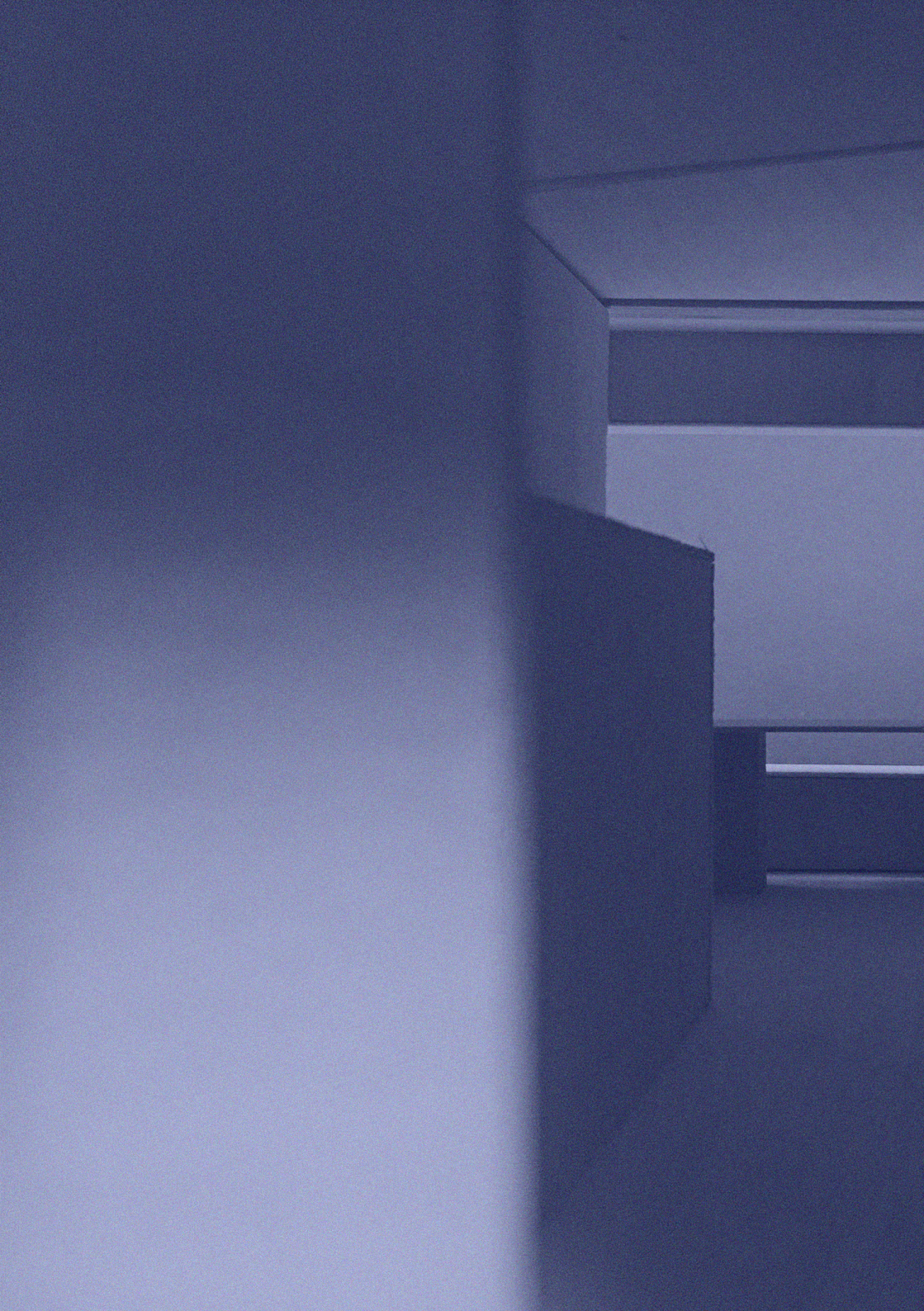



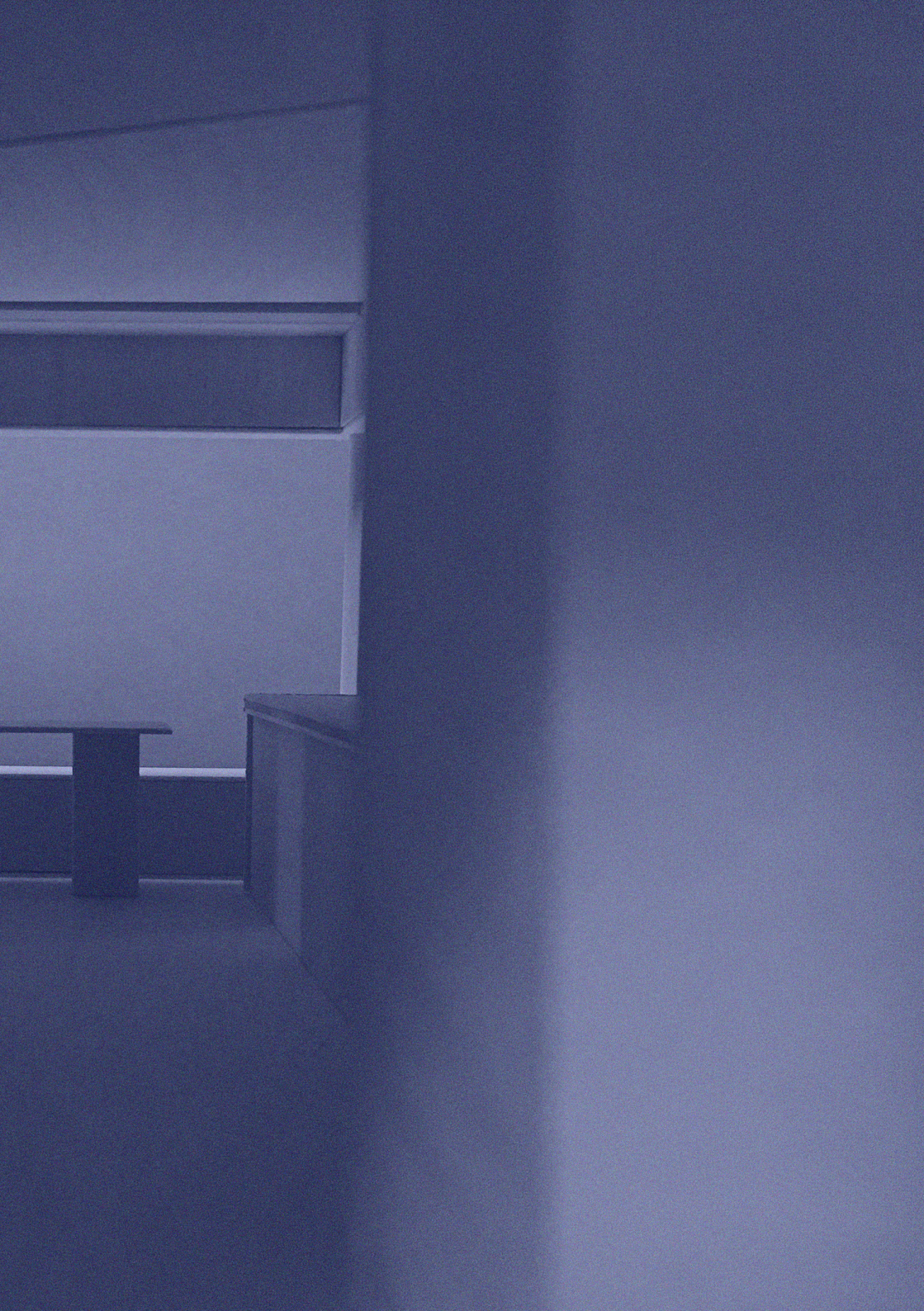



*House 1*  
*Model 1:25*  
*Plywood, birch*





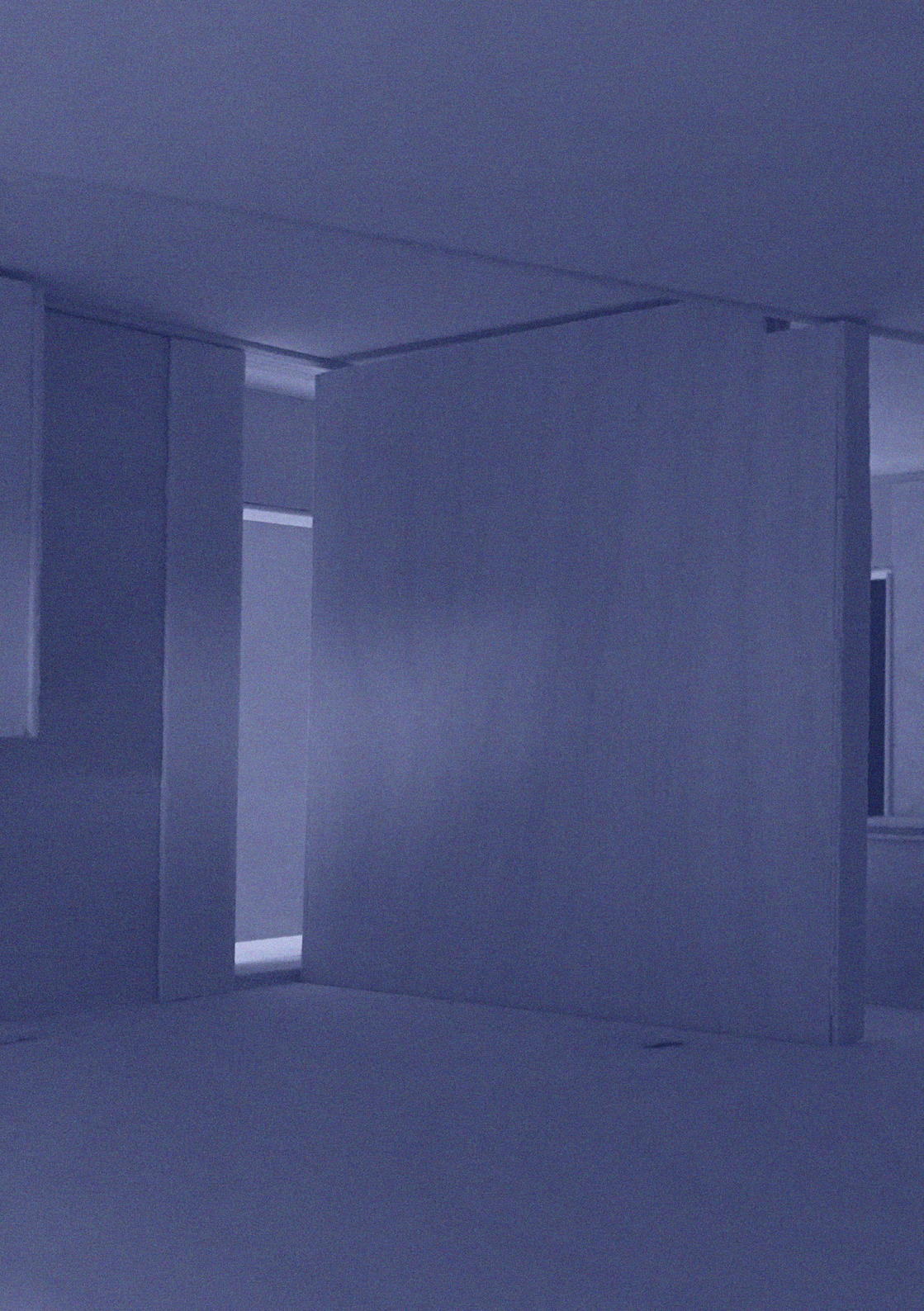



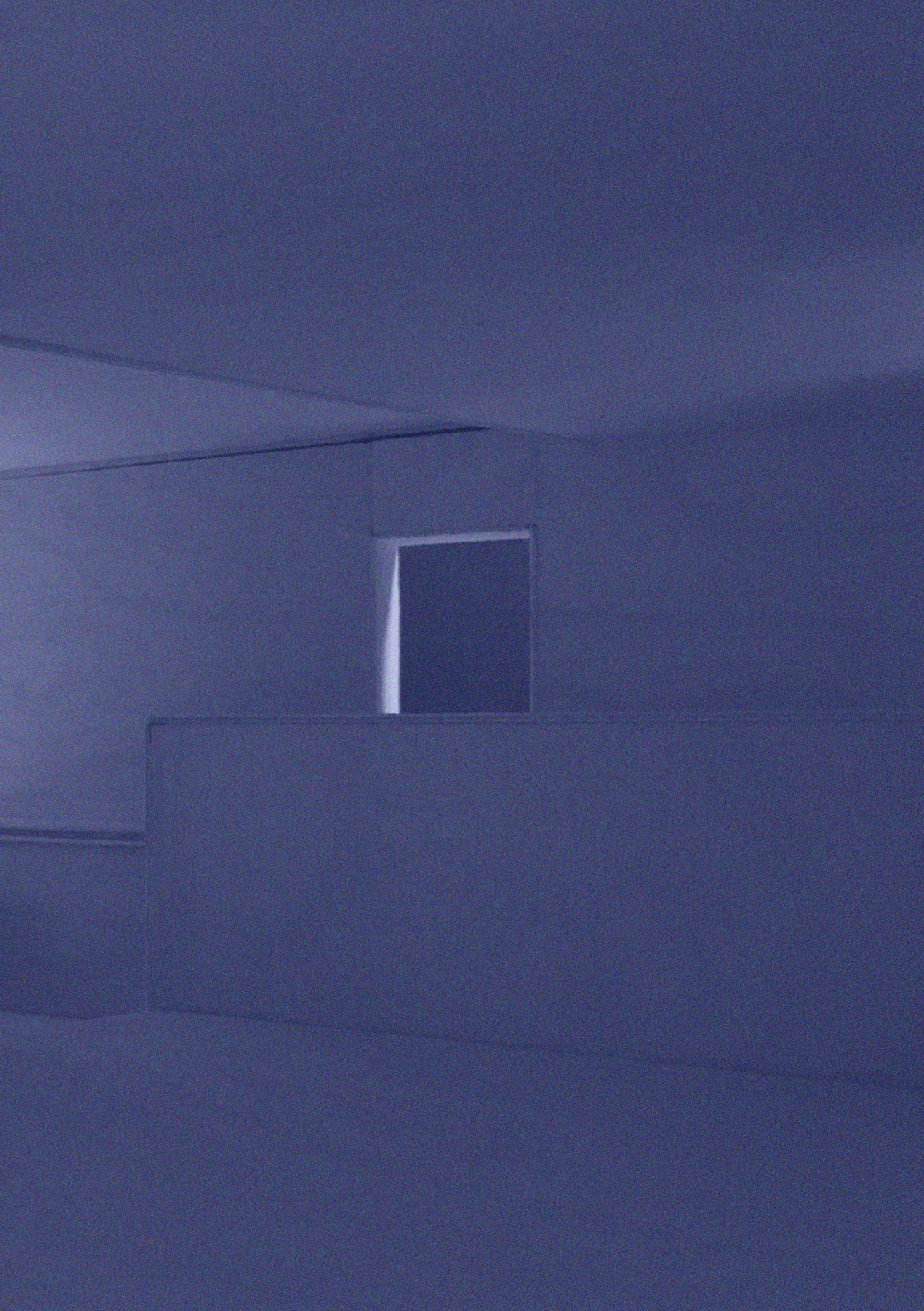





*House 1*  
*Model 1:25*  
*Plywood, birch*









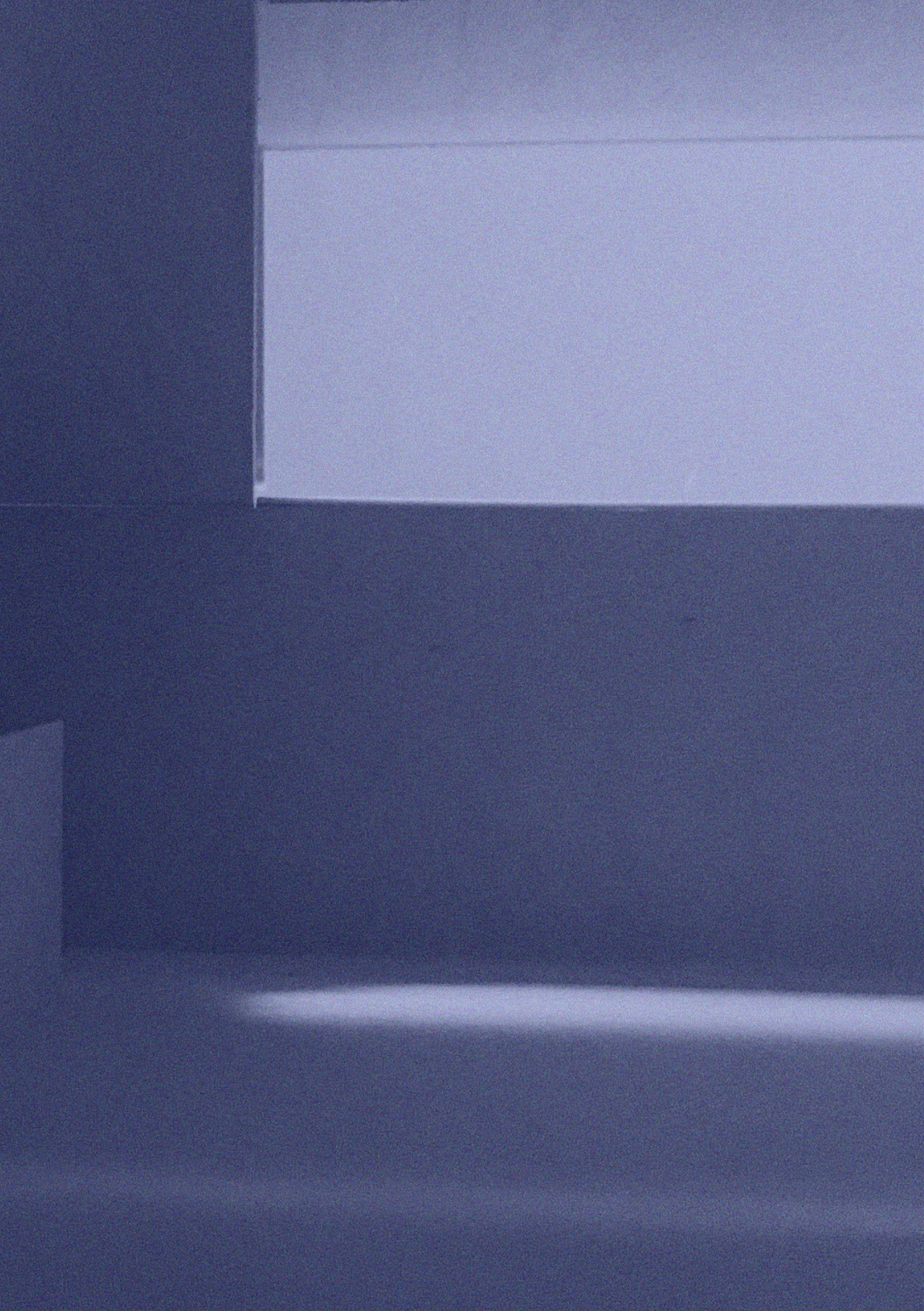





*House 2*  
*Model 1:25*  
*Plywood, birch*





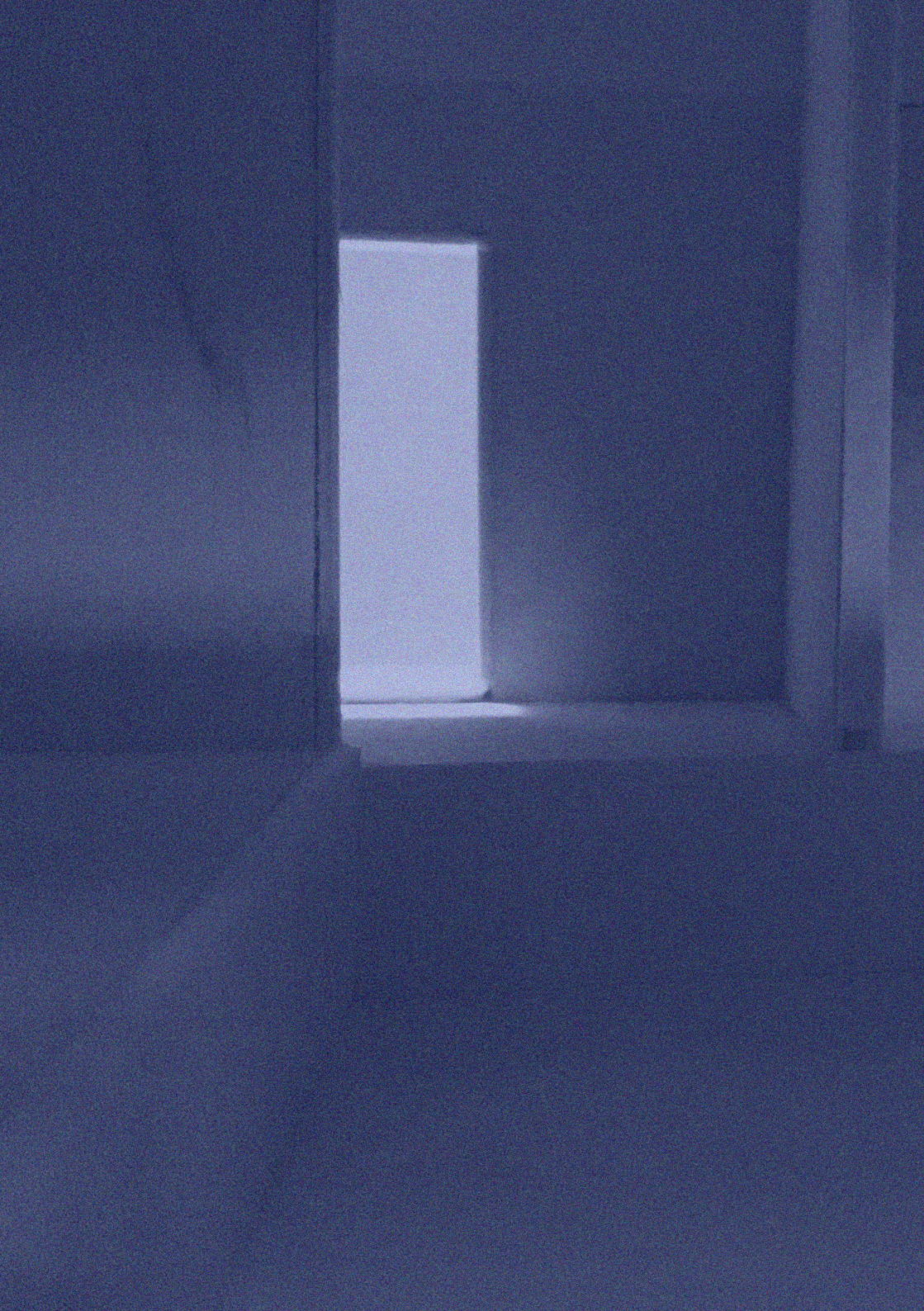



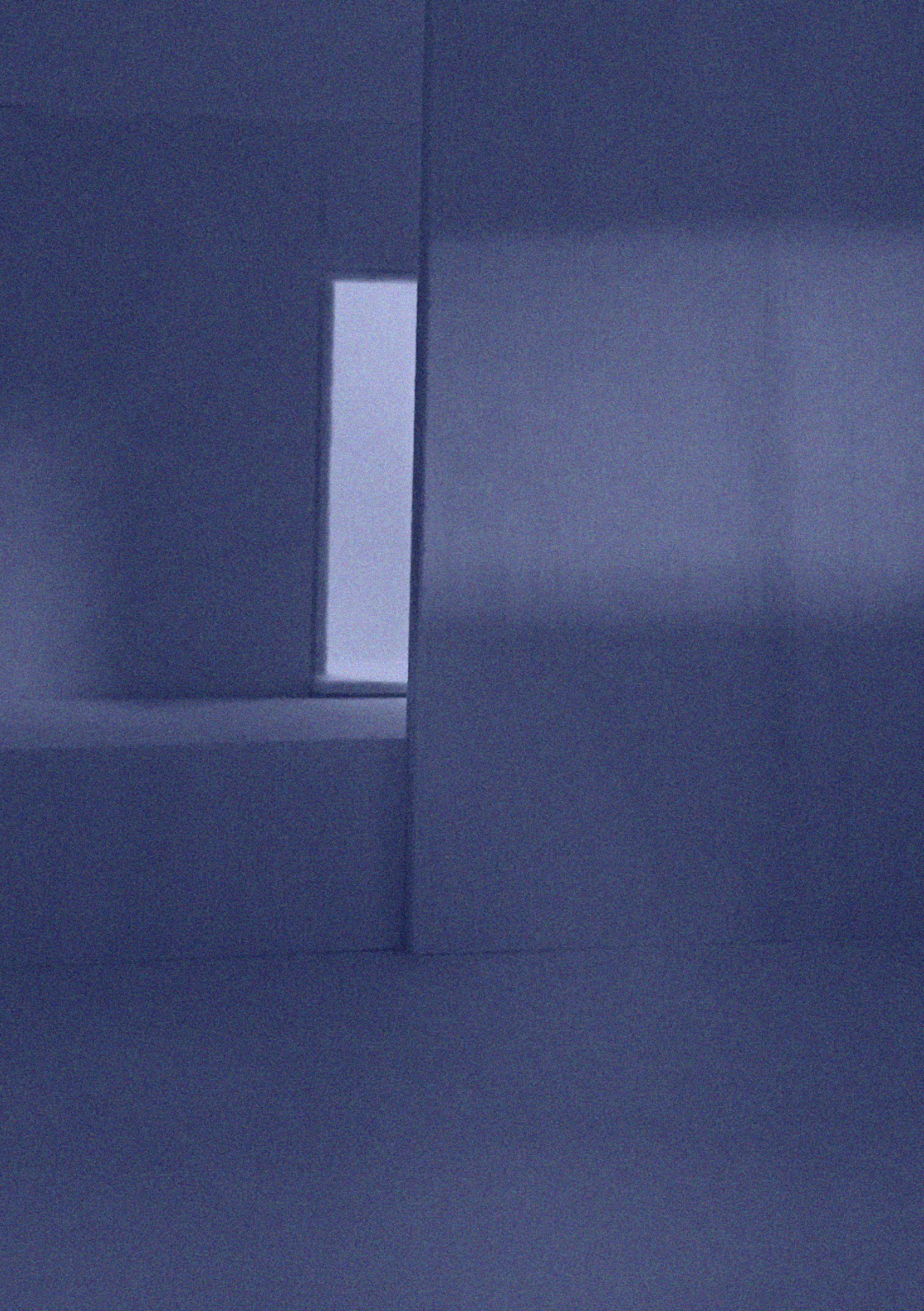





*House 2*  
*Model 1:25*  
*Plywood, birch*





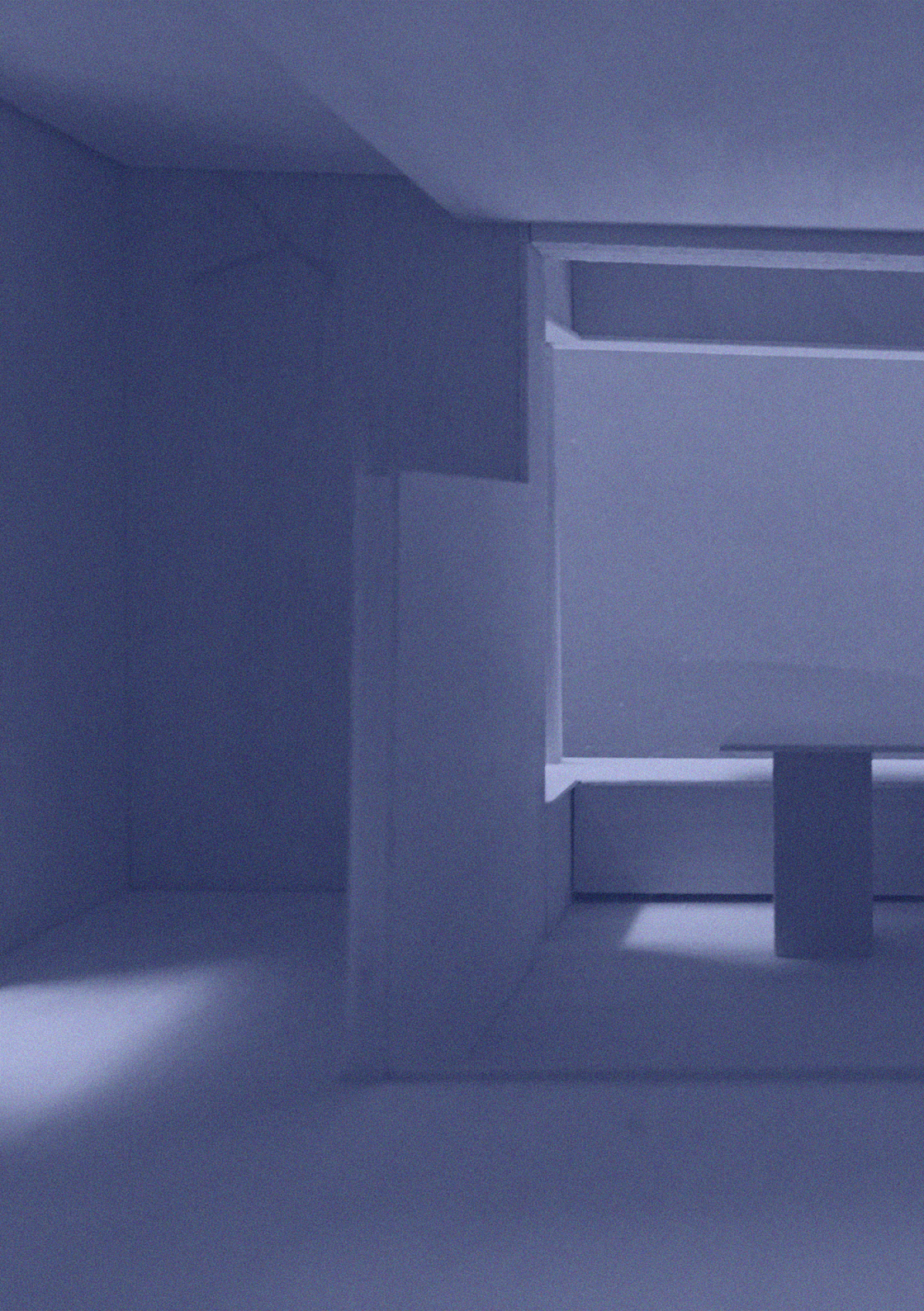



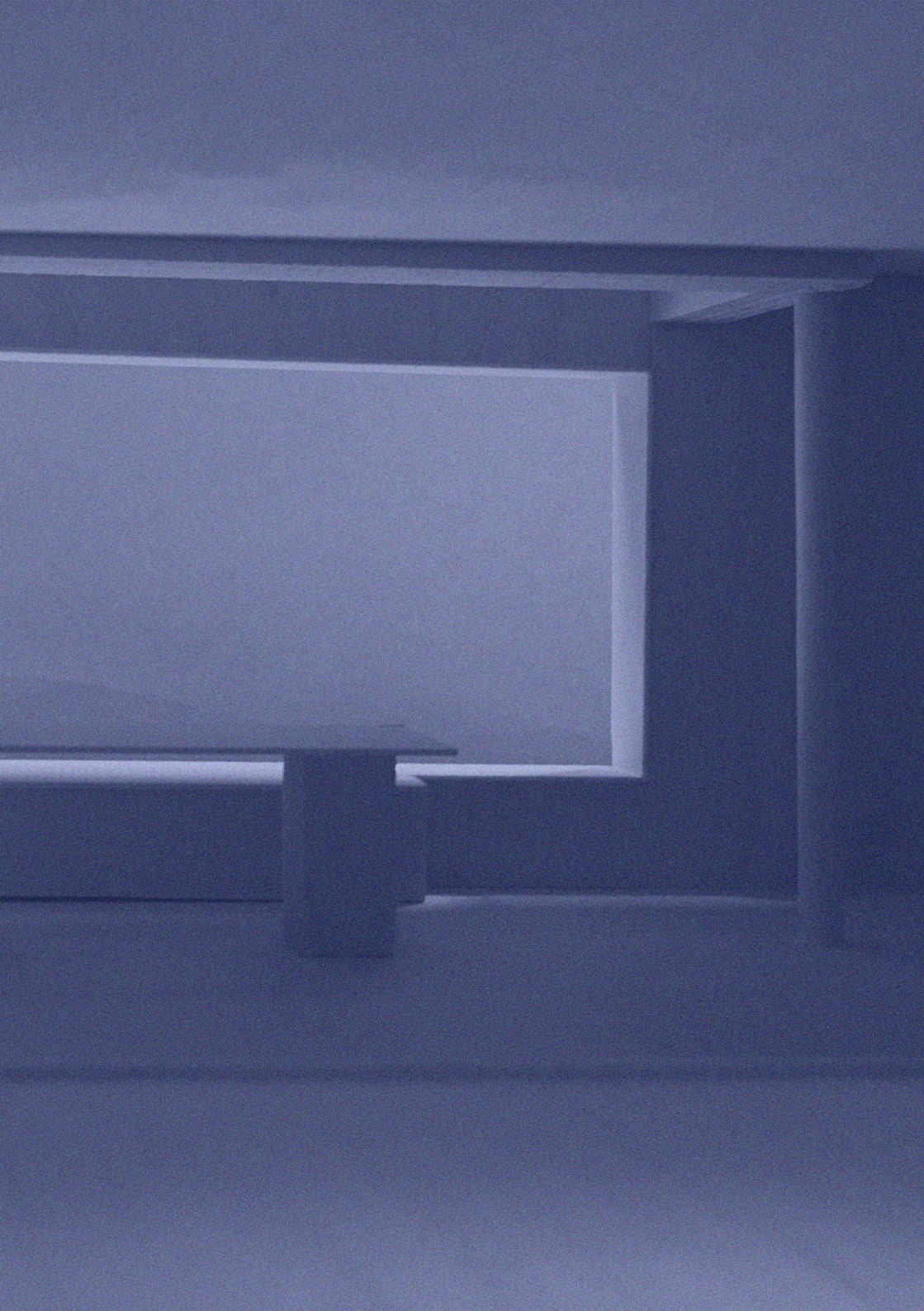



*House 2*  
*Model 1:25*  
*Plywood, birch*













*House 2*  
*Model 1:25*  
*Plywood, birch*









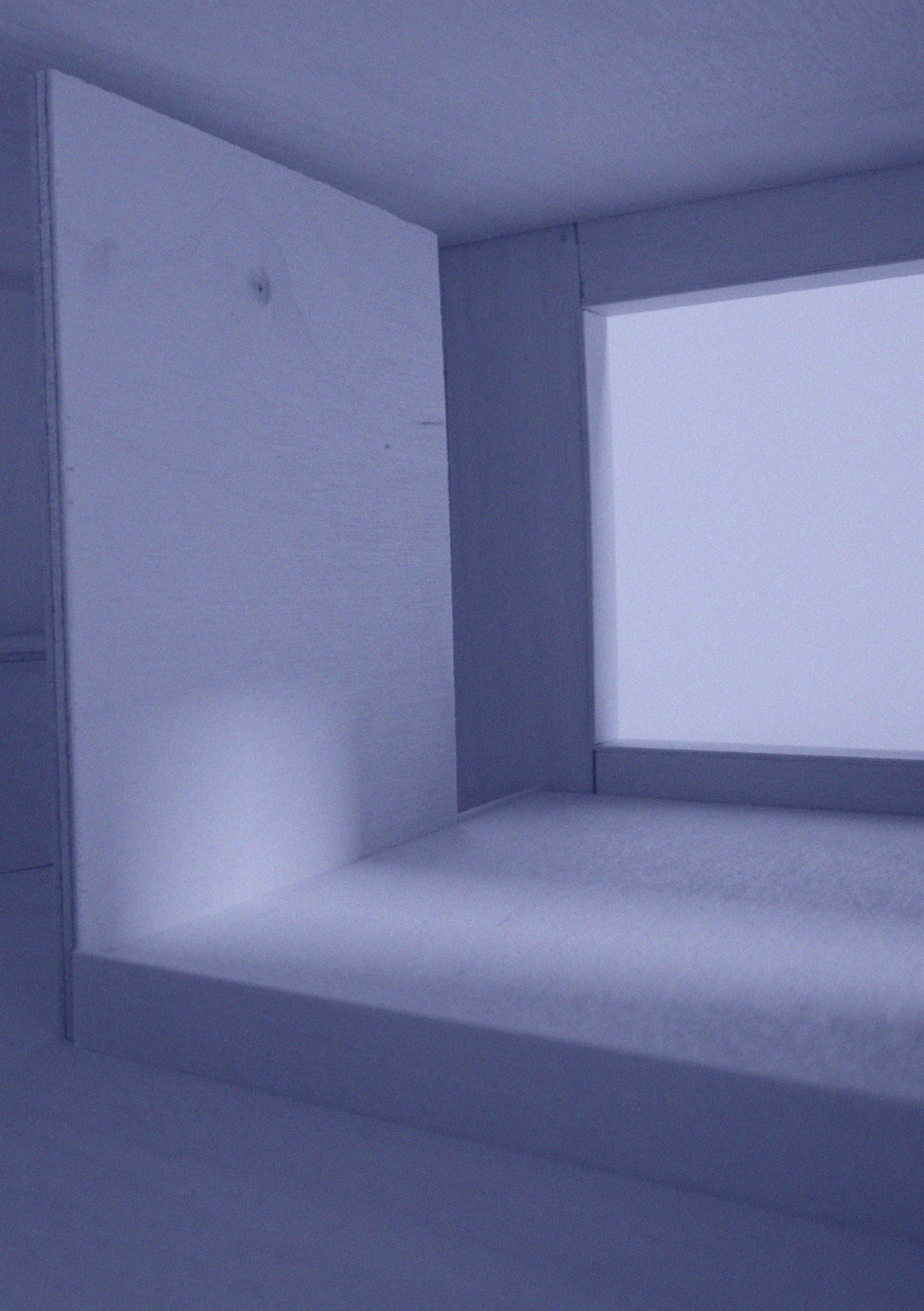

My grandmothers house had a gable roof. I liked to sleep in my mothers old room. The bed was placed against the oblique ceiling. Our house had a Mansard roof. My bed was also placed against the ceiling, but it wasn't as oblique. I't didn't feel as safe.



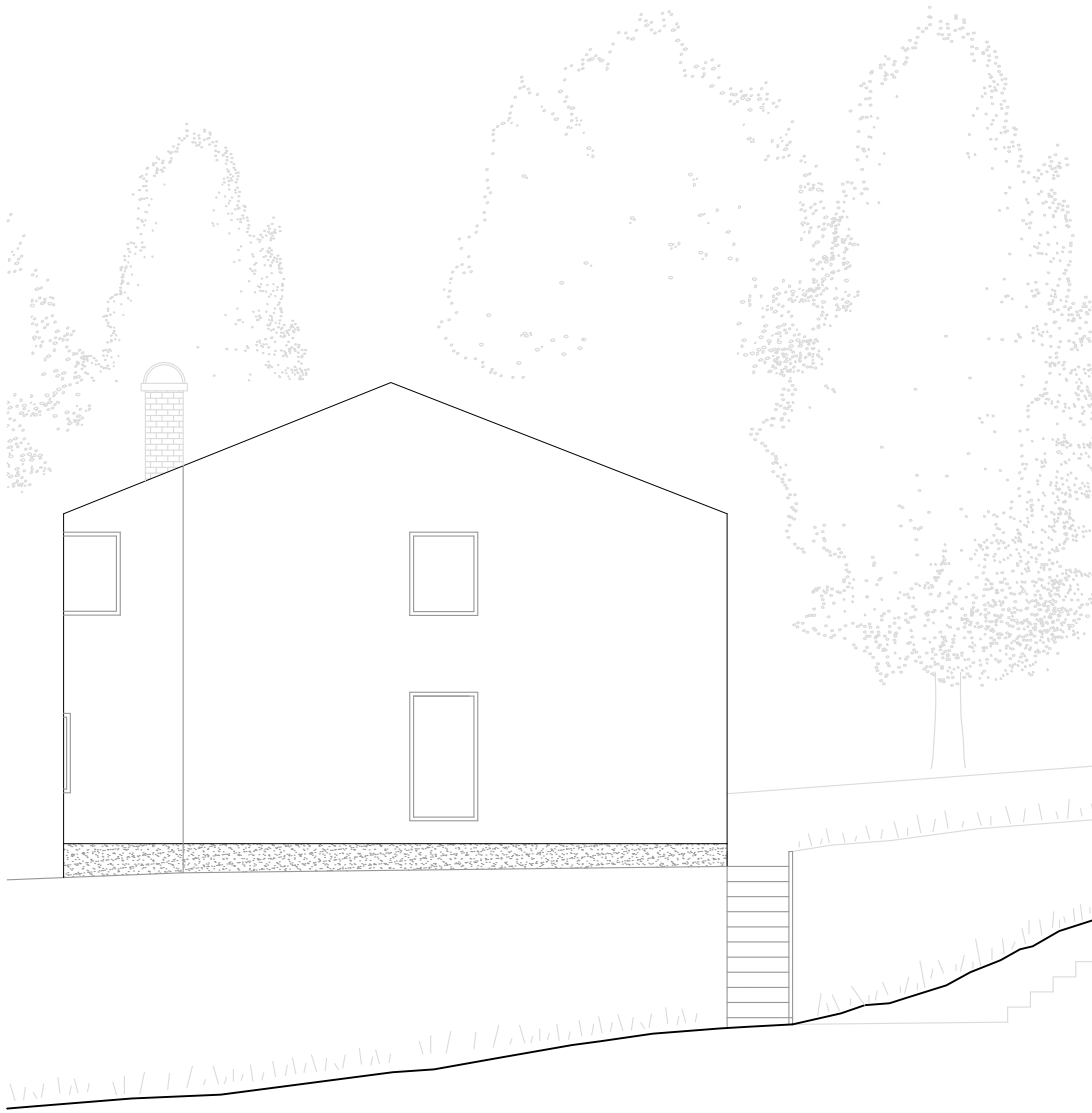

*House 2*  
*Facade North*

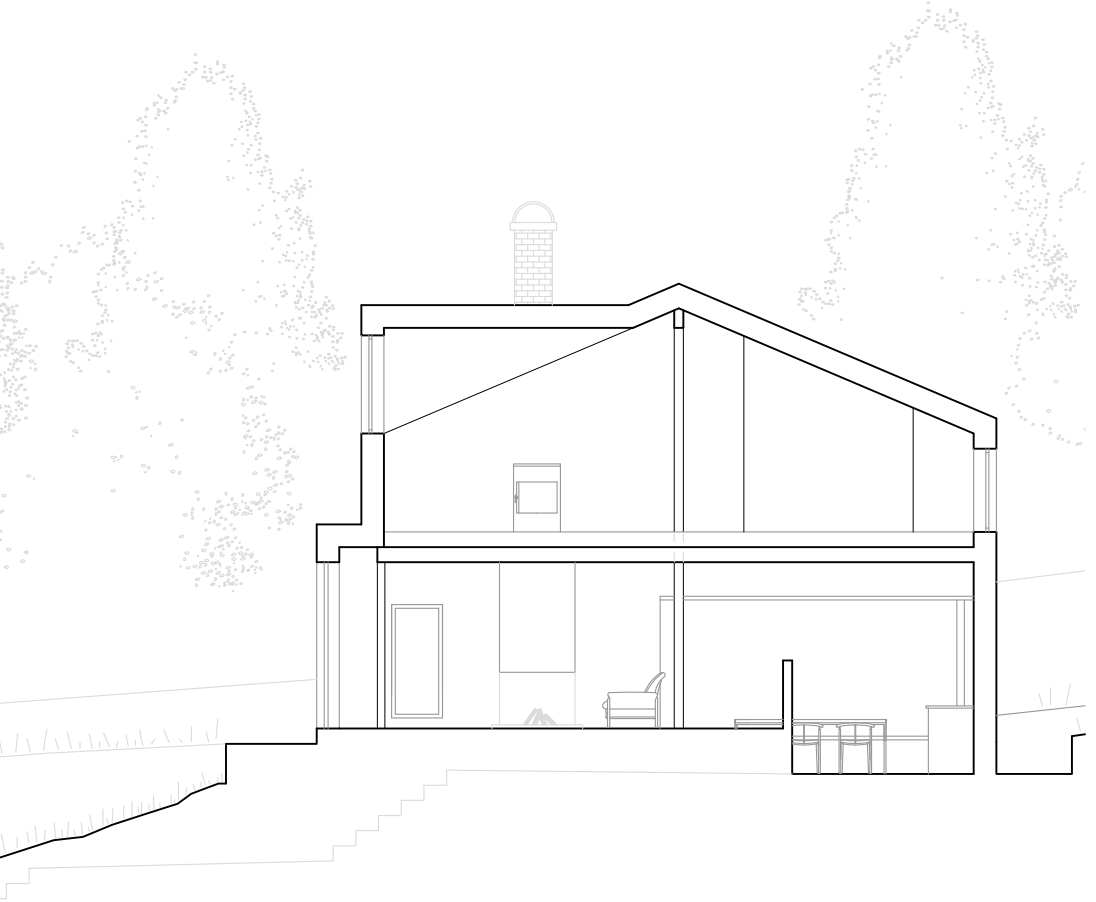

*House 1*  
*Section 2*  
*1:100*



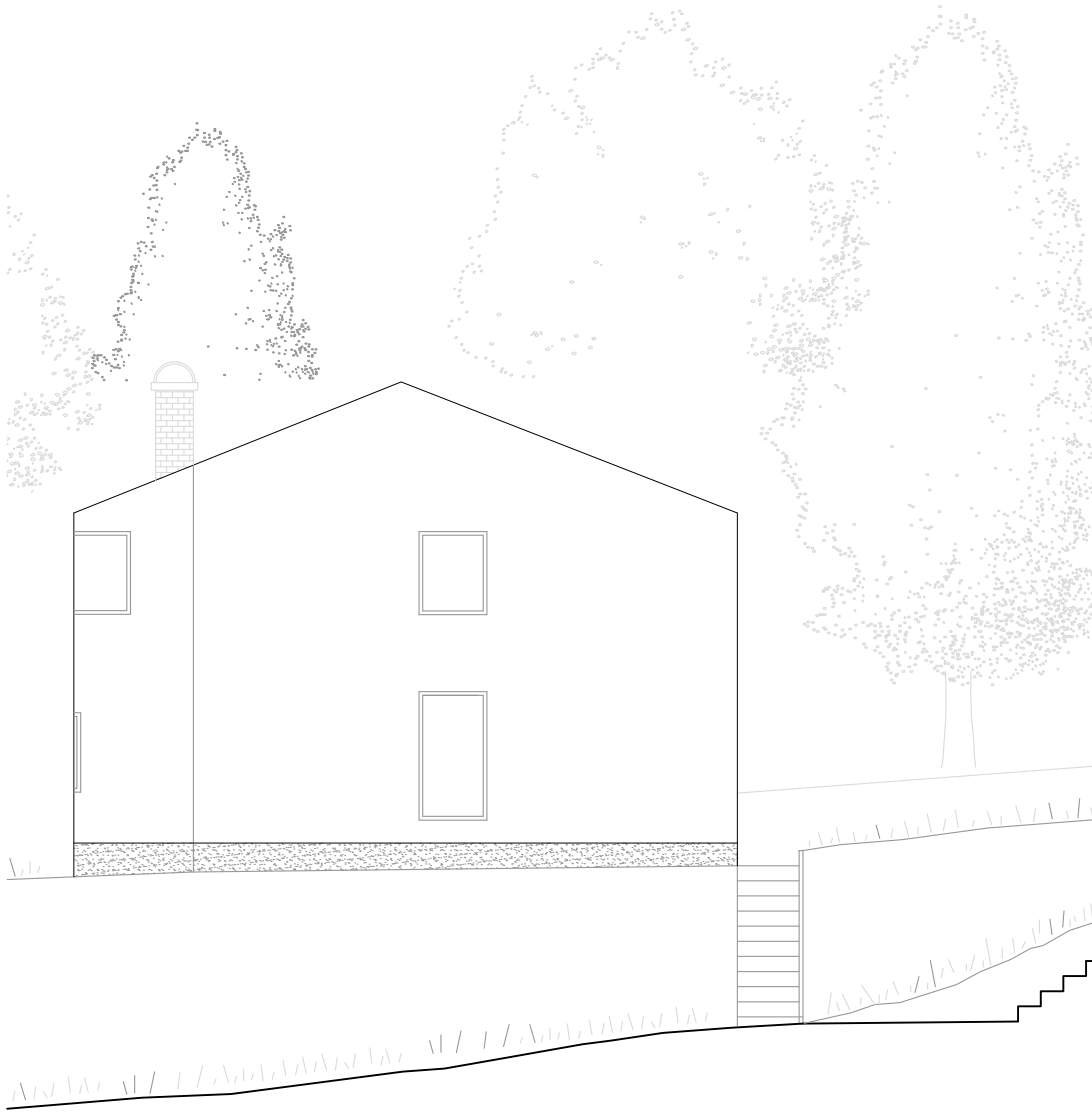

*House 2*  
*Facade North*



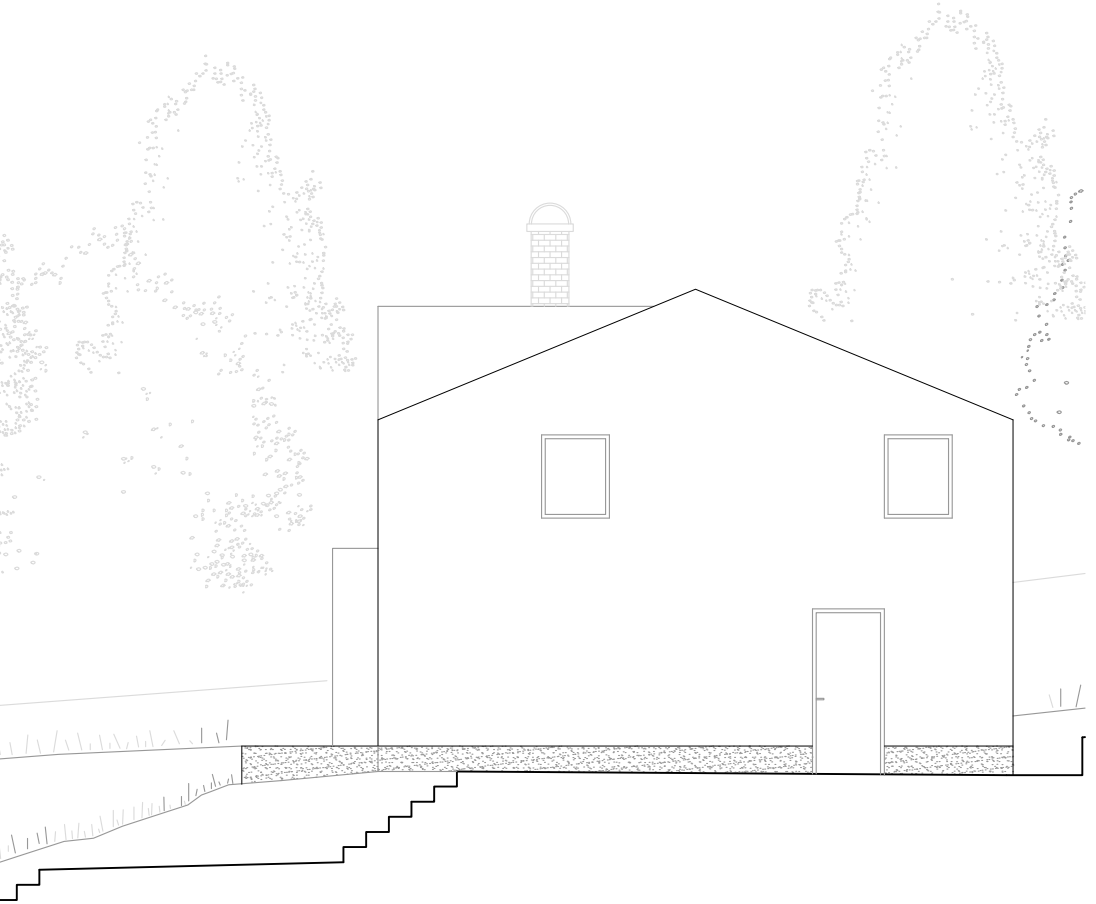

*House 1*  
*Facade North*

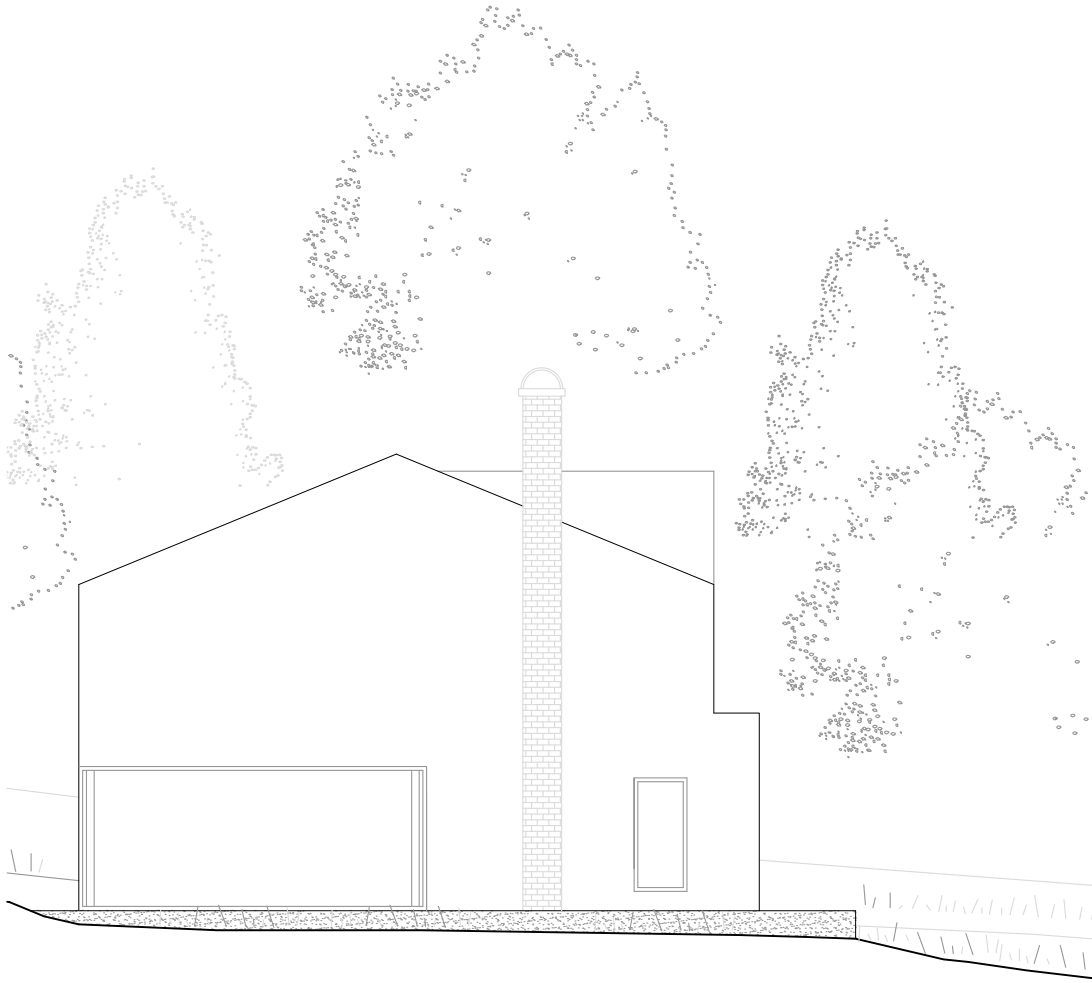

*House 1*  
*Facade South*

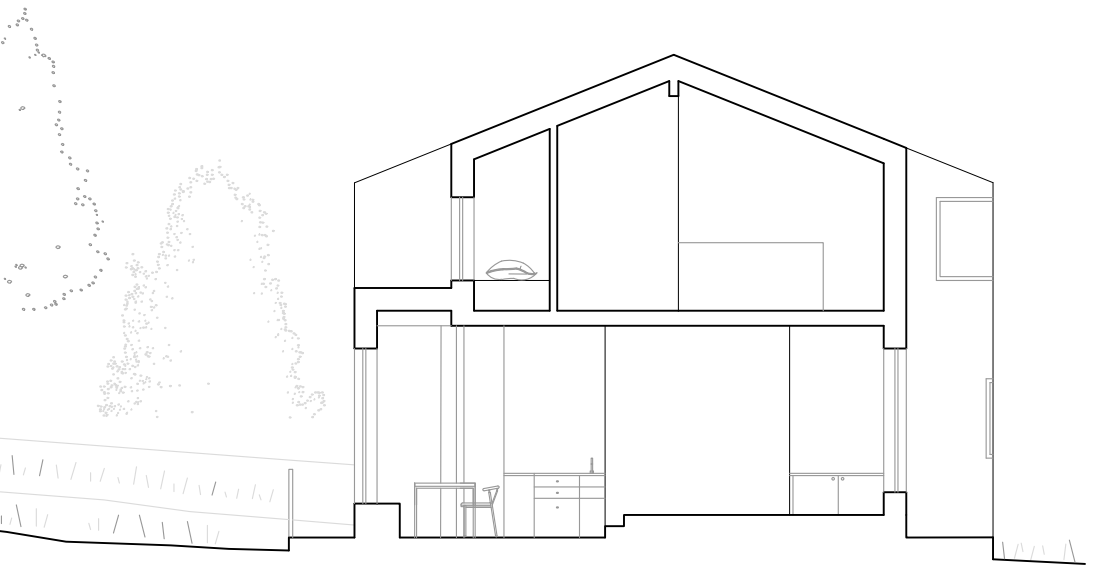

*House 2*  
*Section 4*  
*1:100*

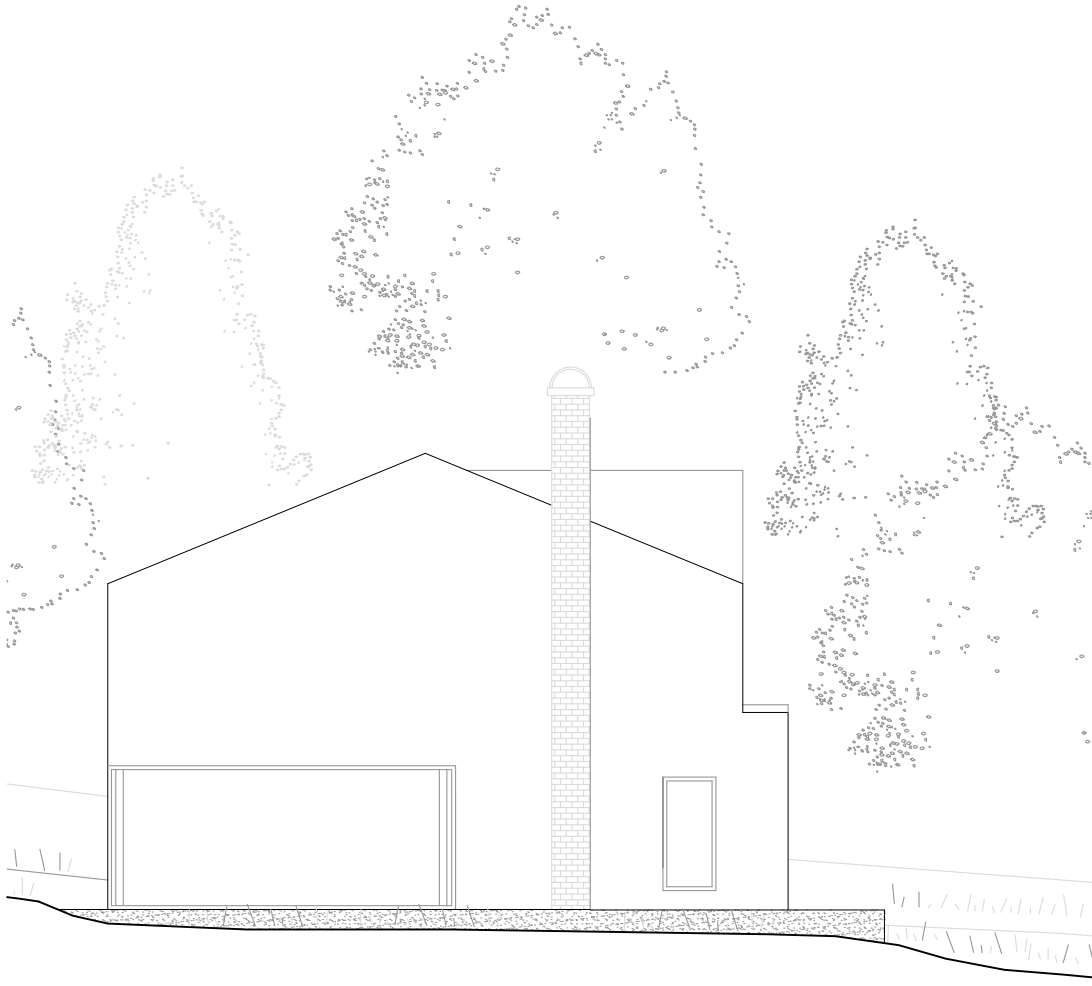

*House 1*  
*Facade South*

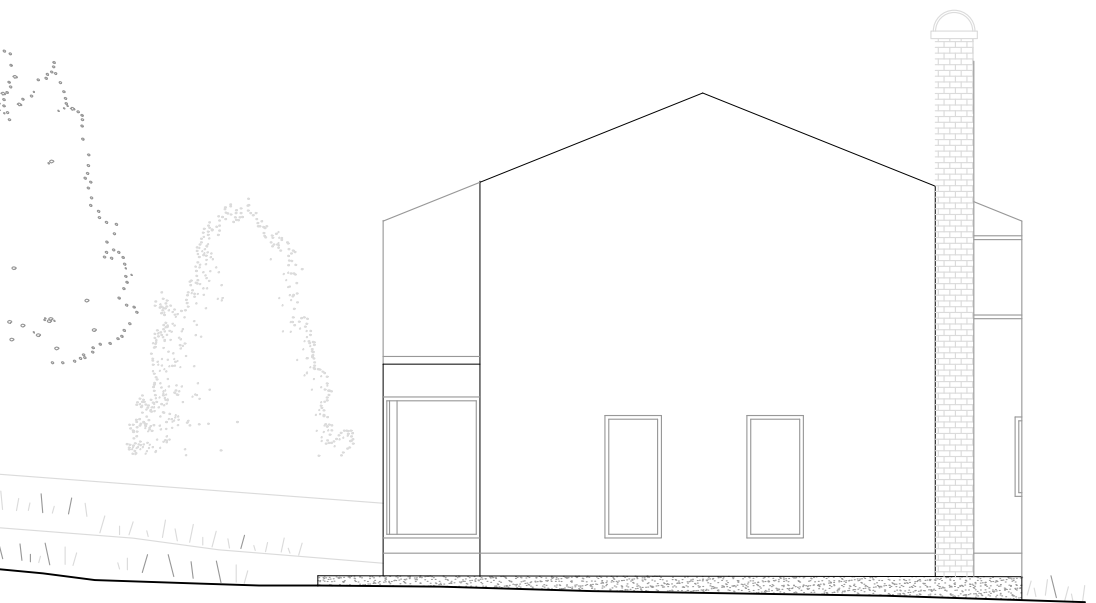

*House 2*  
*Facade South*

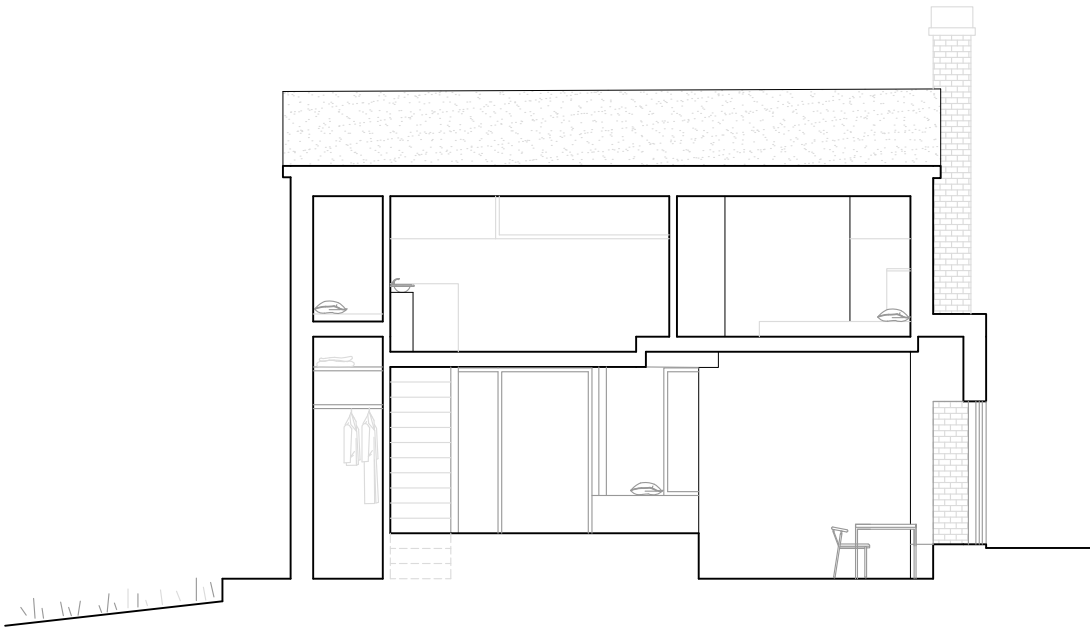

*House 1*  
*Section 1*  
*1:100*





*House 2*  
*Facade West*

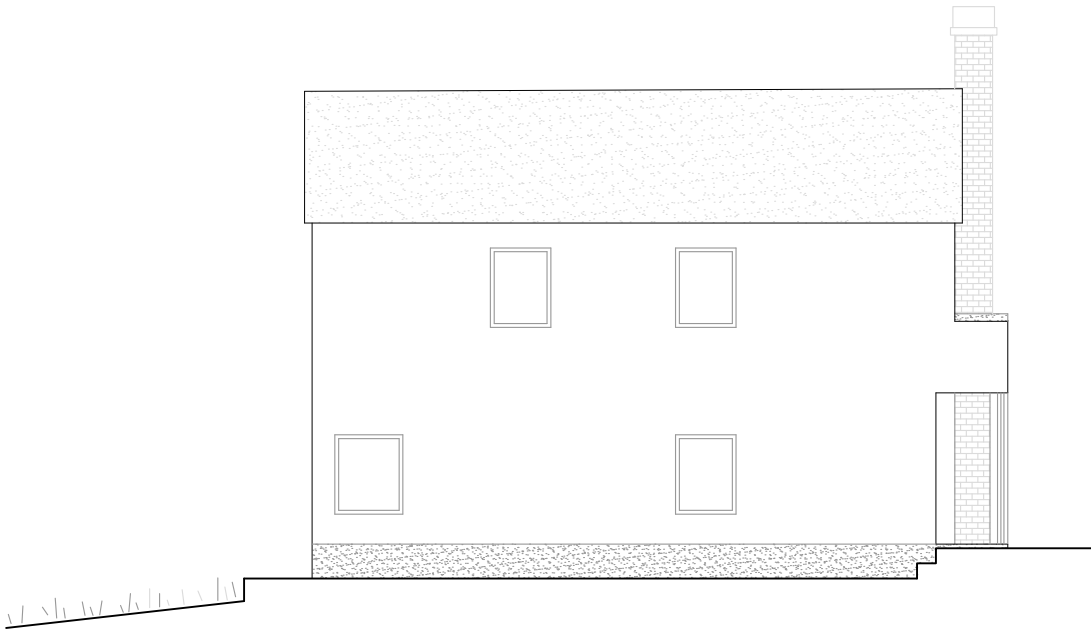

*House 1*  
*Facade West*



*House 2*  
*Facade West*

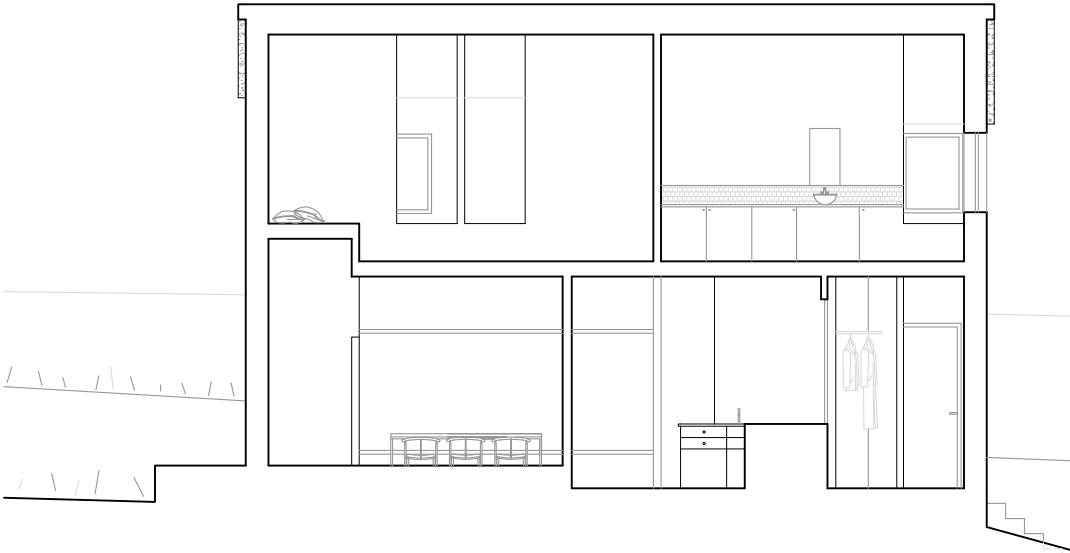

*House 2*  
*Section 3*  
*1:100*

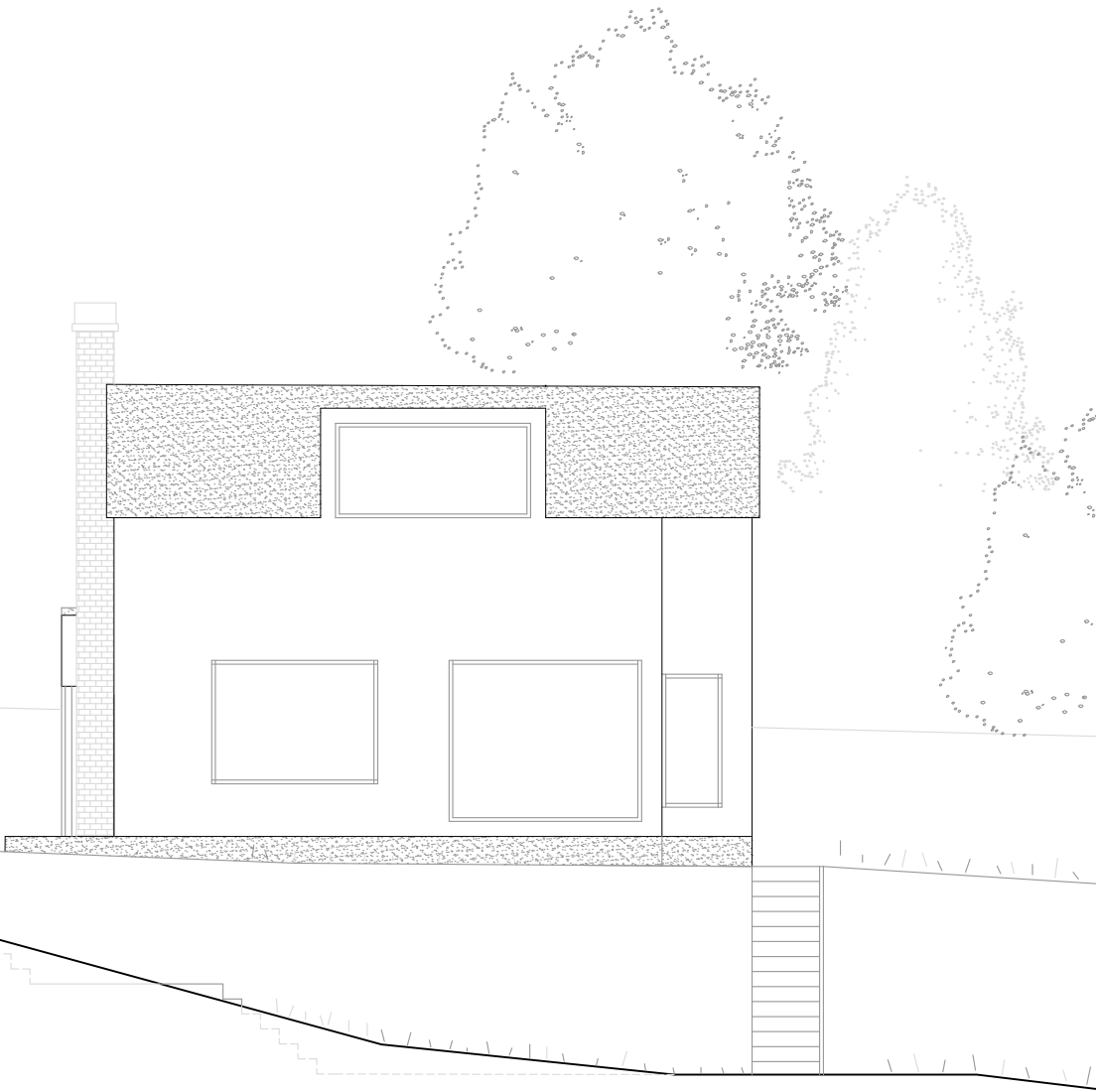

*House 1*  
*Facade East*

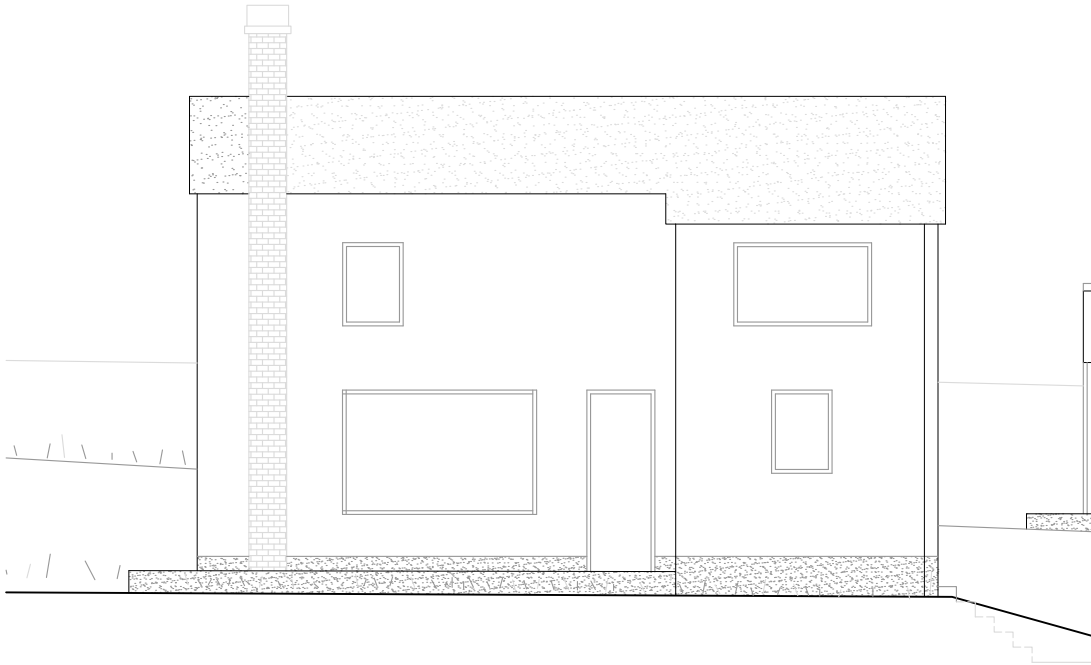

*House 2*  
*Facade East*

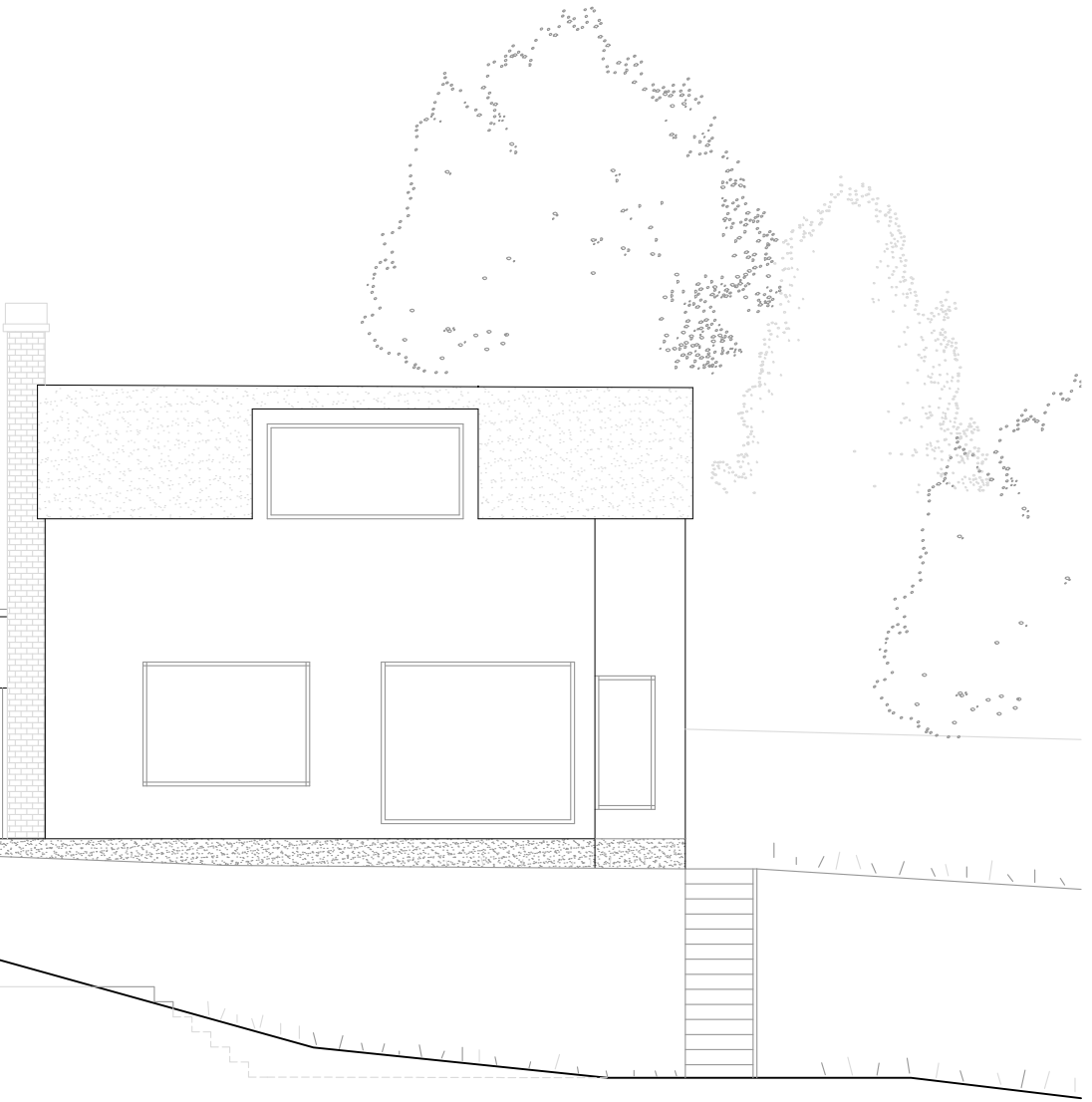

*House 1*  
*Facade East*



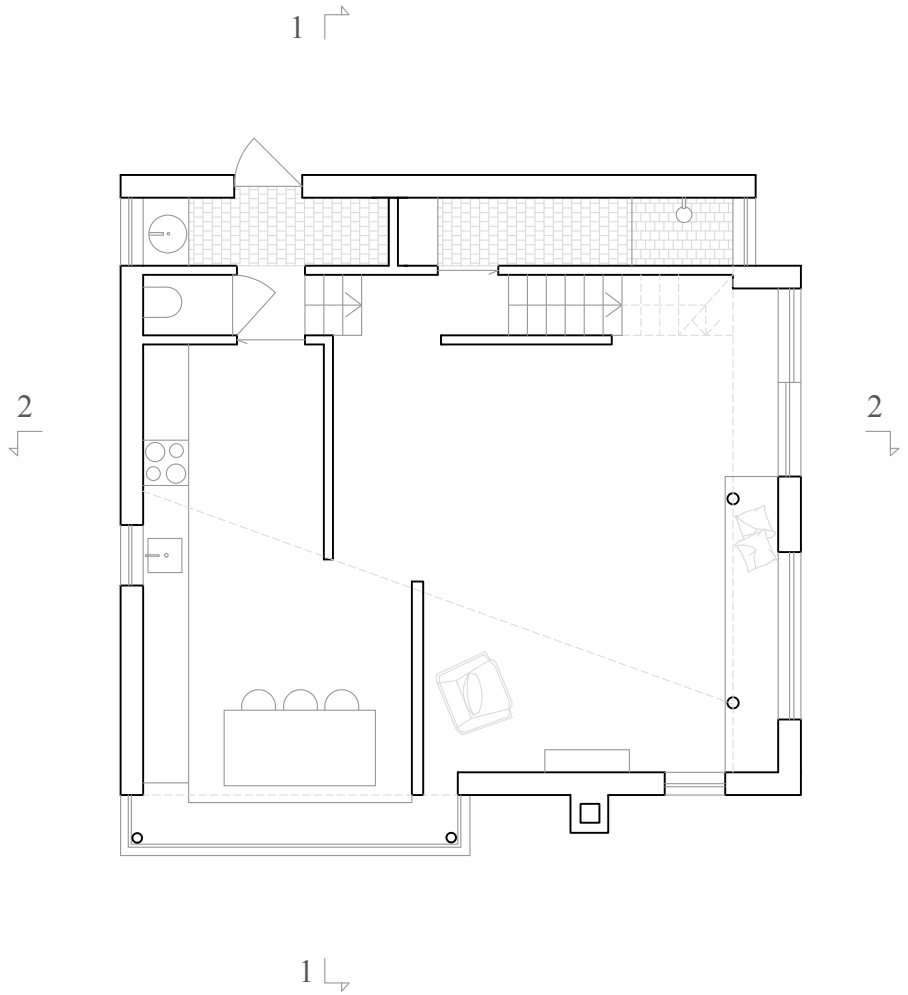

*House 1*  
*Plan first floor 1:100*

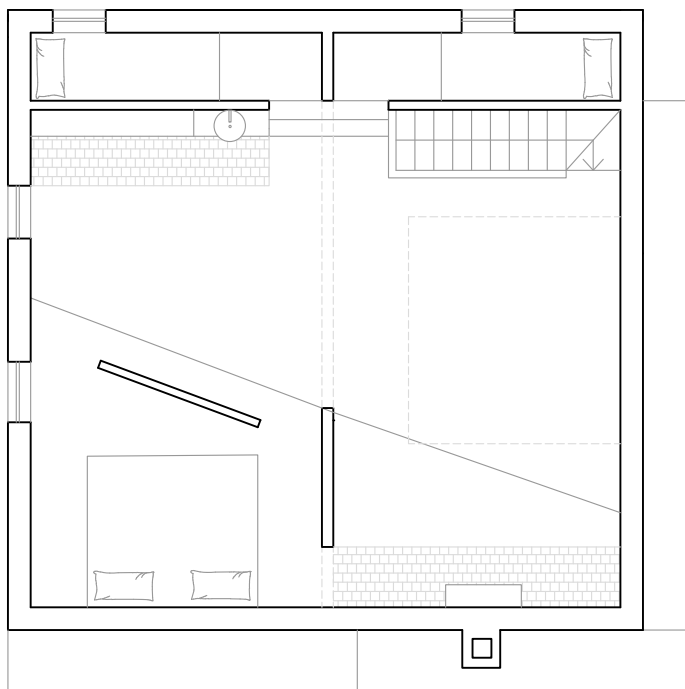

*House 1*  
*Plan second floor 1:100*

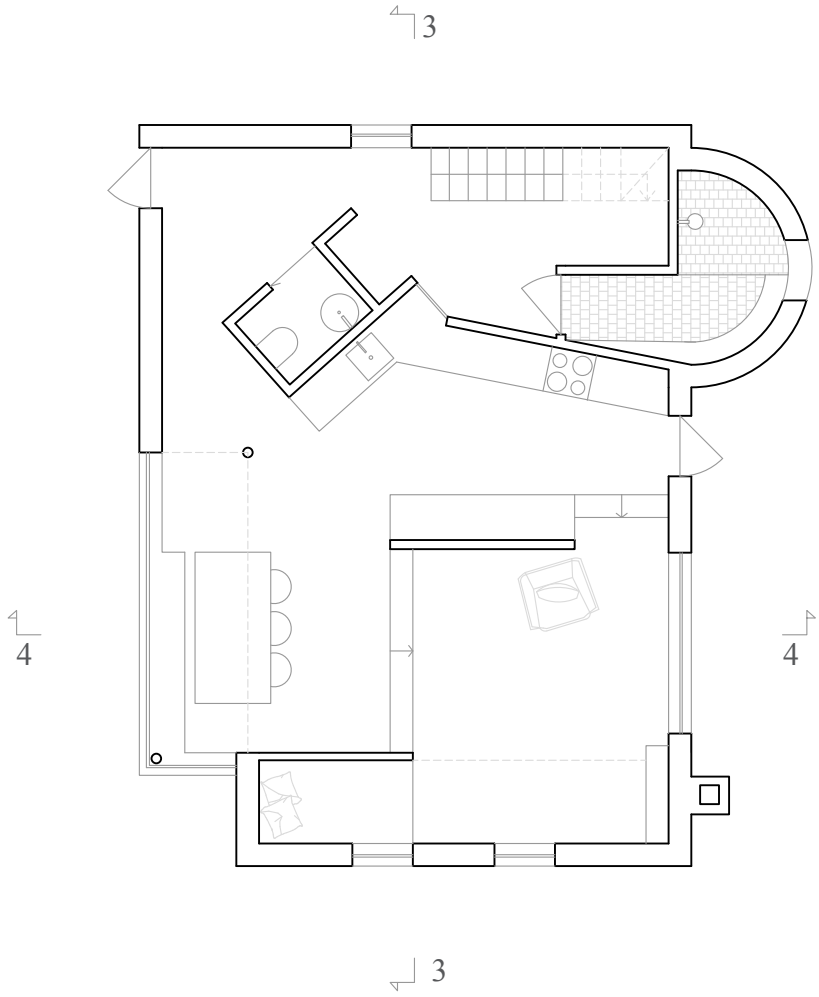

*House 2*  
*Plan first floor 1:100*

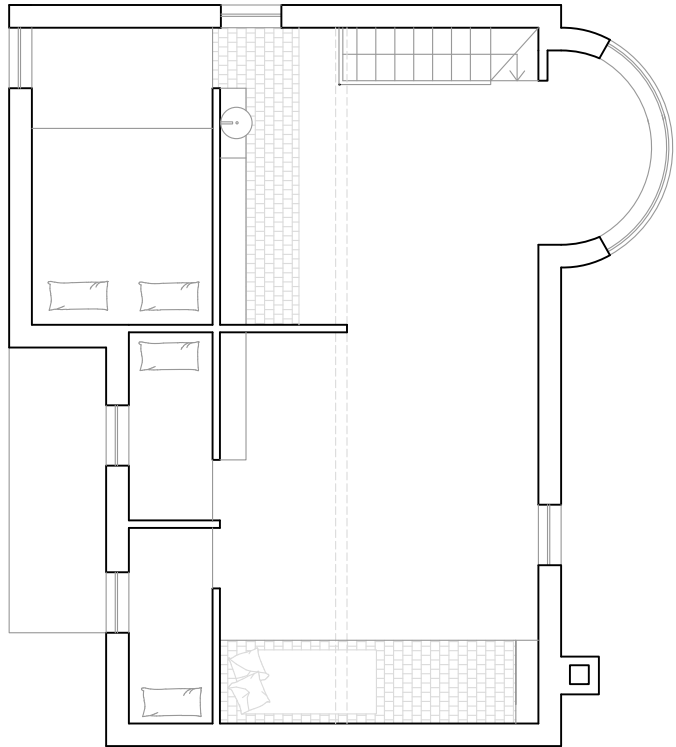

*House 2*  
*Plan second floor 1:100*

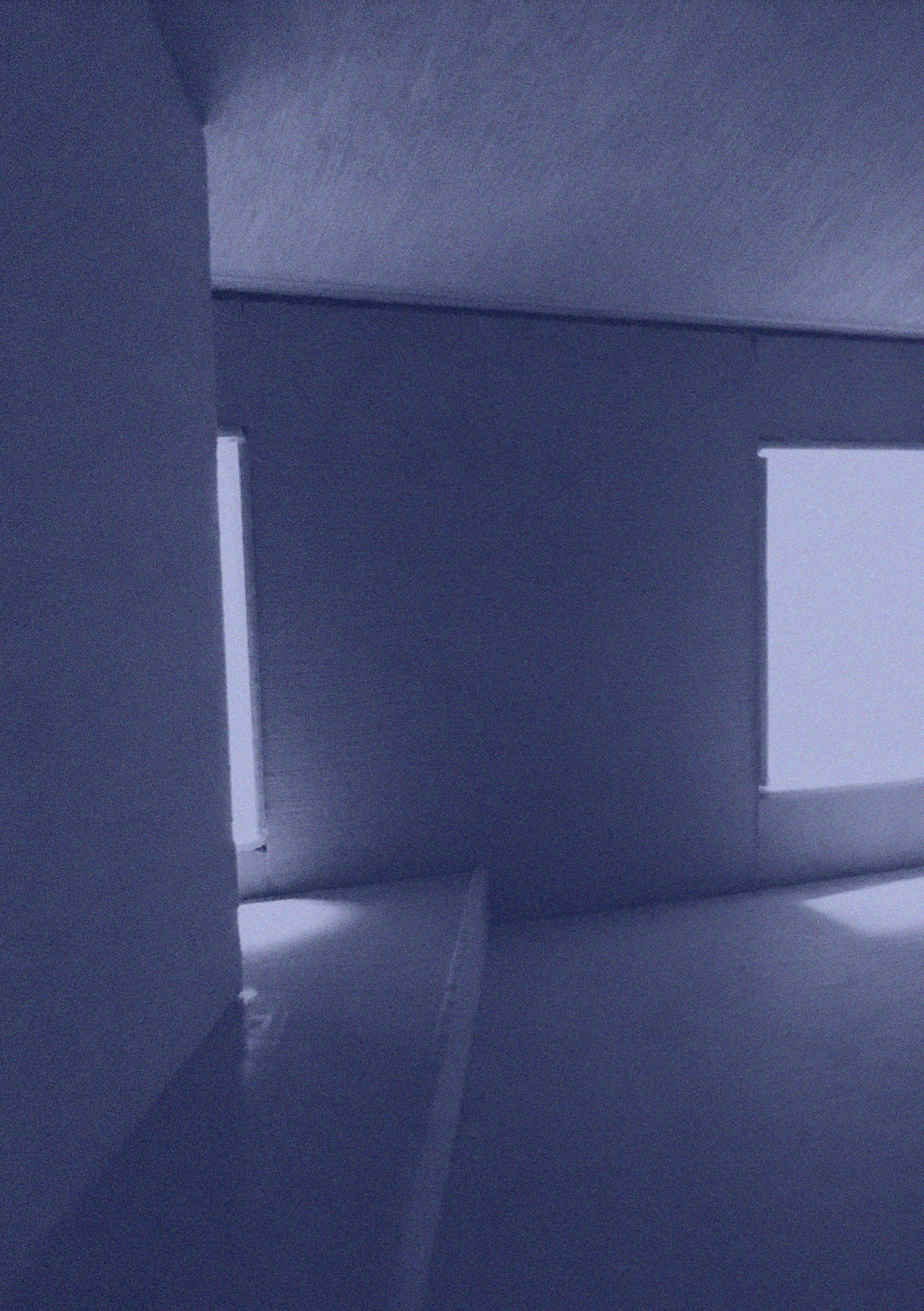



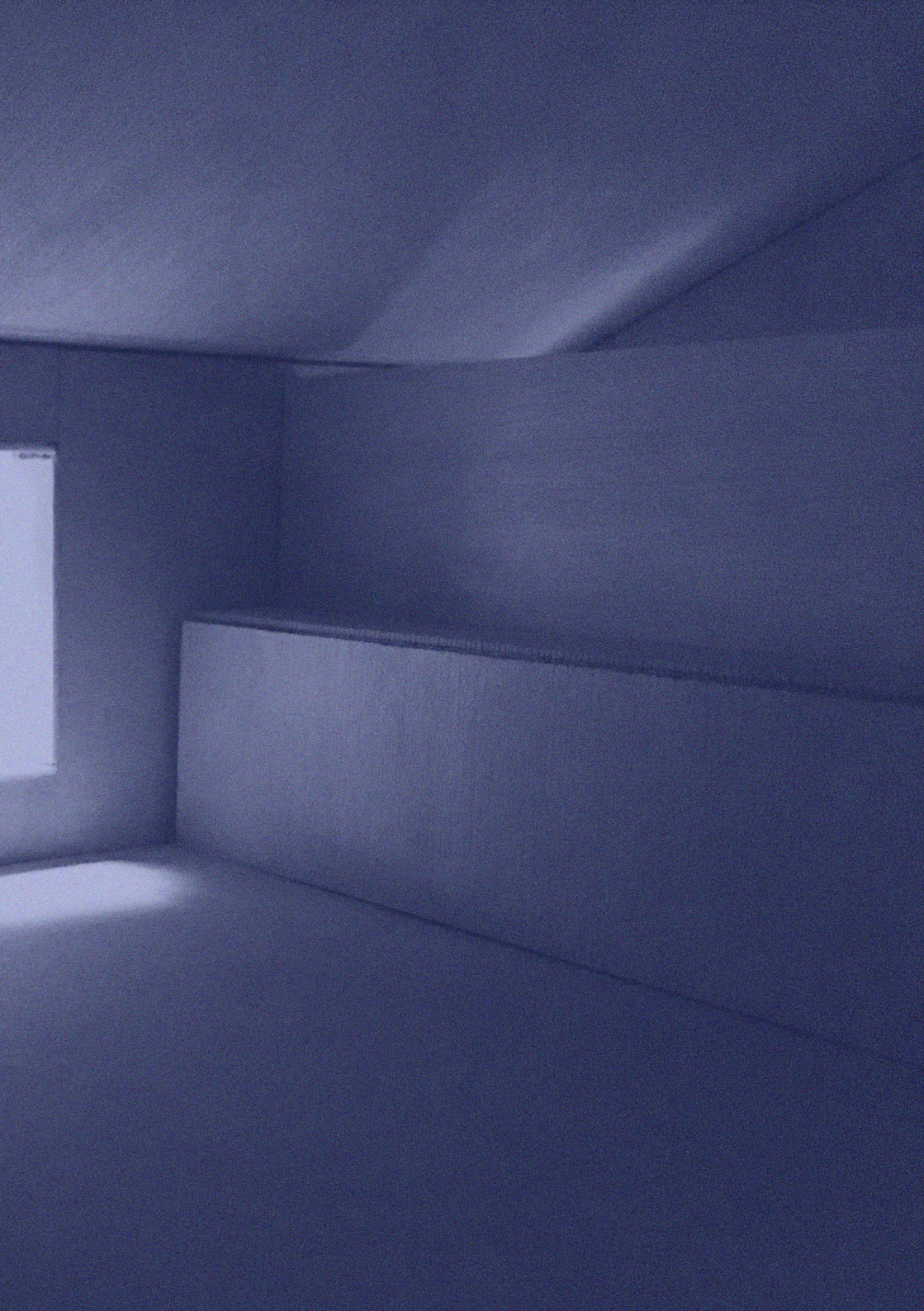



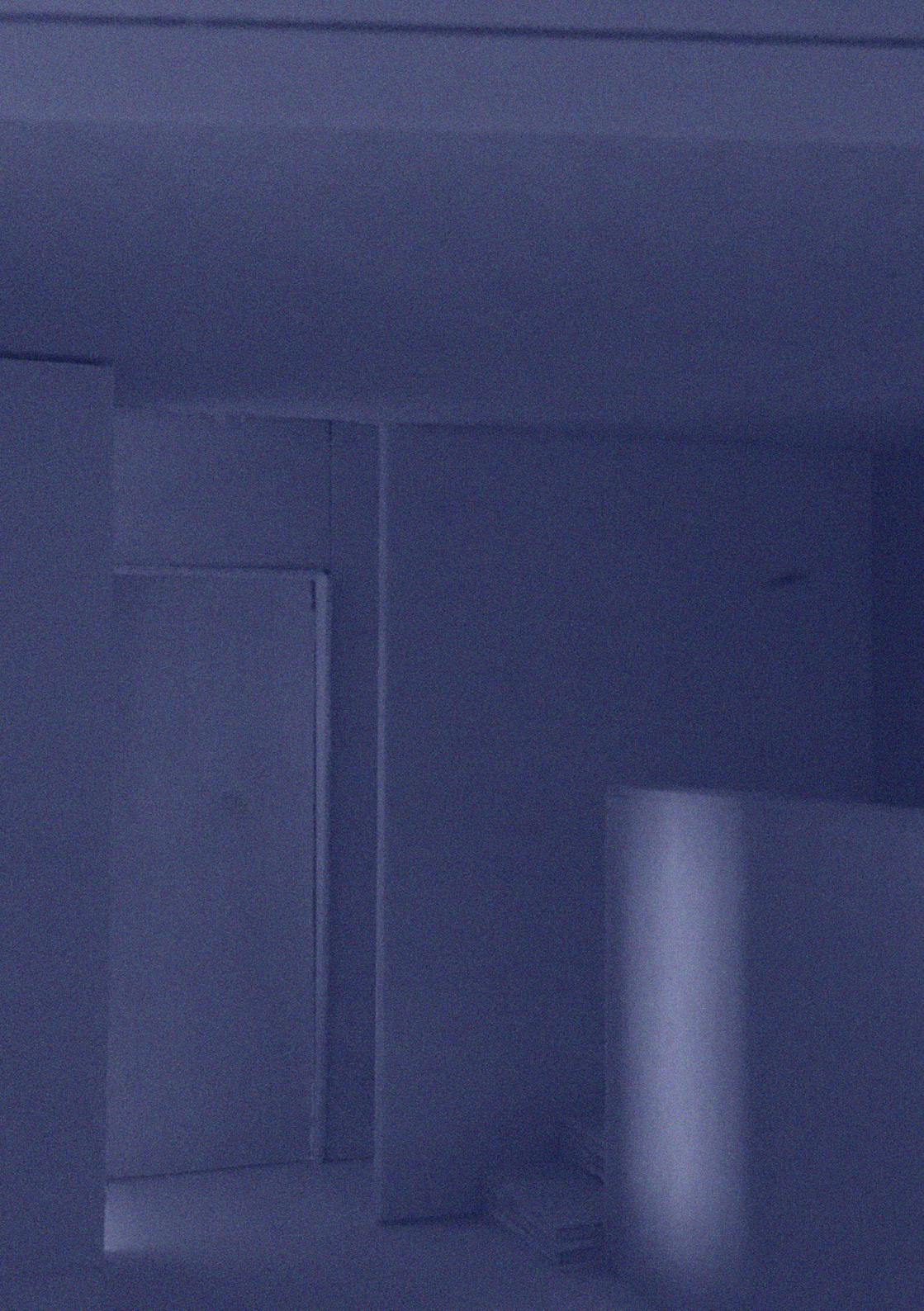















Every winter we, the neighbors of the farm went ice skating on the little water at the bottom of the hill, now in front of The Couple. And in summer the same people walked on a path in the andscape to get down to the ocean for a bath.







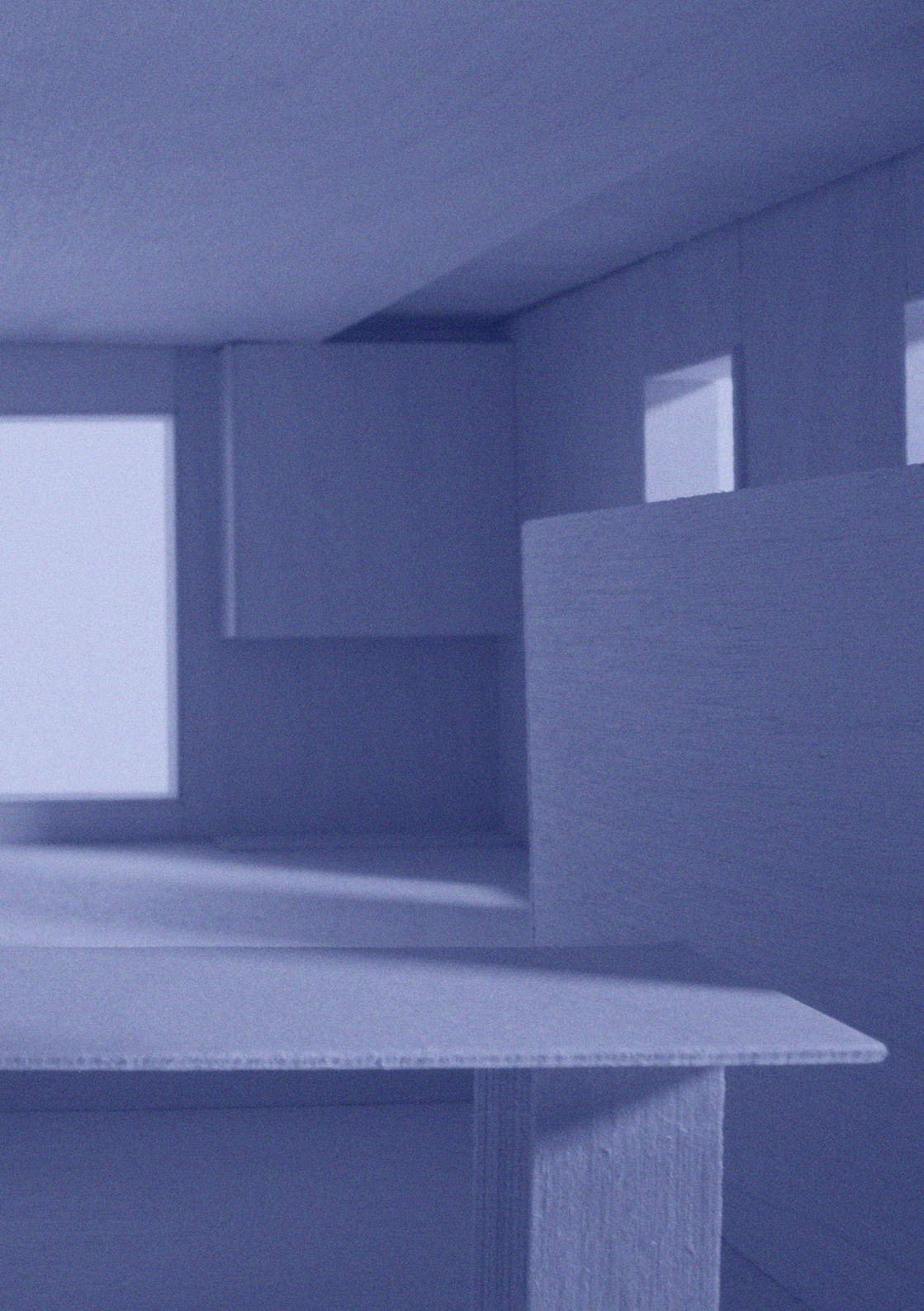



In my childhood house we had a big old wooden staircase up to the loft. I loved to play in this staircase, and to be at the gloomy attic with the small roofwindow. But then my parents tared the stair down in order to make a small office where it stood. And then we got a hatchway with a folding ladder. I still miss that staircase.















