

BOOK OF BEHOLDING

Diploma - Fall 2020

Anne Margrethe Sørseth

Landscape fragments elevated from the ground, creates a significance, a suspension. The objects are still the same as they were on the beach before, the structures only provide a greater visibility. An opportunity for beholding, from the outside. But they also enable the object inside to behold what is outside. The dwelling objects inside look out upon others, both humans and structures. The collecting, ordering and making is a way of curating a landscape. Specific objects, that you might have been able to behold if you walked the same beaches as me, at the same time, but probably never would have. These fragments of shoreline have been extracted from their natural surroundings, where there were many just like them. The exception might be the red buoy, an alien, but familiar object to the shoreline. An even more specific selection has been given tailored beholders to dwell in. This process creates another significance, visible to others, but especially to me.





I started imagining how it would be for a human, like myself, to take the place of one of the objects like the shell or the root in its designated structure. The structure then changing scale to hold its new content, still treating its new inhabitant in the same manner. How would the human inside experience the outside from inside these different structures. Structures that are all elevated in a way but with different materiality, visibility and direction creating a completely different focus and way of being inside.

By adding a new structure containing the smaller structures, others may be invited inside. A structure that may hold all. A structure where the objects may behold each other, where people may behold each other as well as the structures. The experience is concentrated in the white cube, directing the gaze inward. The shoreline is invited into the structure revealed in the openings and transparency of the small structures inside.

Boundaries, walls and frames
separate.
Creates an outside and an inside.
Separates the outside from the inside,
and the inside from the outside.
But also one inside from another inside.
Order and control.
No intermingling



Boundaries, walls and frames
elevate.
Focuses and clarifies.
Looking in, looking out.
Creates a protective layer,
identifying what is important to protect.
Order and structure
Encourages you to behold.



INTERMINGLING



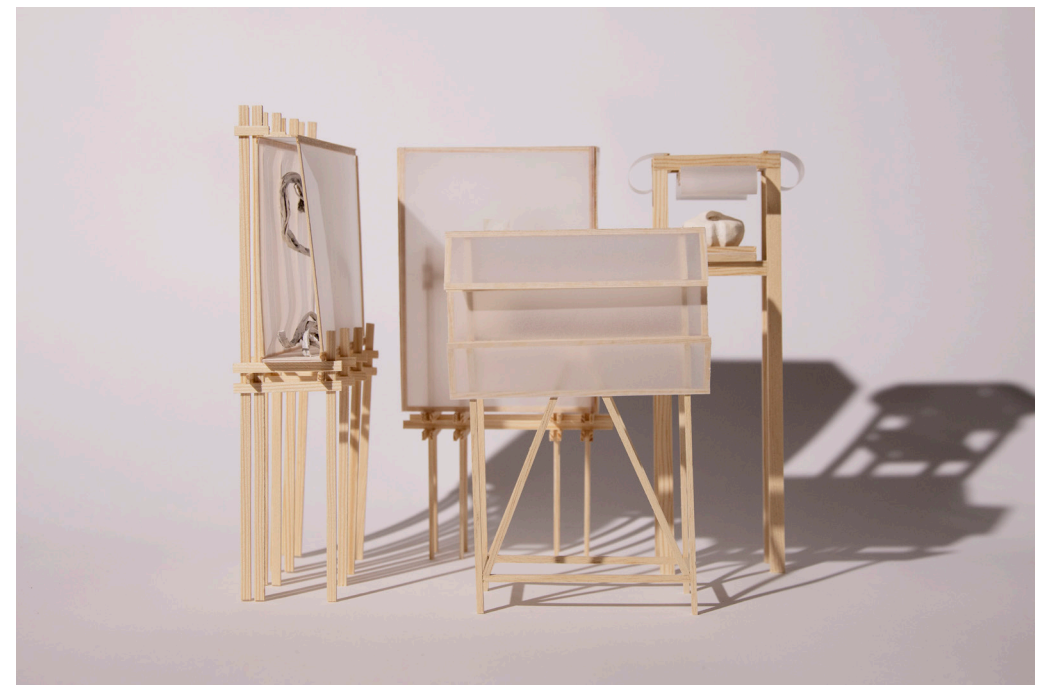
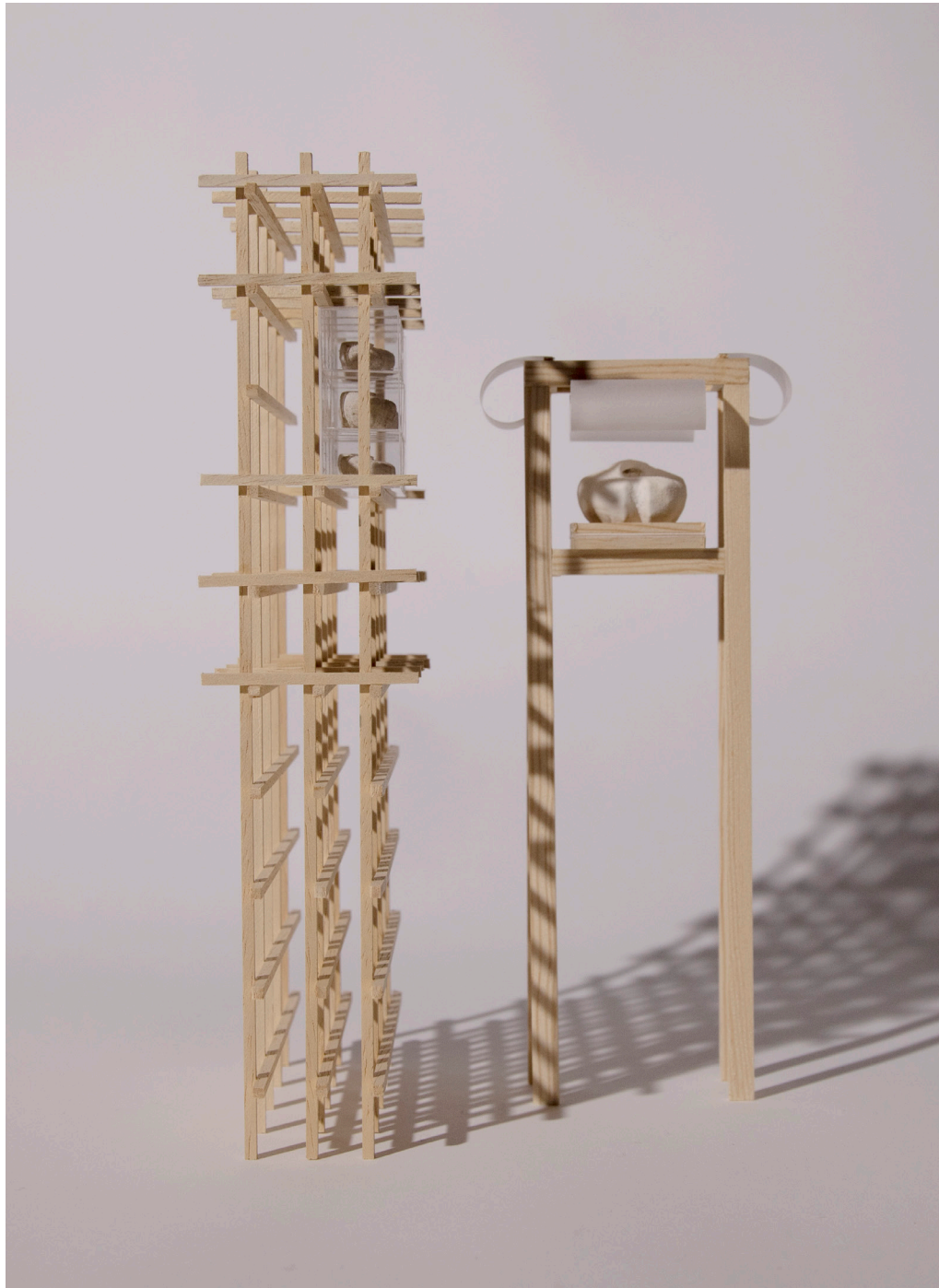

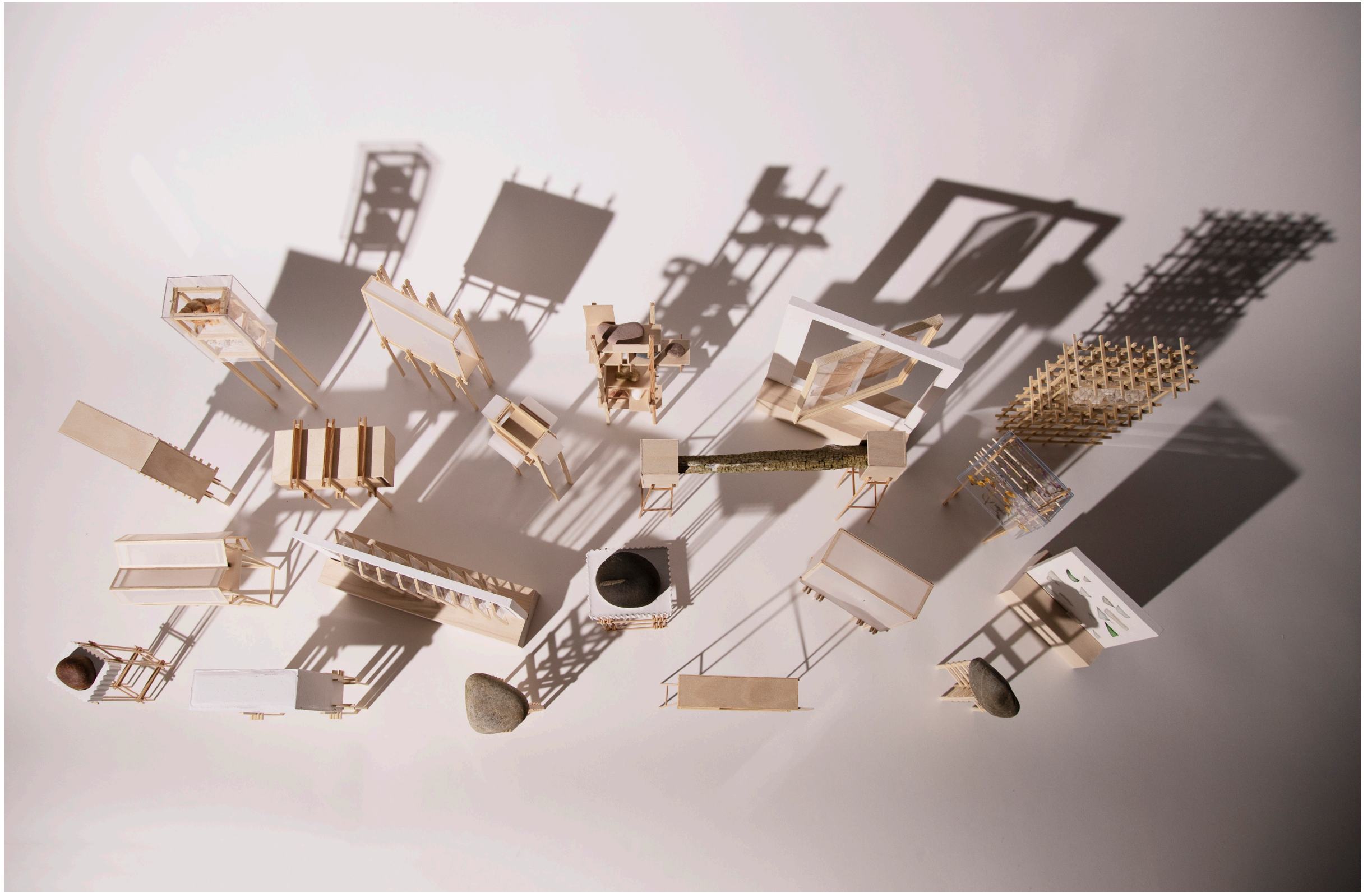

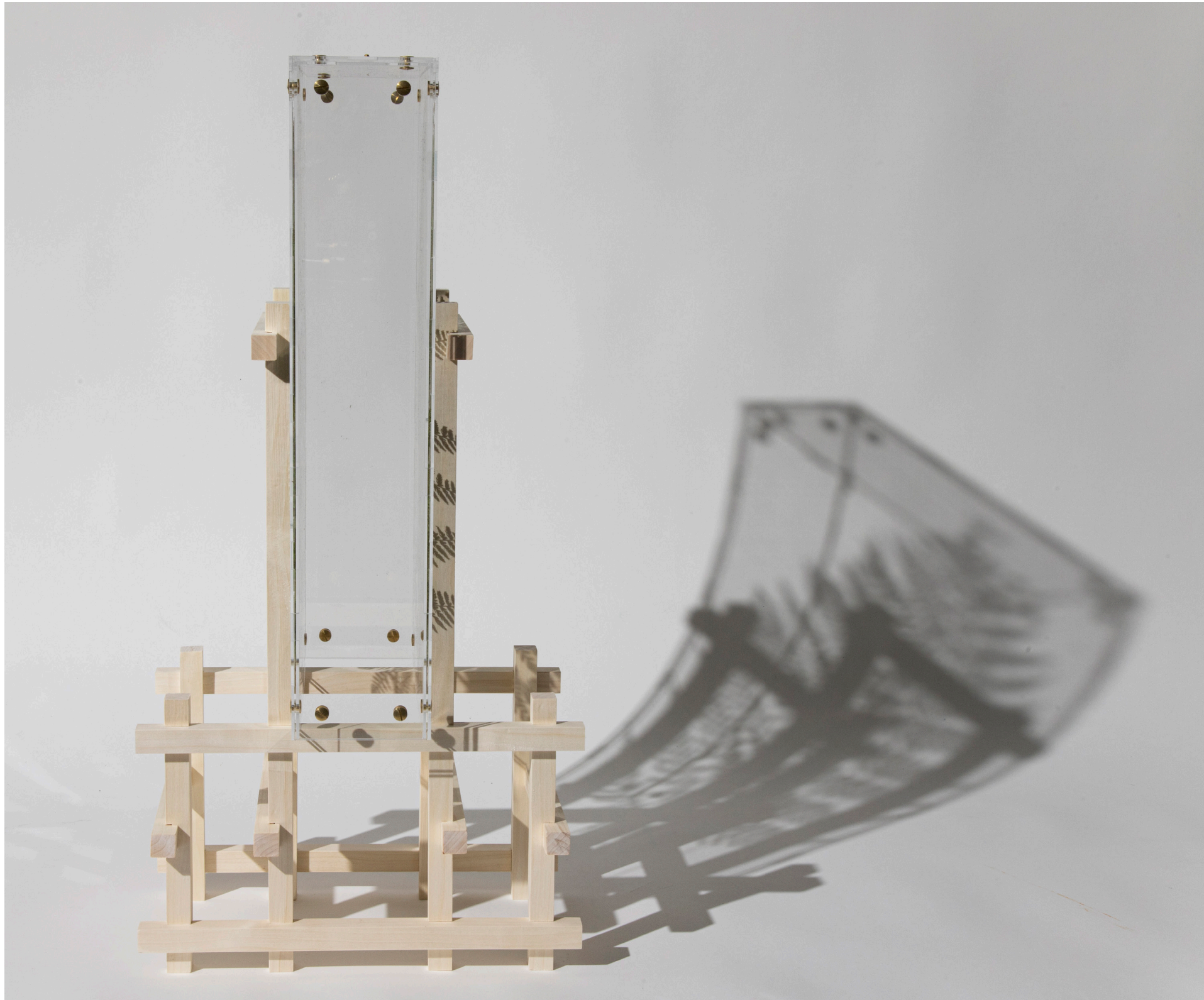

Why do humans carefully transport objects from the other side of the world to put them in glass boxes inside larger glass boxes? Objects migrating from white cube to white cube, intermingling with a collage of other objects of different times and places, but always separated, ordered and enclosed. Fragments of time, landscape, culture and history. We need to behold to remember.



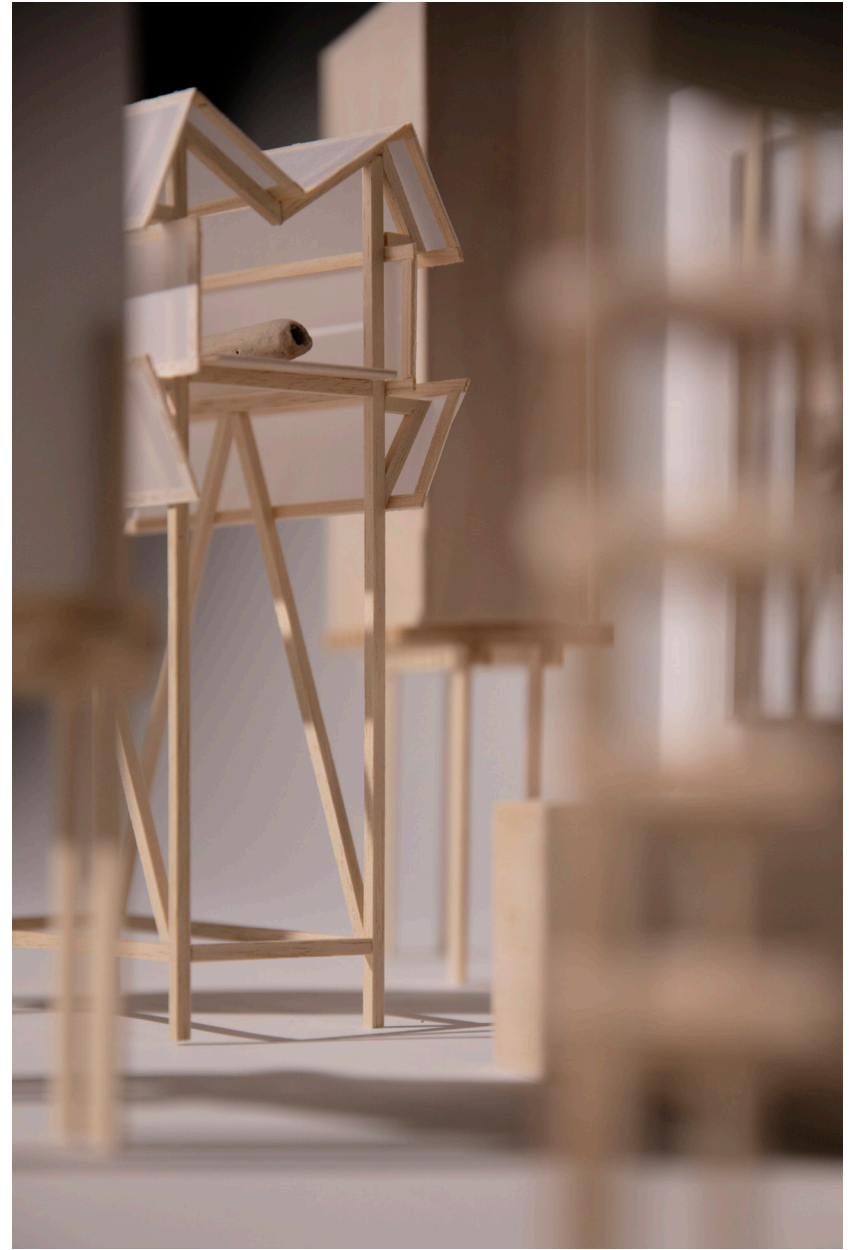

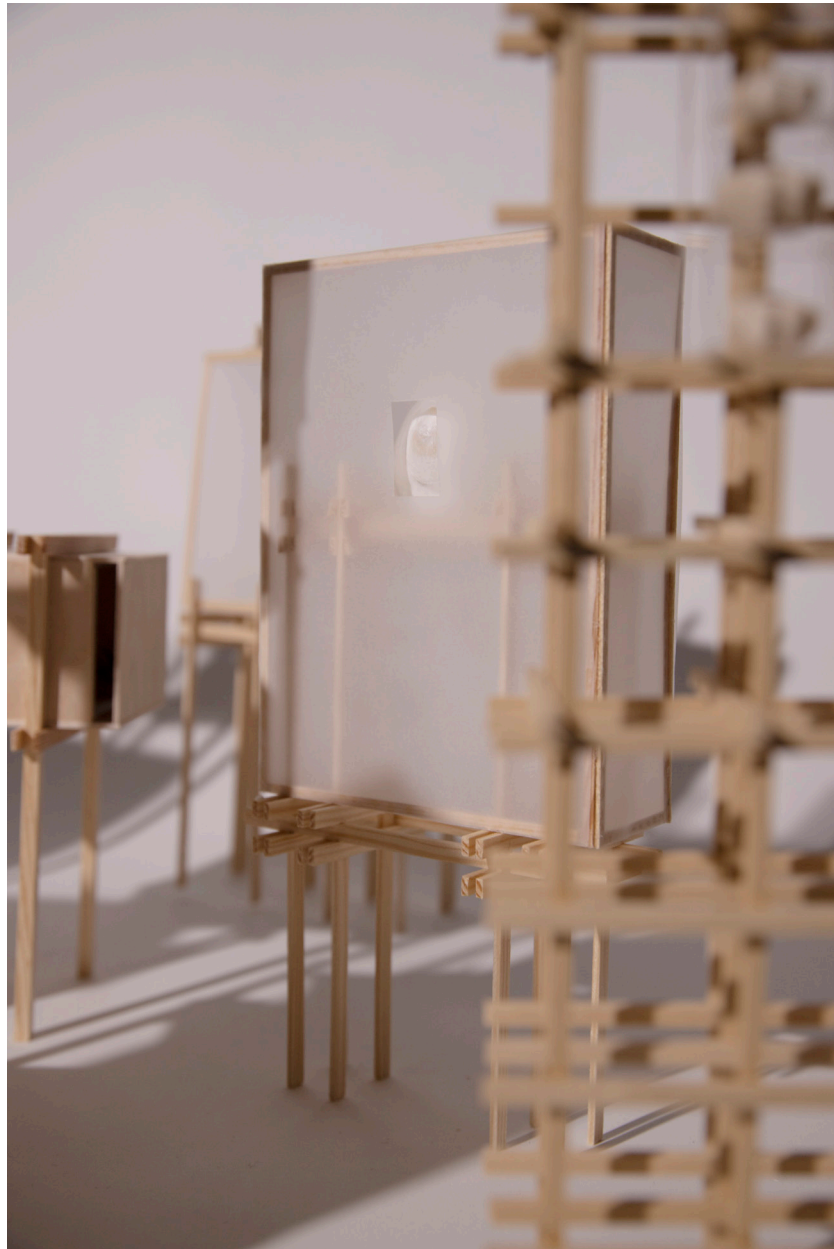







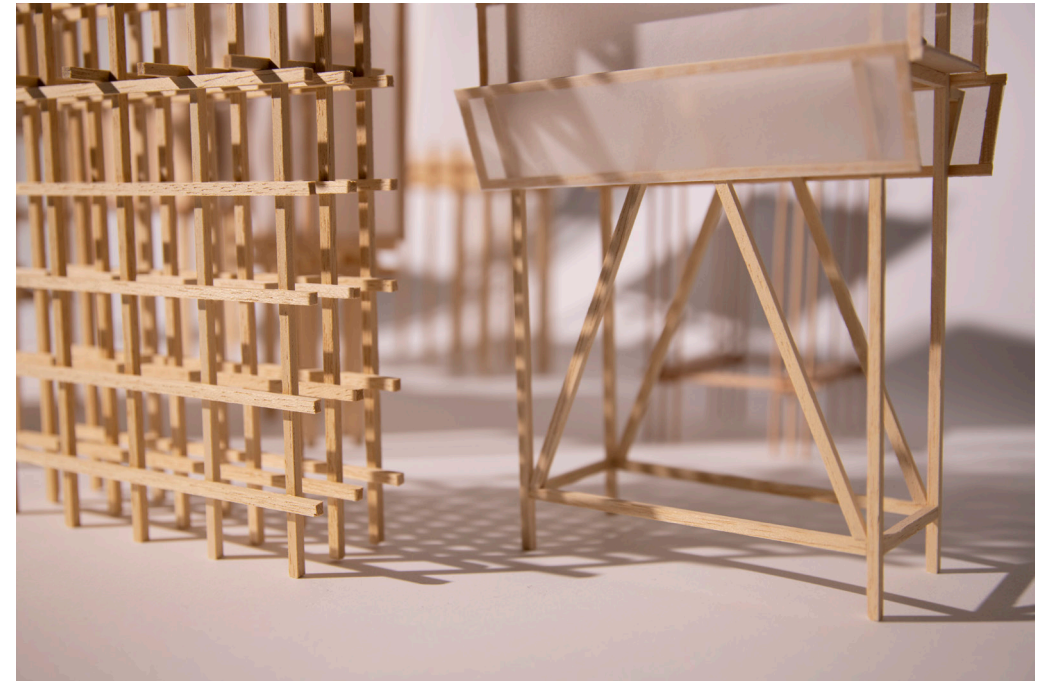





EXHIBIT

Structure nr. 23

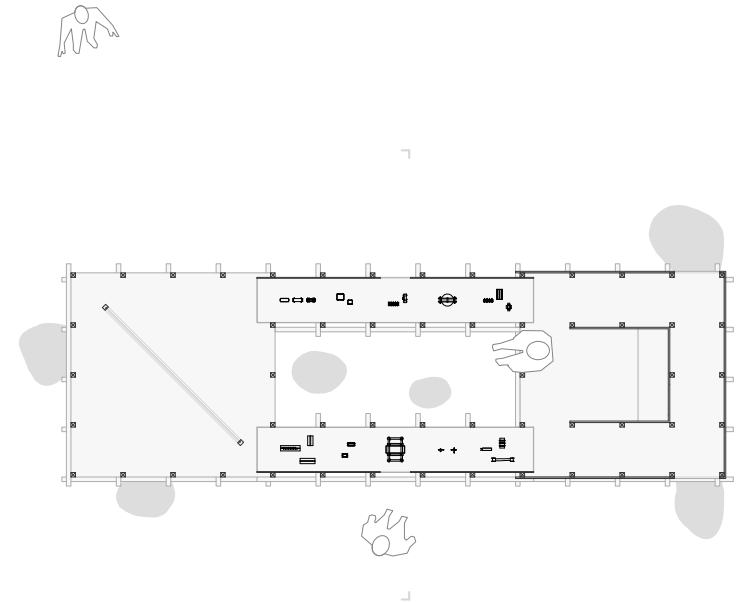

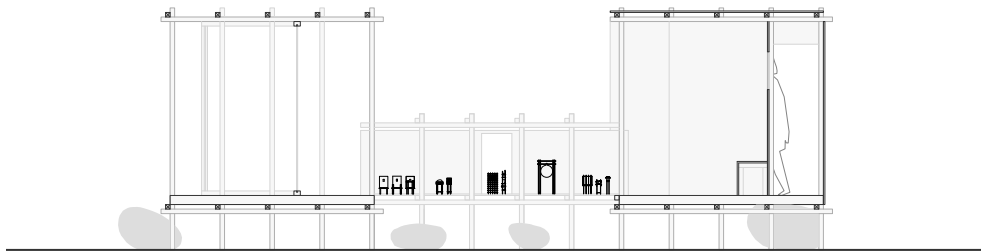

section 1:100

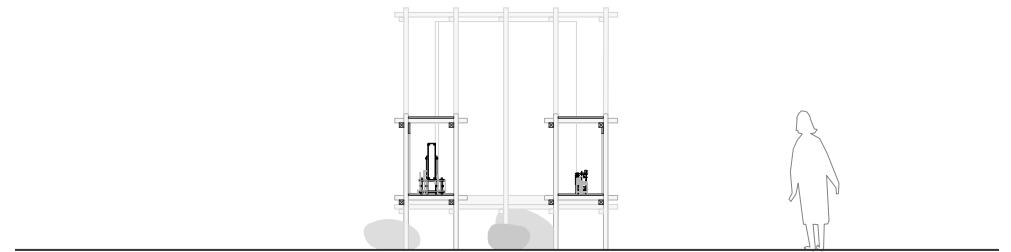

section 1:100

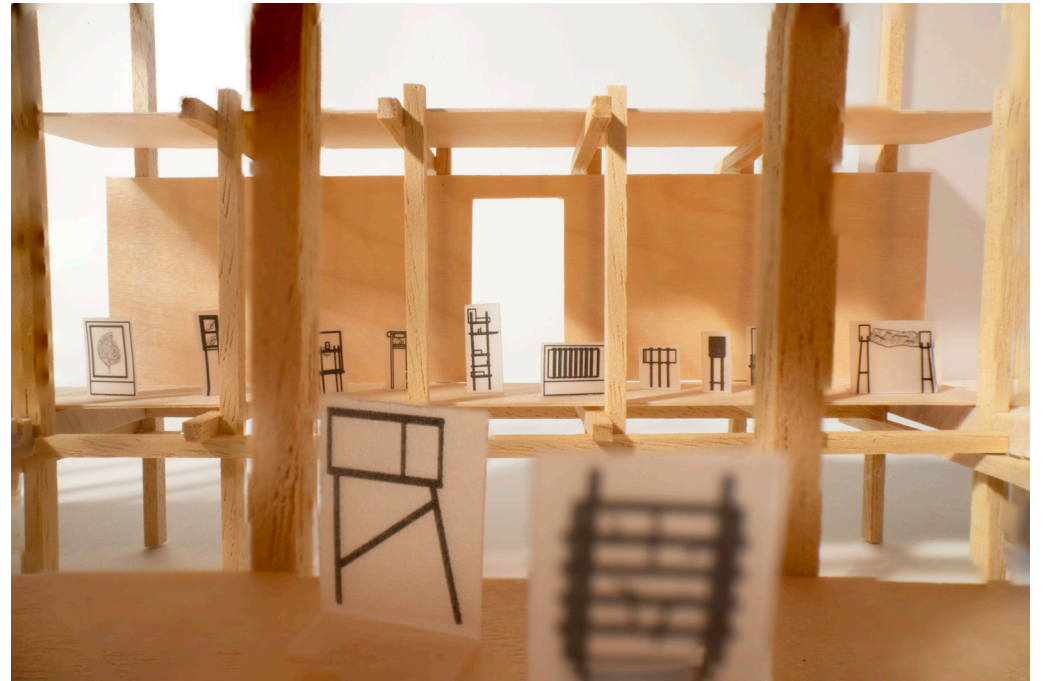

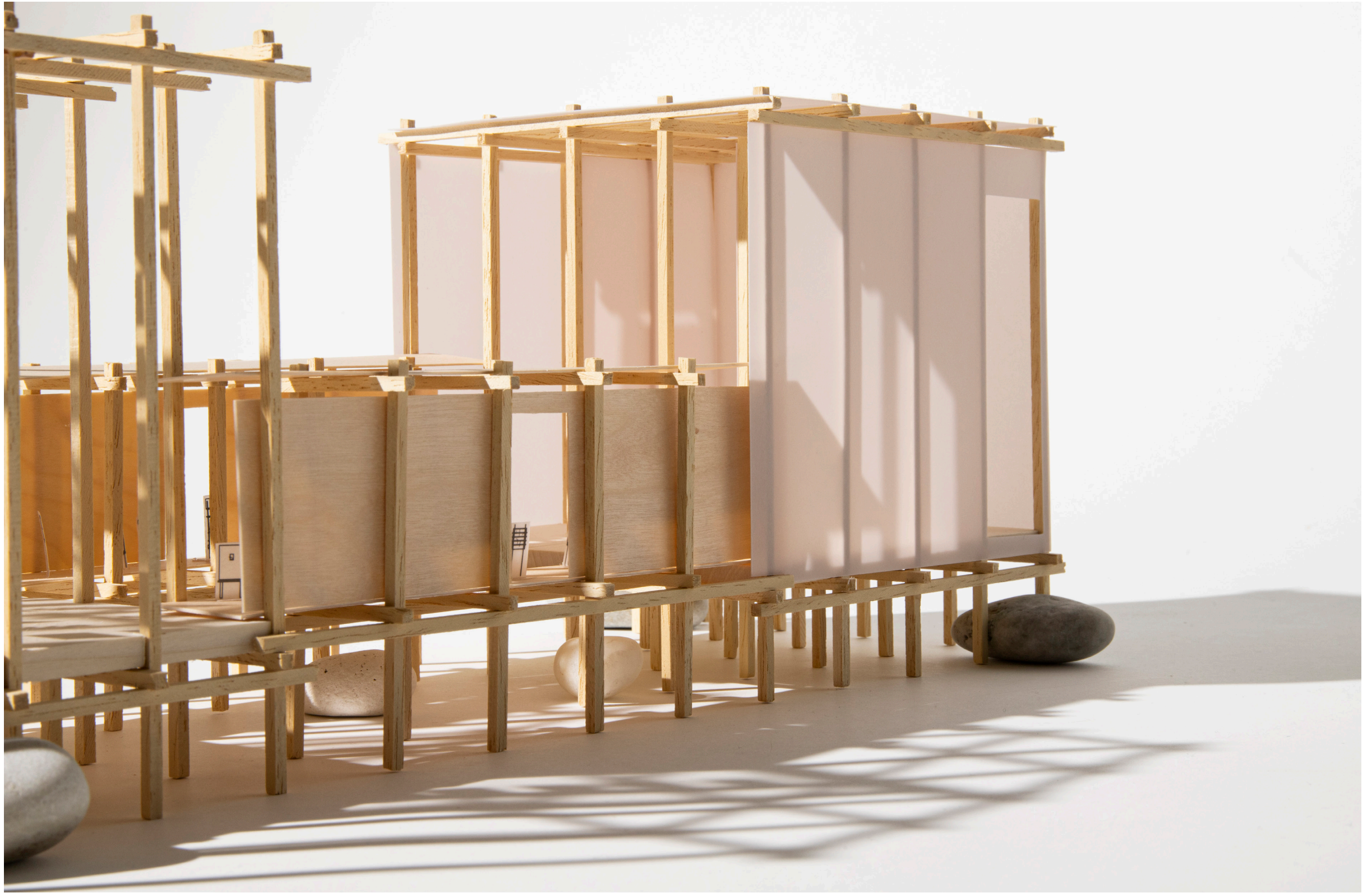





Dwelling in the white cube



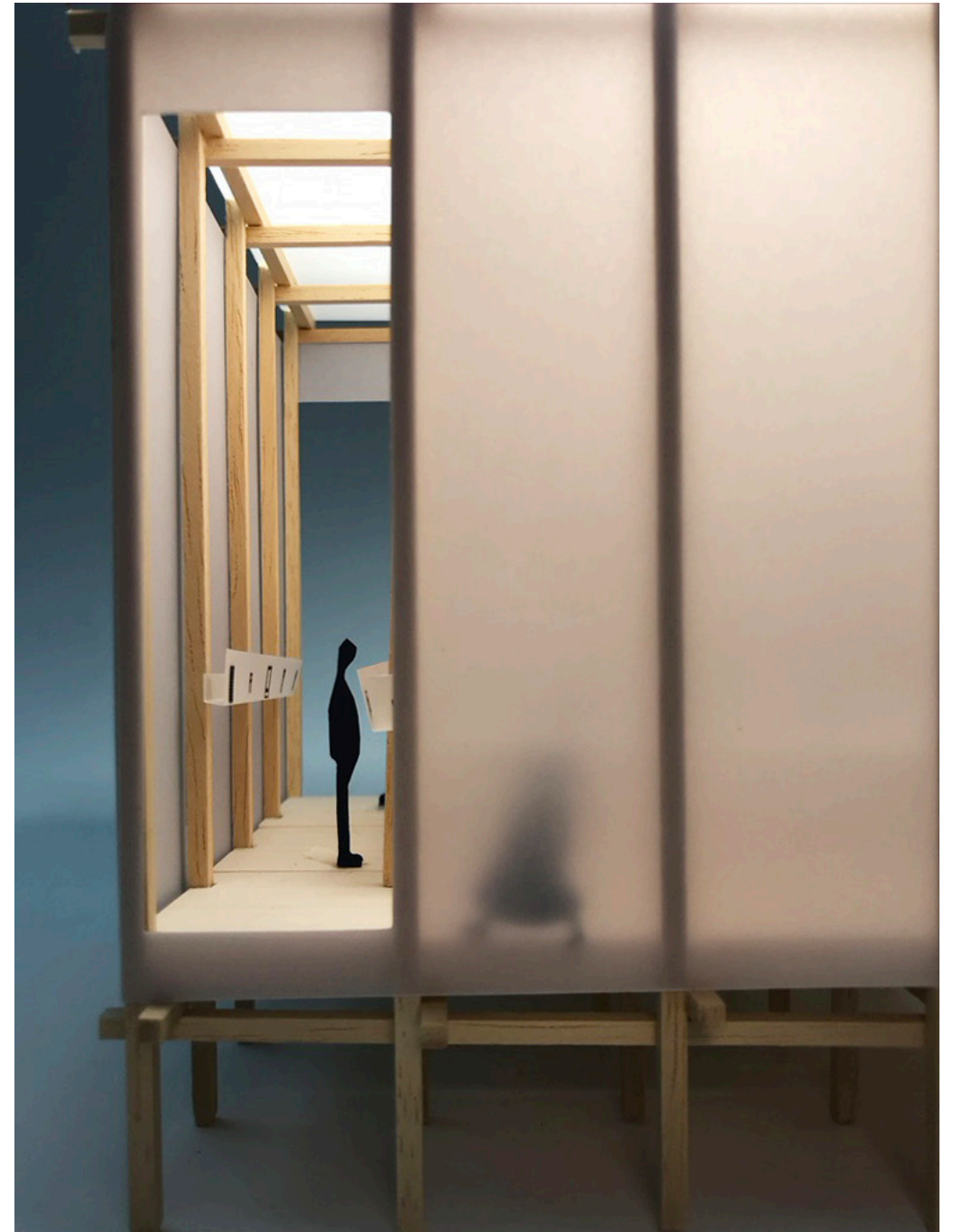

A different scale. Photo of model with people and structures in a 1:50 scale instead of 1:20.

EXHIBIT

Structure nr. 24

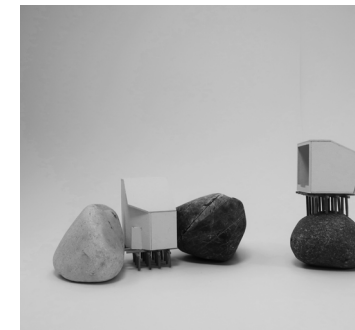
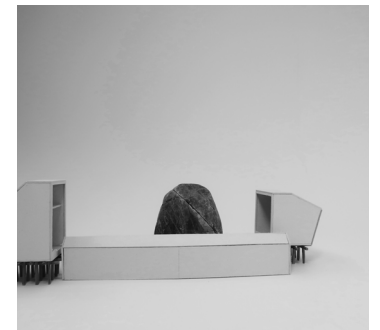
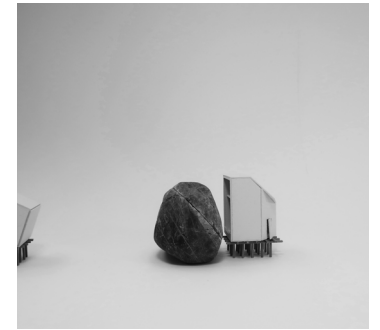
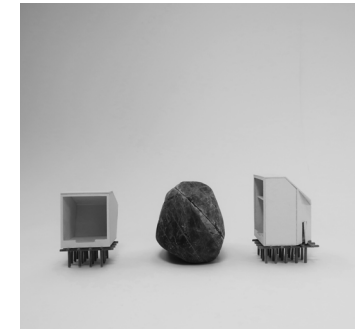
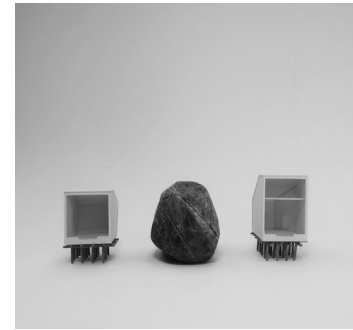
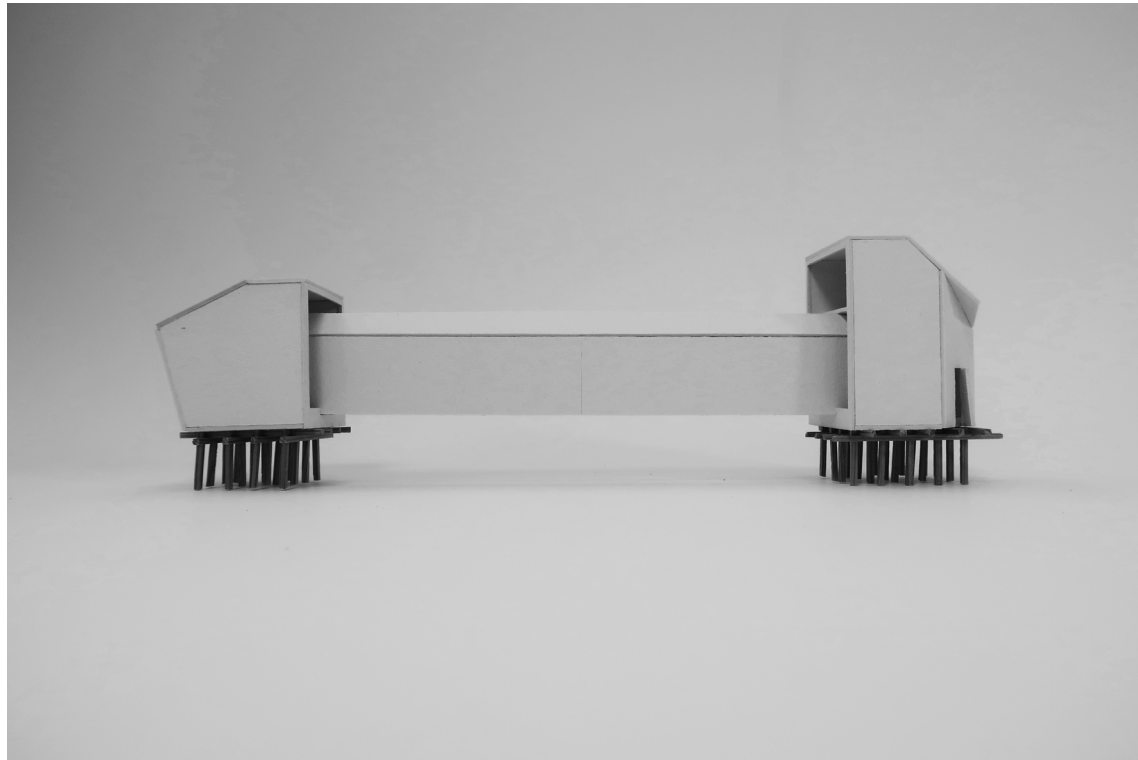

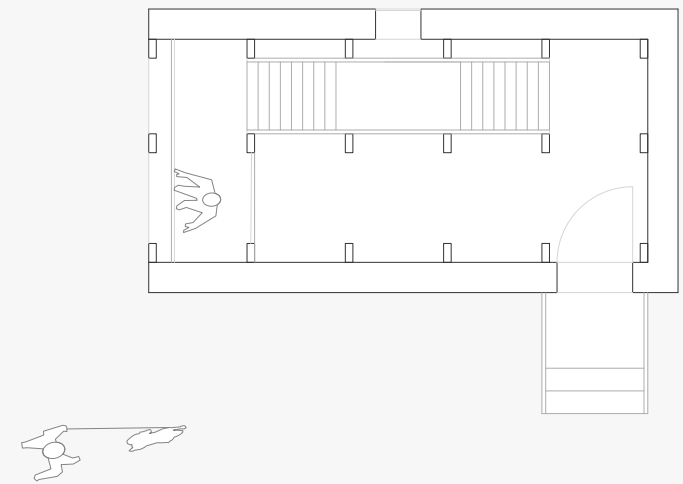
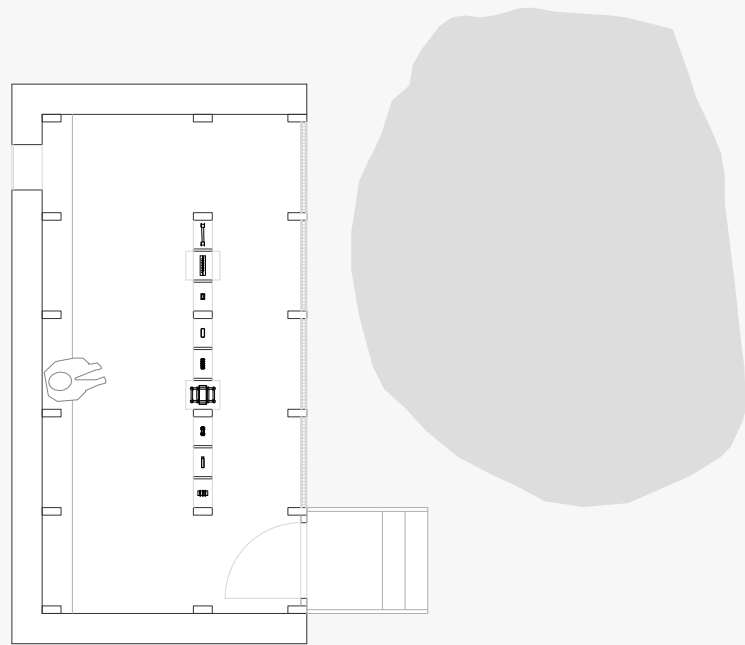

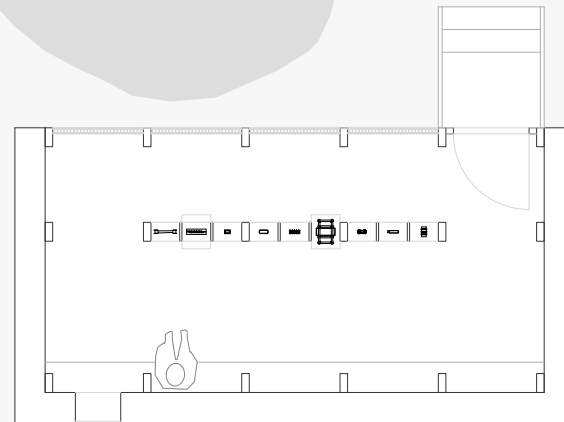
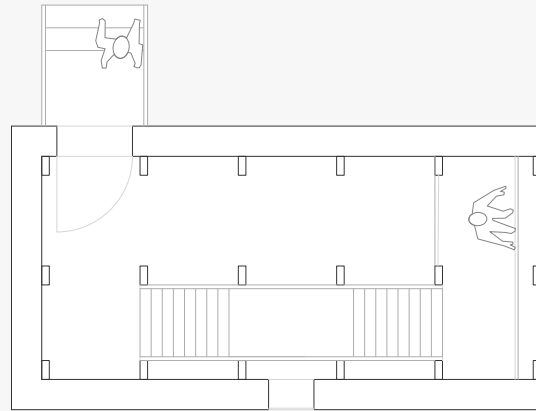

SKETCHES
VIEWS

