

PRESENTENTS

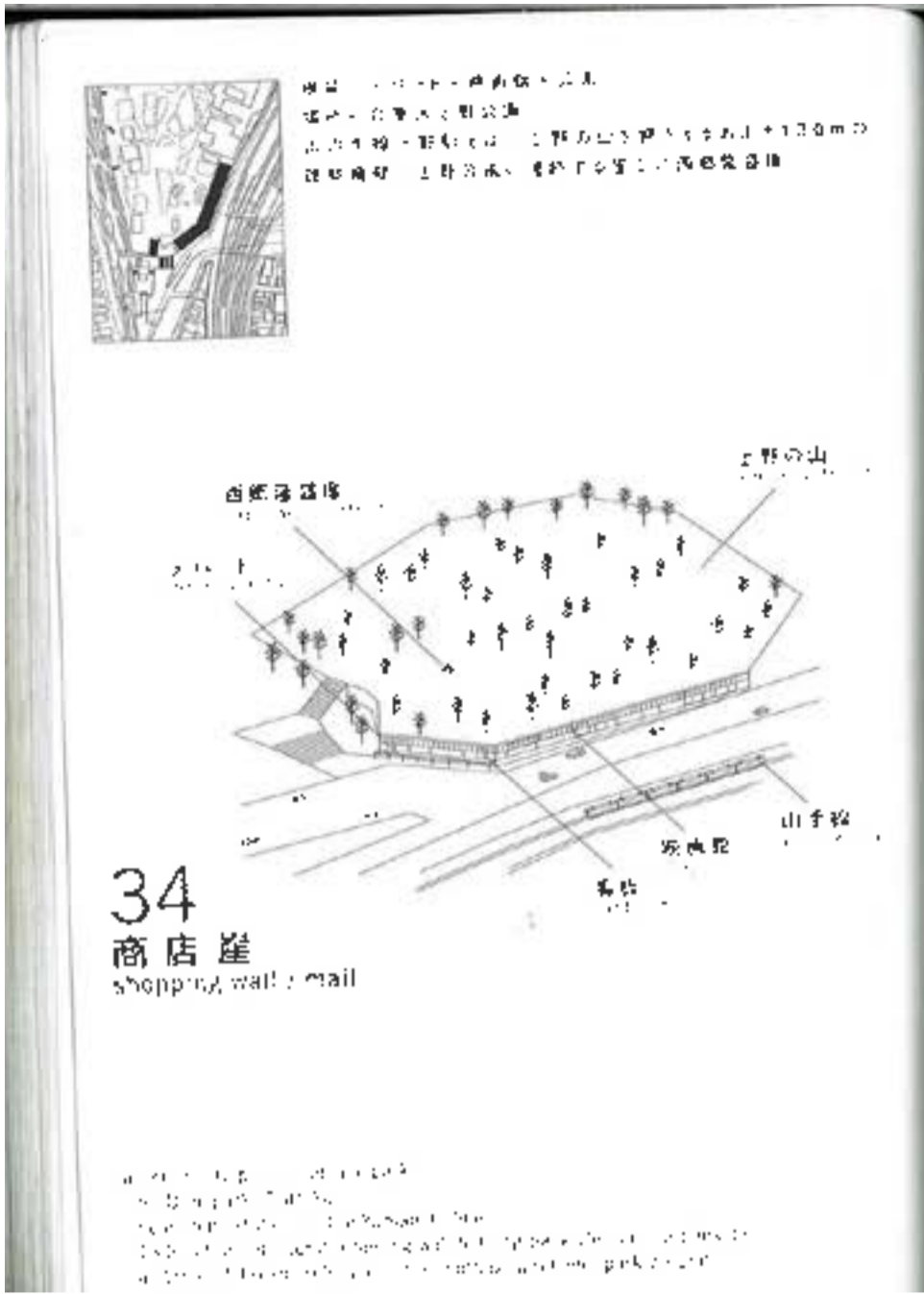

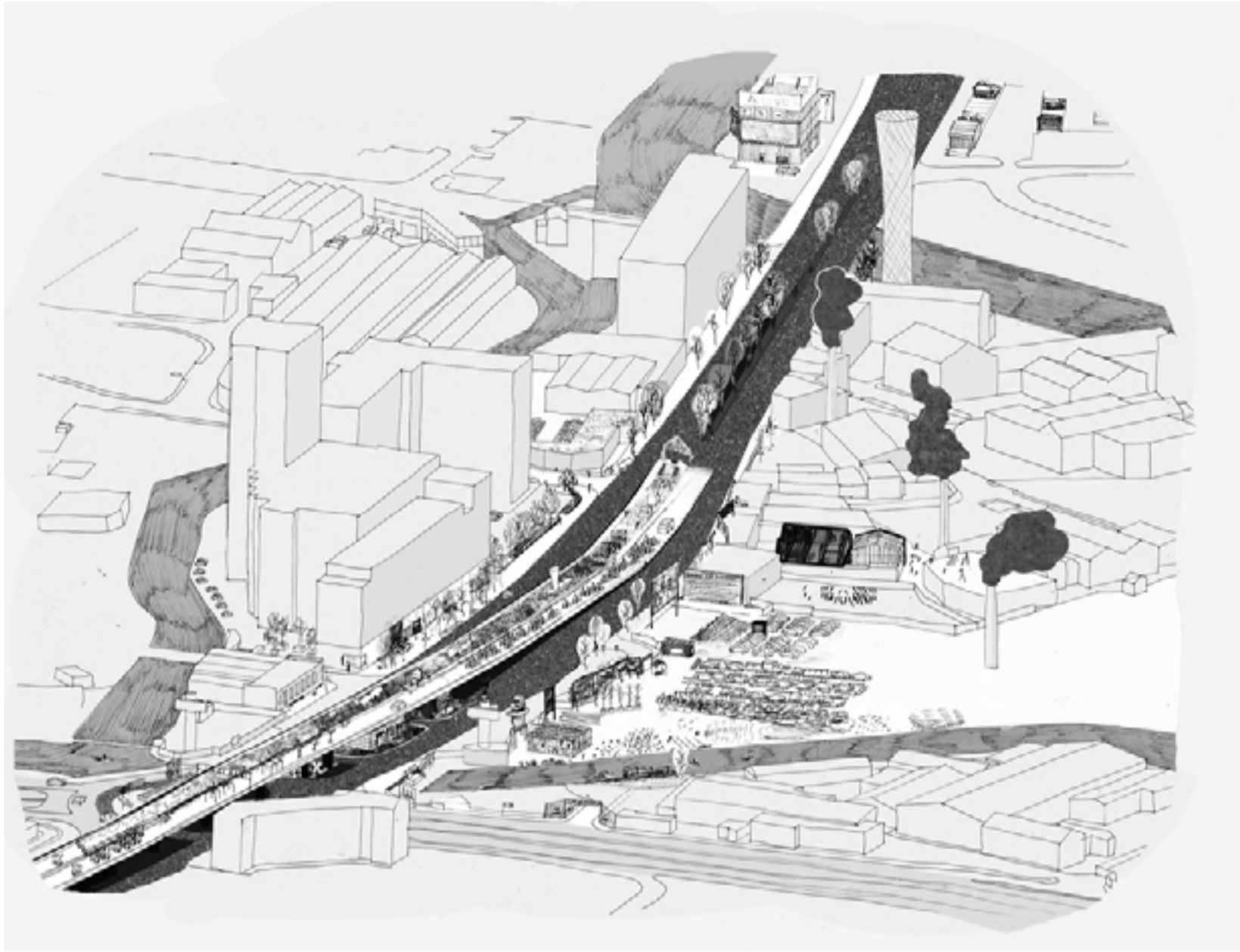







WALL SPACES  
ASTRID FADNES

## METHODOLOGY











Ten principles for intervention

- 1  Make the barrier a destination
- 6  Make better links to Bromley By Bow
- 2  Make uses visible on the High Street
- 7  Make social spaces
- 3  Make the most of passing traffic
- 8  Make the most of existing buildings, institutions and heritage
- 4  Make a coordinated public realm which retains diversity
- 9  Make more affordable workspace
- 5  Make use of vacant spaces
- 10  Make use of the process of change

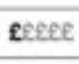
intervention proposals

Temporary Common					
				LandProg	
<p>This is a proposal to take advantage of one of the surrounding vacant developments sites as an open air communal space that can host a variety of temporary, informal and spectacular events, acting something like Stratford High Street's answer to the village green.</p> <p>Events should make the most of the sheer scale of the site and the proximity to the road network by hosting events that will attract local residents and visitors alike - such as car-boot sales and outdoor cinema screenings. The activities can not only encourage positive ownership of future development sites but can also be a useful source of revenue in the short term - providing an alternative to S106, where money generated through events can fund other small projects in the area.</p> <p><small>For more information see LandProg, 2008; Bow Arts; BPP; Bowling; Crafts College; Current Junction; Openness; LandProg</small></p>					
					

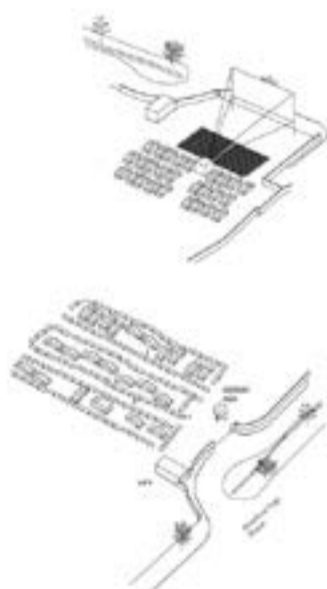

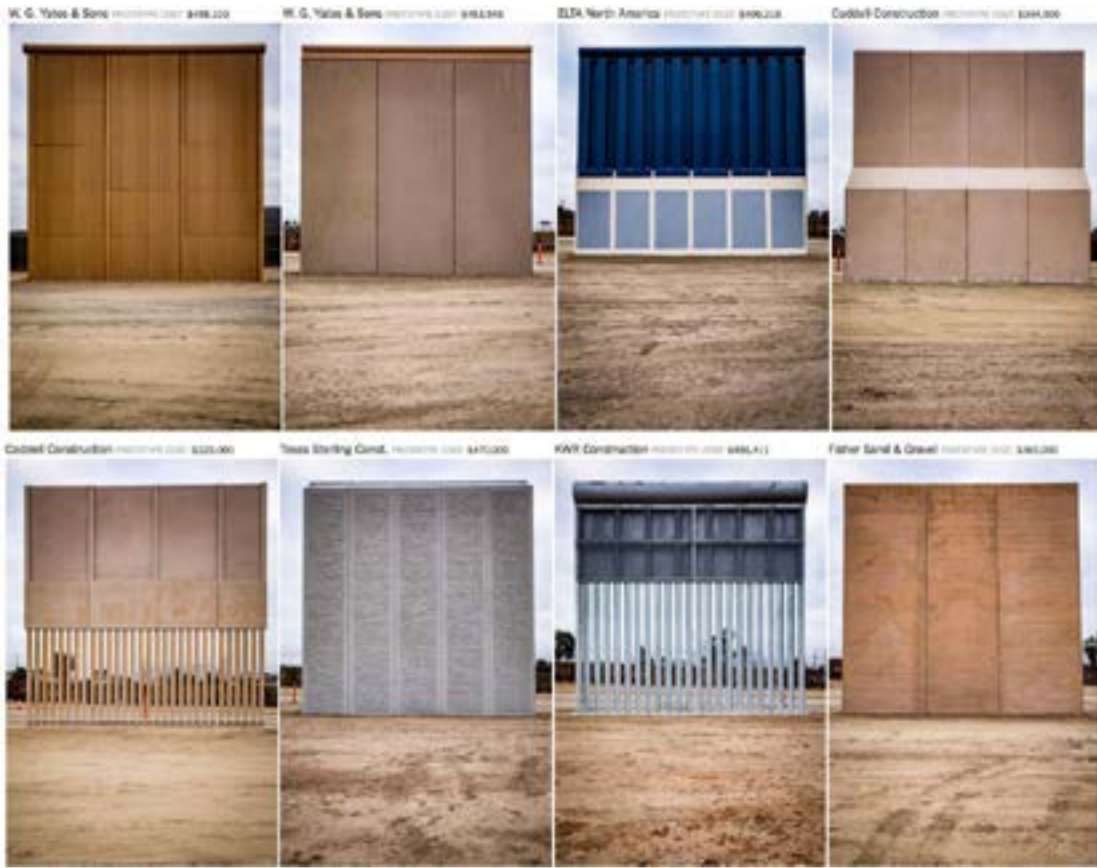

Catalogue\_US\_Mexico Border



The City between Freedom and Security\_BAS Studio,  
Deane Simpson, Vibeke Jense, Anders Rubing

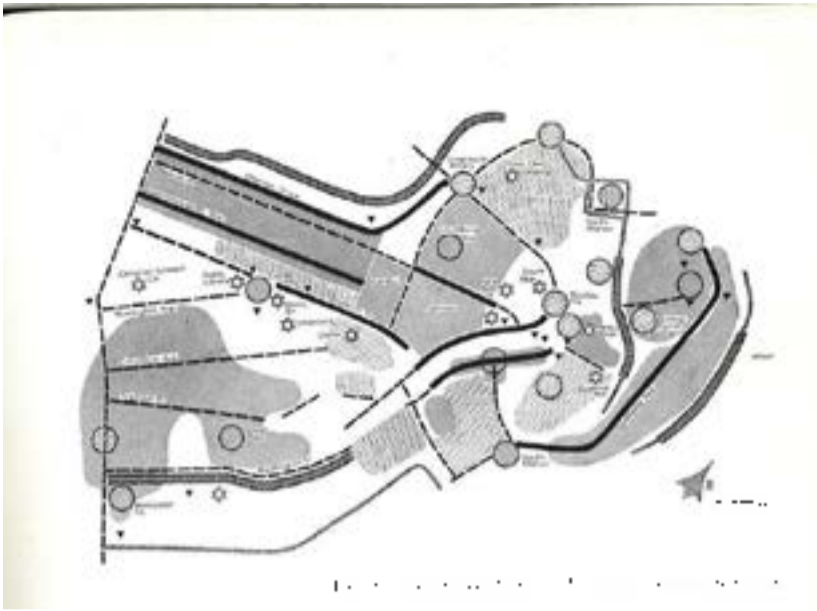

Kevin Lynch\_Image of the City

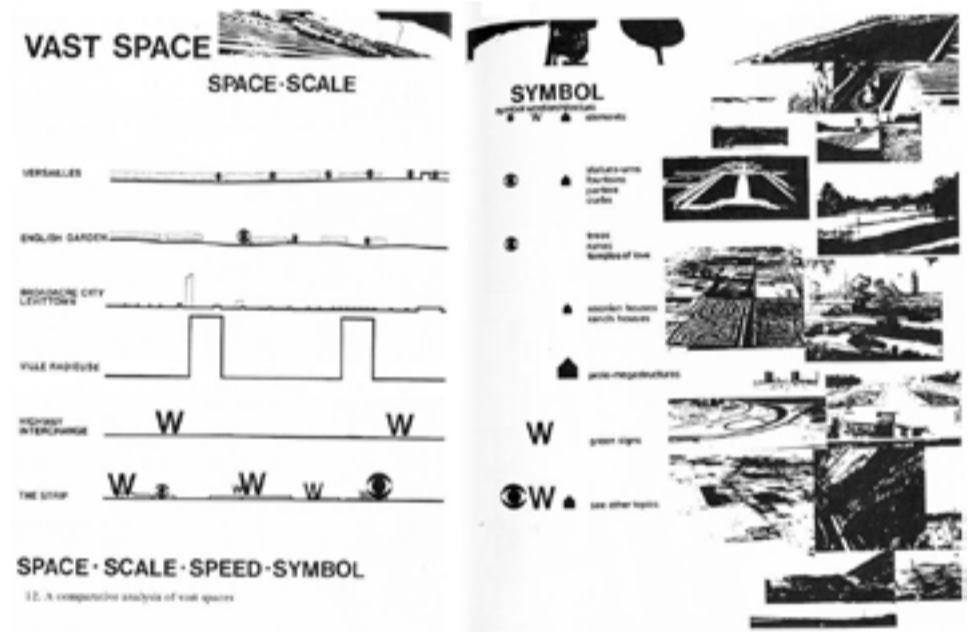
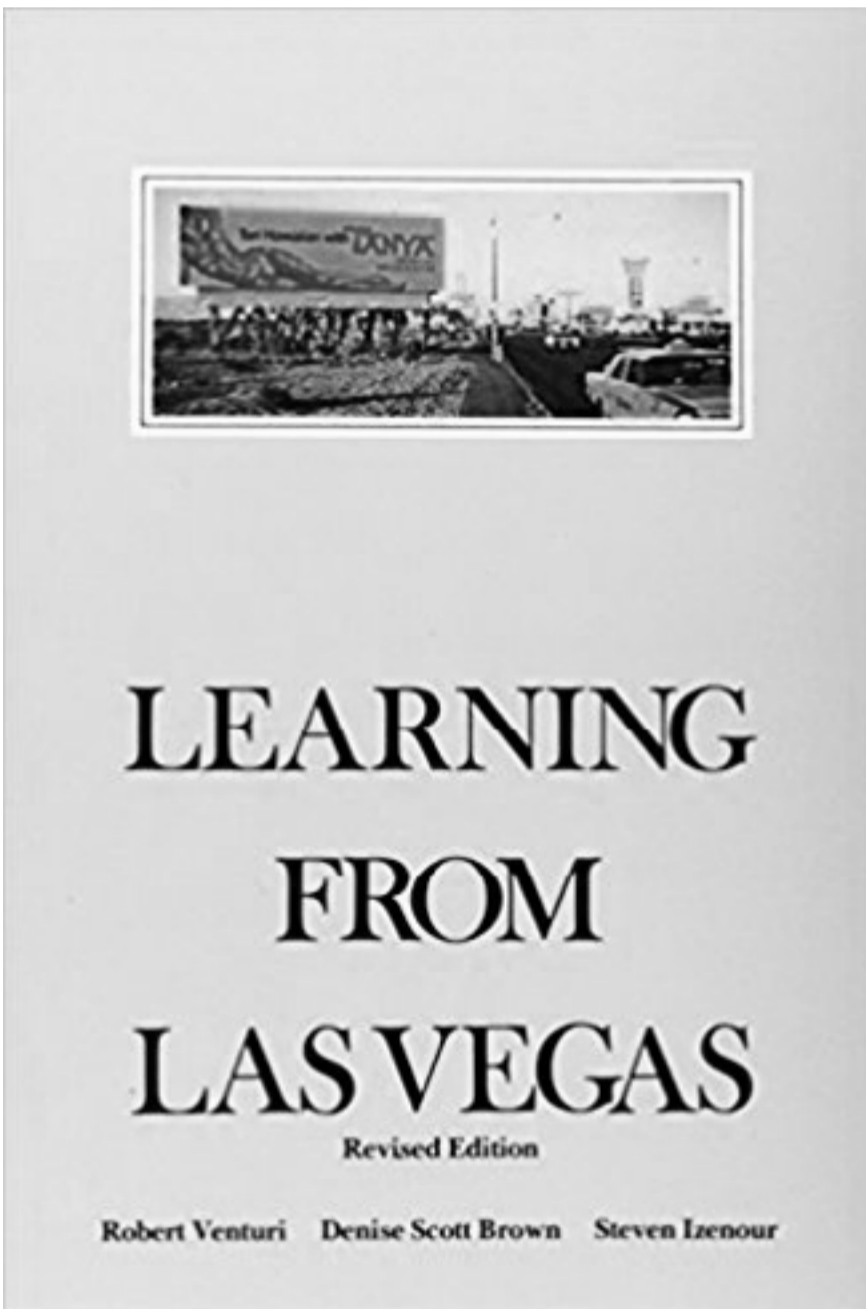

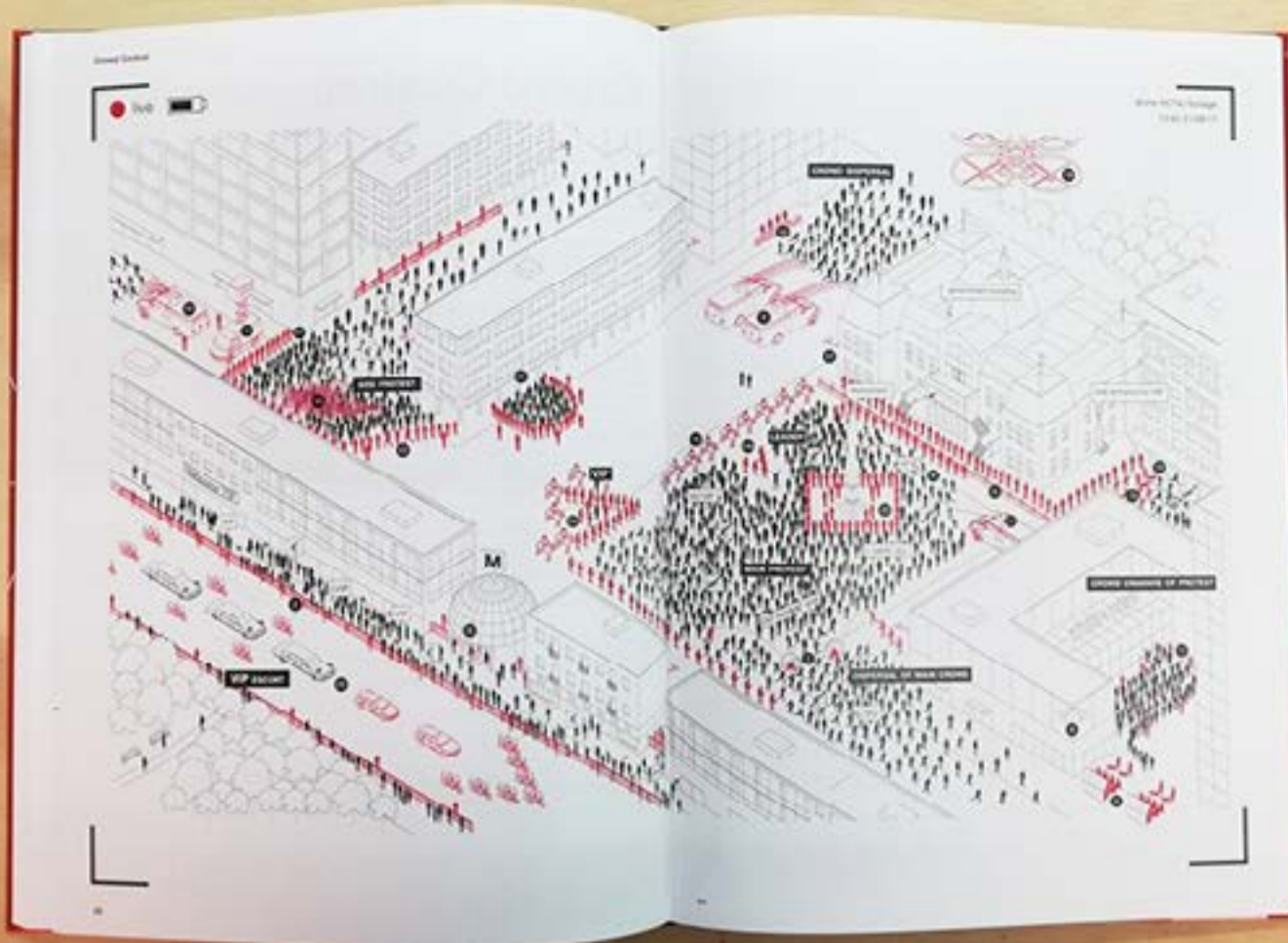

**Walls & Fences**

- 1. **Germany-Greece**: Metal mesh fence fixed on 12 angled metal studs. Anti-theft integration barrier.
- 2. **Hungary-Turkey**: Double metal mesh fence with barbed wire fixed on 12 angled metal studs on one side and vertical metal studs on the other. Double wire is placed on top of both fences, as well as between them. Anti-theft integration barrier.
- 3. **Hungary-Turkey**: Barbed wire fence fixed on metal studs. Anti-theft integration barrier.
- 4. **Greece-Turkey**: Double metal mesh fence with barbed wire fixed on metal studs. Features roller-coated studs. For the security and anti-theft integration barrier.
- 5. **Switzerland-Greece**: Double metal mesh fence fixed on 12 angled metal studs. Features a metal mesh and is heavily protected with barbed wire. Anti-theft integration barrier.
- 6. **Poland-Florida**: Metal mesh fence fixed on metal studs. Multiple sections, corners, conflict and anti-theft barrier.
- 7. **Latvia-Russia**: Metal mesh fence fixed on 12 angled metal studs with barbed wire. Anti-theft integration barrier.
- 8. **Hungary-France**: Barbed wire fence fixed on concrete posts. Anti-theft integration barrier.
- 9. **Hungary-France**: Barbed wire fence fixed on wooden posts. Anti-theft integration barrier.
- 10. **Liberia-Florida**: Metal mesh fence with barbed wire on top fixed on metal studs. Conflict zone barrier aimed at deterring terrorism and weapons smuggling.
- 11. **France-Greece (Piraeus)**: Double metal mesh fence fixed on metal studs. Multiple sections, conflict and anti-theft barrier.
- 12. **Algeria-Algeria**: Metal mesh fence fixed on metal studs. Multiple sections, conflict and anti-theft barrier.
- 13. **France-Somalia**: Double metal mesh fence fixed on pre-fabricated concrete posts with barbed wire in between. Anti-theft barrier.
- 14. **Belarus-Ukraine**: Chain-link fence with metal mesh fence with barbed wire fixed on metal studs. Anti-theft integration and corner conflict barrier.
- 15. **South Africa-Zimbabwe**: Chain-link pre-fabricated metal mesh fence with barbed wire and palm nails. Anti-theft integration and anti-smuggling barrier.
- 16. **Israel-Egypt**: Double fence with barbed wire fixed on metal studs. Anti-theft integration barrier.
- 17. **Turkey-Greece**: Barbed wire fence fixed on pre-fabricated concrete posts. Anti-theft integration and anti-terrorism barrier.
- 18. **Israel-Jordan**: Metal mesh fence fixed on metal studs. Anti-terrorism and anti-theft integration barrier.

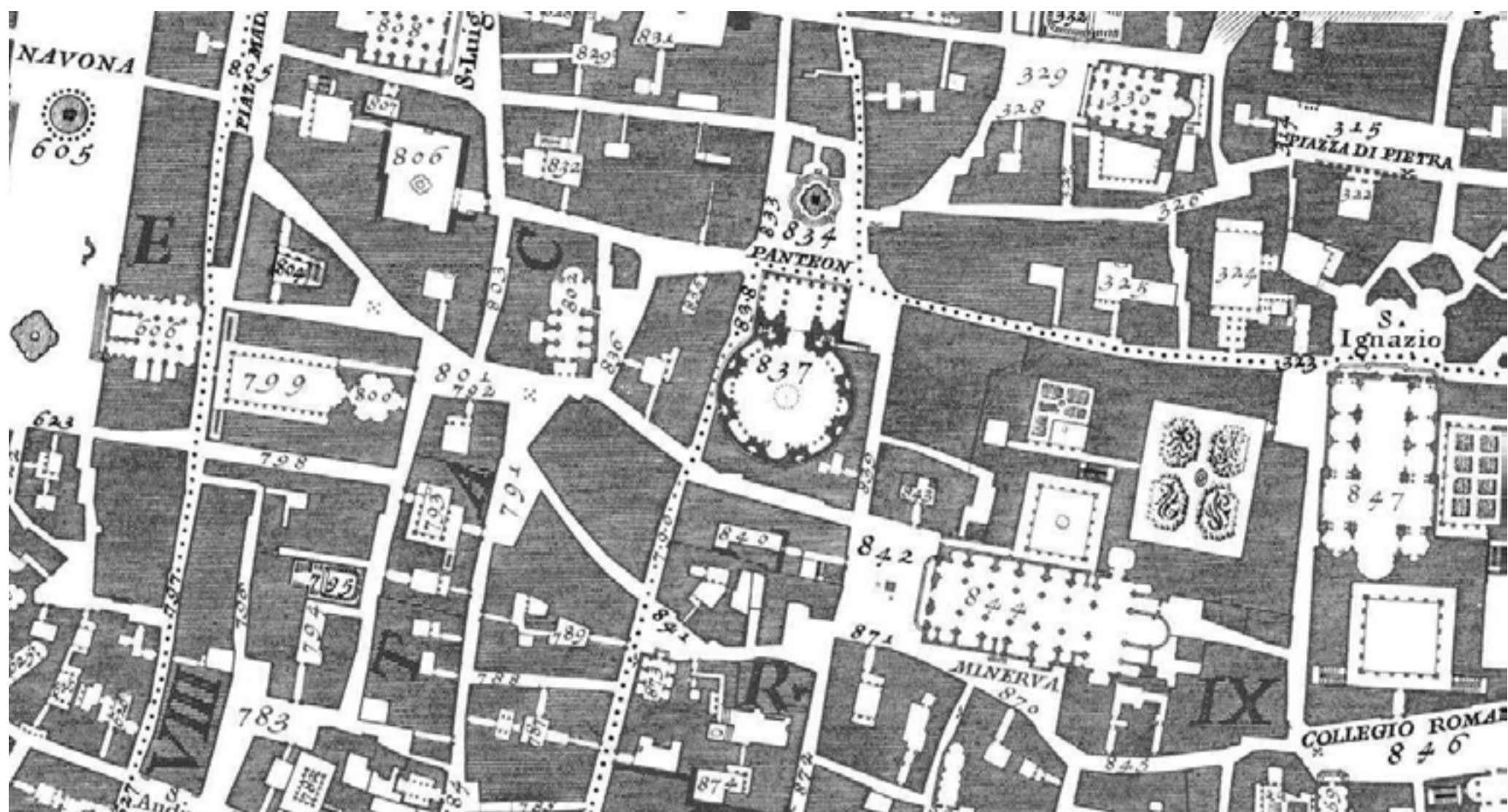

Nolli Map, Giambattista Nolli, 1748



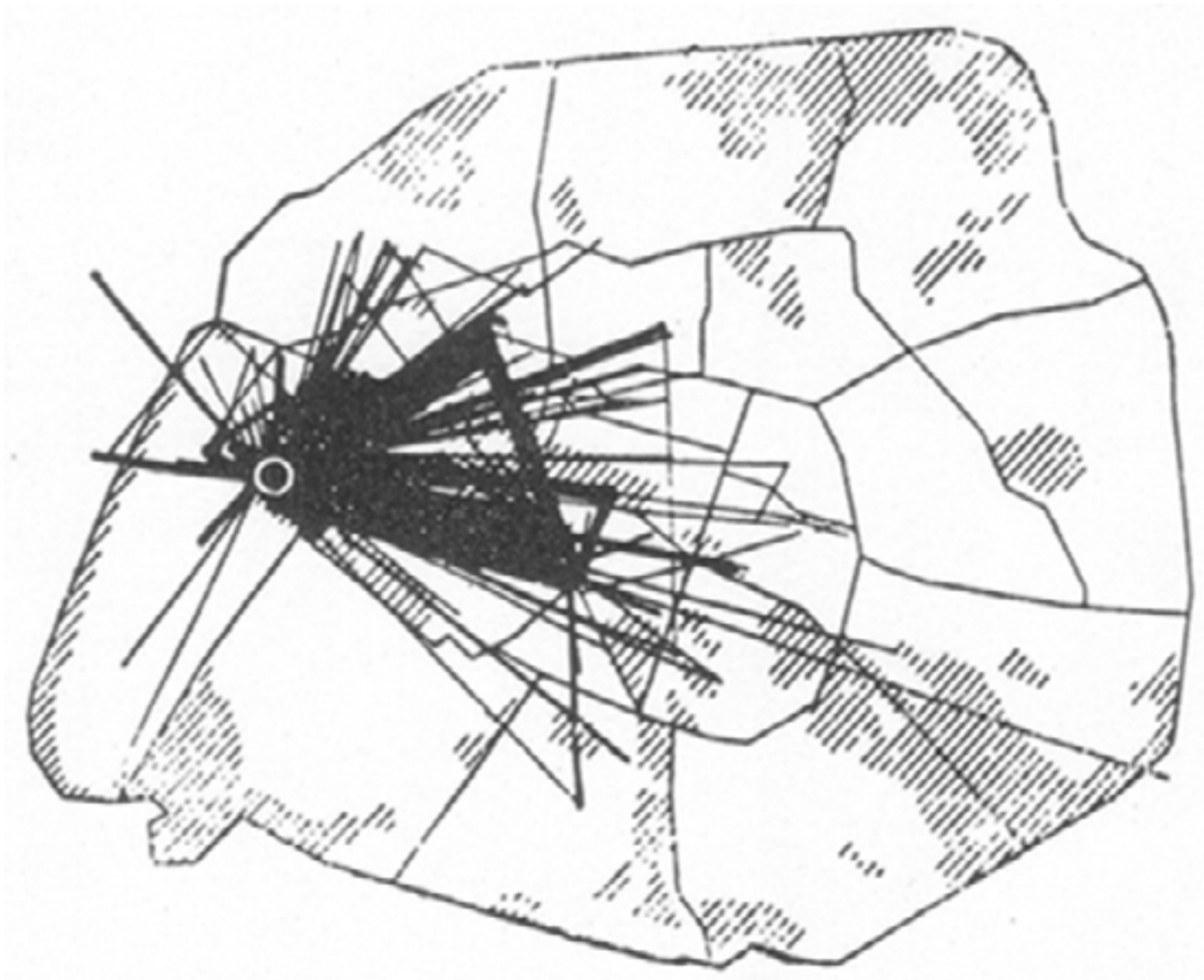
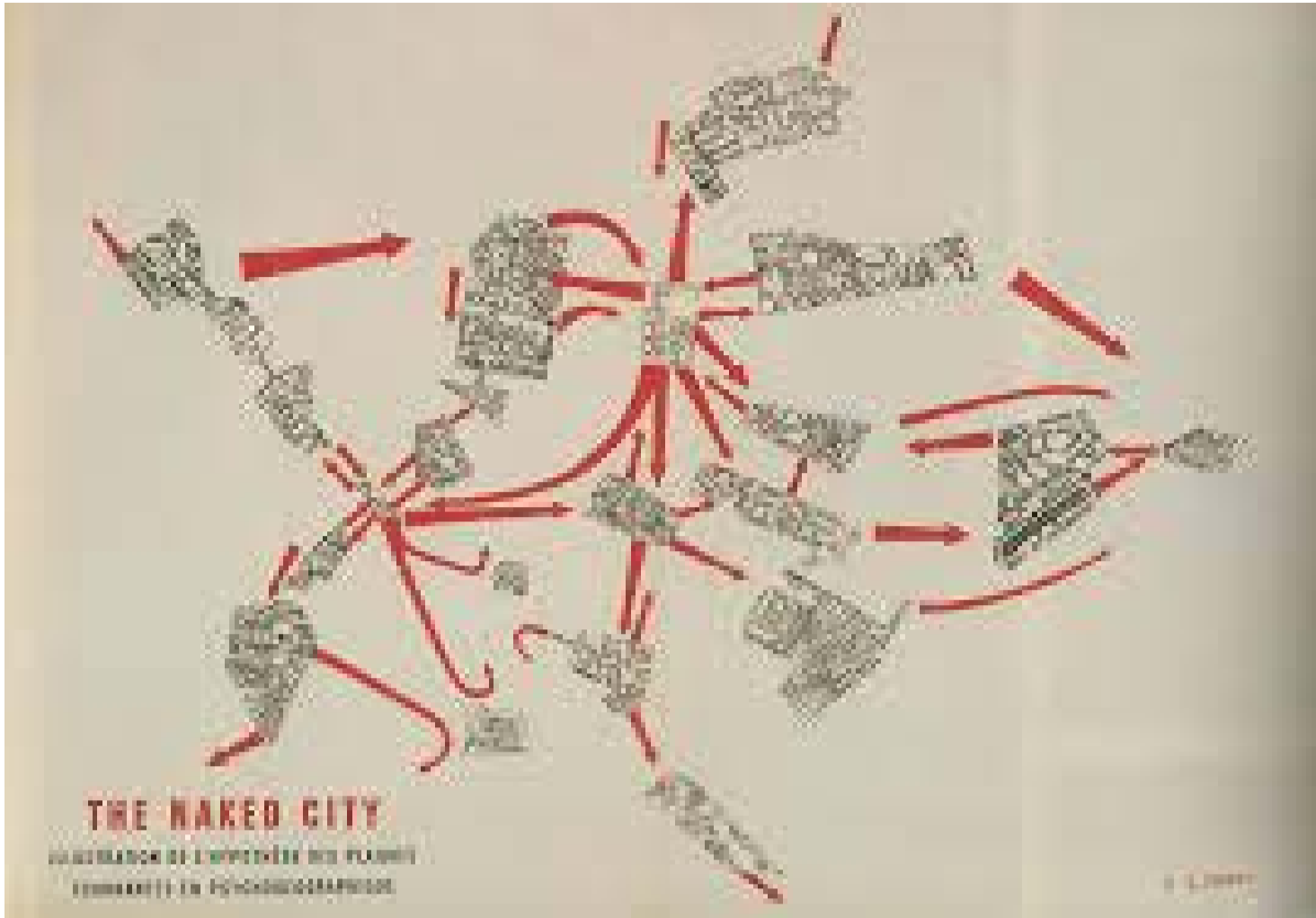

*Situationist map  
The Naked City, Guy Debord*

PUBLIC SPACE



Lina Bo Bardi: MASP (Museum of Modern Art, Sao Paulo) and Sesc Pompeia. Public spaces are integrated in museum- and culture house program.



Minhocão: the uplifted highway turns into a great public space every night and every Sunday when it's closed for traffic and open to pedestrians, bikes, skaters, street sellers, theatre shows from the neighbouring building blocks, flea markets, performances and more.



UVA-projects (Unidades de Vida Articulada) in Medellin, Colombia. Former enclosed and fenced water tanks in the outskirts of the city, grew into the city with the urbanisation and were opened and transformed to big, public spaces: open space, classrooms, internet cafés, public toilets and launderette.



Ronald Rael's proposals for Mexico-US border:  
pedestrian walkway-wall and a library connecting the two sides of the border

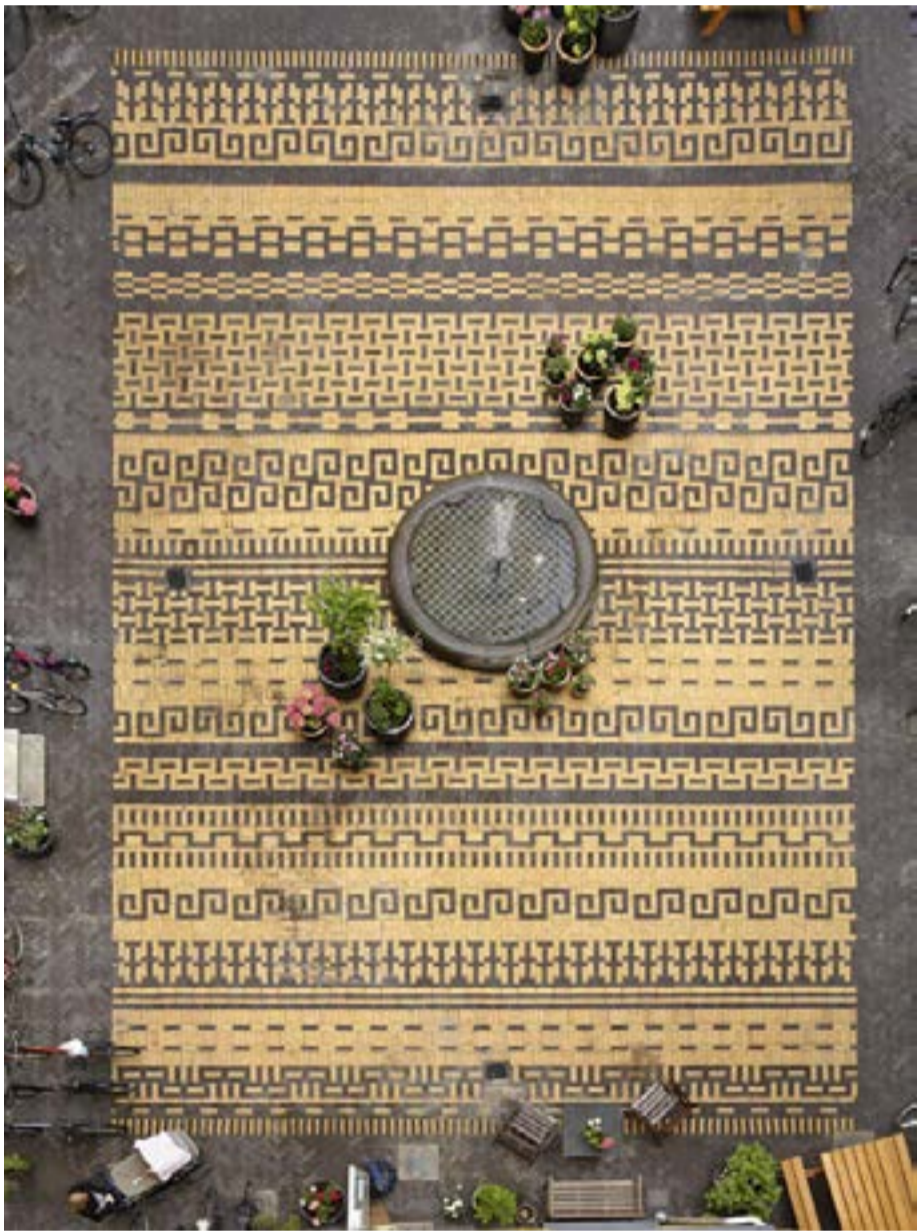

1:1 ARCHITECTS, COOPENHAGEN



COBE ARCHITECTS, KØBENHAVN



*Pigalle-Duperre-by-III-Studio\_dezeen*



*New York Restoration Project\_infill garden*



*INFILL SQUARE, praca Oscar Freire, Sao Paulo*

MATERIALITY



escola-campinas\_MMBB\_archdaily



Archdaily\_parque eduardo guinle, lucio costa

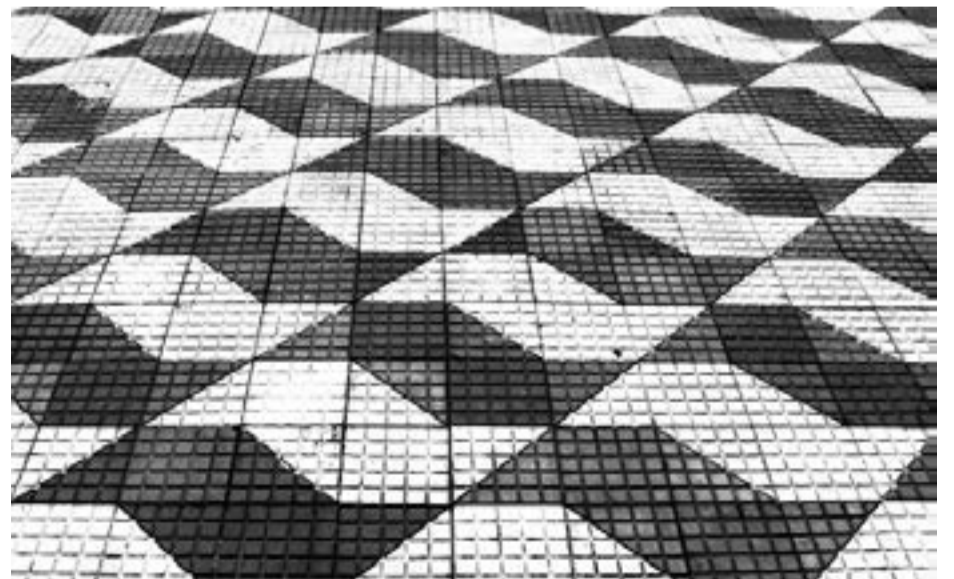

SAO PAULO TILES



BIBLIOTECA MONTEIRO LOBATO, SAO PAULO





ARCHITECTURE

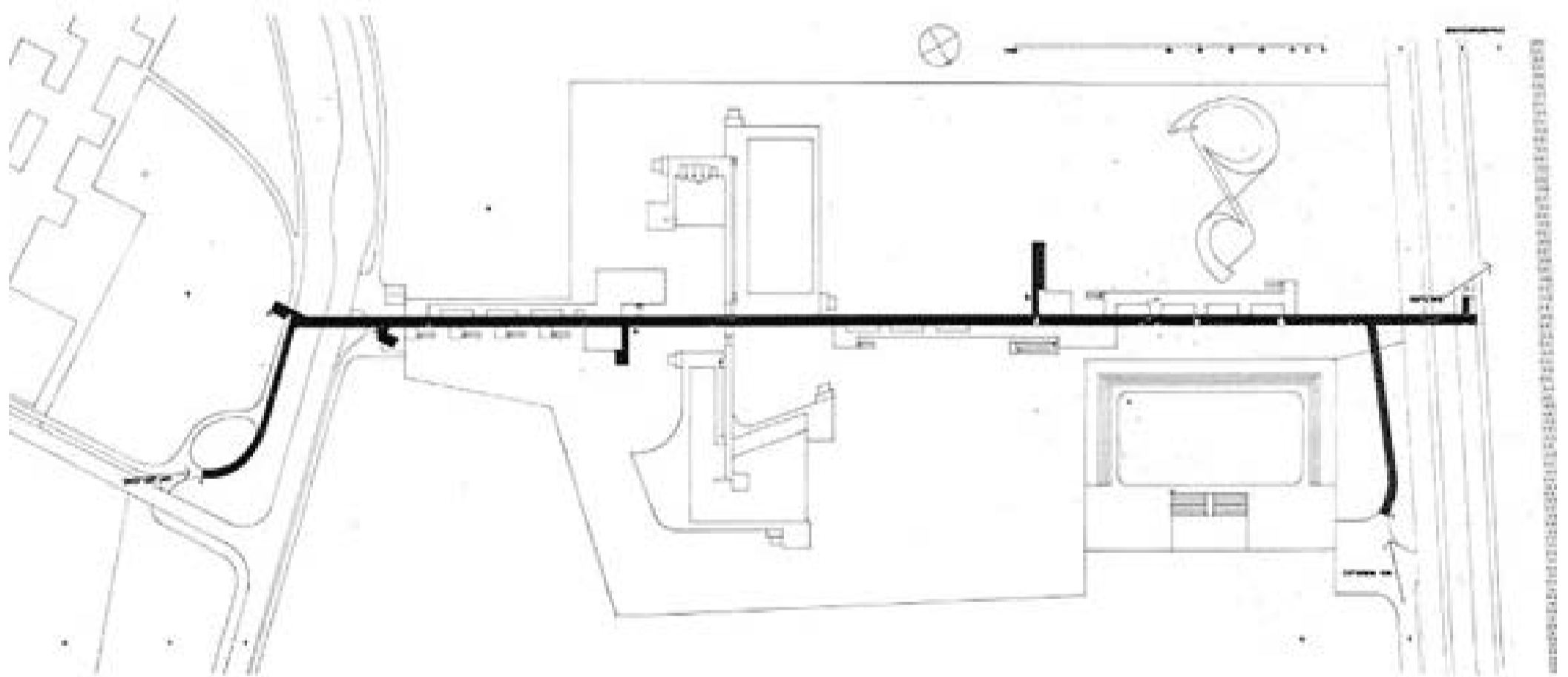

Aurelio Galfetti\_Bellinzona Bath

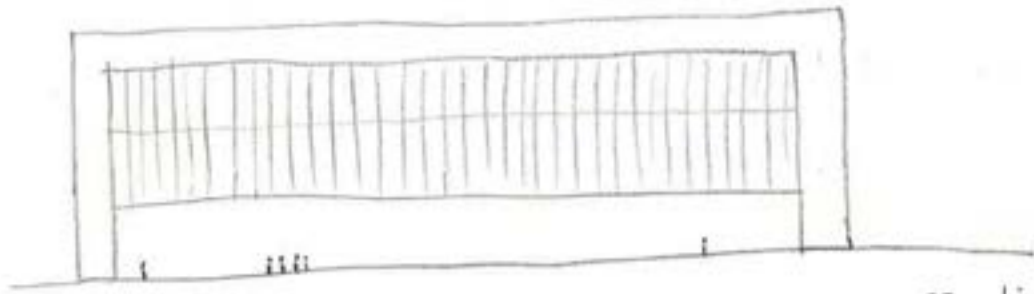

MASP, Lina Bo Bardi

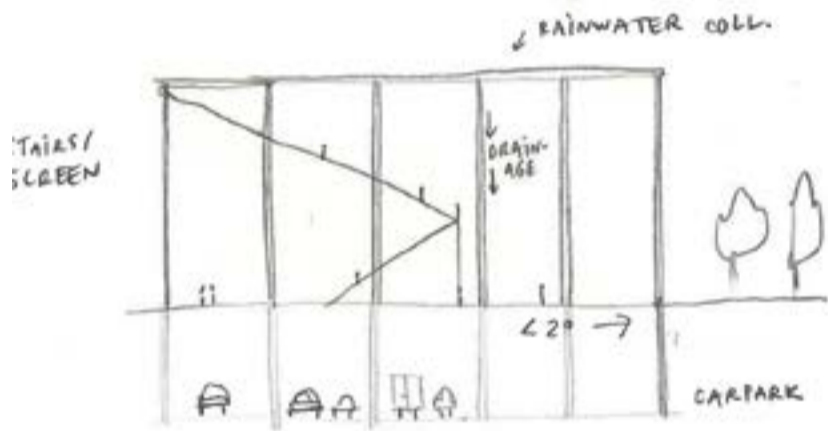

THEATERPLEIN,  
Bernardo Secchi  
Paola Vigano

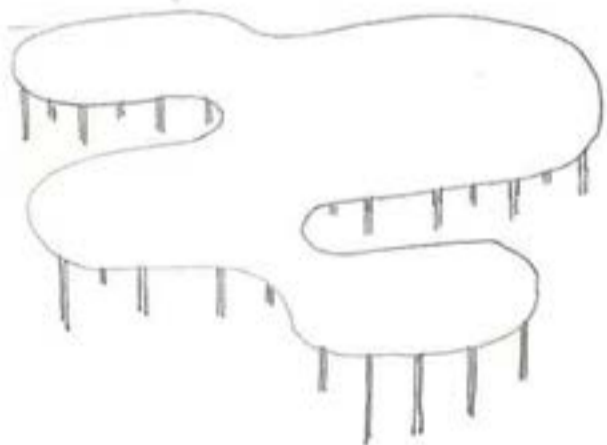

OKAYAMA UNI CAFE  
SOMA





Louis Kahn, SALK Institute



Carioca Aqueduct, Rio de Janeiro



Vila Louveira, Vilanova Artigas, Sao Paulo

ON SITE

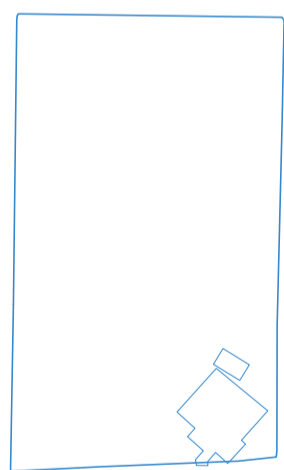
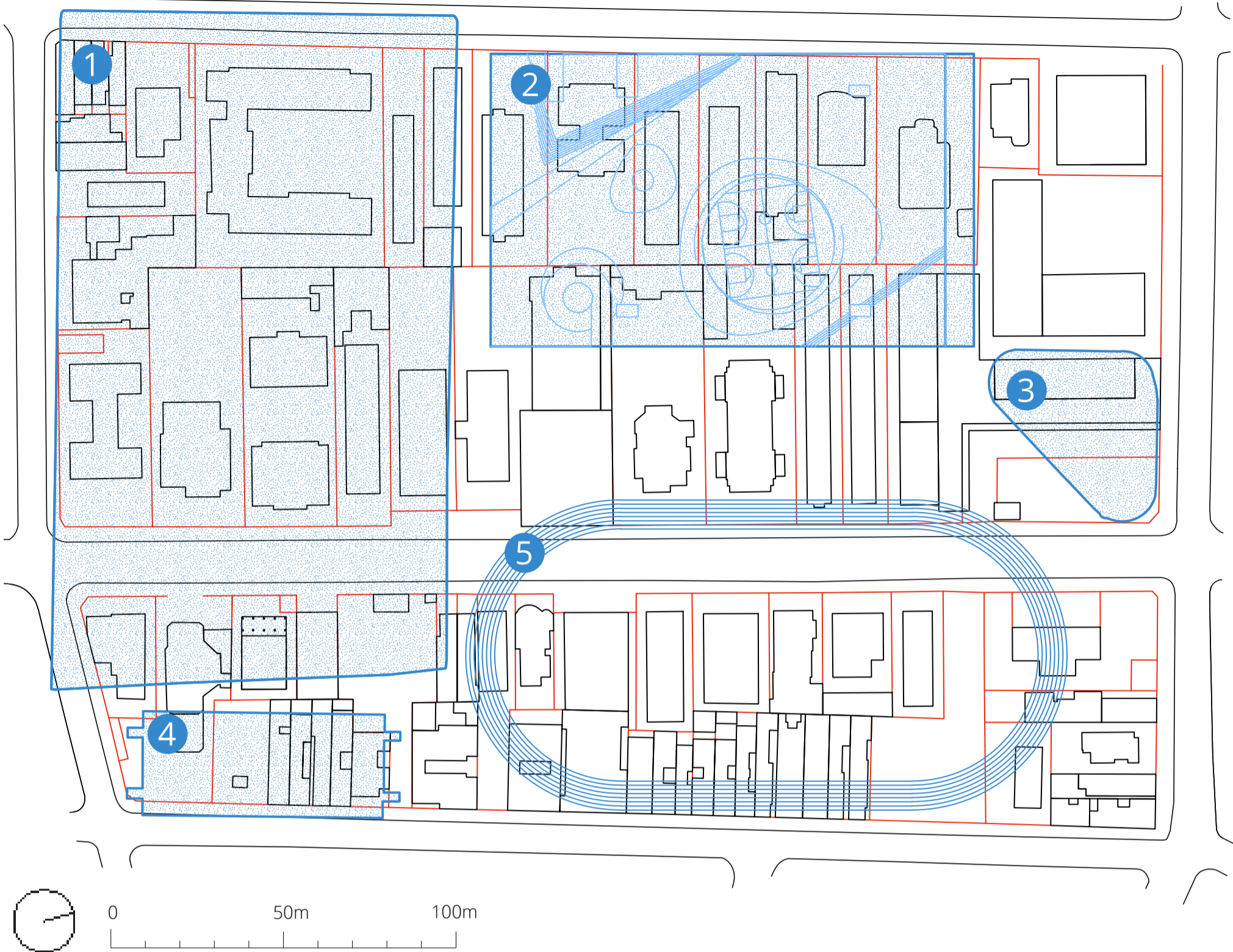

01 Buenos Aires Park

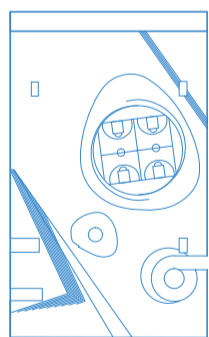

02 Israels Plads



03 Vilaboim

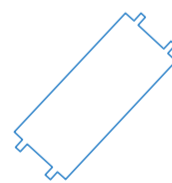

04 MASP

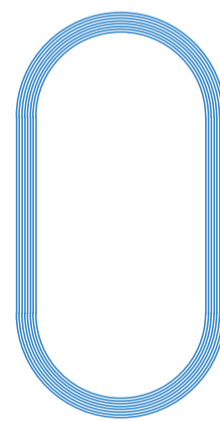

05 400 m running track



neighbourhood park,  
Avenida Angélica São Paulo

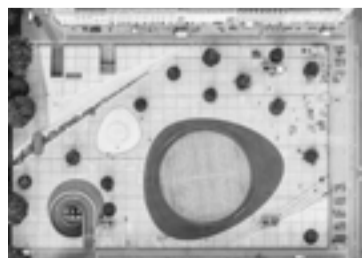

Kobe,  
Copenhagen



neighbourhood square,  
Higienópolis São Paulo



Lina Bo Bardi,  
São Paulo



Subarquitectura,  
Alicante/Spain